

COUNTY SURVEYORS FILE DATA
DO NOT REMOVE FROM OFFICE

SURVEY TO MONUMENT PROPERTY CORNERS
IN VACATED
LOT 3 & LOT 4 OF ADAMS TRACTS
SW 1/4, SECTION 5, T. 30 S., R. 5 W., W.M.
OCTOBER, 1985

FILED
RECEIVED

OCT 17 1985

COUNTY SURVEYOR
DOUGLAS COUNTY, ORE.

For: Valerie Johnson
12091 S.W. Lincoln St.
Tagard, OR. 97223

By: Baughman Technical Services, Inc.
P.O. Box 222
Roseburg, OR. 97470

LEGEND

- Found 1/2" iron rod
- Found 5/8" iron rod
- ⊙ Found 2" iron pipe, Initial Point ADAMS TRACTS
- Set 1/2"x24" iron rod with plastic surv.cap marked "BAUGHMAN TECH. SERV."
- (.) Record per M 76-53, M.L.P. Bk.5, Pg.28

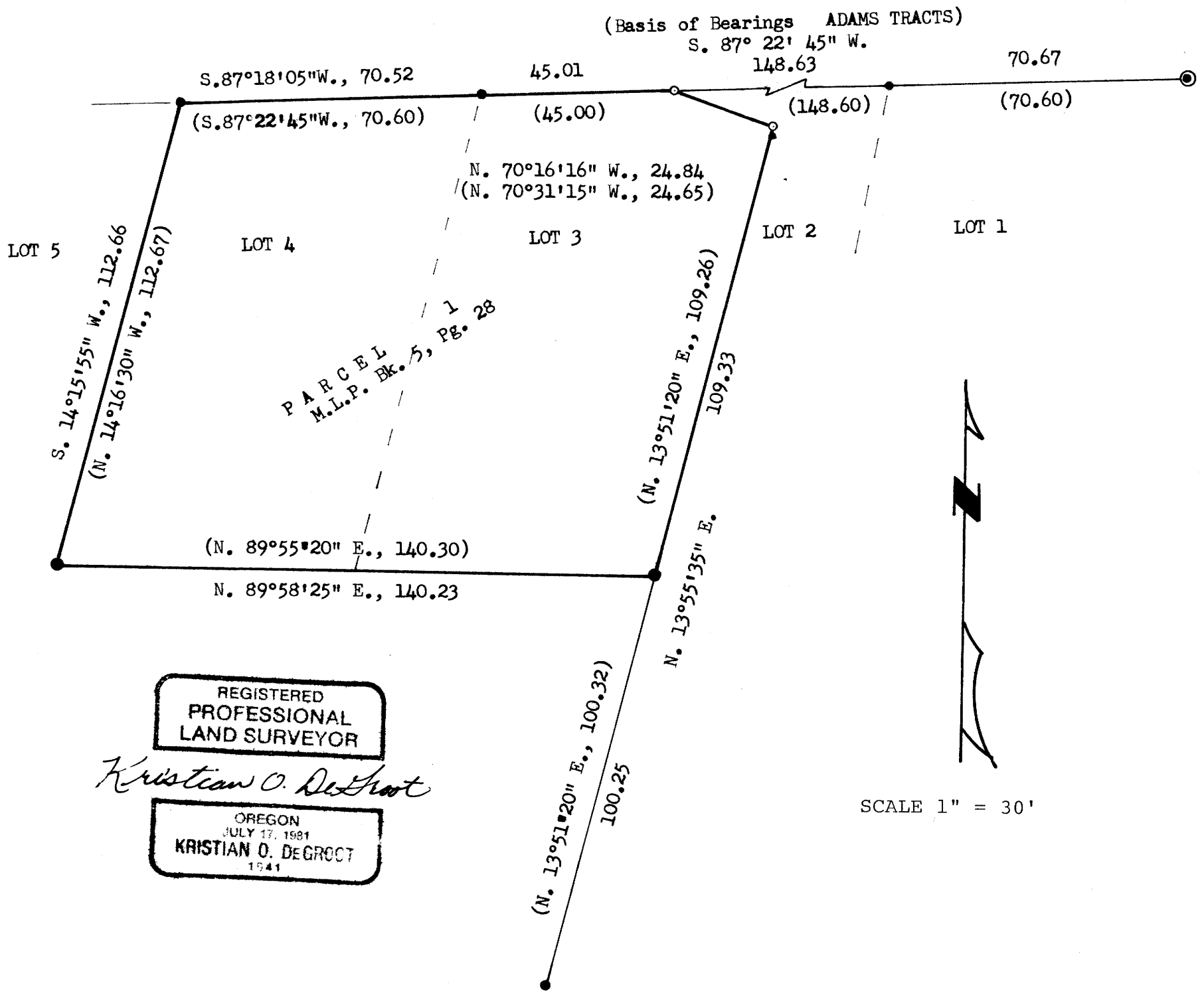

REGISTERED
PROFESSIONAL
LAND SURVEYOR

Kristian O. DeGroot

OREGON
JULY 17, 1981
KRISTIAN O. DEGROOT
1941

SURVEY NARRATIVE:

Reference Surveys: M76-53, Plat of ADAMS TRACTS Vol. 15, Pg.60

The purpose of this survey was to locate and monument the corners of Parcel 1 as recorded in Book 5, Page 28 of the Minor Land Partition Records of Douglas County, Oregon. All corners of Parcel 1 were found except the 2 northeasterly corners. The corner on the North Line was set at single proportionate distances between the NW corner of Lot 3 and the NE corner of Lot 2, ADAMS TRACTS. The corner on the East Line of Lot 3 was set at record distance from the SE corner of ADAMS TRACTS.

The survey was performed by Kris DeGroot, Project Surveyor and Mike Fromdahl, Chainman in August, 1985 using a Leitz TM 20-C Theodolite and a 300 foot steel tape. Computations and drafting are by Kris DeGroot.