

COUNTY SURVEYORS FILE DATA
DO NOT REMOVE FROM OFFICE

FILED
RECEIVED

OCT 3 1985

BASIS FOR BRG.: TRUE FROM SOLAR AND M 90-42
(N 89° 59' 20" W 2574.45')

(S 89° 30' W 2580.0' M I-56)

(WEST 40.00 Ch. G.L.O.)

19 20 COUNTY SURVEYOR
30 29 DOUGLAS COUNTY, ORE.

1/4 CORNER 19 & 30

FND. 1 1/4" IRON PIPE / BRASS CAP - PLS 497 (M 90-42)
10" FIR BRS. S 48° 30' E, 30.3' - PARTIALLY CLOSED FACE
22" CEDAR BRS. N 60° 00' W, 46.0' - PARTIALLY CLOSED FACE

SECTION CORNER 19, 20, 29 & 30

FND. 1 1/4" IRON PIPE / BC - PLS 497 (M 90-42)
32" FIR STUMP BRS. N 15° W, 19.5' (C.S. 42/275)
16" HEM. STUMP BRS. N 64° E, 15.5' " "
24" FIR STUMP BRS. S 82° E, 24.0' " "
34" FIR STUMP BRS. S 59° W, 41.5' " "

NARRATIVE

THE PURPOSE OF THIS SURVEY WAS TO LOCATE AND MARK THE INDICATED BOUNDARY LINES OF INTERNATIONAL PAPER COMPANY IN THE SE 1/4 OF SECTION 30, T20S, R10W, W.M. A KERN KI-SE/DM 502 WAS USED TO PERFORM THIS SURVEY. RANDOM TRAVERSES WITH A MINIMUM ERROR OF CLOSURE OF 1/5000' WERE RUN BETWEEN FOUND CORNERS FOR CONTROL. OFFSETS FROM THE RANDOM TRAVERSE LINE TO THE TRUE PROPERTY LINE WERE CALCULATED AND USED TO DETERMINE THE POSITION OF THE TRUE LINE. THE TRUE PROPERTY LINE WAS MARKED WITH RED PAINTED BLAZES ON BOTH SIDES OF THE LINE AND BY 1/2 x 60" IRON RODS SET AS SHOWN ON THE ACCOMPANYING PLAT. EACH IRON ROD WAS REFERENCED BY A BEARING AND DISTANCE TIE TO A NEARBY TREE. AN ALUMINUM TAG MARKED WITH THE BEARING AND DISTANCE FROM THE TAG TO THE IRON ROD WAS NAILED LOW ON THE SAID TREE. A YELLOW ALUMINUM SIGN MARKED "PROPERTY LINE - INTERNATIONAL PAPER CO. - GARDINER, OREGON" WAS ATTACHED TO EACH IRON ROD. A 1-1/2" ALUMINUM CAP, STAMPED WITH THE FIRST LETTER OF THE DIRECTION AND THE DISTANCE (ROUNDED TO THE NEAREST FOOT) TO THE NEAREST CORNER MONUMENT, WAS ATTACHED TO TOP OF EACH IRON ROD. A FLUORESCENT PURPLE MAGNETIC MARKER WAS BURIED APPROXIMATELY 12" BELOW THE GROUND AND ALONGSIDE EACH IRON ROD. MAGNETIC MARKERS WERE ALSO BURIED AT VARIOUS POINTS ALONG TRUE LINE, AND REFERENCED AS PREVIOUSLY DESCRIBED. THE SOUTH 1/16 CORNER BETWEEN SECTIONS 29 & 30 WAS SET AT THE PROPORTIONATE DISTANCE BETWEEN THE CORNER FOR SECTIONS 29, 30, 31 & 32 AND THE 1/4 CORNER. THE WITNESS CORNER FOR THE EAST 1/16 CORNER BETWEEN SECTIONS 30 & 31 WAS SET ON THE LEFT BANK OF THE NORTH FORK OF SMITH RIVER N 89° 25' 37", 405.00' FROM THE EAST 1/16 CORNER POSITION. AN APPROXIMATE EAST-WEST BLAZED CENTERLINE OF SECTION 30 HAD BEEN RUN ABOUT 10 YEARS AGO BY CHAMPION INTERNATIONAL CORP. FOR CUTTING PURPOSES IN THE NE 1/4. INTERNATIONAL PAPER AND CHAMPION HAVE AGREED TO USE THIS FORMER LINE IN LIEU OF ESTABLISHING THE TRUE CENTERLINE. A METAL FENCE POST WAS SET BY EACH SET MONUMENT ALONG WITH A BURIED MAGNETIC MARKER.

CORNERS FOUND

SET 1 1/4 x 36" IRON PIPES / STAMPED BRASS CAPS ○
(PLS 497 - 1985 AND CORNER IDENTIFICATION)

SET 1/2 x 60" IRON RODS ●

BLAZED & PAINTED PROPERTY LINES ————

(SURVEYS OF RECORD)

DISTANCES TO EACH NEW BEARING TREE WERE MEASURED TO A 60g. NAIL DRIVEN IN THE SIDE OF THE TREE.

1/4 CORNER 29 & 30

FND. R. R. SPIKE / 'X' MARKED ON HEAD IN THE CENTER OF A 60" FIR STUMP (REN. 55)
14" HEMLOCK BRS. N 56° E, 40.6'
PARTIALLY CLOSED FACE
32" HEMLOCK STUMP BRS. N 42° E, 34'
20" HEMLOCK BRS. N 57° W, 81.6'
CLOSED FACE

WEST 652'

2614.39'
N 0° 27' 54" E
(N 0° 08' W 2616.0' M I-56)

(NORTH 80.00 Ch. G.L.O.)

(N 0° 57' E 2614.0' M I-56)

REGISTERED
PROFESSIONAL
LAND SURVEYOR

Richard J. Hintz

OREGON
MAY 13, 1980
RICHARD J. HINTZ
497

RICHARD J. HINTZ
1890 N. 14th ST.
COOS BAY, OREGON

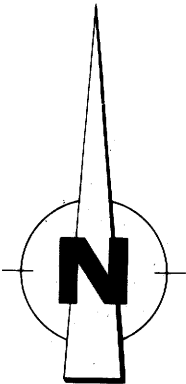

SOUTH 1/16 CORNER 29 & 30

12" ALDER BRS. N 73° 30' E, 14.8'
BARK SCRIBED S 1/16 S 29 BT
10" FIR BRS. S 7° 00' W, 13.3'
SCRIBED S 1/16 S 30 BT
1" IRON PIPE BRS. S 51° 44' W, 3.76' SET BY
R. KRELL & B. BLUMBERG, U.S.F.S.,
8-7-57

398'
403'
1305.71'
350'
155'
402'
386'
1305.71'
345'
173'
30'
31'
32'

1/4 CORNER 30 & 31

FND. 1/2" IRON PIPE (M 10-3)
8" CEDAR, NOW A 16" WINDFALL
BRS. N 3° 30' E, 15.3' TO A 50d. NL.
ON THE UPPER SIDE OF THE CLOSED
FACE M 10-3 BT
12" FIR WINDFALL BRS. S 45° 30' W, 9.9'
TO A 50d. NL. ON THE UPPER SIDE OF
THE CLOSED FACE M 10-3 BT

(S 89° 45' E 40.00 Ch. G.L.O.)
(N 89° 38' 16" E 2618.88' M 10-3)

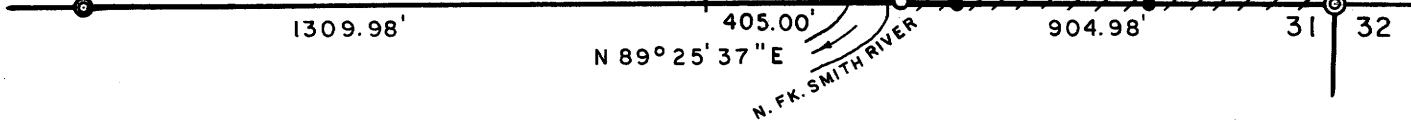

WC EAST 1/16 CORNER 30 & 31

20" FIR BRS. N 74° 15' E, 19.8'
SCRIBED 'X' BT
16" ALDER BRS. S 42° 15' E, 89.0'
BARK SCRIBED 'X' BT

SECTION CORNER 29, 30, 31 & 32

FND. IRON PIPE / BRASS CAP, G.L.O. 1951 (REN. 21)
12" FIR BRS. NORTH, 53.2' - CLOSED FACE
12" MAPLE BRS. S 67° E, 28.8' - CLOSED FACE
24" CEDAR BRS. S 49° W, 7.9' - CLOSED FACE
16" FIR BRS. N 23° 00' W, 37.0' - NEW BT
SCRIBED S 30 BT

PROPERTY SURVEY FOR
INTERNATIONAL PAPER COMPANY
SE 1/4 SECTION 30, T 20 S, R 10 W
SEPTEMBER 1985 SCALE 1" = 400'