

COUNTY SURVEYORS FILE DATA
DO NOT REMOVE FROM OFFICE

FILED
RECEIVED *OR*

DEC 9 1983

COUNTY SURVEYOR
DOUGLAS COUNTY, ORE.

PROPERTY SURVEY FOR INTERNATIONAL PAPER CO.

SECTIONS 28 & 29, T 21 S, R 11 W
DEC. 1983 SCALE 1" = 400'

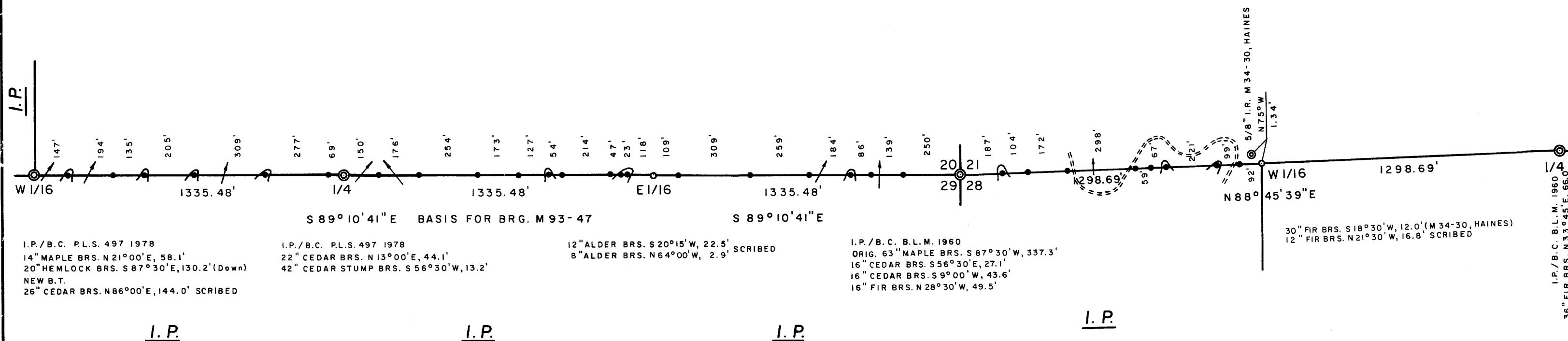

I.P./B.C. P.L.S. 497 1978
 14" MAPLE BRS. N 21° 00' E, 58.1'
 20" HEMLOCK BRS. S 87° 30' E, 130.2' (Down)
 NEW B.T.
 26" CEDAR BRS. N 86° 00' E, 144.0' SCRIBED

I.P./B.C. P.L.S. 497 1978
 22" CEDAR BRS. N 13° 00' E, 44.1'
 42" CEDAR STUMP BRS. S 56° 30' W, 13.2'

12" ALDER BRS. S 20° 15' W, 22.5'
 8" ALDER BRS. N 64° 00' W, 2.9' SCRIBED

I.P./B.C. B.L.M. 1960
 ORIG. 63" MAPLE BRS. S 87° 30' W, 337.3'
 16" CEDAR BRS. S 56° 30' E, 27.1'
 16" CEDAR BRS. S 9° 00' W, 43.6'
 16" FIR BRS. N 28° 30' W, 49.5'

30" FIR BRS. S 18° 30' W, 12.0' (M 34-30, HAINES)
 12" FIR BRS. N 21° 30' W, 16.8' SCRIBED

I.P./B.C. B.L.M. 1960
 36" FIR BRS. N 33° 45' E, 66.0'

I.P.

I.P.

I.P.

I.P.

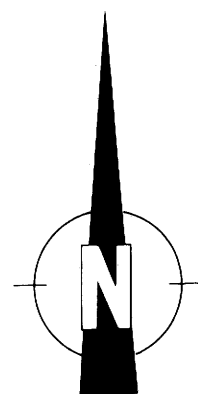

LEGEND

CORNERS FOUND ©
 SET 1 1/4 x 36" I.P.'S / STAMPED BRASS CAPS (P.L.S. 497 1983) ○
 EACH CAP IS ALSO STAMPED IN THE PRESCRIBED MANNER AS
 SET FORTH IN THE B.L.M. MANUAL OF SURVEY INSTRUCTIONS.
 PROPERTY LINES ESTABLISHED, 1/2 x 60" I.R.'S / ATTACHED
 ALUMINUM SIGNS AND RED PAINTED BLAZES.

NOTES

1. THE WEST 1/16 CORNER BETWEEN SECTIONS 21 & 28 WAS SET AT THE PROPORTIONATE DISTANCE BETWEEN THE SECTION CORNER AND THE 1/4 CORNER.
2. THE EAST 1/16 CORNER BETWEEN SECTIONS 20 & 29 WAS SET AT THE PROPORTIONATE DISTANCE BETWEEN THE SECTION CORNER AND THE 1/4 CORNER.
3. DISTANCES ARE TAKEN TO A 50 d. NAIL IN THE CENTER OF EACH BEARING TREE.

REGISTERED
 PROFESSIONAL
 LAND SURVEYOR

Richard J. Hintz

OREGON
 MAY 19, 1900
 RICHARD J. HINTZ
 497

RICHARD J. HINTZ
 1890 N. 14th ST.
 COOS BAY, OREGON

MAP FILE N 95-57

MAP FILE N 95-57