

FILED
RECEIVED
MAY 4 1983
COUNTY SURVEYOR
DOUGLAS COUNTY, ORE

PROFESSIONAL
LAND SURVEYOR
Les Roberts
EUGENE, OREGON
L.D. ROBERTS
1989

WEST 1/4 CORNER
FD. 24" CEDAR STUB, N79°E, 17.2' (NO MARKS), 1894 B.T.
42" CEDAR LINE TREE, NORTH, 31.7' (NO MARKS)
16" DOWNED FIR, N10°W, 26.4' (CUT OPEN AND FOUND SCRIBING "1/4 S", 1894 B.T.)
SET 1/2" x 36" IRON PIPE & BRASS CAP
29" HEMLOCK, N70°E, 47.6' (SCRIBED/SET WASHER)
56" CEDAR, S6°W, 12.2' (SCRIBED/SET WASHER)

S.W. SECTION CORNER
FD. 1975 DOUGLAS COUNTY BRASS CAP
24" MAPLE STUMP, N79°W, 11.0' (NO MARKS), 1894 B.T.
30" CEDAR STUMP, S67°E, 29.7' (NO MARKS), 1894 B.T.
ROOT HOLE, S33°W, 27.7', 1894 B.T.
14" HEM. SNAG, N18°E, 54.5' (SCRIBE VIS.), 1975 C.S.B.T.

N.W. SECTION CORNER
FD. 1966 B.L.M. BRASS CAP
42" FIR SNAG, N24°W, 10.7' (SCAR VIS.), 1894 B.T.
12" FIR SNAG, S18°E, 36.9' (SCAR VIS.), 1966 B.T.
24" DOWNED HEM., S57°W, 72.9' (SCRIBE VIS.), 1966 B.T.
34" CEDAR, N73°E, 26.0' (SCRIBE VIS.), 1966 B.T.

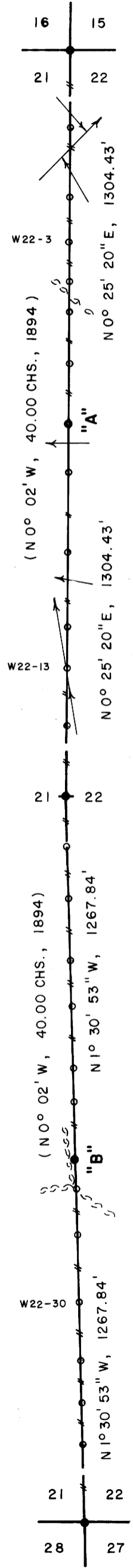

SURVEY OF

WEST LINE SEC. 22, T21S, R9W, W.M.
DOUGLAS COUNTY, OREGON

LOCATION OF 1/2" IRON RODS

N.W. COR.	ROD	BEARING	DISTANCE
W 22-1	SOUTH		274'
W 22-2	SOUTH		515'
W 22-3	SOUTH		671'
W 22-4	SOUTH		803'
W 22-5	SOUTH		912'
W 22-6	SOUTH		1092'
N/16 COR.	SOUTH		1304'
W 22-10	SOUTH		1480'
W 22-11	SOUTH		1755'
W 22-12	SOUTH		2014'
W 22-13	SOUTH		2160'
W 22-14	SOUTH		2359'
W 1/4 COR.	SOUTH		2609'
W 22-18	SOUTH		172'
W 22-19	SOUTH		361'
W 22-20	SOUTH		573'
W 22-21	SOUTH		732'
W 22-22	SOUTH		946'
W 22-23	SOUTH		1067'
S 1/16 COR.	SOUTH		1268'
W 22-26	SOUTH		1369'
W 22-28	SOUTH		1531'
W 22-30	SOUTH		1765'
W 22-32	SOUTH		1972'
W 22-33	SOUTH		2115'
W 22-34	SOUTH		2259'
S.W. COR.	SOUTH		2536'

LEGEND

- CORNERS FOUND AND USED FOR CONTROL
- CORNERS SET, 1 1/2" x 36" IRON PIPES WITH BRASS CAPS.
- CAPS STAMPED S-T-R, DATE AND P.L.S. NO. 1039.
- +— LINES MARKED WITH RED PAINTED BLAZES, 1/2" x 60" IRON RODS AND RED RIBBON. A YELLOW PROPERTY LINE SIGN, WITH P.L.S. NO. 1039 STAMPED UPON, IS ATTACHED TO EACH ROD.
- () DATA OF RECORD, 1894 G.L.O. SURVEY
- BASIS OF BEARING, SOLAR OBSERVATION
- DISTANCE TO BEARING TREES ARE CENTER MEASURE
- ALL NEW BEARING TREES ARE SCRIBED AND HAVE A BRASS WASHER STAMPED "P.L.S. 1039" NAILED TO LOWER BLAZE.
- SCALE 1" = 400'

NARRATIVE

I, LES ROBERTS, REGISTERED PROFESSIONAL LAND SURVEYOR DO CERTIFY THAT I HAVE CORRECTLY SURVEYED THE WEST LINE OF SECTION 22 IN ACCORDANCE TO THE 1973 MANUAL OF INSTRUCTIONS FOR THE SURVEY OF THE PUBLIC LANDS OF THE UNITED STATES. THE NORTH 1/16 CORNER BETWEEN SECTIONS 21 AND 22 WAS SET HALFWAY BETWEEN THE WEST 1/4 CORNER AND THE N.W. CORNER OF SECTION 22. THE SOUTH 1/16 CORNER BETWEEN SECTIONS 21 AND 22 WAS SET HALFWAY BETWEEN THE WEST 1/4 CORNER AND THE S.W. CORNER OF SECTION 22. A CLOSED MEANDER TRANSIT AND E. D.M. TRAVERSE WAS RUN BETWEEN ALL FOUND CORNERS AND USED FOR CONTROL. A CLOSED MEANDER TRANSIT AND CHAIN TRAVERSE WAS RUN ALONG ALL BLAZED AND POSTED PROPERTY LINES AS SHOWN. OFFSETS WERE COMPUTED FROM THIS MEANDER TRAVERSE TO THE TRUE PROPERTY LINE.

COUNTY SURVEYORS FILE DATA
DO NOT REMOVE FROM OFFICE

BY

ROBERTS SURVEYING INC.

29 WEST 29TH STREET

EUGENE, OREGON 97405

MARCH 10, 1983

MAP FILE M 94-4