

MAJOR LAND PARTITION
OF
Parcel 8, Romine Tracts
In the NW $\frac{1}{4}$, Section 20, T. 26 S., R 3 W., W.M.
May 1982 Scale: 1"= 100'

COUNTY SURVEYORS FILE DATA
DO NOT REMOVE FROM OFFICE

OWNER AND PARTITIONER

Gerald Rust
P.O. Box 91
Glide, Oregon 97443 496-3329

Number of Parcels - 2
Water Supply - Glide Water Association
Sewer - Glide-Idleyld Sewer District (Parcel 2 only)

By: Baughman Technical Service, Inc.
P.O. Box 222
Roseburg, Oregon 97470 673-0966

FILED *BS*
RECEIVED *RWS*

JUL 26 1982

COUNTY SURVEYORS
DOUGLAS COUNTY

BS

DESCRIPTIONS

Parcel 1 Beginning at a 5/8 inch iron rod from which a 2 inch iron pipe at the Section corner common to Sections 17, 18, 19, and 20, T. 26 S., R. 3 W., W.M. bears N 63° 17' 49" W, 1669.15 feet, thence S 60° 18' 40" W, 135.92 feet to a 5/8 inch iron rod, thence N 88° 25' 57" W, 219.71 feet to a 7/8 inch iron rod, thence S 1° 28' 30" W, 231.60 feet to a 5/8 inch iron rod, thence S 88° 31' 30" E, 527.83 feet to a 5/8 inch iron rod, thence N 30° 58' 56" W, 357.41 feet to the point of beginning. The parcel described contains 2.54 acres more or less in the NW $\frac{1}{4}$ of Section 20, T. 26 S., R. 3 W., W.M., Douglas County, Oregon and is subject to that certain easement described in Instrument No. 77-0219, Deed Records of Douglas County.

Parcel 2. Beginning at a 5/8 inch iron rod from which a 2 inch iron pipe at the Section corner common to Sections 17, 18, 19, and 20. T. 26 S., R. 3 W., W.M. bears N 63° 17' 49" W, 1669.15 feet, thence S 30° 58' 56" E, 357.41 feet to a 5/8 inch iron rod, thence S 88° 31' 30" E, 42.00 feet to a 5/8 inch iron rod, thence N 70° 48' 30" E, 164.00 feet to a 7/8 inch iron rod, thence N 1° 26' 32" E, 313.23 feet to a 5/8 inch iron rod, thence N 88° 35' 04" W, 272.60 feet to a 7/8 inch iron rod, thence S 60° 18' 40" W, 133.80 feet to the point of beginning. The parcel described contains 2.44 acres more or less in the NW $\frac{1}{4}$ of Section 20, T. 26 S., R 3 W., W.M., Douglas County, Oregon, together with a non exclusive easement 25 feet in width, 12.5 feet on either side of the following described center line: Beginning at a 2 inch iron pipe on the Westerly right of way line of Terrace Drive from which the Section corner common to Sections 17, 18, 19 and 20, T. 26 S., R. 3 W., W.M. bears N 70° 14' 13" W, 2944.27 feet, thence N 88° 31' 30" W, 815.50 feet to a 7/8 inch iron rod, thence S 70° 48' 30" W, 88.54 feet to a 7/8 inch iron rod.

NARRATIVE

The survey was performed to divide a parcel of land into two parcels for the purpose of providing a building site. The survey was based upon a parcelization of the Romine property as recorded on RM 1-58. The basis of bearings was taken from the South line of parcel 9 of that survey. Monuments were found as noted. The work was performed by Lester Fanning using a Wild T-1A, HP 3805 and 300 foot steel tape.

Keith D. Cubic
PLANNING COMMISSION

7/19/82
DATE

Larry E. Mannon DEPUTY
COUNTY SURVEYOR

7-26-82
DATE

STATE OF OREGON)
COUNTY OF DOUGLAS) SS.

I, DORIS L. WADSWORTH, COUNTY CLERK
AND RECORDER OF CONVEYANCES, IN AND FOR
SAID COUNTY, DO HEREBY CERTIFY THAT THE
WITHIN INSTRUMENT WAS RECORDED THIS DAY:

1982 JUL 27 AM 10:01

DORIS L. WADSWORTH
DOUGLAS COUNTY CLERK

BY *Maryel Seal*
DEPUTY
No. _____ FEE *6.00*

DOUGLAS COUNTY OFFICIAL RECORDS

REGISTERED
PROFESSIONAL
LAND SURVEYOR

George E. Grube
OREGON
NEW 10, 1967
GEORGE E. GRUBE
397

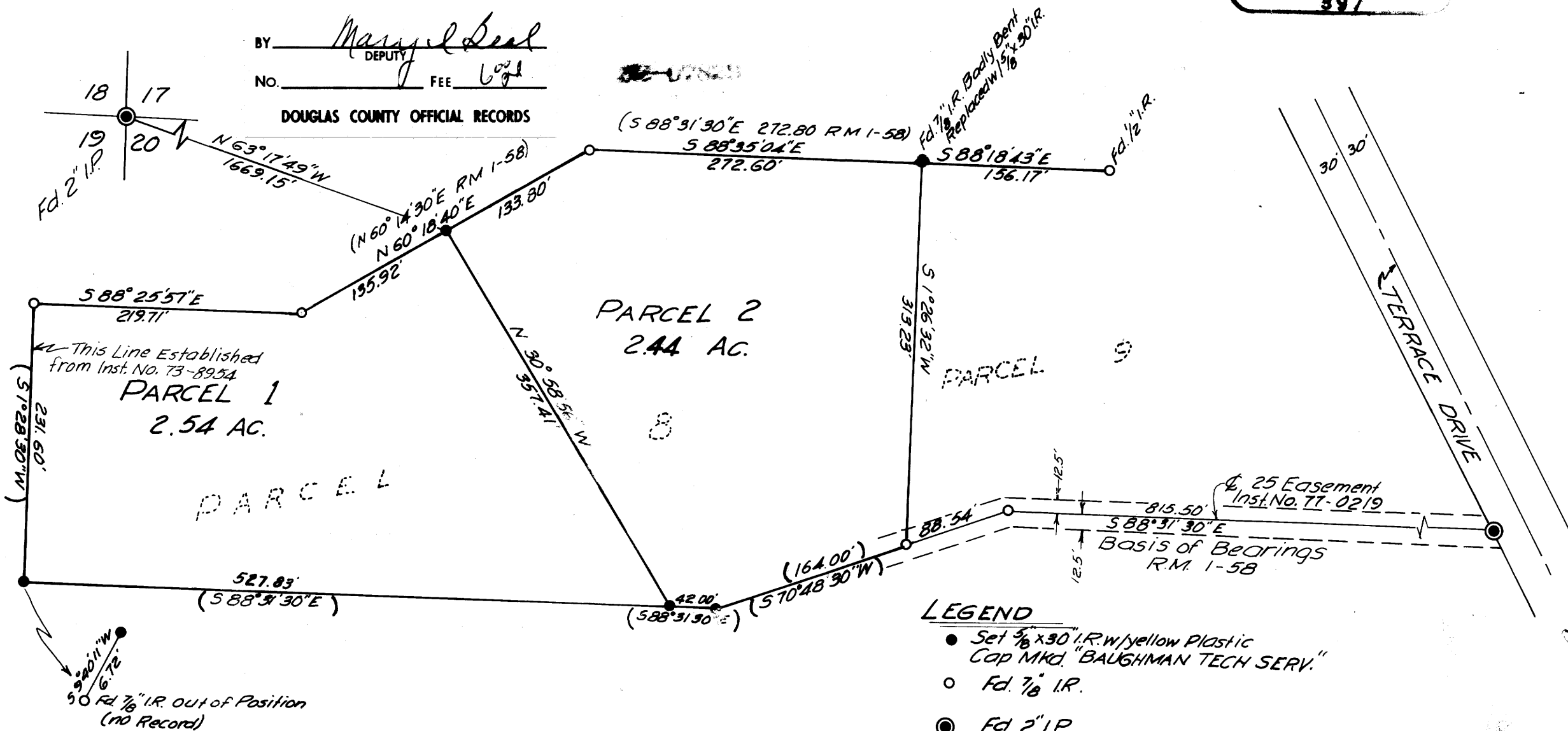

LEGEND

- Set $\frac{3}{8}$ x 30 I.R./yellow Plastic Cap MKD. "BAUGHMAN TECH SERV."
- Fd. $\frac{7}{8}$ I.R.
- ⊙ Fd. 2" I.P.