

MAP FILE M.91-73

NARRATIVE

I, LES ROBERTS, REGISTERED PROFESSIONAL LAND SURVEYOR DO CERTIFY THAT I HAVE CORRECTLY SURVEYED THE SOUTH BOUNDARY OF SECTION 18 IN ACCORDANCE TO THE MANUAL OF INSTRUCTION FOR THE SURVEY OF THE PUBLIC LANDS OF THE UNITED STATES. THE S.E. CORNER OF SECTION 18 WAS RE-SET FROM 2 EXISTING CEDAR B.T.'S. IN ORDER TO GET THE BEARINGS TO MATCH THE ORIGINAL 1891 NOTES, SLOPE DISTANCE RATHER THAN HORIZONTAL DISTANCE WAS USED TO RE-SET THIS CORNER. NO MARKS COULD BE FOUND ON THE EXISTING CEDARS. THE ORIGINAL 1891 NOTES CALL FOR A SLIDE BOTTOM 50' NORTH, A CREEK 55' EAST, AND A HOLLOW 198' WEST OF SAID S.E. CORNER. MY DISTANCES FROM THE NEWLY RE-SET S.E. CORNER TO THE ABOVE MENTIONED CREEKS ARE 53' NORTH, 60' EAST AND 204' WEST RESPECTIVELY. FROM THESE CREEK TIES I CONCLUDE THAT THE 2 EXISTING CEDARS I FOUND TO ACTUALLY BE ORIGINAL 1891 B.T.'S EVEN THOUGH NO VISIBLE SCRIBE MARKS COULD BE FOUND. THE EAST 1/16 CORNER BETWEEN SECTIONS 18 AND 19 WAS SET HALFWAY BETWEEN THE SOUTH 1/4 CORNER AND THE S.E. CORNER OF SECTION 18. THE WEST 1/16 CORNER AND THE WEST 1/16-80 CORNER BETWEEN SECTIONS 18 AND 19 WERE SET BY PROPORTIONATE MEASURE BETWEEN THE SOUTH 1/4 CORNER AND THE S.W. CORNER OF SECTION 18. A CLOSED MEANDER TRANSIT AND CHAIN TRAVERSE WAS RUN BETWEEN ALL FOUND CORNERS ALONG THE SOUTH BOUNDARY OF SECTION 18. OFFSETS WERE COMPUTED FROM THIS MEANDER TRAVERSE TO THE TRUE PROPERTY LINE.

LOCATION OF 1/2" IRON RODS

S.E. SEC. COR.		S 1/4 COR.			
S18-3	64'	WEST	S18-20	169'	WEST
S18-4	327'	WEST	S18-21	412'	WEST
S18-5	445'	WEST	S18-22	629'	WEST
S18-6	636'	WEST	S18-23	783'	WEST
S18-7	774'	WEST	S18-25	1055'	WEST
S18-8	994'	WEST	S18-27	1155'	WEST
S18-10	1141'	WEST	W 1/16 COR.	1310'	WEST
E 1/16 COR	1338'	WEST	S18-31	1485'	WEST
S18-12	1513'	WEST	S18-32	1727'	WEST
S18-14	1743'	WEST	S18-34	1962'	WEST
S18-15	1896'	WEST	S18-36	2064'	WEST
S18-16	2023'	WEST	S18-37	2285'	WEST
S18-18	2276'	WEST	S18-38	2465'	WEST
S18-19	2488'	WEST	W 1/16 (80) COR.	2620'	WEST
S 1/4 COR.	2677'	WEST	S18-41	2889'	WEST
			S18-43	3089'	WEST
			S18-45	3264'	WEST
			S18-46	3381'	WEST
			S18-47	3560'	WEST
			S18-48	3645'	WEST
			S.W. SEC. COR.	3733'	WEST

SURVEY OF
SECTION 18, T19S, R8W, W.M.
DOUGLAS COUNTY, OREGON
FOR
INTERNATIONAL PAPER COMPANY
BY
ROBERTS SURVEYING INC.
29 WEST 29TH STREET
EUGENE, OREGON 97405
MARCH 21, 1982

"A" EAST 1/16 CORNER

SET 1 1/2" x 36" IRON PIPE & BRASS CAP
17" MAPLE, N 24° E, 32.7' (SCRIBED)
20" FIR, S 35° E, 73.4' (SCRIBED)

"B" WEST 1/16 CORNER

SET 1 1/2" x 36" IRON PIPE & BRASS CAP
53" FIR, S 7° E, 14.3' (SCRIBED)
60" FIR, N 21° W, 23.8' (SCRIBED)

"C" WEST 1/16-80 CORNER

SET 1 1/2" x 36" IRON PIPE & BRASS CAP
18" FIR, S 32° E, 20.0' (SCRIBED)
24" FIR, N 46° E, 28.0' (SCRIBED)

LEGEND

- CORNERS FOUND AND USED FOR CONTROL
- CORNERS SET, ALL CORNERS ARE 1 1/2" x 36" IRON PIPES & BRASS CAPS STAMPED S-T-R, DATE & P.L.S. NO. *1039 5/11/82 # MOVED*
- LINE MARKED WITH RED PAINTED BLAZES, 1/2" x 60" IRON RODS AND RED RIBBON (A YELLOW PROPERTY LINE SIGN, WITH P.L.S. NO. STAMPED UPON, IS ATTACHED TO EACH ROD)
- () DATA OF RECORD, 1891
- BASIS OF BEARING, WEST 1/2 OF SOUTH LINE OF SECTION 18 FROM 1891 G.L.O. SURVEY
- DISTANCE TO BEARING TREES ARE CENTER MEASURE
- ALL BEARING TREES ARE SCRIBED
- SCALE, 1" = 400'

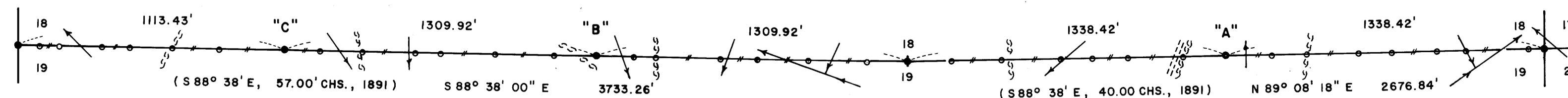

S.W. SECTION CORNER

FD. 1957 B.L.M. BRASS CAP
26" CEDAR STUB, S 56 1/2° E, 19.3' (SCRIBE VIS.), 1891 B.T.

SOUTH 1/4 CORNER

FD. 1980 B.L.M. BRASS CAP, NOT OF RECORD
48" FIR, N 77° W, 24.1' (SCRIBE VIS.), 1891 B.T.
62" FIR, S 77° E, 23.3' (SCRIBE VIS.), 1891 B.T.
NOTE, SURVEY M57-31 SHOWS A 3/4" IRON ROD
SET. FOUND NO EVIDENCE OF ROD.

S.E. SECTION CORNER

FD. 48" CEDAR SNAG, N 66° W, 39.6' (NO MARKS), 1891 B.T.
50" CEDAR, S 87° W, 40.3' (NO MARKS), 1891 B.T.
NOTE, SLOPE DISTANCE USED TO RE-SET CORNER
SET 1 1/2" x 36" IRON PIPE & BRASS CAP
(4" x 4" x 36" SQUARED POST BEARS N 4° E, 6.0')

Les Roberts

MAP FILE M.91-73