

Found a 48" Fir Snag, blazed, marking 1/4 cor. from which a 1" iron pipe, 2 1/2" brass cap bears S20°W, 2.2 feet marked

a 40" Fir stump bears N74°W, 20.5 feet, blazed
a 10" Fir sawed stump bears N29°W, 34.6 feet, blazed
a 16" Fir bears S55°E, 13.0 feet, blazed

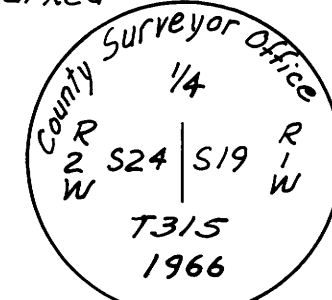

Found 2" iron pipe / 3" brass cap marked

7315 R1W
C14 + S19
PLS 944
1978

from which:
a 8" cedar bears N66°W, 63.0 feet, scribed
a 14" Fir bears N22°E, 19.6 feet, scribed

MAP OF SURVEY FOR RICHARD L. BONNEY

the SW 1/4 of Section 19, T.31S., R.1W., W.M.

Scale: 1"=100' April 15, 1983

Legend

- Found monument as noted
- ⊙ Set 5/8" x 30" rebar with red cap marked LS 601
- Computed position
- P-K Nail set in centerline
- *** Fence-line
- () Record data
- [] USFS R/W DATA

Found a 5/8" rebar
1 1/2" Aluminum cap
marked

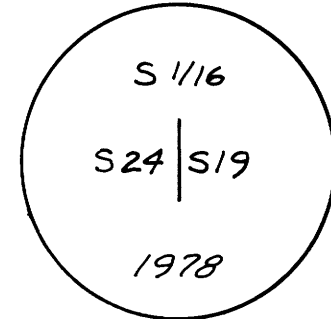

from which:
a 15" Ash bears S6 1/2°E, 36.9 feet, blazed & healed
a 16" Yew bears S36 1/2°W, 19.4 feet, blazed & healed

Found a 1 1/4" iron pipe
2 1/2" Douglas County Cap
marked

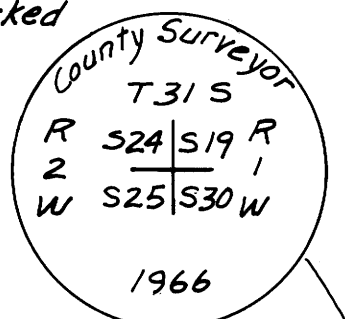

from which:
a 14" snag bears N05°E, 13.5 feet, scribed BT
a 14" D-F bears N19°E, 28.0 feet, blazed & healed
a 24" D-F bears S89 1/2°E, 91.4 feet, barked scribed
a 14" D-F bears S76°E, 9.2 feet, blazed & healed
a 12" D-F bears S42°W, 18.6 feet, blazed & healed
a 13" D-F bears S49°W, 30.3 feet, blazed & healed
a 12" D-F bears N79°W, 7.4 feet, scribed
a 11" D-F bears N67°W, 23.3 feet, blazed & healed
a Windfall bears N60°W, 4.0 feet, scribed BT

Narrative

Purpose: This survey done at the request of Richard Bonney & Gilbert Bonney, adjacent landowners, in the NW 1/4 of the SW 1/4, Section 19, for a parcel line adjustment & to describe & monument the 5.82 acre parcel.

Equipment: Wild T-16 and Wild D14 Distomat

Procedure: The bearings are based on M 70-23, filed June 29, 1978, Douglas County Surveyor's Office -- the bearing base is between the West 1/4 and Center 1/4 corners of Section 19. The parcel was surveyed and monumented as shown on map.

Date: April 15, 1983

Survey by: Chickering - Green Empire Inc.
360 S.E. "H" Street
Grants Pass, Oregon 97526 (503-474-2035)
Malcolm N. Clark, RPLS 601 Oregon

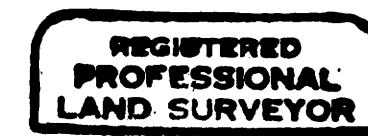

S89°13'31"W 2611.53' (M42-74 N89°11'57"E 2612.65')