

Map File M84-6
 S. S. File 58/143N

**COUNTY SURVEYORS FILE DATA
 DO NOT REMOVE FROM OFFICE**

Survey in **Section 30, T.32 S., R.2 W., W.M.**

For the U.S. DEPARTMENT OF AGRICULTURE, UMPQUA NATIONAL FOREST

Contract No. 53 04HI 0 7669 N, Tiller Land Survey No. 38,

May, 1980

FILED
 RECEIVED
 JUN 18 1980

COUNTY SURVEYOR
 DOUGLAS COUNTY, ORE.

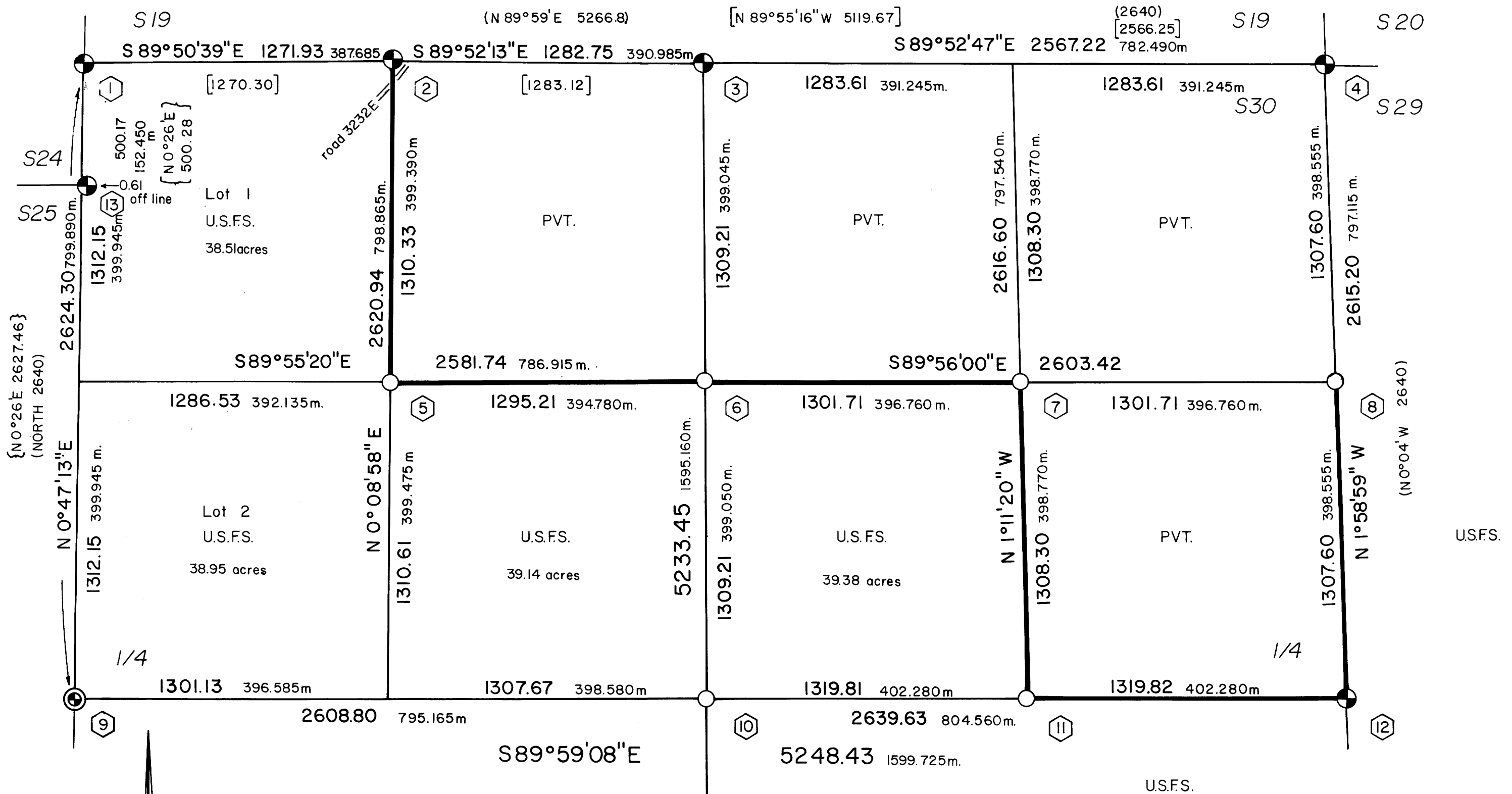

I, William J. Ruppert, a registered land surveyor in the State of Oregon, hereby certify that this plat and the notes hereon or attached are a correct representation of a survey I performed during May of 1980 for the U.S. Forest Service in accordance with the statutes of the State of Oregon and with the Articles of my contract.

William J. Ruppert
 Registered Land Surveyor
 Oregon License 866

LEGEND & HISTORY

- ⊕ Fd. monumented corner
- ⊙ Fd. corner, set monument
- Established corner, set monument
- ⬡ Description of corner stated in narrative
- Line marked by 6' orange fiberglass posts with USFS sign no. 54-2
- () Record course per G.L.O. plat of T.32S., R.2W., W.M. dated Dec. 11, 1903
- [] Record course per M 38-38 G. Baughman, July 1969
- { } Record course per G.L.O. plat of T.32S., R.3W., W.M. dated Oct. 15, 1914

UMPQUA SURVEYING
 COMPANY

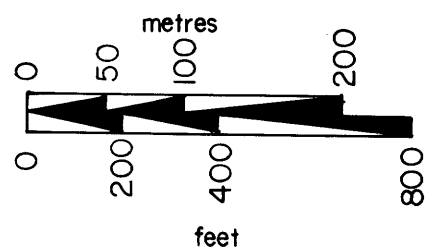

SCALE: 1" = 400' = 121.920m.

Bearings based upon solar observation

58/143N
 M84-6

M 84-6

UMPQUA SURVEYING COMPANY

P. O. Box 791
Myrtle Creek, Oregon 97457
Page 1 of 5.

626 N.E. Division Street
Telephone (503) 863-5201

FILED ✓
RECEIVED ✓
JUN 18 1980
COUNTY SURVEYOR
DOUGLAS COUNTY OREGON

SURVEY NARRATIVE

May 1980

- LOCATION: SECTION 30, TOWNSHIP 32 SOUTH, RANGE 2 WEST, WILLAMETTE MERIDIAN
- PURPOSE: TO SUBDIVIDE SECTION 30 & MARK LINES AS SHOWN ON THE SURVEY PLAT.
- EVIDENCE: FOUND CORNER MONUMENTS AND EVIDENCE AS DESCRIBED BELOW.
- CONCLUSIONS: ACCEPTED ORIGINAL CORNERS FROM EVIDENCE SHOWN BELOW. ACCEPTED PROPORTIONED CORNERS SET PER M38-38 AS BEING WITHIN ACCEPTABLE LIMITS OF PROPORTIONED POSITIONS, AFTER SEARCHING AGAIN FOR EVIDENCE OF ORIGINAL CORNERS.
- EQUIPMENT: LEITZ T60D THEODOLITES, BEETLE & MAC EDM EQUIPMENT

DESCRIPTIONS OF CORNERS NUMBERED ON SURVEY PLAT SEC. 30 T32S, R2W

1. FOUND: 2" galvanized iron pipe with 3" Brass Cap marked as shown
- 34" D. Fir N48°-54' E 5.4 ft old scribing visible in old cut. New scribing visible "T32S R2W S19 BT"
 - 23" D. Fir S36°-06' E 23.1 ft Good scars
 - 17" Snag S6°-06' E 5.0 ft Rotten
 - 32" D. Fir S76°-54' W 19.2 ft Good scar near base
 - 31" D. Fir N74°-06' W 28.7 ft No scar

2. FOUND: 2" galvanized iron pipe with 3" Brass Cap marked as shown
- 15" Hemlock N66°-22' W 41.3 ft "1/16 S19 BT" visible
 - 21" Hemlock S46°-00' W 31.8 ft "1/16 S30 BT" visible

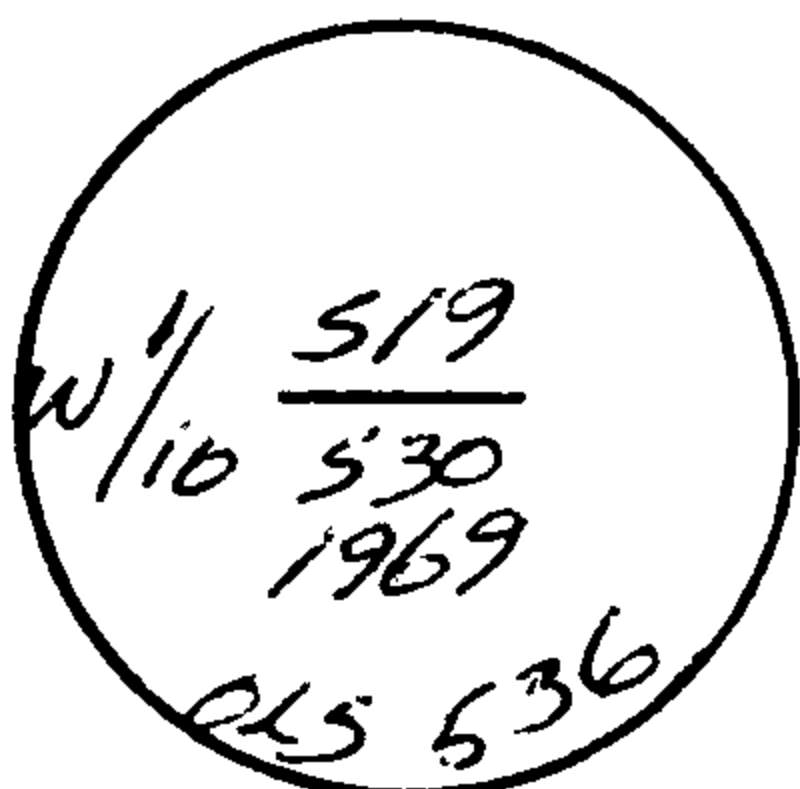
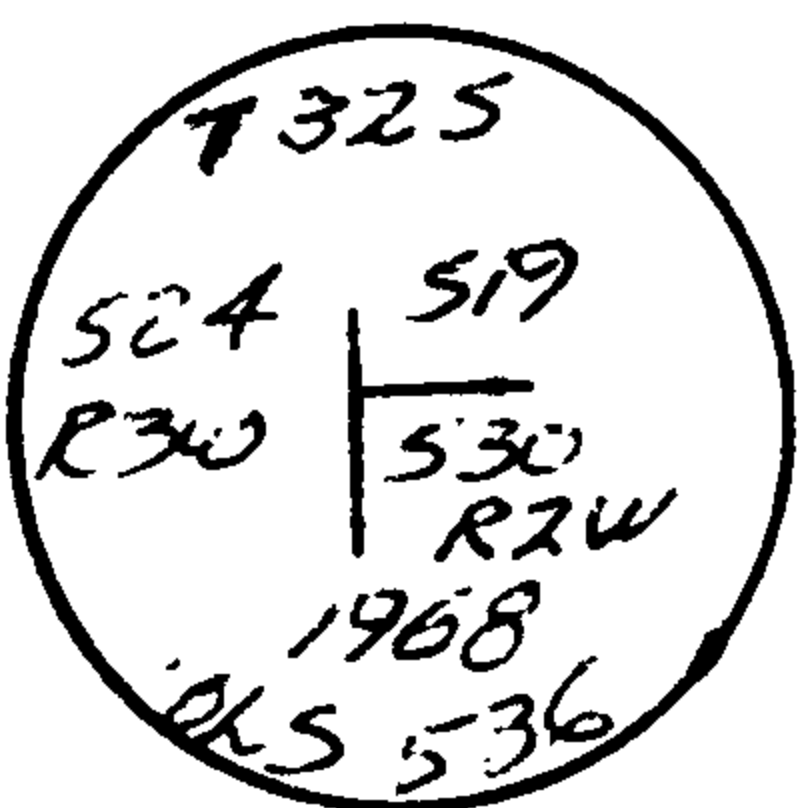

REGISTERED
OREGON
LAND SURVEYOR

JULY 12, 1968
WILLIAM J. RUPPERT
866

3. FOUND: 3" Brass Cap marked as shown on 2" galvanized iron pipe

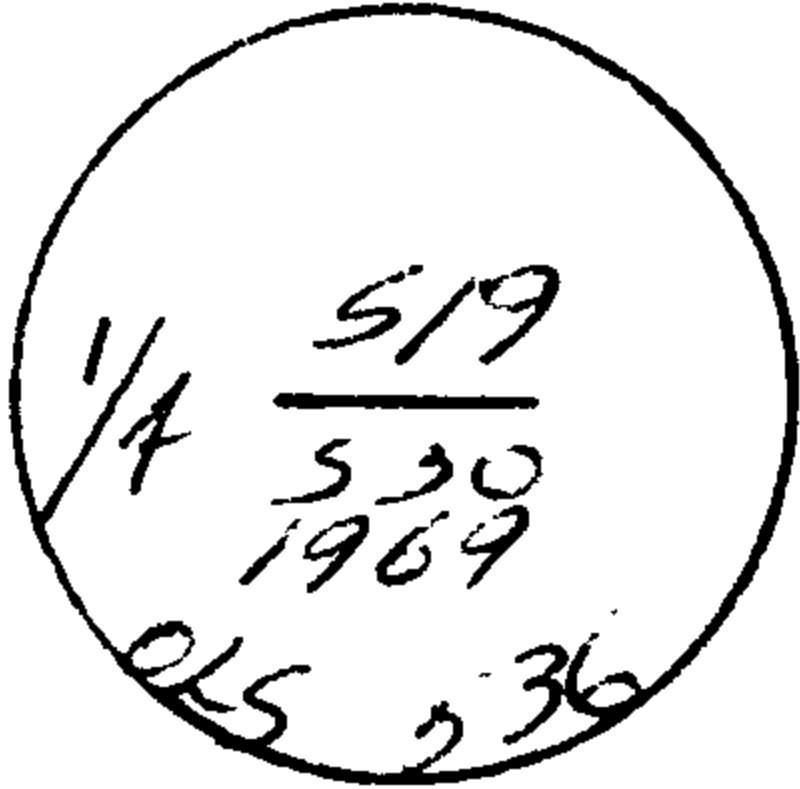

13" W. Fir N6⁰-33' E 11.9 ft "1/4 S" visible

12" Yew S50⁰-07' E 4.9 ft "1/4 S30 BT" visible

4. FOUND: 2" galvanized iron pipe with 3" Brass cap marked as shown.
Original stone is in mound around cap.

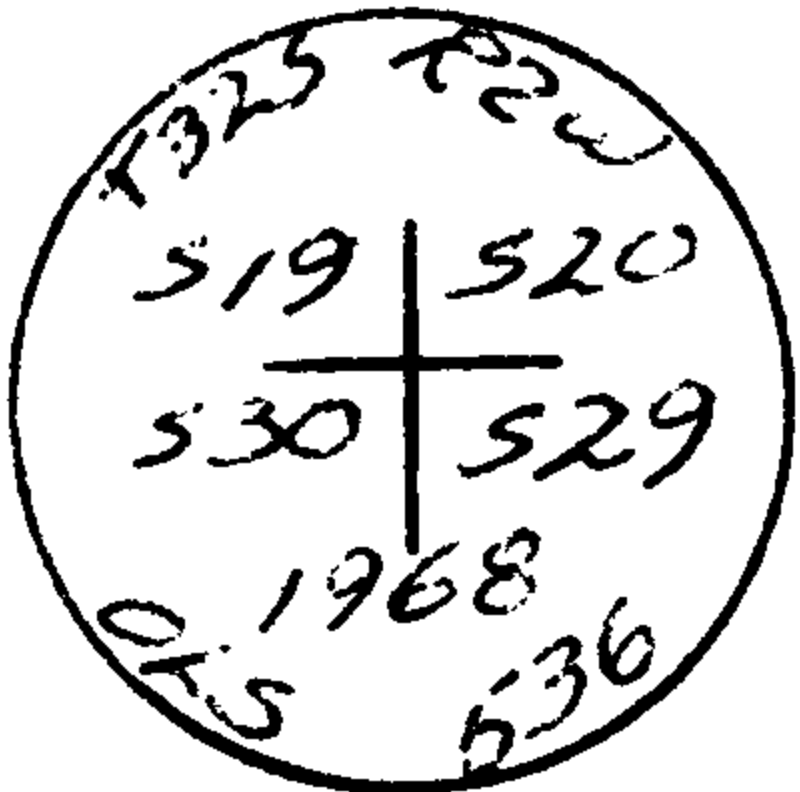

22" snag S14⁰-43' E 42.35 "T32S R2W S29 BT" visible
"X" in bark.

53" D. Fir N70⁰-00' E 31.3 ft "T32S R2W S20 BT" visible.

28" Hemlock N6⁰-10' W 27.7 ft "W" visible

36" Uproot S17⁰-35' W 18.0 ft "T32S R2W S30 BT" visible

NEW BT: 11" Yew S31⁰-40' E 32.0 ft "T32S R2W S29 BT"

6" Madrone S6⁰-52' W 5.5 ft "T32S R2W S30 BT"

Attached 3/4" Brass washer marked "LS 866" to lower blaze of each new BT.

5. SET: 2" x 30" aluminum pipe with 2 1/2" magnetized aluminum cap marked as shown.

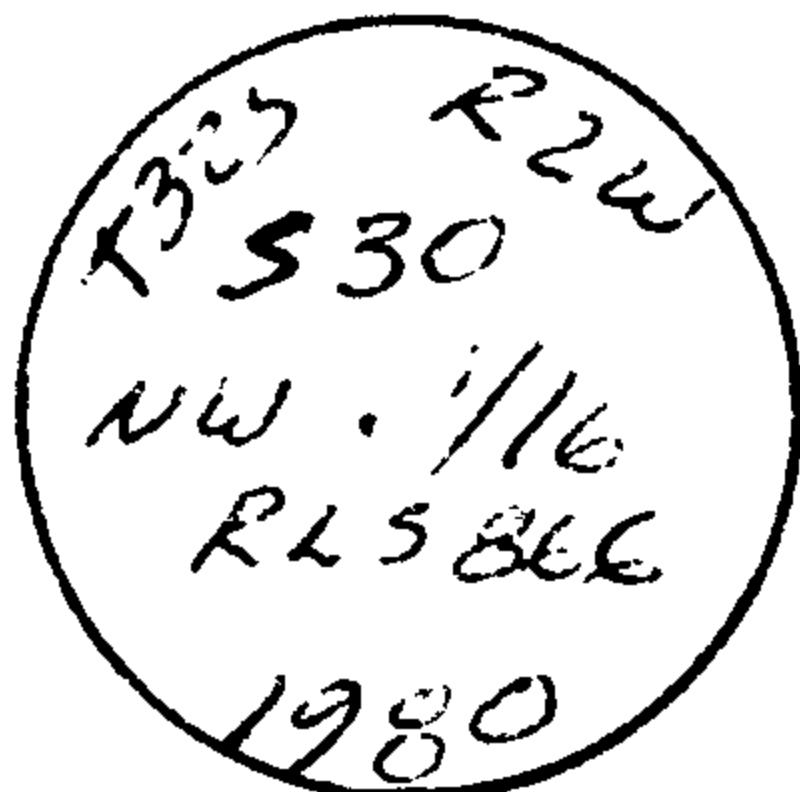

Built cairn around cap.

NEW BT: 21" W. Fir S28⁰-34' E 16.3 ft "NW1/16 S30 BT"

8" W. Fir S57⁰-15' W 38.7 ft "NW1/16 S30 BT"

Attached 3/4" Brass washer marked "LS 866" to lower blaze of each new BT.

6. SET: 2" x 30" aluminum pipe 26" into ground with 2 1/2" magnetized aluminum cap marked as shown.

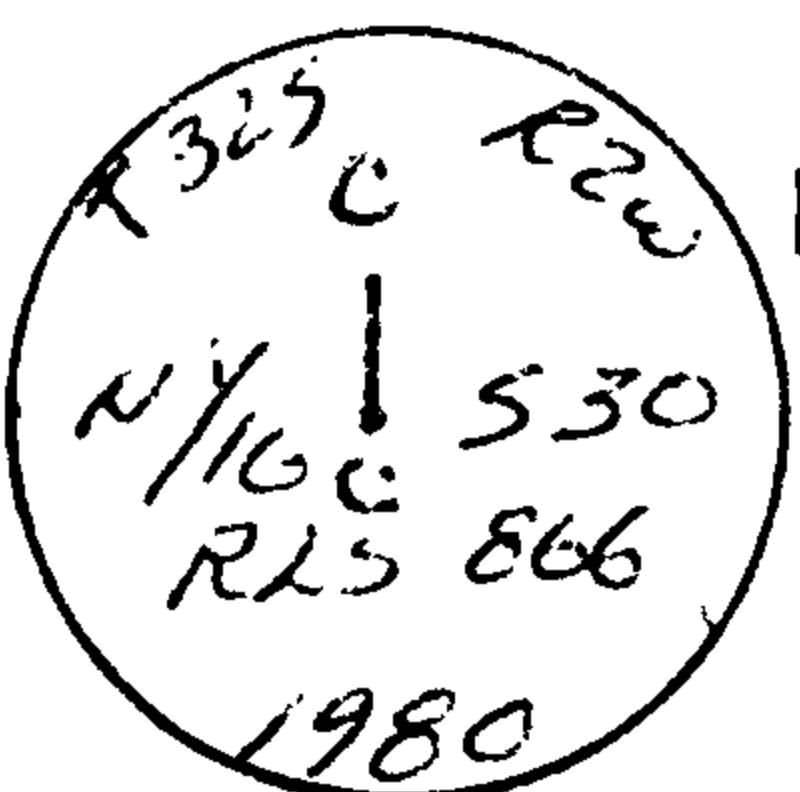

Built cairn around cap.

NEW BT: 24" D. Fir N74⁰-23' W 15.0 ft "CN1/16 S30 BT"

18" D. Fir S34⁰-03' E 18.3 ft "CN1/16 S30 BT"

Attached 3/4" Brass washer marked "LS 866" to lower blaze of each new BT.

7. SET: 2" x 30" aluminum pipe with 2½" aluminum cap marked as shown.
Built cairn to cap

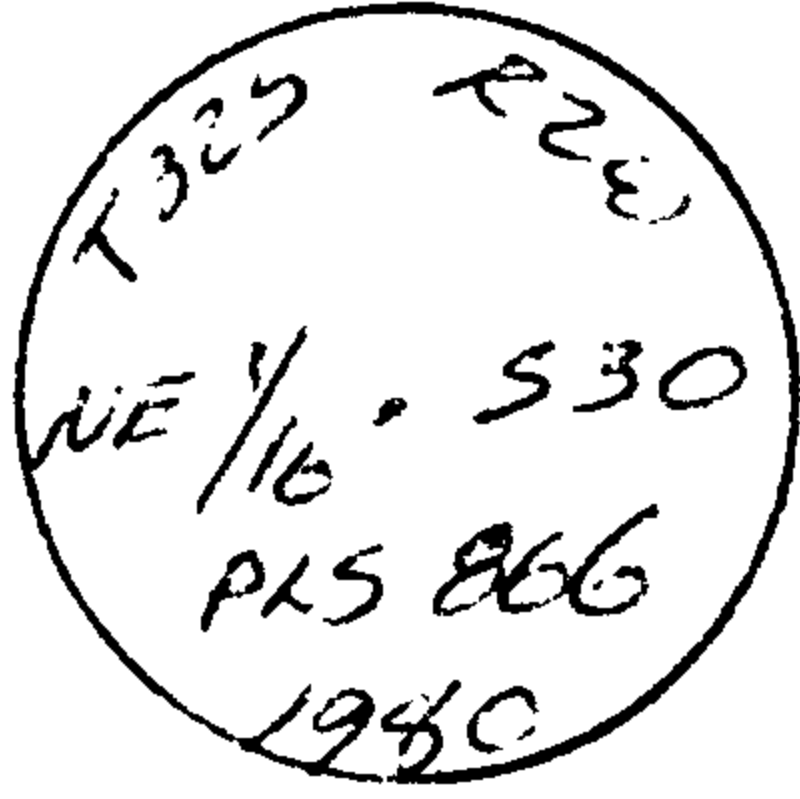

NEW BT: 8" W. Fir S72°-14' W 17.8 ft "NE1/16 S30 BT".

10" W. Fir S1°-04' W 26.8 ft "NE1/16 S30 BT".

Attached 3/4" Brass washer marked "LS 866" to lower blaze of each new BT.

-
8. SET: 2" x 30" aluminum pipe with 2½" magnetized aluminum cap marked as shown.



Built cairn to cap.

NEW BT: 10" Pine S0°-20' W 28.4 ft "N1/16 S30 BT"

12" D. Fir S53°-40' E 47.8 ft "N1/16 S29 BT"

Set 6' fiberglass post with signs 54-2, 54-9 4' east

Attached 3/4" Brass washer marked "LS 866" to lower blaze of each new BT.

-
9. FOUND: Original 12" x 12" x 12" stone, loosley set & broken in two, no marks.

16" Madrone N3°-06' E 27.3 ft Hollow

50" snag S15°-36' W 47.9 ft. Good scar

SET: 2" x 30" galvanized iron pipe with 2½" brass cap marked as shown, at location of stone.

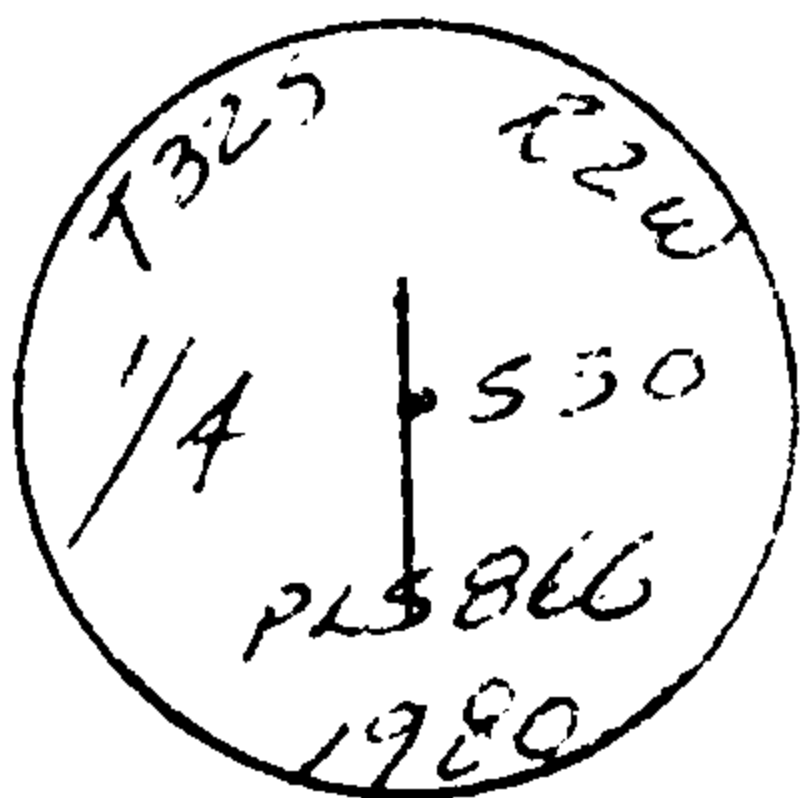

#118
T32-2
#199 T32-3

9. NEW BT: 6" Chinquapin S47⁰-04' E 31.3 ft. Scribed "1/4 S30 BT"
cont.
7" D. Fir N14⁰-46' E 70.7 ft. Scribed "1/4 S30 BT"

Attached 3/4" Brass washer marked "LS 866" to lower blaze of each new BT.

10. SET: 2" x 30" aluminum pipe with 2 1/2" aluminum cap marked as shown.

Built cairn to cap.

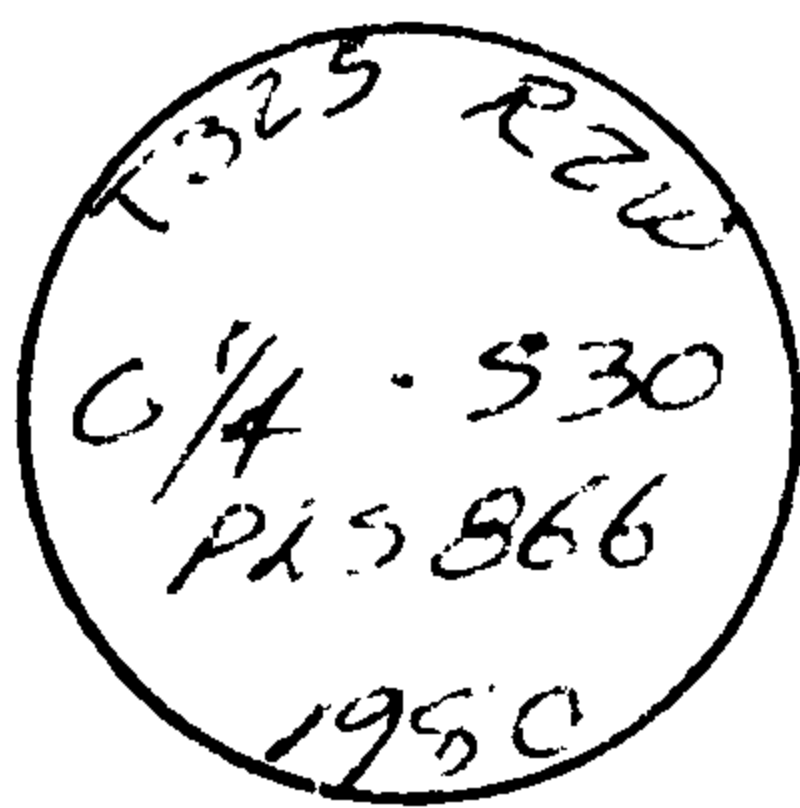

NEW BT: 8" Hemlock S12⁰-35' W 11.9 ft "C1/4 S30 BT"

13" Hemlock N33⁰-51' E 19.1 ft "C1/4 S30 BT"

Attached 3/4" Brass washer marked "LS 866" to lower blaze of each new BT.

11. SET: 2" x 30" aluminum pipe 28" into ground with 2 1/2" magnetized aluminum cap marked as shown.

Built cairn to cap

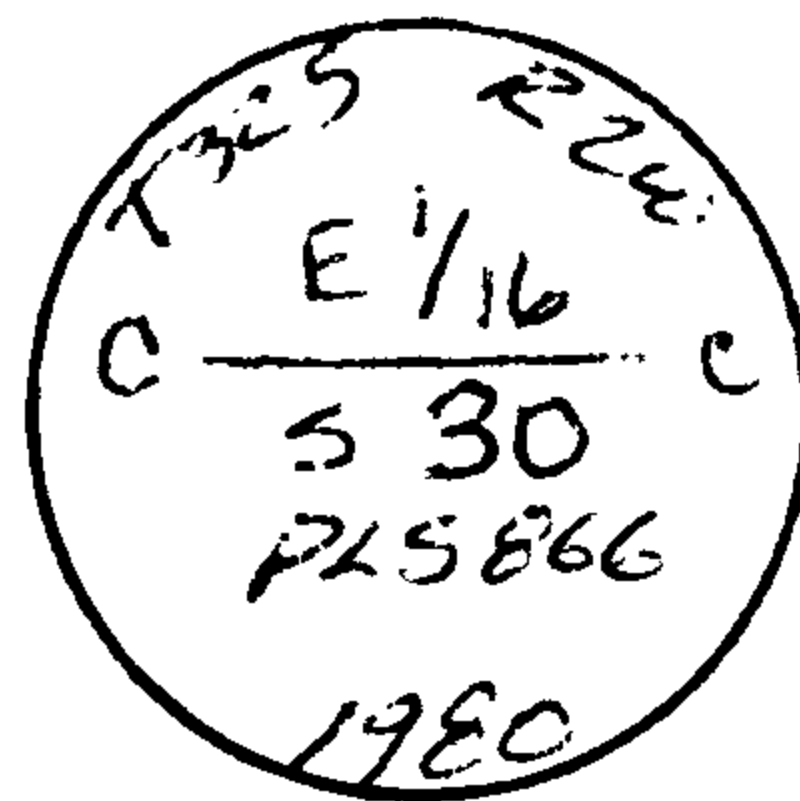

NEW BT: 10" D. Fir S74⁰-48' E 24.8 ft "CE1/16 S30 BT"

12" Pine S4⁰-45' E 23.8 ft "CE1/16 S30 BT"

Attached 3/4" Brass washer marked "LS 866" to lower blaze of each new BT.

12. FOUND: 1" galvanized iron pipe with 2 1/2" brass cap marked as shown

42" Snag S51⁰-54' W 29.3 ft "S30 BT" on old face

34" D. Fir N66⁰-06' W 36.9 ft "1/4 S30 CS BT" visible

12" D. Fir N9⁰-54' E 22.4 ft "1/4 S29 BT" visible

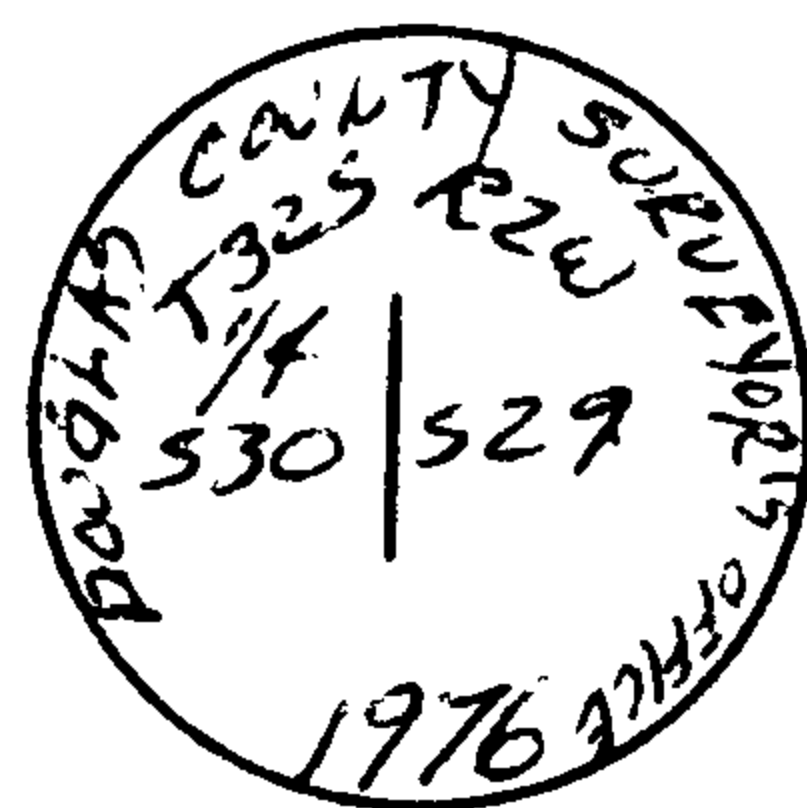

13. FOUND: 2" galvanized iron pipe with 3" Brass cap marked as shown.

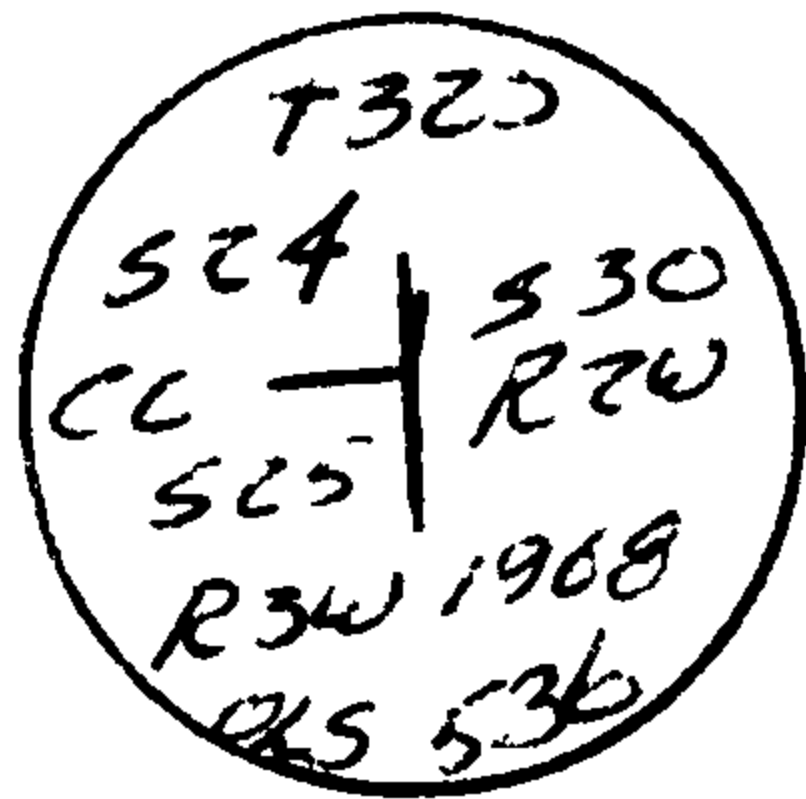

25" D. Fir N59⁰-36' W 29.4 ft healing scar

23" Sugar Pine S83⁰-24' W 16.5 ft "32S R3W S25 BT" newly scribed.

14. FOUND: 54" D. Fir N57⁰-15' W 12.8 ft. Good scar (60⁰ magnetic)

34" Snag S18⁰-57' W 23.4 ft "1/4" visible

SET: 2" x 30" aluminum pipe with 2 1/2" aluminum cap at record magnetic bearing & distance from closer bearing tree.

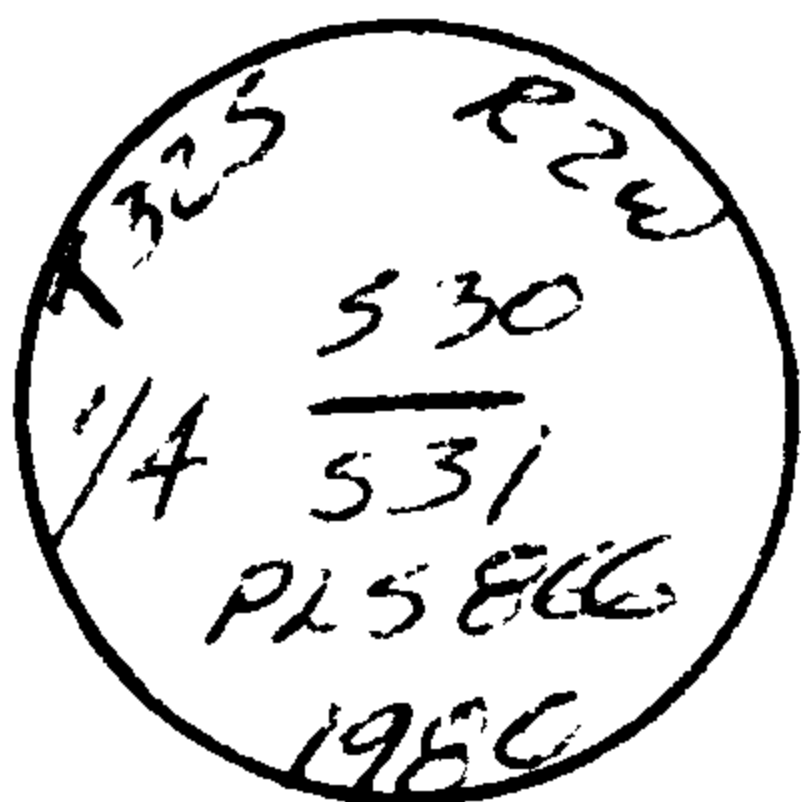

Cap marked as shown.

Record & bearings from original survey do not result in single intersection.

Built mound of stones around pipe.

NEW BT: 8" Hemlock S 25⁰-55' W 40.4 ft "1/4 S31 BT"

Attached 3/4" Brass washer marked "LS 866" to lower blaze of new BT.

#117