

# SURVEY for JACK PICKETT

FILED &  
RECEIVED *VP*

JUL 17 1980

COUNTY SURVEYOR  
DOUGLAS COUNTY, ORE

N.E. COR. WM. PRESTON D.L.C. #62  
TOWNSHIP 30 SOUTH, RANGE 5 WEST  
WILLAMETTE MERIDIAN

FOUND: 1/2" IRON PIPE AT COR. 6" DEEP  
33" W. OAK N6°-44'E 142.1', GOOD SCARS  
22" W. OAK S9°-28'W 35.6', GOOD SCAR  
1 1/4" IRON ROD N47°-43'E 13.07' (NO RECORD)  
1/2" IRON ROD AT COR. INTO 1/2" IRON PIPE 2" BELOW SURFACE.  
5/8" IRON ROD S47°-43'W, 5.64'

NOTE: 1/2" ROD & 5/8" ROD SET FEB. 1980 DURING SURVEY FOR BENNETTA PICKETT.

### SURVEY NARRATIVE

**LOCATION:** NORTHEAST 1/4 AND SOUTHEAST 1/4, SECTION 26, TOWNSHIP 30 SOUTH, RANGE 5 WEST, WILLAMETTE MERIDIAN.

**PURPOSE:** SURVEY FOR PROPERTY LINE AGREEMENT.

**EVIDENCE:** FOUND THE NORTHEAST CORNER OF DONATION LAND CLAIM #62 AS SHOWN. THE SOUTHEAST CORNER OF DONATION LAND CLAIM #62 WAS NOT FOUND.

**CONCLUSION:** MONUMENTS ALONG THE FENCE ARE TO BE USED AS A BASIS FOR A PROPERTY LINE AGREEMENT ON A NORTH-SOUTH LINE ONLY, I.E. THE 3/4" IRON ROD IS ONLY A LINE MONUMENT NOT A CORNER MONUMENT.

#### DESCRIPTION FOR AGREEMENT LINE:

BEGINNING AT A 5/8" IRON ROD WHICH IS SOUTH 0°-27'-35" EAST 1004.54 FEET FROM THE NORTHEAST CORNER OF WILLIAM PRESTON DONATION LAND CLAIM #62, TOWNSHIP 30 SOUTH, RANGE 5 WEST, WILLAMETTE MERIDIAN, DOUGLAS COUNTY, OREGON; THENCE SOUTH 0°-27'-35" EAST 535.72 FEET TO A 5/8" IRON ROD; THENCE SOUTH 0°-22'-15" WEST 608.33 FEET TO A 3/4" IRON ROD AT THE POINT OF ENDING. ALL SITUATED IN SECTION 26, TOWNSHIP 30 SOUTH, RANGE 5 WEST, WILLAMETTE MERIDIAN.

July 1980

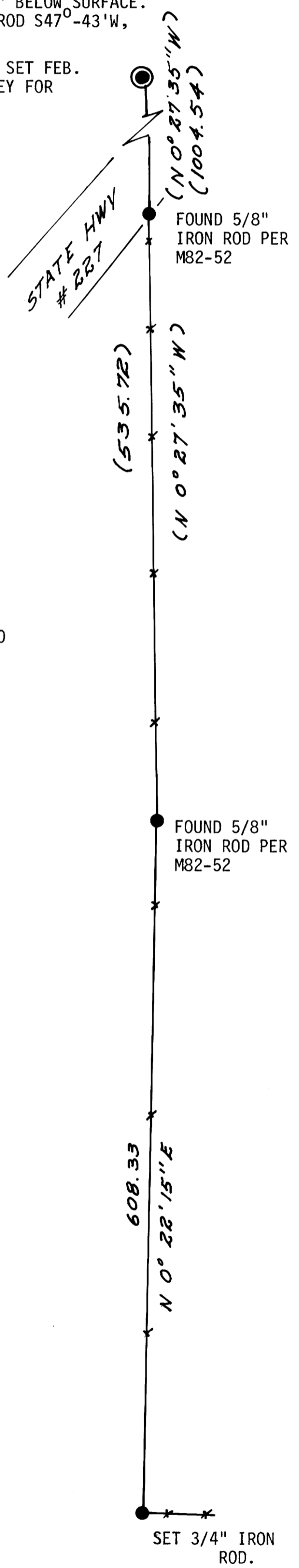

REGISTERED  
OREGON  
LAND SURVEYOR

JULY 12, 1968  
WILLIAM J. RUPPERT  
866

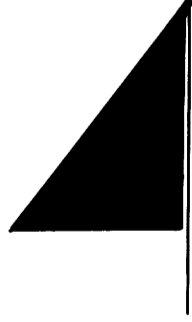

SCALE  
1" = 100'  
BEARINGS BASED  
ON M82-52

UMPQUA SURVEYING COMPANY  
MYRTLE CREEK, OR  
863-5201

COUNTY SURVEYORS FILE DATA  
DO NOT REMOVE FROM OFFICE