

# MINOR LAND PARTITION

IN LOT 17 ROSEBURG HOME ORCHARD TRACTS PLAT "H"  
SECTION 10 T28S R6WWM - NOVEMBER 1979

SCALE: 1"=100'

COUNTY SURVEYORS FILE DATA  
NOT REMOVE FROM OFFICE

FILED  
RECEIVED

NOV 26 1979

COUNTY SURVEYOR  
DOUGLAS COUNTY, ORE.

STATE OF OREGON  
COUNTY OF DOUGLAS

**PARTITIONER:**

David W. Currie  
5583 SW Dillard Hwy  
Roseburg, Oregon 97470  
679-4413

I, DORIS L. WADSWORTH, COUNTY CLERK  
AND RECORDER OF CONVEYANCES, IN AND FOR  
SAID COUNTY, DO HEREBY CERTIFY THAT THE  
WITHIN INSTRUMENT WAS RECORDED THIS DAY:

**LEGAL OWNER:**

Stephen W. Currie  
4276 SW Stella St.  
Roseburg, Oregon 97470  
679-8451

NO. 79-18762  
DOUGLAS COUNTY OFFICIAL RECORDS

**NO. LOTS:**

2

**WATER:**

Roberts Creek

79-18762

**SEWAGE:**

Green Sanitary District  
Only the first 330 feet westerly from  
Stella St. is within the Green Sanitary  
District boundaries; therefore, no  
building would be serviced beyond the  
330 feet.

**MAP PREPARED BY:**

A A SURVEYING SERVICE, INC.  
P.O. BOX 454  
Roseburg, Oregon 97470  
672-2096

**NOTE:**

One single family dwelling only permitted  
on Parcel No. 1.

**LEGEND**

- — Found 5/8" iron rod
- — Set 5/8" iron rod
- ⊙ — Stone

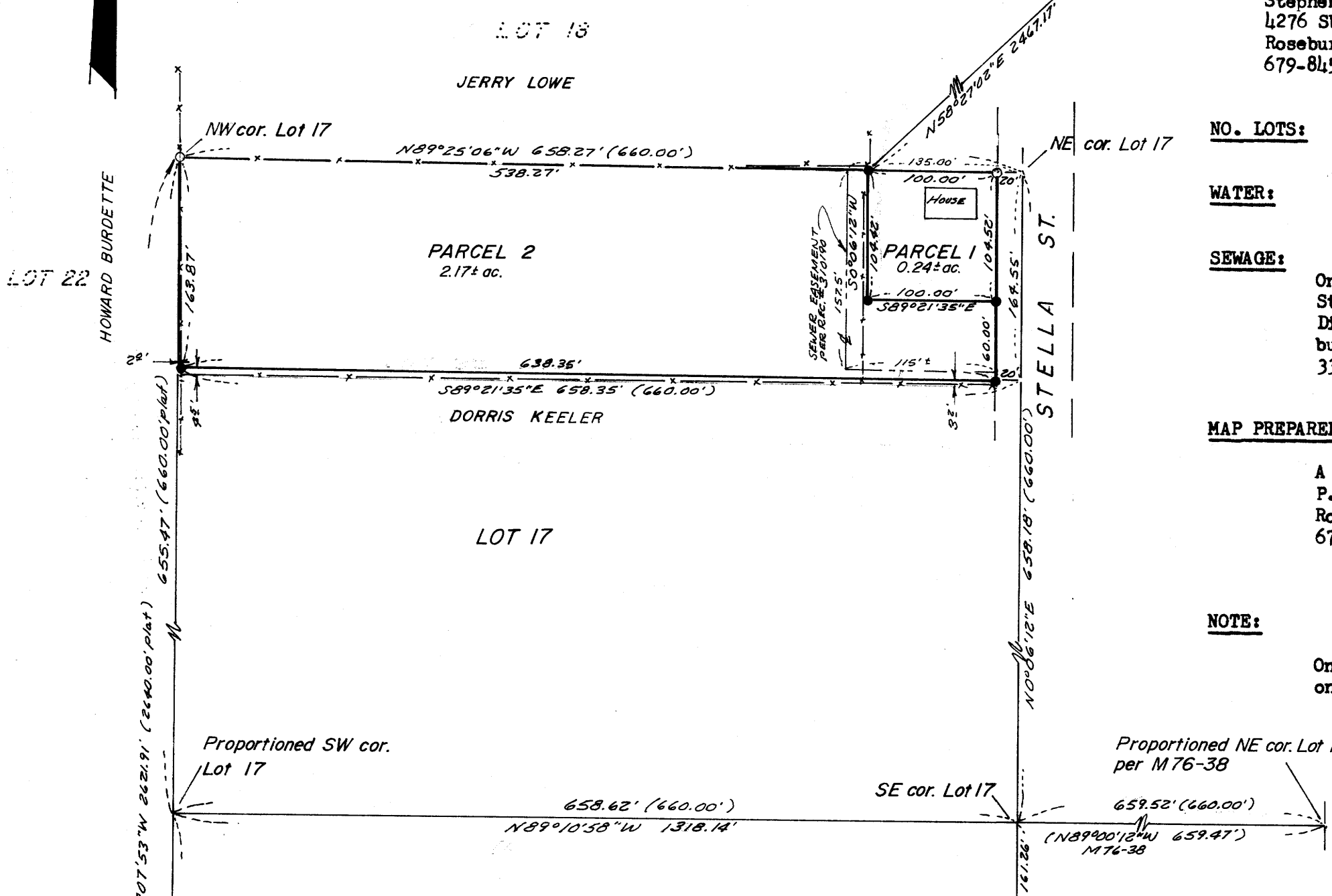

**DESCRIPTIONS:**

**Parcel 1**

Beginning at a 5/8" iron rod from which the section corner common to Sections 2,3,10 & 11, T.28S., R.6W. W.M., bears N58°27'02"E 2467.17 feet; thence S 0°06'12"W 104.42 feet to a 5/8" iron rod; thence S89°21'35"E 100.00 feet to a 5/8" iron rod on the West R/W line of Stella St.; thence N 0°06'12"E along said West R/W line 104.52 feet to a 5/8" iron rod; thence N89°25'06"W along the North line of Lot 17 Roseburg Home Orchard Tracts Plat "H", as recorded in volume 3, page 21, Plat Records of Douglas County, Oregon, 100.00 feet to the Point of Beginning, situated in Lot 17 of said Roseburg Home Orchard Tracts Plat "H", containing 0.24 acres, more or less.

**Parcel 2**

Beginning at a 5/8" iron rod, from which the section corner common to Sections 2,3,10&11, T.28S., R.6W.W.M., bears N58°27'02"E 2467.17 feet; thence N89°25'06"W along the North line of Lot 17 Roseburg Home Orchard Tracts Plat "H", as recorded in volume 3, page 21, Plat Records of Douglas County, Oregon, 538.27 feet to a 5/8" iron rod; thence S 0°07'53"W along the West line of said Lot 17, 163.87 feet to a 5/8" iron rod; thence leaving said West line S89°21'35"E 638.35 feet to a 5/8" iron rod on the West R/W line of Stella St; thence N 0°06'12"E along said West R/W line 60.00 feet to a 5/8" iron rod; thence leaving said West R/W line, N89°21'35"W 100.00 feet to a 5/8" iron rod; thence N 0°06'12"E 104.42 feet to the Point of Beginning, situated in Lot 17 of said Roseburg Home Orchard Tracts Plat "H", containing 2.17 acres, more or less.

SUBJECT TO a sewer easement as described in recorders no. 310190, Deed Records of Douglas County, Oregon

REGISTERED  
PROFESSIONAL  
LAND SURVEYOR

Eugene A. Bloom  
OREGON  
MAY 13, 1960  
EUGENE A. BLOOM  
492

**APPROVALS**

Keith L. Cubic  
Planning Commission

11/26/79  
Date

Francis L. Ingram  
County Surveyor

11-26-79  
Date

Pl. 5-148