

MAP FILE M.76-62-B
COUNTY SURVEYORS FILE DATA
DO NOT REMOVE FROM OFFICE MAJOR LAND PARTITION

IN SECTION 32, T.24S. R.3 W. W.M.

APRIL 1979

FILED ✓
RECEIVED JH

APR 23 1979

COUNTY SURVEYOR
DOUGLAS COUNTY, ORE.
TB

PARTITIONER AND LEGAL OWNER:

Mr. and Mrs. Donald Hunt
Rt. 1, Box 5720,
Sutherlin, Oregon 97479

LOTS: 2

WATER SUPPLY: 2 Wells

SEWAGE: Sub-surface

MAP PREPARED BY:

Herman A. Pieske
1778 Riverview Drive
Roseburg, Oregon 97470

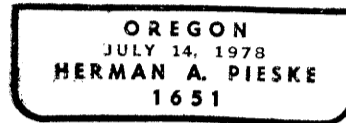
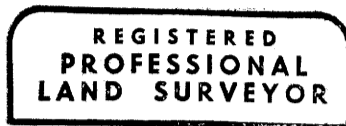

PARCEL NO. 1

A parcel of land situated in Section 32, Township 24 South, Range 3 West, W.M., Douglas County, Oregon, more particularly described as follows:

Beginning at a 1/2" iron rod on the easterly R/W line of County Road No. 19, from which the one-quarter corner common to Sections 29 and 32, Township 24 South, Range 3 West, W.M., bears S 75°51'55" E 575.32 feet; thence along the easterly R/W line of said County Road, S 23°00'08" W 101.89 feet to a 5/8" iron rod and along the arc of a 620 foot radius curve left (the long chord of which bears S 14°14'48" W) 189.49 feet to point "A" and S 5°29'28" W 149.31 feet to a 5/8" iron rod and along the arc of a 780 foot radius curve right (the long chord of which bears S 15°27'43" W) 271.48 feet to a 5/8" iron rod and S 25°25'58" W 335.24 feet to a 5/8" iron rod and along an arc of a 380 foot radius curve right (the long chord of which bears S 32°49'10" W) 97.98 feet to a 1/2" iron rod on the North line of the A.E. Newell lands; thence S 68°12'57" E along said North line 321.35 feet to the center of Calapooia Creek; thence leaving said North line, and run along the center of said creek, N 25°09'48" E 198.91 feet and N 12°25'10" W 316.52 feet and N 3°38'46" W 414.79 feet and N 20°32'56" E 299.69 feet to a point on the North line of said Section 32; thence leaving said creek and run along the North line of said Section 32 N 75°51'55" W 24.98 feet to the Point of Beginning, containing 3.29 acres, more or less. SUBJECT TO a 60 foot roadway easement for ingress and egress, described as follows:

Beginning at a point known as point "A"; thence S 75° E on a line to its intersection with the center of Calapooia Creek, which bearing is N 20°32'56" E said 60 feet being 60 feet North of and perpendicular to said line.

PARCEL NO. 2

A parcel of land situated in Section 32, Township 24 South, Range 3 West, W.M., Douglas County, Oregon, more particularly described as follows:

Beginning at the one-quarter corner common to Sections 29 and 32, Township 24 South, Range 3 West, W.M.; thence S 5°33'47" E along the North-South centerline of said Section 32, 1359.78 feet to a 1/2" iron rod; thence N 68°12'57" W along the North line of the A.E. Newell lands 819.32 feet to the center of Calapooia Creek; thence leaving said North line and run along the center of said creek N 25°09'48" E 198.91 feet and N 12°25'10" W 316.52 feet and N 3°38'46" W 414.79 feet and N 20°32'56" E 299.69 feet to a point on the North line of said Section 32; thence S 75°51'55" E along the North line of said Section 32, 550.34 feet to the Point of Beginning; containing 19.21 acres, more or less.

TOGETHER WITH a 60 foot roadway easement for ingress and egress, described as follows:

Beginning at a point, known as point "A"; thence S 75° E on a line to its intersection with the center of Calapooia Creek, which bearing is N 20°32'56" E, said 60 feet being 60 feet North of and perpendicular to said line.

APPROVALS:

Keith L. Cubic
Douglas County Planning Department

4/19/79
Date

Francis L. Ingram
Douglas County Surveyor

4-23-79
Date

STATE OF OREGON)
COUNTY OF DOUGLAS) ss.

I, DORIS L. WADSWORTH, COUNTY CLERK
AND RECORDER OF CONVEYANCES, IN AND FOR
SAID COUNTY, DO HEREBY CERTIFY THAT THE
WITHIN INSTRUMENT WAS RECORDED THIS DAY:

APR 23 10 58 AM '79
BY Margaret Beal
DEPUTY
NO. _____ FEE 6.00
DOUGLAS COUNTY OFFICIAL RECORDS

79-06457