

COUNTY SURVEYORS FILE DATA
DO NOT REMOVE FROM OFFICE

FILED 7
RECEIVED 78

APR 16 1979

COUNTY SURVEYOR
DOUGLAS COUNTY, ORE.
DW

MAP FILE M.76
19 20
30 29
FD. MARKED STONE WITH
BRASS CAPPED IRON
PIPE BESIDE IT

N89°47'40"E. 1320.61

PROPERTY LINE AGREEMENT

FENCE CORNER

SET 1/2" IRON PIPE
PROPERTY CORNER
NOT SET AS 1/16" CORNER

58 3/4 W
40 1/2
26" W. OAK
SCRIBED
N 1/16 S 30
BT

5 1/2 S E
10 1/2
10" CEDAR
SCRIBED
N 1/16 S 29
BT

REGISTERED
PROFESSIONAL
LAND SURVEYOR
Russell T. Pinard
OREGON
JULY 16, 1971
RUSSELL T. PINARD
958

39.95 ACRES

NORTH 1320.29

PROPERTY LINE AGREEMENT

6" MADRONE
SCRIBED
1/4 S 30
BT

12" MADRONE
SCRIBED
1/4 S 29
BT

10" OAK
SCRIBED
PC

6" MADRONE
SCRIBED
PC

PROPERTY LINE AGREEMENT
EAST 1321.23

SET 1/2" IRON PIPE
PROPERTY CORNER
NOT SET AS 1/16" CORNER

PROPERTY BOUNDARY SURVEY

FOR WOOLEY LUMBER COMPANY & J. GOSSETT

BY RUSSELL T. PINARD

IN TOWNSHIP 23 SOUTH, RANGE 5 WEST, W.M.
SECTION 29

DATE MARCH 1979

SCALE 1 IN. = 200 FT.



① SET 1" IRON PIPE WITH BRASS CAP

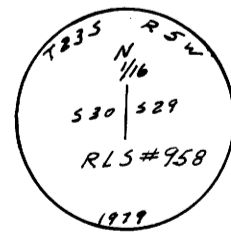

② SET 1" IRON PIPE WITH BRASS CAP
FOUND STONE AS PER M-72-17

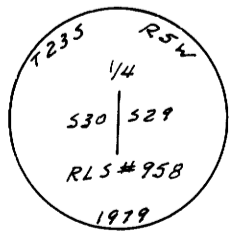

③ SET 1" IRON PIPE WITH BRASS CAP

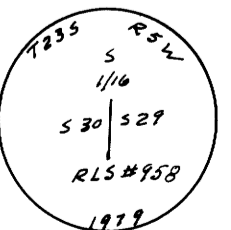

5 1/2 W
46 1/2
9" OAK
SCRIBED
S 1/16 S 30
BT

5" CEDAR
SCRIBED
S 1/16 S 29
BT

30 29
31 32
FD. BRASS CAPPED
IRON PIPE