

COUNTY SURVEYORS FILE DATE  
DO NOT REMOVE FROM OFFICE

540' SPIRAL  
S = 7° 17' 24"  
a = 0.5

A = S 75° 24' 13" W 421.55'  
B = S 72° 23' 16" W 126.05'

254 + 45.53 PCS  
R/W 75' RT

259 + 85.53 PT BK  
259 + 75.97 RT  
R/W 75' RT

INTERSECTION OF  
NORTH R/W AND  
SECTION LINE

FILED  
RECEIVED

MAY 5 1978

COUNTY SURVEYOR  
DOUGLAS COUNTY, ORE.

UMPQUA  
HIGHWAY

NORTH

### SURVEY FOR DOUGLAS COUNTY RURAL FIRE DISTRICT NO. 2 IN SEC. 23, T. 27 S., R. 5 W., W.M.

SURVEYED BY DOUGLAS COUNTY SURVEYOR'S OFFICE  
FRANCIS L. INGRAM COUNTY SURVEYOR  
DRAWN BY BILL STEWART APRIL 1978

REGISTERED  
PROFESSIONAL  
LAND SURVEYOR

*Francis L. Ingram*

OREGON  
JULY 11, 1969  
FRANCIS L. INGRAM  
902

N 00° 22' 24" W (BASIS OF BEARING FROM M 52-79)  
1568.18' (RECORD 1568.49' FROM M 52-79)



SCALE 1" = 100'  
1" = 0.3048006 M

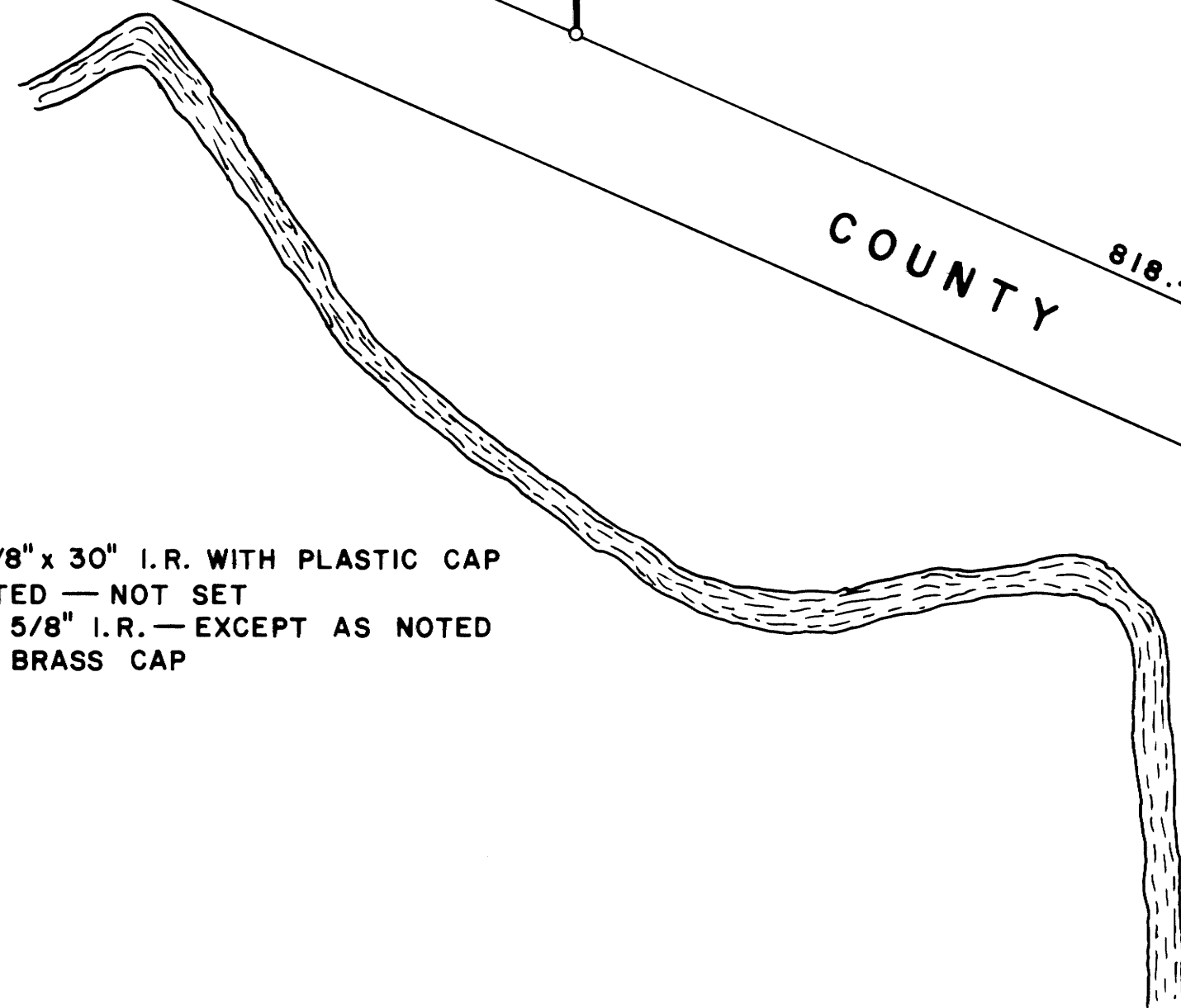

COUNTY  
ROAD NO. 4B

WESTERLY LINE OF THAT  
PROPERTY DESCRIBED IN VOL. 117,  
PAGE 169 DOUGLAS COUNTY  
DEED RECORDS

3/4" I.R.

66° 04' 25" W  
171.56'

61 + 00.00 POT  
R/W 40' LT

S 22° 23' 50" W  
200.06'

67 + 71.61 PC  
R/W 40' LT

S 78° 55' 15" E  
326.72'

W.C. BEARS  
N 00° 22' 24" W  
35.0' FROM 1/4 COR.

- SET 5/8" x 30" I.R. WITH PLASTIC CAP
- COMPUTED — NOT SET
- FOUND 5/8" I.R. — EXCEPT AS NOTED
- FOUND BRASS CAP

CS FILE FOLDER

CONTAINS

MORE

INFORMATION