

DESCRIPTION OF MONUMENTS AND ACCESSORY TIES

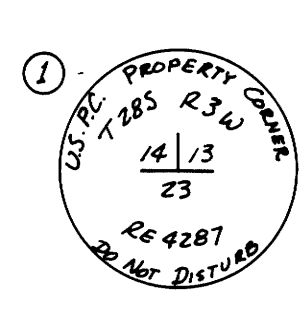

Standard Corner, Sections 13 & 14
Found 1" iron rod with Aluminum Cap stamped as shown.
From which:
42" Fir stump bears N 37° E, 32.8 ft. Face not visible.
42" Fir stump bears N 53° 30' E, 32.6 ft. Face w/scrubbing visible.
36" Hemlock stump bears N 47° W, 42.6 ft. Face w/scrubbing visible.
18" Yew snag bears S 12° SE, 76.0 ft. Face w/scrubbing visible.
5" D. Fir bears N 14° 45' W, 46.2 ft. Scribbled "X BT"
5" D. Fir bears S 62° W, 73.7 ft. Scribbled "X BT"

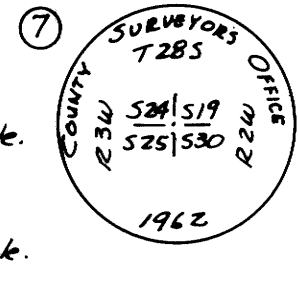

Section Corner, Sections 19 & 20, T285, R2W, and Sections 24 & 25, T285, R3W
Found 1" iron pipe with Brass Cap stamped as shown.
From which:
40" Hemlock bears S 14° E, 23.4 ft. Face w/scrubbing visible.
36" D. Fir snag bears S 29° W, 19.7 ft. Healed face. Did not open.
36" D. Fir snag bears N 50° W, 15.8 ft. Face w/scrubbing visible.
New BT, 18" Chingapin bears S 14° 30' W, 102.5 ft. I blazed & scribed "T 285, R 3 W S 25 BT"

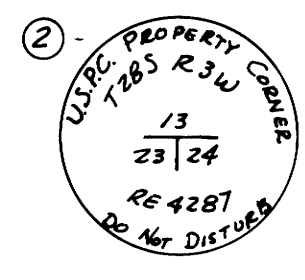

Claim Corner, Sections 23 & 24
Found 1" iron rod with Aluminum Cap stamped as shown.
From which:
22" Fir stump bears S 52° W, 42.5 ft. Face not visible.
6" Yew bears S 4° W, 33.4 ft. Face w/scrubbing visible.
15" Fir bears N 85° E, 64.2 ft. Face w/scrubbing visible.
15" Fir bears S 24° 30' E, 58.5 ft. Face w/scrubbing visible.

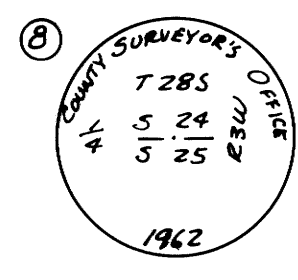

1/4 Corner, Sections 24 & 25
Found 1" iron pipe with Brass Cap stamped as shown.
From which:
18" D. Fir bears S 9° E, 5.6 ft. Healed face. Did not open.
15" D. Fir bears N 46° E, 25.0 ft. Healed face. Did not open.

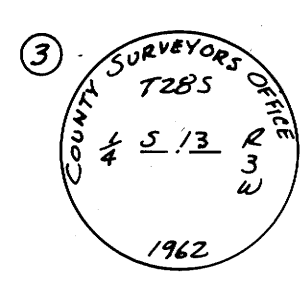

S 1/4 Corner Section 13 only
Found 1" iron pipe with Brass Cap stamped as shown.
From which:
34" Hemlock bears N 84° 30' W, 11.0 ft. Face with scribing visible "S & S 1/3 C S BT"
8" Yew bears N 78° E, 5.7 ft. Face with scribing visible "S & S 1/3 C S BT"
14" Yew snag bears S 55° 30' W, 27.1 ft. Partial scribing visible.

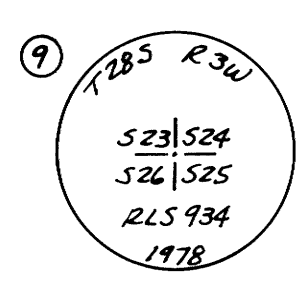

Section Corner, Sections 23, 24, 25 & 26
Found 3/4" iron rod with orig. stone alongside.
From which:
30" Hemlock bears S 22° 30' E, 15.2 ft. Face w/scrubbing visible.
40" Cedar bears N 70° W, 33.8 ft. Face w/scrubbing visible.
S.W. and N.E. BT's are down.
Set 2"x30" galv. iron pipe with 3" Brass Cap, stamped as shown.
From which: (New BT's)
26" Cedar bears S 44° 30' W, 71.6 ft. I blazed & scribed "T 285 R 3 W S 26 BT"
8" Hemlock bears N 45° E, 35.7 ft. I blazed & scribed "T 285 R 3 W S 24 BT"
Set 3/4" iron rod and stone alongside new mon.

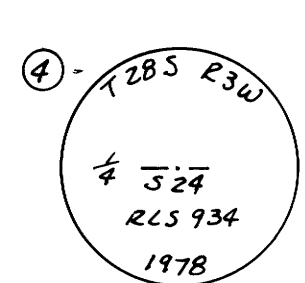

N 1/4 Corner Section 24 only.
Set 2"x30" iron pipe with Brass Cap stamped as shown.
From which:
12" Hemlock bears S 31° W, 17.7 ft. I blazed & scribed "N & S 24 BT"
16" Hemlock bears S 17° E, 5.5 ft. I blazed & scribed "N & S 24 BT"

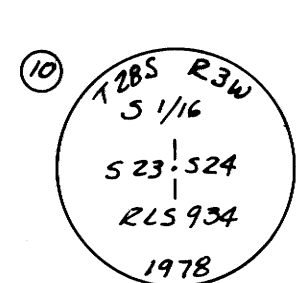

S 1/4 Corner between Sections 23 & 24
Found 3/4" iron rod
From which:
24" Hemlock bears S 35° W, 17.4 ft. Face w/scrubbing visible.
12" Hemlock bears N 64° E, 14.5 ft. Face w/scrubbing visible.
Set 2"x30" galv. iron pipe with 3" Brass Cap, stamped as shown. Set 3/4" iron rod alongside.

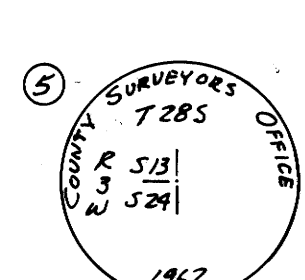

Sec. Corner, Sections 13 & 24 only.
Found 1" iron pipe with Brass Cap stamped as shown.
From which:
28" Hemlock bears S 31° W, 10.9 ft. Good scribing visible.
18" Hemlock bears S 24° E, 4.3 ft. Healed face, did not open.
26" Cedar bears N 25° W, 5.4 ft. Healed face, did not open.
30" Hemlock bears N 59° E, 37.3 ft. Healed face, did not open.

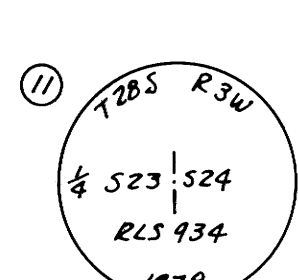

1/4 Corner, Sections 23 & 24
Found 3/4" iron rod
From which:
14" Yew stump bears N 47° W, 57.8 ft. Lower face with scribing "BT" visible.
14" Yew bears N 82° E, 31.2 ft. Face w/scrubbing visible.
56" Fir stump bears N 84° W, 15.5 ft. No scribing visible.
Set 2"x30" galv. iron pipe with 3" Brass Cap, stamped as shown. Set 3/4" iron rod alongside.

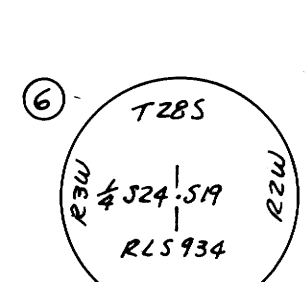

1/4 Corner, Sections 24 & 19
Set concrete mon. approx. 6" wide on top, 12" wide at bottom, 18" high, on steep NW. rock slope.
Set 3" Brass disc in top of conc. mon., stamped as shown.
From which:
10" Yew Q.B.T. bears S 13° E, 15.2 ft. (23/14) Good face w/scrubbing visible. Tree is down but alive.
16" Hemlock Q.B.T. bears N 58° W, 24.4 ft. (37/14) No remains of face found. Tree is down and almost completely rotted away. Rotted stump hole apparent.
New BT, 10" Hemlock bears N 6° 30' W, 26.9 ft. I blazed & scribed "T 285 R 3 W & S 24 BT"
New BT, 12" Hemlock bears N 83° E, 5.8 ft. I blazed & scribed "T 285 R 2 W & S 19 BT"

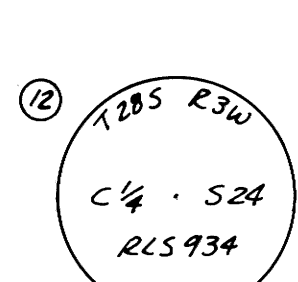

Center 1/4 Corner Section 24
Set 2"x30" galv. iron pipe with a 3" Brass Cap stamped as shown.
From which:
8" Hemlock bears S 41° 15' E, 14.6 ft. I blazed & scribed "C & S 24 BT"
8" Hemlock bears N 44° E, 10.4 ft. I blazed & scribed "C & S 24 BT"

NOTE: All new bearing trees scribed in this survey are marked with brass washers stamped "RLS 934" nailed to the lower blaze of each tree.

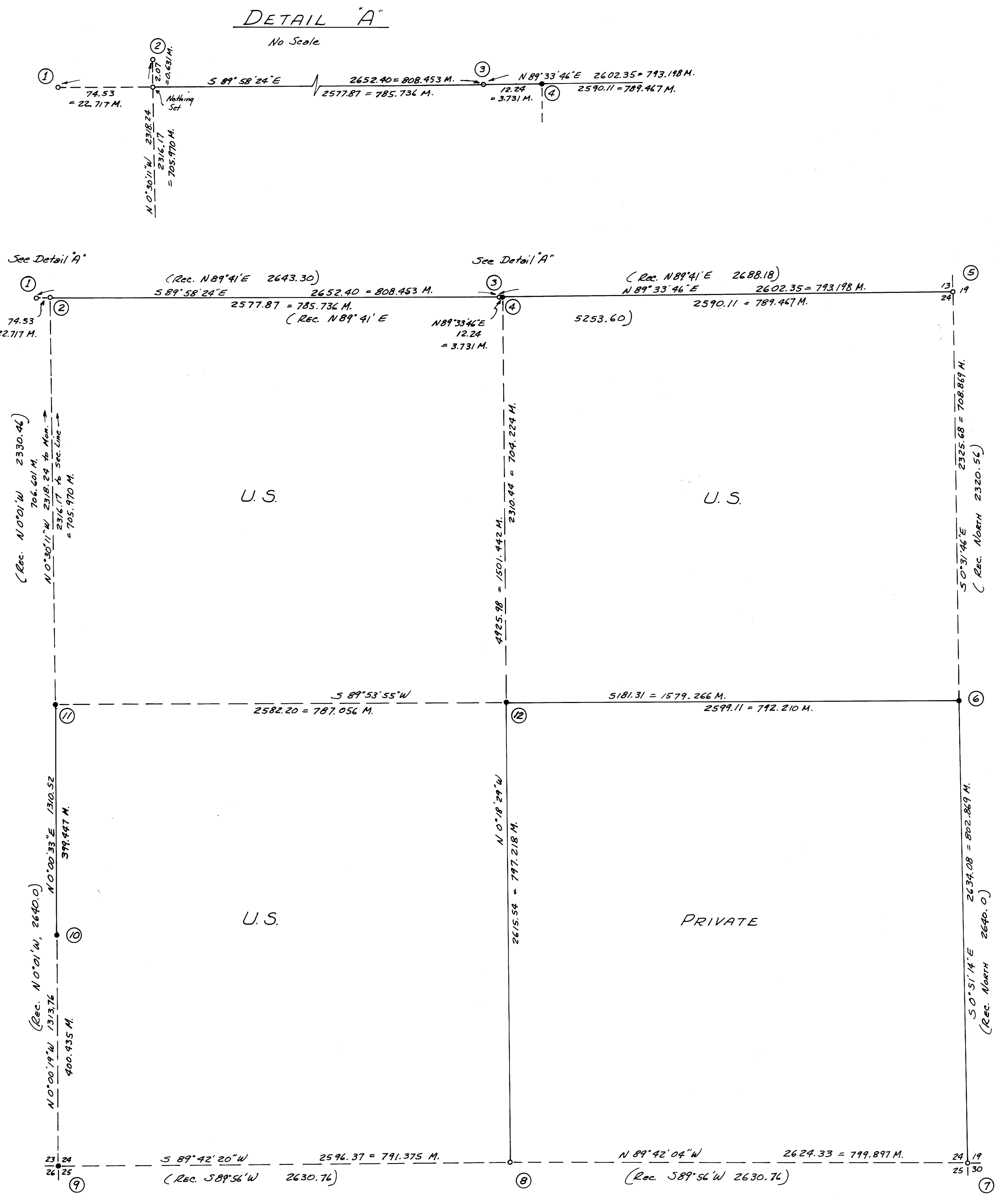

CONTRACTOR'S CERTIFICATION:
I, Victor M. McLind, a registered land surveyor in the State of Oregon, hereby certify that this plat and the notes hereon, or attached, are a correct representation of a survey I performed during August and September, 1978, for the U.S. Forest Service, in accordance with the statutes of the State of Oregon and with the Articles of my contract.
Victor M. McLind
Victor M. McLind
Registered Land Surveyor
Oregon License 934

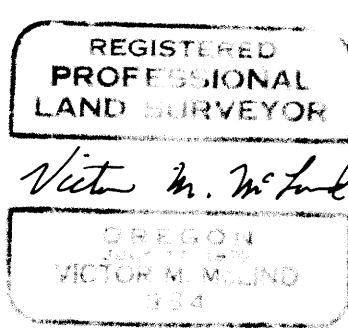

- LEGEND
- Found Monument
 - Set Monument
 - National Forest Boundary Posted This Contract
 - - - Section Lines or Sectional Subdivision Lines
 - "M" indicates meters (unlabeled distances are feet)

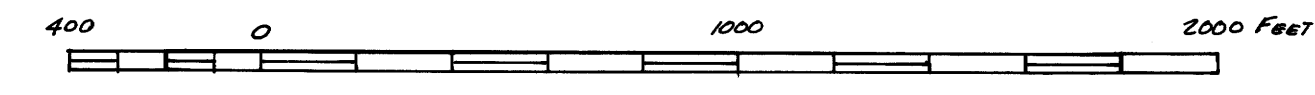

COUNTY SURVEYORS FILE DATA
DO NOT REMOVE FROM OFFICE

PLAT OF SURVEY
LOCATED IN
SECTION 24, T285, R3W, W.M.
DOUGLAS COUNTY, OREGON
FOR
THE UNITED STATES DEPARTMENT OF AGRICULTURE
LUMPUA NATIONAL FOREST
VICTOR M. MCLIND, MILTON-FREEWATER, ORE.
SCALE: 1" = 400' SEPTEMBER, 1978
BEARINGS BASED ON SOLAR OBSERVATION
GLIDE LAND SURVEY NO. 8
CONTRACT NO. 53-0471-8-66