

SURVEY FOR U.S. FOREST SERVICE

Section 28, Township 25 South, Range 1 West, Willamette Meridian

B.H.W. Engineering & Surveying Inc.

1205 S.E. Court, Roseburg Oregon. 673-0165

August 1978

Scale 1"=400'

FILED
RECORDED
COUNTY SURVEYOR
DOUGLAS COUNTY, ORE.

REGISTERED
PROFESSIONAL
LAND SURVEYOR

Romanco E. Ware
OREGON
NOV. 16, 1978
ROMANCO E. WARE
1005

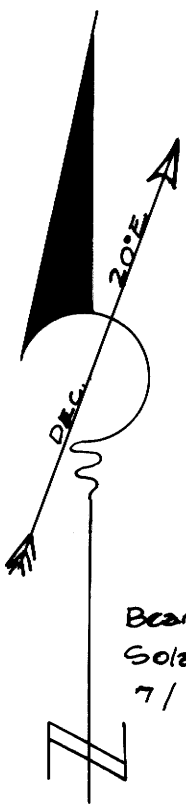
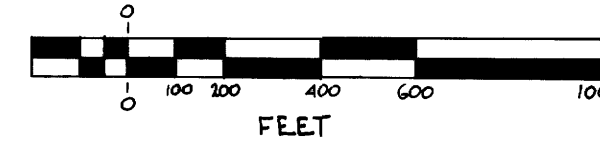

- ⊙ Denotes corner monuments found
- ⊕ Denotes 1/4 corner monuments set by single proportionate measurement.
- ⊗ Denotes corner monument set from evidence found at corner location
- Denotes line posted with steel fence posts and Government property signs.
- () Course per GLO Plat May 6, 1901

20 21
29 28

Sec 28
Private

N 1/2 Sec 27
Private

U.S. W 1/2 SW 1/4
Sec 27

U.S. Sec. 34

U.S. Sec 33

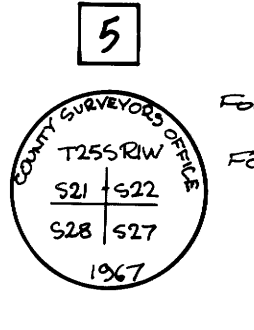
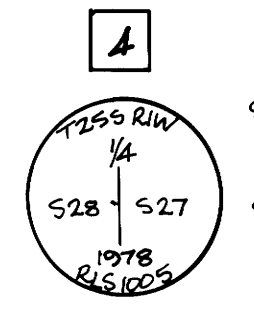
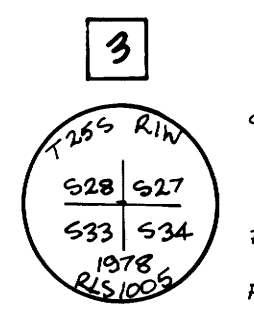
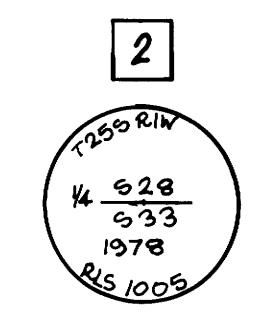
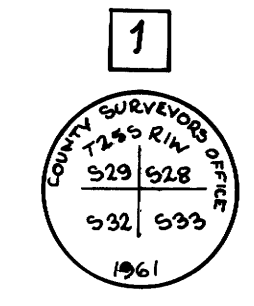

" I, Romanco E. Ware, a registered professional land surveyor in the State of Oregon, hereby certify that this plat and the notes hereon, or attached, are a correct representation of a survey I performed during July 1978 to August 1978, for the U.S. Forest Service, in accordance with the Statutes of the State of Oregon and with the articles of my contract."

Romanco E. Ware
Registered Professional Land Surveyor
Oregon License No. 1005