

COUNTY SURVEYORS FILE DATA  
DO NOT REMOVE FROM OFFICE

# DESCRIPTION OF MONUMENTS AND ACCESSORY TIES

FILED  
RECEIVED  
DK AUG 10 1978  
COUNTY SURVEYOR  
DOUGLAS COUNTY, ORE.  
78

RECORD SURVEY M 65-79

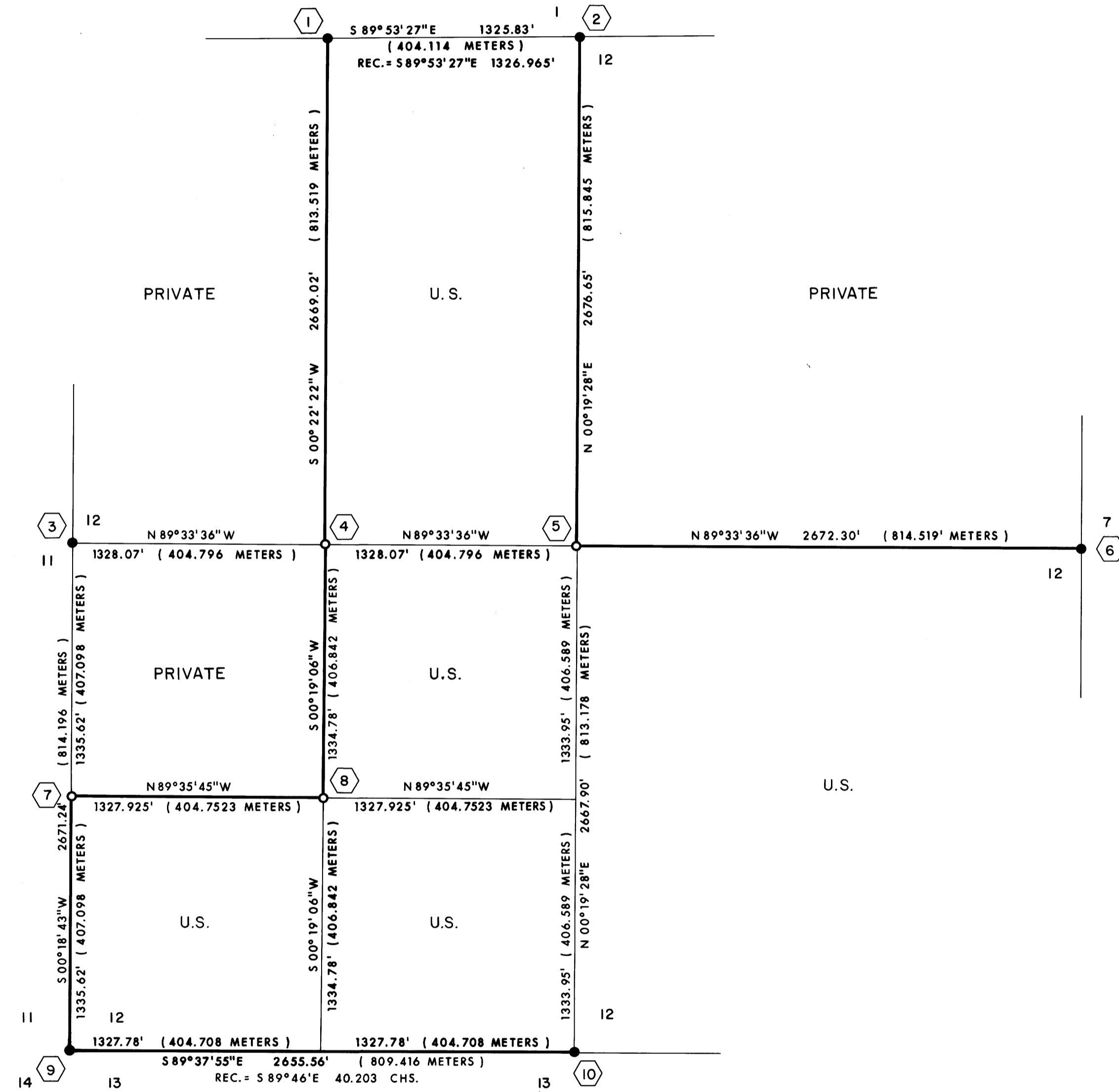

RECORD SURVEY M 1-38

**LEGEND:**  
● = FOUND MONUMENT AS SHOWN.  
○ = SET MONUMENT AS SHOWN.  
— = TRUE LINE POSTED WITH STEEL FENCE POSTS AND GOVERNMENT PROPERTY SIGNS.

**BASIS OF BEARINGS:** SURVEY M 65-79

**FIELD BOOKS** REFERENCED UNDER CONTRACT NO. 53-04T1-8-1  
FIELD BOOKS 13 AND 12 (1 OF 3, 2 OF 3, AND 3 OF 3).

**NOTE:** ALL NEW BEARING TREES HAVE BRASS TAGS NAILED TO THE TREE AT THE BT SCRIBE.

I, LOYD R. MOFFITT A REGISTERED LAND SURVEYOR IN THE STATE OF OREGON, DO HEREBY CERTIFY THAT THIS PLAT AND THE NOTES HEREON ARE A CORRECT REPRESENTATION OF A SURVEY I PERFORMED DURING JULY, 1978, FOR THE U.S. FOREST SERVICE IN ACCORDANCE WITH THE STATUTES OF THE STATE OF OREGON AND THE ARTICLES OF MY CONTRACT.

*Lloyd R. Moffitt*  
LOYD R. MOFFITT  
REGISTERED LAND SURVEYOR NO. 944

① FOUND 2" PIPE WITH 3" BRASS CAP STAMPED:

FROM WHICH: A 10" FIR BEARS N63°W 10.5', SCRIBE VISIBLE.  
A 18" CEDAR BEARS SOUTH 22.5', SCRIBE VISIBLE.

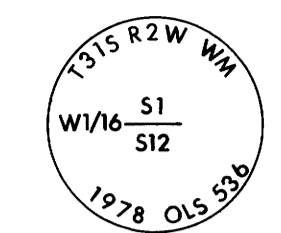

② FOUND 2" PIPE WITH 3" BRASS CAP STAMPED:

FROM WHICH: A 12" FIR BEARS N09°E 59.0', SCRIBE VISIBLE.  
A 9" FIR BEARS S79°E 24.6', SCRIBE VISIBLE.

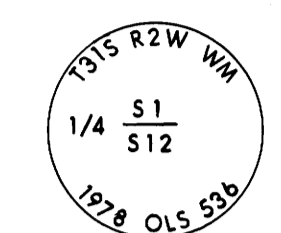

③ FOUND 1" PIPE WITH 2 1/2" BRASS CAP STAMPED:

FROM WHICH: A 26" FIR BEARS S64°W 54.1', SHOWS SCARS.  
A 17" FIR BEARS S38°E 35.0', SHOWS SCARS.  
A STONE WITH 1/4 SCRIBE IS LAYING BESIDE PIPE.

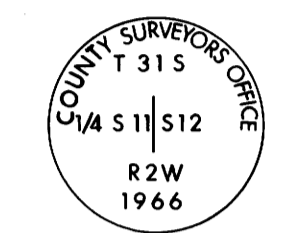

④ SET 2" PIPE WITH 3" BRASS CAP STAMPED:

FROM WHICH: A 18" FIR BEARS S52°E 8.4', SCRIBED, CW 1/16 S 12, BT.  
A 36" OAK BEARS N27°E 6.3', SCRIBED, CW 1/16 S 12, BT.

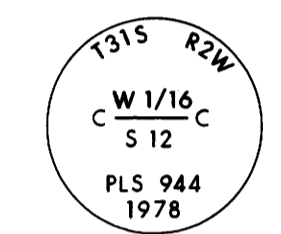

⑤ SET 2" PIPE WITH 3" BRASS CAP STAMPED:

FROM WHICH: A 6" FIR BEARS S69°W 11.0', SCRIBED, C 1/4 S 12, BT.  
A 20" FIR BEARS SOUTH 3.0', SCRIBED, C 1/4 S 12, BT.

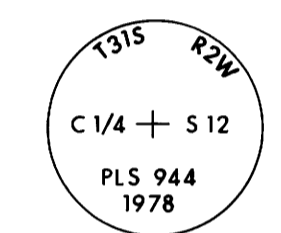

⑥ FOUND 1" PIPE WITH 2 1/2" BRASS CAP STAMPED:

FROM WHICH: A 6" MAPLE BEARS N48°W 11.9', SHOWS SCARS.  
A 12" FIR BEARS N52°E 13.9', SHOWS SCARS.  
A 24" FIR BEARS N04°W 26.1', SHOWS SCARS.

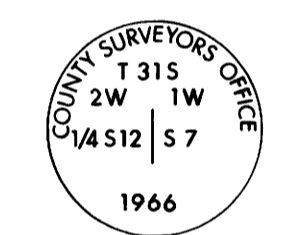

⑦ SET 2" PIPE WITH 3" BRASS CAP STAMPED:

FROM WHICH: A 16" FIR BEARS N65°W 10.7', SCRIBED, S 1/16 S 11, BT.  
A 20" FIR BEARS N67°E 62.6', SCRIBED, S 1/16 S 12, BT.

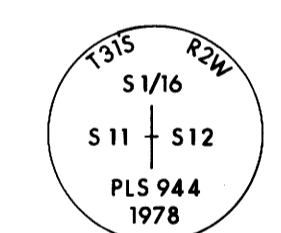

⑧ SET 2" PIPE WITH 3" BRASS CAP STAMPED:

FROM WHICH: A 18" PINE BEARS N78°E 12.2', SCRIBED, SW 1/16 S 12, BT.  
A 24" PINE BEARS S16°E 22.0', SCRIBED, SW 1/16 S 12, BT.

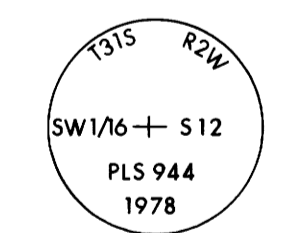

⑨ FOUND 1" PIPE WITH 2 1/2" BRASS CAP STAMPED:

FROM WHICH: A 40" FIR BEARS N45°E 29.0', NO SCAR.  
A 10" FIR BEARS S05°E 22.9', SCAR VISIBLE.  
A 30" PINE BEARS S24°W 47.5', SCAR VISIBLE.  
A 14" FIR BEARS N28°W 8.0', SCAR VISIBLE.

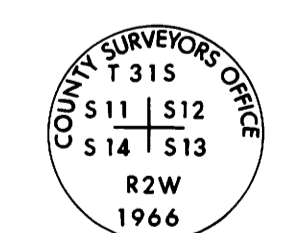

⑩ FOUND 1" PIPE WITH 2 1/2" BRASS CAP STAMPED:

FROM WHICH: A 24" FIR BEARS N21°E 33.0', SCAR VISIBLE.  
A 12" MADRONE BEARS S51°W 26.2', SCRIBE VISIBLE.

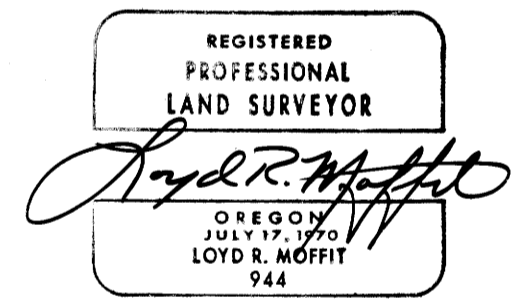
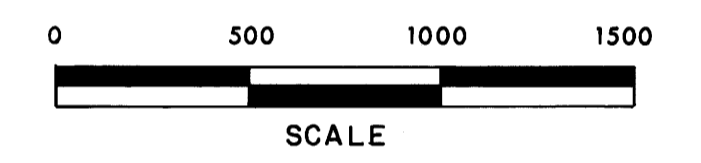
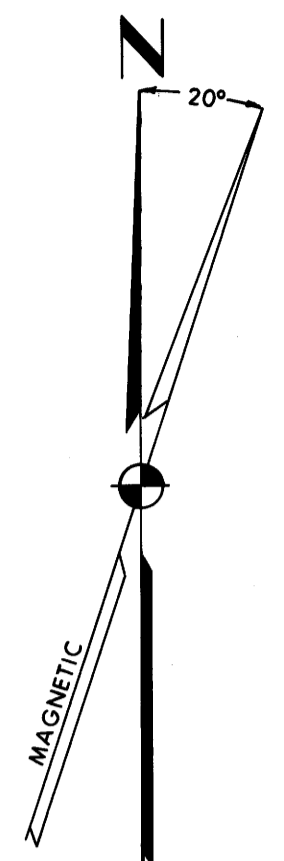
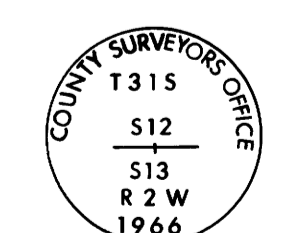

PLAT OF SURVEY  
FOR  
THE UNITED STATES DEPARTMENT OF AGRICULTURE  
**UMPQUA NATIONAL FOREST**  
CONTRACT NO. 53-04T1-8-1  
TILLER LAND SURVEY NO. 28  
BEING A PORTION OF SECTION 12, T. 31 S., R. 2 W., W.M.,  
DOUGLAS CO. SCALE: 1" = 500'  
OREGON DATE: JULY, 1978  
PREPARED BY: FRIAR-MOFFITT SURVEYING COMPANY  
MEDFORD, OREGON

COUNTY SURVEYORS FILE DATA  
DO NOT REMOVE FROM OFFICE