

08-99 W

FILED *✓*
RECEIVED *fc*

AUG 10 1977

COUNTY SURVEYOR
DOUGLAS COUNTY, ORE.



Scale 1" = 400'

Bearings based on Solar Observation

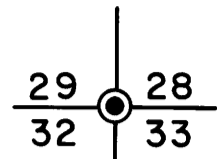

Set Brass Cap mkd.
S29, S28, S32, S33, T.22 S., R.12 W. 1977
From which a :

46" fir stump orig. BT
old bark face
bears S 32° E, 11.2 ft.

50" fir stump orig. B.T.
partial scribes on old bark face
bears S 34 1/2° W, 22.0 ft.

other orig. B.T.'S missing

old 1" iron pipe alongside brass cap

18" hemlock blowdown, scribes visible
bears S 15° W, 3.8 ft.

8" hemlock stump, scribes visible
bears S 79° E, 10.4 ft.

24" Doug. fir w/face bears N 75° E, 20.2 ft.
I scribe " T 22 S, R 12 W, Sec 28, BT "

12" spruce bears S 50° W, 17.3 ft.
I scribe " T 22 S, R 12 W, Sec 32, BT "

14" doug. fir bears N 19° W, 12.6 ft.
I scribe " T 22 S, R 12 W, Sec 29, BT "

22" doug. fir bears S 70° E, 18.6 ft.
I scribe " T 22 S, R 12 W, Sec 33, BT "

S 2° 09' 38" W, 2674.38
(Record, South, 2640.00)

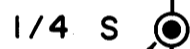

**SURVEY OF WEST LINE OF SEC. 33
T. 22 S., R. 12 W., W.M., DOUGLAS COUNTY, OR.**

For : Jack Russell

By : Shaner Engineering, Inc., Roseburg, Ore.

July 30, 1977

Set Brass Cap mkd.
1/4 S32, S33, T 22 S, R 12 W, 1977

From which a :

48" spruce stump orig. BT
scribes "1/4 S" visible
bears N 78 1/2° E, 30.4 ft.

34" red cedar bears N 43° W, 44.5 ft.
I scribe " 1/4 S 32, BT "

54" spruce bears N 68° E, 44.4 ft.
to scribed face.
I scribe " 1/4 S 33, BT "

S 2° 14' 11" W, 1596.27 (Record, South, 1610.4)
1546.57



South 410.52'

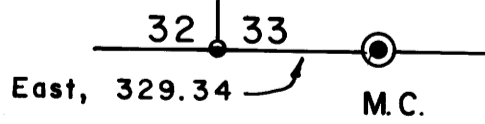

Meander Corner:
Fd. 2" iron pipe
From which a:
26" Douglas fir stump, original BT
Partial scribes "BT"
Bears S 16° E, 20.5 ft.
36" Douglas fir stump, original BT
Scribes vis.
Bears N 2° W, 13.2 ft.

Witness Corner to M. C.
Set Brass Cap mkd. W.C. S 2° W, 49.7 to M.C.
S32, S33 T 22 S, R 12 W, 1977

From which a :

16" doug. fir bears N 62° W, 18.6 ft.
I scribe " T 22 S, R 12 W, S 32 WC BT "

10" doug. fir bears N 8° E, 8.2 ft.
I scribe " T 22 S, R 12 W, S 33 WC BT "

LEGEND

- ⊙ COR. SET
- COR. FOUND
- COMPUTED, NOT SET