

LEGAL DESCRIPTIONS CONTINUED:

Parcel 2

A parcel of land lying in Section 21, Township 26 South, Range 6 West, Willamette Meridian, said parcel being more particularly described as follows;

Beginning at a 5/8" iron rod from which the Southeast corner of D.L.C. 61 bears N 0° 22' 18" W 470.78 feet, N 88° 06' E 1359.95 feet and N 88° 05' E 878.35 feet; thence S 0° 22' 18" E 550.68 feet to a 5/8" iron rod set in the Northerly line of that 60 foot dedicated road as described in Inst. No. 72-7200 in the Deed Records of Douglas County, Oregon; thence along said Northerly line along the arc of a 507.46 foot radius curve to the left ( the long chord of which bears S 70° 12' 58" W 108.84 feet) a distance of 109.05 feet to a 5/8" iron rod and S 64° 01' 53" W 187.13 feet to a 5/8" iron rod; thence N 11° 47' 32" W 118.90 feet to a 5/8" iron rod; thence N 0° 27' 11" E 179.48 feet to a 5/8" iron rod; thence N 15° 50' 25" E 159.61 feet to a 5/8" iron rod; thence N 48° 13' 56" E 330.35 feet to the point of beginning and containing 3.14 acres of land more or less.

Parcel 3

A parcel of land lying in Section 21, Township 26 South, Range 6 West, Willamette Meridian, said parcel being more particularly described as follows:

Beginning at a 5/8 inch iron rod from which the Southeast corner of D.L.C. 61 bears N 0° 22' 18" W 470.78 feet, N 88° 06' E 1359.95 feet and N 88° 05' E 878.35 feet; thence S 71° 45' 06" E 348.17 feet to a 5/8" iron rod set in the West line of that property as described in Inst. No. 76-16673 in the Deed Records of Douglas County, Oregon; thence along said West line S 0° 23' 02" E 415.52 feet to a 5/8" iron rod set in the Northerly line of that 60 foot dedicated road as described in Inst. No. 72-7200 in the Deed Records of Douglas County, Oregon; thence along said Northerly line S 86° 58' 06" W 238.14 feet to a 5/8" iron rod and along the arc of a 507.46 foot radius curve to the left ( the long chord of which bears S 81° 37' 56" W 93.06 feet) a distance of 93.19 feet to a 5/8" iron rod; thence N 0° 22' 18" W 550.68 feet to the point of beginning and containing 3.63 acres of land more or less.

FILED ✓  
 RECEIVED M L L

FEB 15 1977

COUNTY SURVEYOR  
 DOUGLAS COUNTY, ORE.

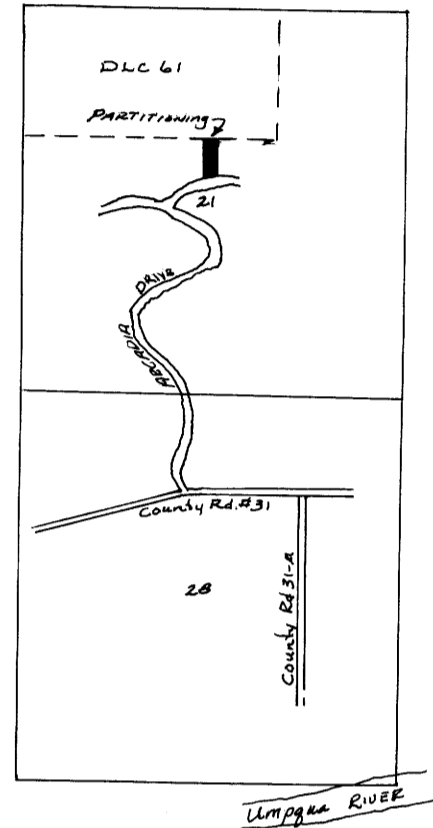

APPROVALS

Keith L. Cubic  
 Planning Commission

2/10/77  
 Date

Francis L. Ingram  
 County Surveyor

2/15/77  
 Date

STATE OF OREGON )  
 COUNTY OF DOUGLAS ) SS.

I DORIS L. WADSWORTH, COUNTY CLERK  
 AND RECORDER OF CONVEYANCES, IN AND FOR SAID  
 COUNTY, DO HEREBY CERTIFY THAT THE WITHIN  
 INSTRUMENT WAS RECORDED THIS DAY:

1977 FEB 15 PM 12 05

DORIS L. WADSWORTH  
 DOUGLAS COUNTY CLERK

BY Mary J. Seal  
 Deputy

77- 2666

NO. \_\_\_\_\_ FEE 6.00

DOUGLAS COUNTY OFFICIAL RECORDS

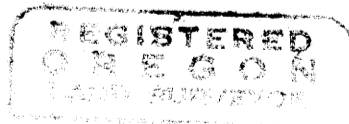

BRUCE A. ROGERS



M.L. 2-19-77