

**SURVEY FOR U.S. FOREST SERVICE
IN SECTION 22, T.31S. R.2W.W.M., DOUGLAS COUNTY, OREGON**
BY: **BAUGHMAN SURVEYING SERVICE, ROSEBURG, OREGON**

JANUARY 1975

SCALE: 1" = 400'

FILED
RECEIVED 2/4
FEB 12 1975
COUNTY SURVEYOR
DOUGLAS COUNTY, ORE.

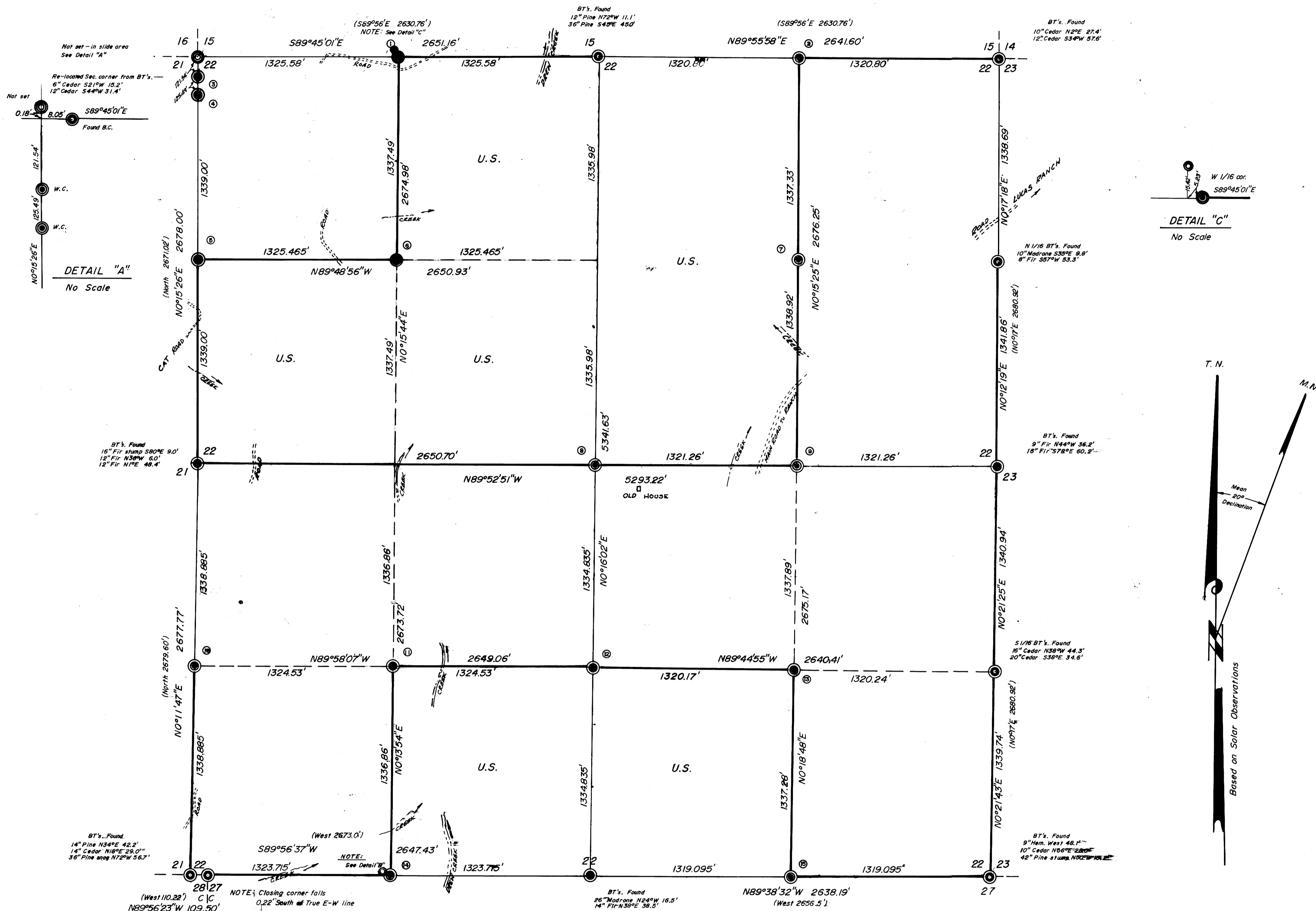

DETAIL "A"
No Scale

DETAIL "C"
No Scale

DETAIL "B"
No Scale

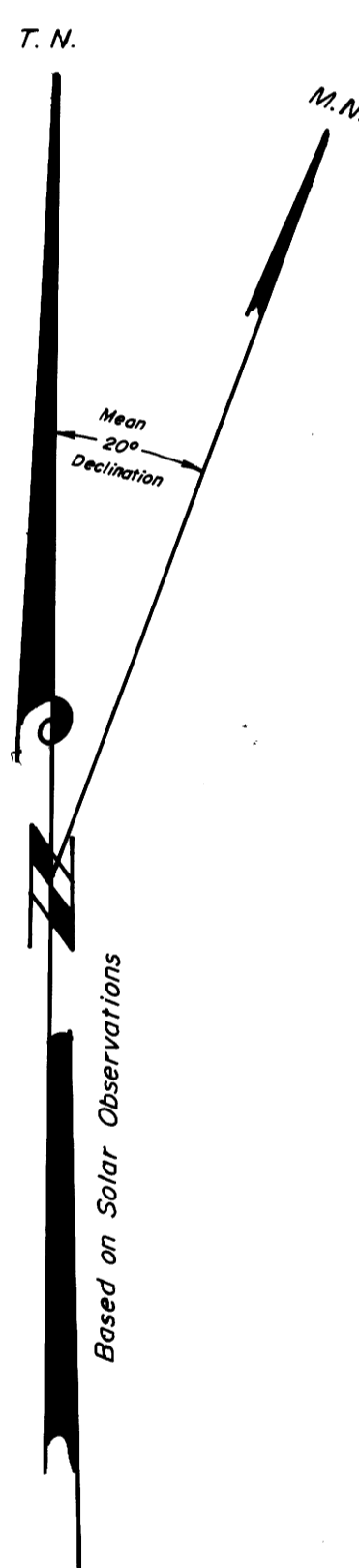

LEGEND

- ⊙ — Found Brass cap
- — Set Brass cap
- ⊙ — Found 1/2" iron pipe (no record)
- True line posted with steel fence posts and government property signs.
- () — Record Calls
- See page number as indicated, i.e. 1 thru 5, on form no. RS-7600-57 Certified Record of Land Corner Monumentation.

I, GLENN S. BAUGHMAN, a registered professional land surveyor in the State of Oregon hereby certify that this plat and the notes hereon attached, are a correct representation of a survey I performed during October thru December 1974 and January 1975, for the U.S. Forest Service, in accordance with statutes of the State of Oregon and with the Articles of my contract.

REGISTERED
PROFESSIONAL
LAND SURVEYOR
Glenn S. Baughman
GLENN S. BAUGHMAN
OREGON
JULY 18 1961
GLENN S. BAUGHMAN
536

CERTIFIED RECORD OF LAND CORNER MONUMENTATION

History of original corner establishment:

NONE

DIAGRAM
T31S R2W
C 1/4 S22

RLS 536 1975

Description of corner evidence found:

NONE

REGISTERED
PROFESSIONAL
LAND SURVEYOR

Glenn S. Baughman
OREGON
1914
GLENN S. BAUGHMAN
536

Description of monument and accessories I established to perpetuate the original location of this corner

I set a 30 inch long, 2 1/2 inch diameter galvanized iron pipe 25 inches in the ground, with mound of rock, with a 3 inch Brass Cap stamped:

T31S R2W
C 1/4 S22
RLS 536 1975

BEARING TREES:

A Cedar, 11 inches diameter bears S19°E. 16.2 feet scribed C 1/4 S22 (BT) with brass washer stamped LS 536 nailed at BT. Blaze

A white Fir 7 inches diameter bears S.78°W. 13.1 feet with brass washer stamped LS 536 nailed at BT Blaze.

NOTE: Both trees have a 6 inch red band painted around trees. CORNER lies in edge of fir and Cedar thicket. Corner bears N.51°W. 196. feet from Northwest corner of partially collapsed building, and 3 feet South of old Blaze line.

From Book #2, page #35, Tiller Land Survey #14 - Contract #004610N.

Office of *Sheriff* County of *Douglas*
State of *Oregon*, I hereby certify that the within instrument was filed in this office for record on the *12* day of *February*.
Thomas L. Ingram by *Virginia A. Yates*
(COUNTY OFFICIAL) (DEPUTY)

CERTIFIED RECORD OF LAND CORNER MONUMENTATION

History of original corner establishment:

August 19, 1857
 ORIGINAL CORNER set post to Corner of Section
 15/16/21/22 from which
 A Fir 18 inch diameter bears S10°E 68 lks.
 A Laurel 18 inch diameter bears S27°W 58 lks.
 A Laurel 10 inch diameter bears N45°E 40 lks.
 A Cedar 24 inch diameter bears N43°W 31 lks.

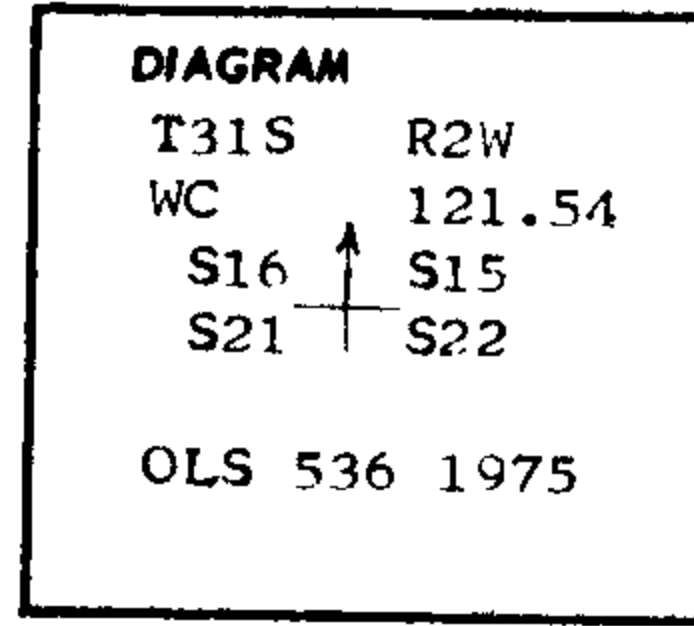

Description of corner evidence found:

I find a 1 inch galvanized iron pipe with brass cap stamped :
 7 inch cedar bears N2°W 12.0 feet scribed
 T31S R2W S16 CS BT
 8 inch Cedar bears N47°W 15.5 feet scribed
 T31S R2W S16 CS BT
 6 inch Cedar bears S21°W 15.2 feet scribed
 T31S R2W visible
 12 inch Cedar bears S44°W 33.1 feet at @ 18°30', scribed
 T31S R2W S21 Cs BT
 CORNER lies in recent slide: I leave the County Brass Cap out of position:
 I reestablish corner position by County Surveyors bearing trees, using the
 6 inch and 12 inch Cedars, which lie outside slide area; I then set Witness
 Corner on the South line between Sections 21/22 outside of active slide area.

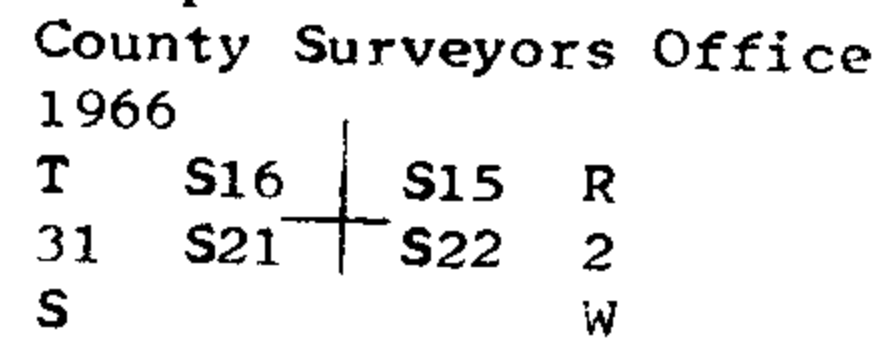

Description of monument and accessories I established to perpetuate the original location of this corner

I set a 30 inch long, 2 1/2 inch diameter galvanized iron pipe 26 inches in the ground, in a mound of stones, with a 3 inch brass cap stamped:

BEARING TREES:

A Cedar 10 inch diameter bears S79°E. 32.6 feet scribed WC T31S R2W S21 (BT) with brass washer stamped LS 536 nailed at BT. Blaze

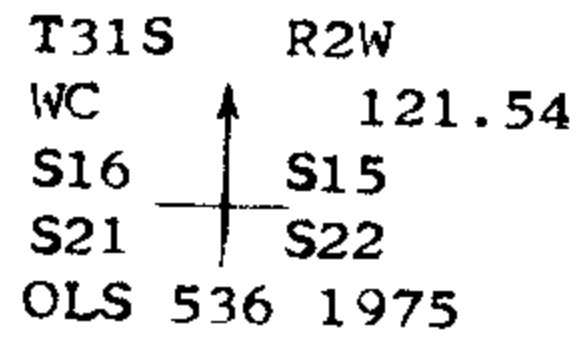

A Cedar 8 inch diameter bears S32°W 29.3 feet Scribed W.C. T31S R2W S22 (BT) with brass washer stamped Ls 536 nailed at BT. Blaze.

NOTE: Both trees have a 6 inch red band painted around tree.

CORNER lies 121 feet South of draw and slide area.

From Book # **2** , page # **37** , Tiller land Survey #14, Contract #004610N.

Office of Surveyors County of Douglas
 State of Oregon I hereby certify that the within instrument was filed in this office
 for record on the 17 day of February

Trammie L. Rose by Virginia A. Jatta
 (COUNTY OFFICIAL) (DEPUTY)

**REGISTERED
 PROFESSIONAL
 LAND SURVEYOR**

Handwritten Signature
 OREGON
 G. T. ... SURVEYOR
 536

CERTIFIED RECORD OF LAND CORNER MONUMENTATION

History of original corner establishment: August 19, 1857

ORIGINAL CORNER
 Set post to corner Sections 15/16/21/22 from which
 A Fir 18 inches diameter bears S. 10° E. 68 lks
 A Laurel 18 inches diameter bears S. 27° W. 58 lks
 A Laurel 10 inches diameter bears N. 45° E. 40 lks
 A Cedar 24 inches diameter bears N. 43° W. 31 lks

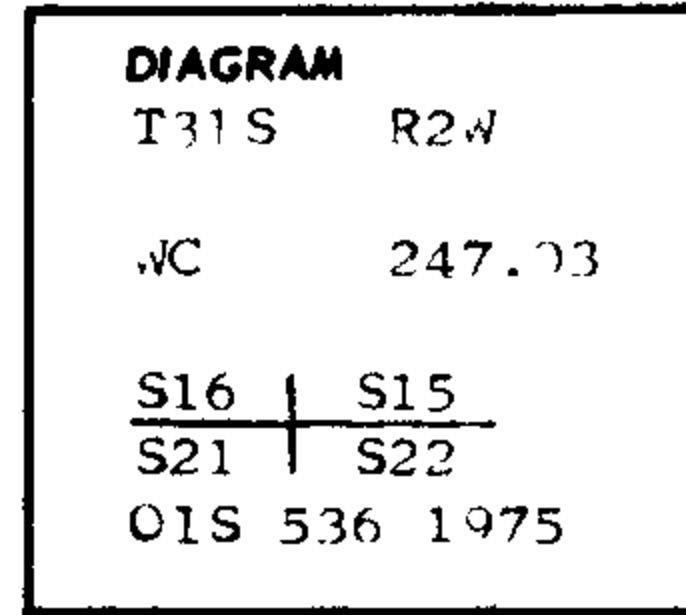

Description of corner evidence found:

I find a 1 inch galvanized iron pipe with brass cap stamped:

A 7 inch cedar bears N. 2° W. 12.0 feet scribed
 T 31S R 2W S S 16 CS (BT)
 A 8 inch cedar bears N. 47° W. 15.5 feet scribed
 T 31S R 2 W S 16 CS (BT)
 A 6 inch cedar bears S. 21° W. 15.2 feet scribed
 T 31S R 2 W visible
 A 12 inch cedar bears S. 44° W. 33.1 @ 18° 30' scribed T 31S R 2 W S 21 CS (BT)

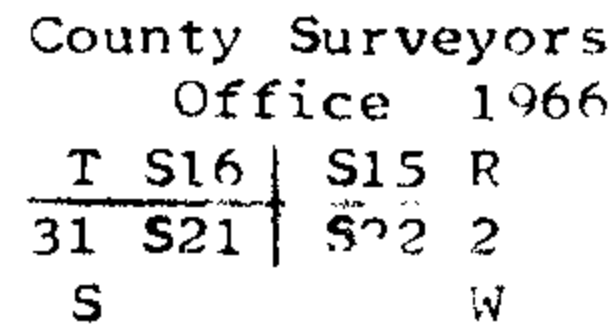

The corner lies in recent slide. I leave the County brass cap out of position. I reestablish corner position by County Surveyors bearing trees which lie outside of the slide area, a 6 inch and 12 inch cedar. Then I set the witness corner on South line of S 21 S 22 outside of slide area.

Description of monument and accessories I established to perpetuate the original location of this corner

I set a 30 inch long 2 1/2 inch diameter galvanized iron pipe 24 inches in the ground, in a mound of stone with a 3 inch brass cap stamped:

Bearing Trees:

A Cedar 7 inches diameter bears S. 56° E. 9.8 feet scribed: WC T 31S R 2 W S 22 (BT) with brass washer stamped CS 536 nailed at B. T. Blaze

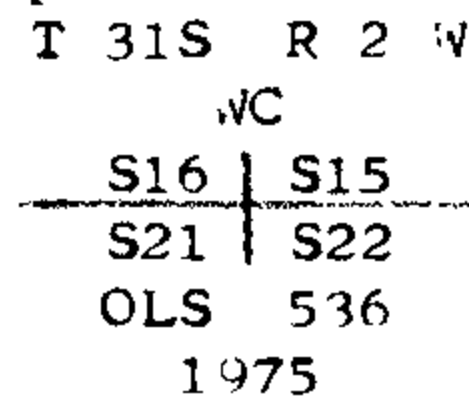

A Douglas Fir 9 inches diameter bears N. 12° W. 9.0 feet scribed: WC T 31S R 2 W S 21 (BT) with brass washer stamped CS 536 nailed at B. T. Blaze

Note: Both trees have 6 inch red band painted around the tree corner. It lies on steep East slope approximately 100 feet East of ridge top and 247 feet South of draw.

From book # 2 pag 38 Tiller Land Survey # 14 Contract #004610N

Office of Surveyors County of Douglas
 State of Oregon I hereby certify that the within instrument was filed in this office
 for record on the 12 day of February
Thomas P. Johnson by Virginia A. Yates
 (COUNTY OFFICIAL) (DEPUTY)

CERTIFIED RECORD OF LAND CORNER MONUMENTATION

History of original corner establishment:

NONE

DIAGRAM
T31S R2W
NW 1/16 S22

PLS 536 1975

Description of corner evidence found:

NONE

REGISTERED
PROFESSIONAL
LAND SURVEYOR

Glenn S. Daughman
OREGON
GLENN S. DAUGHMAN
536

Description of monument and accessories I established to perpetuate the original location of this corner

I set a 30 inch long, 2 1/2 inch diameter galvanized iron pipe 24 inches in the ground, in mound of stones, with 3 inch Brass Cap stamped:

BEARING TREES:

T31S R2W
NW 1/16 S22
PLS 536 1975

X A Cedar, 8 inch diameter bears N20°E. 23.6 feet scribed NW 1/16 S22 (BT) with brass washer stamped LS 536 nailed at BT. Blaze

A Cedar, 7 inch diameter bears N.49°W. 40.2 feet scribed NW 1/16 S22 (BT) with brass washer stamped LS 536 nailed at BT. Blaze

NOTE: Both trees have a 6 inch red band painted around tree.

CORNER lies on steep rocky East slope, immediately East of 3 foot high rock drop, approximately 450 feet East of road.

From Book # 2, page 39, Tiller Land Survey #14 - Contract #004610N.

Office of *Surveyor* County of *Douglas*
State of *Oregon*, I hereby certify that the within instrument was filed in this office for record on the *12* day of *February*
Thomas L. Rogers by *Magiana P. Yates*
(COUNTY OFFICIAL) (DEPUTY)

CERTIFIED RECORD OF LAND CORNER MONUMENTATION

History of original corner establishment:

NONE

DIAGRAM
T31S R2W
N 1/16
S21/S22
OLS 536 1975

Description of corner evidence found:

NONE



Description of monument and accessories I established to perpetuate the original location of this corner

I set a 30 inch long, 2 1/2 inch galvanized iron pipe 26 inches in ground, in mound of stones, with 3 inch brass cap stamped:

T31S R2W
N 1/16
S21/S22
OLS 536 1975

BEARING TREES:

A Pine, 9 inch diameter bears N.28°30'W. 12.6 feet scribed N. 1/16 S21 (BT) with brass washer stamped LS 536 nailed at BT. Blaze

A Pine, 23 inch diameter bears N.72°E. 41.3 feet, scribed N 1/16 S.22 (BT) with brass washer stamped LS 536 nailed at BT. Blaze

NOTE: Both trees have a 6 inch band of Red painted around trees.

CORNER lies on gentle East slope approximately 25 feet East of center line of Ranch Road and 3 feet East of 24 inch Cedar; also approximately 55 feet North of North and East fence corner.

From Book # 2, page # 36, Tiller Land Survey # 14, Contract #004610N.

Office of Lawyer County of Douglas

State of Oregon, I hereby certify that the within instrument was filed in this office

for record on the 12 day of February

Franklin D. Ingram by Virginia C. Yates

(COUNTY OFFICIAL)

(DEPUTY)

CERTIFIED RECORD OF LAND CORNER MONUMENTATION

History of original corner establishment:

NONE

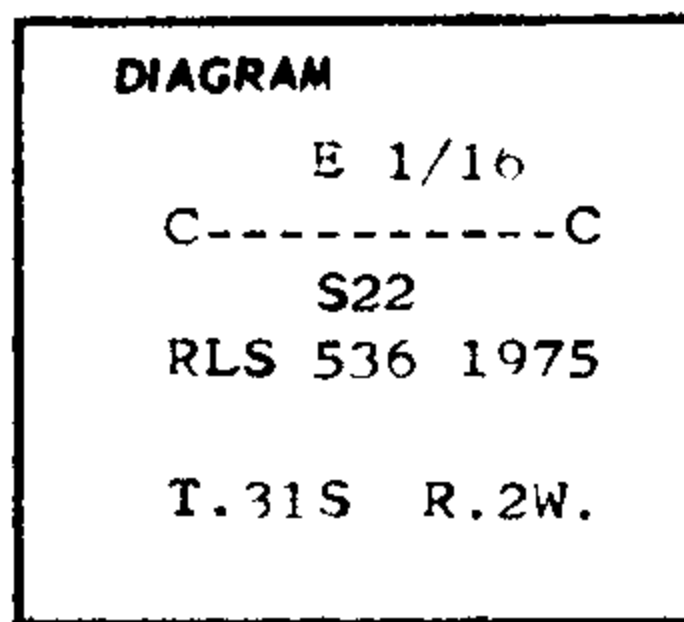

Description of corner evidence found:

NONE



Description of monument and accessories I established to perpetuate the original location of this corner

I set a 30 inch long, 2 1/2 inch diameter galvanized iron pipe, with a mound of stones, 26 inches in ground, with brass cap stamped: T.31S. R.2W. E 1/16 C-----C S22 RLS 536 1975

BEARING TREES:

A Madrona 11 inches in diameter bears S38°E. 19.3 feet scribed C E. 1/16 S22 (BT) with brass washer stamped LS 536 nailed at BT. Blaze

A Fir, 8 1/2 inches in diameter bears N.50°W. 19.0 feet, scribed C E. 1/16 S.22 (BT) with brass washer stamped LS 536 nailed at BT blaze.

NOTE: Both trees have a 6 inch red band painted around tree.

CORNER lies on steep N.E. slope in small Cedar and Madrona thicket, approximately 170 feet East of Ranch Road.

From Book # 2 , page # 34, Tiller Land Survey #14, Contract #004610N.

Office of *Surveyor* County of *Douglas*

State of *Oregon* .. , I hereby certify that the within instrument was filed in this office for record on the *12* day of *February* ..

Thomas D. Ingram by *Virginia A. Yates* ..

(COUNTY OFFICIAL) (DEPUTY)

CERTIFIED RECORD OF LAND CORNER MONUMENTATION

History of original corner establishment:

None

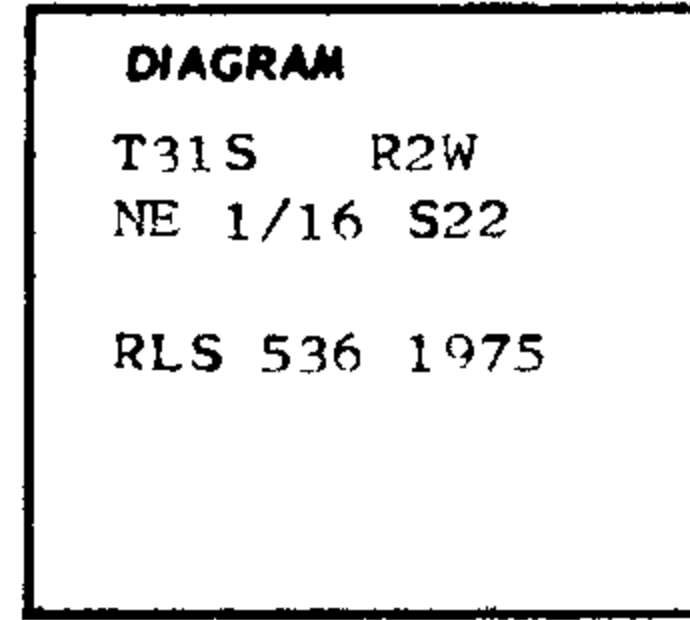

Description of corner evidence found:

NONE



Description of monument and accessories I established to perpetuate the original location of this corner

I set a 30 inch long, 2 1/2 inch diameter galvanized iron pipe, in mound of stone, 26 inches in ground with 3 inch Brass Cap stamped:

BEARING TREES:

T31S R2W
NE 1/16
RLS 536 1975

A Fir, 8 inch diameter bears S43°E. 7.0 feet scribed N.E. 1/16 S22 (BT) with Brass washer stamped LS 536 nailed at BT Blaze.

A Fir 8 inch diameter bears S.80°W. 19.9 feet scribed N.E. 1/16 S22 (BT) with brass washer stamped LS 536 nailed at BT Blaze.

NOTE: Both trees have a 6 inch red band painted around trees.

CORNER lies on a South-West slope approximately 80. feet North from North and East Timber Line Corner.

From Book # 2 , page# 33, Tiller Land Survey # 14 Contract #004610N.

Office of *Surveyor* County of *Douglas*
State of *Oregon*, I hereby certify that the within instrument was filed in this office
for record on the *12* day of *February*.
Francis P. Ingram by *Virginia A. Yates*
(COUNTY OFFICIAL) (DEPUTY)

CERTIFIED RECORD OF LAND CORNER MONUMENTATION

History of original corner establishment:

NONE

DIAGRAM
T31S R2W
E 1/16
S15
S22
RLS #536 1975

Description of corner evidence found:

NONE

REGISTERED
PROFESSIONAL
LAND SURVEYOR
Glenn S. Baughman
OREGON
JULY 14 1951
GLENN S. BAUGHMAN
536

Description of monument and accessories established to perpetuate the original location of this corner

I set a 30 inch long 2 1/2 inch diameter galvanized iron pipe 26 inches in the ground, in a mound of stones, with a 3 inch brass cap marked:

BEARING TREES

T31S R2W
S15
E 1/16 S22
RLS 536 1975

A 10 inch Fir bears N26°W 33.0 feet scribed
E 1/16 S15 BT. with a brass washer stamped LS
536 nailed at Bt. Blaze

A 10 inch Cedar bears S75°W. 43.0 feet scribed
E. 1/16 S22 BT. with a brass washer stamped LS 536 nailed at BT. Blaze

NOTE:

Both trees have a 6 inch red band painted around tree.

CORNER lies on West slope at timber line.

From Book #2, page #32, Tiller Land Survey #14, Contract #004610N.

Office of *Surveyor* County of *Douglas*
State of *Oregon*, I hereby certify that the within instrument was filed in this office
for record on the *12* day of *February*
Fleming R. Sogard, by *Virginia C. Yates*
(COUNTY OFFICIAL) (DEPUTY)

CERTIFIED RECORD OF LAND CORNER MONUMENTATION

History of original corner establishment:

NONE

DIAGRAM
T31S R2W
S 1/16
S21/S22
RLS 536 1974

Description of corner evidence found:

NONE



Description of monument and accessories I established to perpetuate the original location of this corner

I set a 30 inch long 2 1/2 inch diameter galvanized iron pipe 26 inches in the ground, in a mound of stones, with a 3 inch brass cap stamped:

BEARING TREES

A 8 inch white Fir bears S40°W 15.8 feet scribed S 1/16 S21 (BT) Brass washer marked LS 536 nailed at BT. Blaze

A 11 inch Cedar bears N26 1/2°E. 59.8 feet scribed S 1/16 S22 (BT) Brass washer marked LS 536 nailed at BT. Blaze

T31S R2W
S 1/16
S21/S22
RLS 536 1974

NOTE: Both trees have a 6 inch red band painted around tree.

CORNER lies on East slope approximately 175 feet West of Road next to North-South timber line, approximately 20 feet South of small spring.

From Book #2, page #31, Tiller Land Survey #14, Contract #004610N.

Office of Surveyor County of Douglas
State of Oregon, I hereby certify that the within instrument was filed in this office for record on the 102 day of February.
Travis P. Ingram by Virginia A. Yates
(COUNTY OFFICIAL) (DEPUTY)

CERTIFIED RECORD OF LAND CORNER MONUMENTATION

History of original corner establishment:

NONE

DIAGRAM
T31S R2W
SW 1/16 S22

RLS 536 1975

Description of corner evidence found:

NONE



Description of monument and accessories I established to perpetuate the original location of this corner

I set a 30 inch long, 2 1/2 inch diameter galvanized iron pipe in a mound of stones, 26 inches in the ground, with brass cap stamped:

BEARING TREES:

A Cedar 7 inch diameter bears N.43°E. 7.9 feet scribed SW 1/16 S22 (BT) with brass washer stamped LS 536 nailed at BT Blaze.

A Cedar 8 inch diameter bears N.35°W. 21.1 feet scribed SW 1/16 S22 (BT) with brass washer stamped LS 536 nailed at BT Blaze.

NOTE: Both trees have a 6 inch red band painted around tree.

Corner lies on gradual NorthEast slope, approximately 85 feet south of a small draw and about 400 feet west of Drew Creek.

From Book **2** Page **30** Tiller Land Survey Contract No. 004610N

T31S R2W
SW 1/16 S22
RLS 536 1975

Office of *Surveyor* County of *Douglas*
State of *Oregon* .. I hereby certify that the within instrument was filed in this office
for record on the *12* day of *February* ..
Thomas L. Baughman by *Virginia A. Yates* ..
(COUNTY OFFICIAL) (DEPUTY)

e

CERTIFIED RECORD OF LAND CORNER MONUMENTATION

History of original corner establishment:

NONE

DIAGRAM
T31S R2W
W 1/16 S22 ONLY
On South Line
RLS 536 1974

Description of corner evidence found:

Found 1/2 inch iron pipe set 16 inches above ground with no Bearing Trees.
No record of this Corner.

REGISTERED
PROFESSIONAL
LAND SURVEYOR
Glenn S. Baughman
OREGON
JULY 14 1955
GLENN S. BAUGHMAN
536

Description of monument and accessories established to perpetuate the original location of this corner

I set a 30 inch long, 2 1/2 inch diameter galvanized iron pipe in mound of stones, 26 inches in the ground, with brass cap stamped:

BEARING TREES:

A Cedar, 8 inch diameter bears N.26°E. 28.1 feet scribed W. 1/16 S22 (BT) with brass washer stamped LS 536 nailed at BT Blaze.

A Cedar 9 inch diameter bears N.77°W. 17.4 feet, scribed W. 1/16 S22 (BT) with brass washer stamped: LS 536 nailed at BT Blaze.

NOTE: Both trees have a 6 inch red band painted around tree.

CORNER falls on gradual East slope approximately 450 feet West from Drew Creek; also East 30 feet from timber line.

From Book **5** Page **29** Tiller Land Survey No. 14 Contract No. 004610N

Office of *Surveyor* County of *Douglas*
State of *Oregon*, I hereby certify that the within instrument was filed in this office for record on the *102* day of *February* ..
Franklin S. Baughman by *Virginia A. Yates*
(COUNTY OFFICIAL) (DEPUTY)

CERTIFIED RECORD OF LAND CORNER MONUMENTATION

History of original corner establishment:

NONE

DIAGRAM
T31S R2W
E 1/16 S22 ONLY
On South Line
1974 OLS 536

Description of corner evidence found:

NONE



Description of monument and accessories I established to perpetuate the original location of this corner

I set a 30 inch long, 2 1/2 inch diameter galvanized iron pipe 25 inches in the ground, in a mound of stones, with a 3 inch brass cap marked:

BEARING TREES:

T31S R2W
E. 1/16 S22
1974 OLS 536

A Madrone, 9 inch diameter bears N 52°30'W. 64.6 feet scribed E. 1/16 S.22 (BT) with a brass washer stamped LS 536 nailed at BT. Blaze

A Fir, 10 inch diameter bears N.59°W. 96.2 feet scribed E. 1/16 S.22 (BT) with a brass washer stamped LS 536 nailed at BT. Blaze

NOTE: Both trees have a 6 inch red band painted around tree.

Corner lies approximately 12 feet South from East-West-North-South fence corner; also at above said corner of timber line.

From Book #2, page 28, Tiller Land Survey #14 - Contract #004610N.

Office of *Surveyor* County of *Douglas*
State of *Oregon* I hereby certify that the within instrument was filed in this office
for record on the *12* day of *February*
Fannie L. Grogan by *Virginia A. Yates*
(COUNTY OFFICIAL) (DEPUTY)

CERTIFIED RECORD OF LAND CORNER MONUMENTATION

History of original corner establishment:

NONE

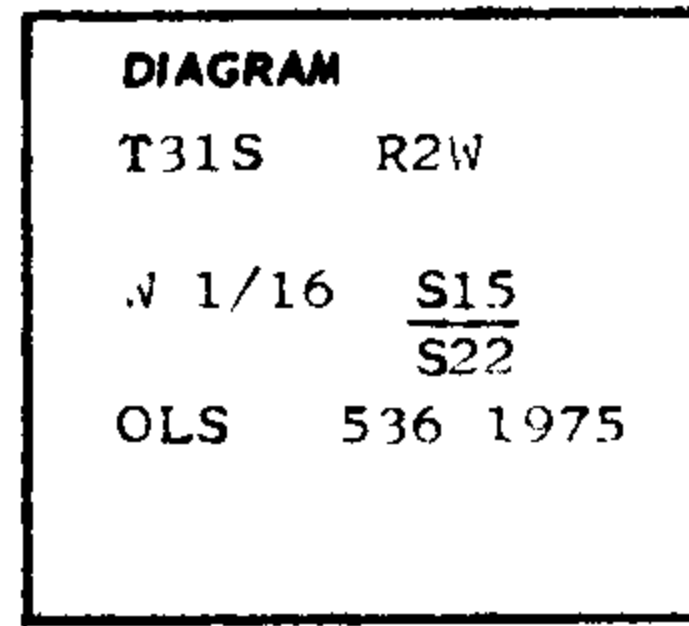

Description of corner evidence found:

Found unidentified 1/2 Inch iron pipe, in mound of stones.
It lies N.18°43'W. 16.28 feet from our corner.

No bearing trees identified.

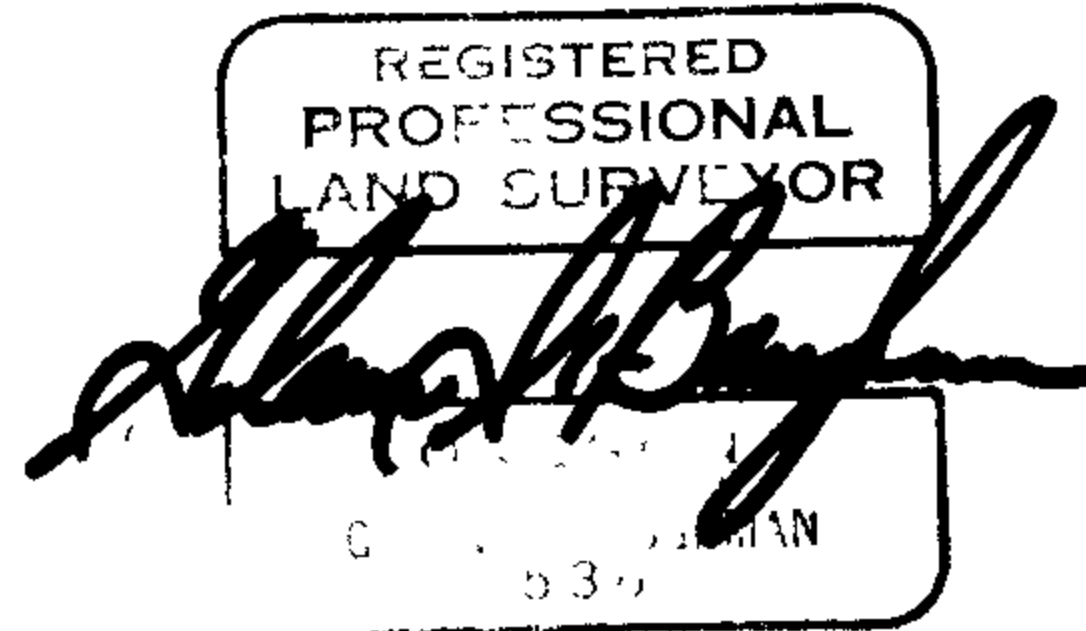

Description of monument and accessories I established to perpetuate the original location of this corner

I set a 30 inch long 2 1/2 inch diameter galvanized pipe 26 inches in the ground, in a mound of stones, with a 3 inch Brass Cap stamped:

T31S R2W

BEARING TREES:

W 1/16 S15
S22

A 10 inch Fir bears N.56°E. 4.8 feet, scribed W. 1/16 S15 BT
With a brass washer stamped Ls 536 nailed at BT. Blaze

OLS 536 1975

A 7 inch Madrona bears S45°W. 16.8 feet scribed W 1/16 S22 BT
with a brass washer stamped LS 536 nailed at BT. Blaze

NOTE: Both trees have a 6 inch red band painted around the tree.

From book #2, page #40, Tiller Land Survey #14, Contract #004610N.

Office of Surveyor County of Douglas
 State of Oregon I hereby certify that the within instrument was filed in this office
 for record on the 12 day of February ..
Thomas L. Ingram by Virginia C. Yates ..
 (COUNTY OFFICIAL) (DEPUTY)

CERTIFIED RECORD OF LAND CORNER MONUMENTATION

History of original corner establishment:

NONE

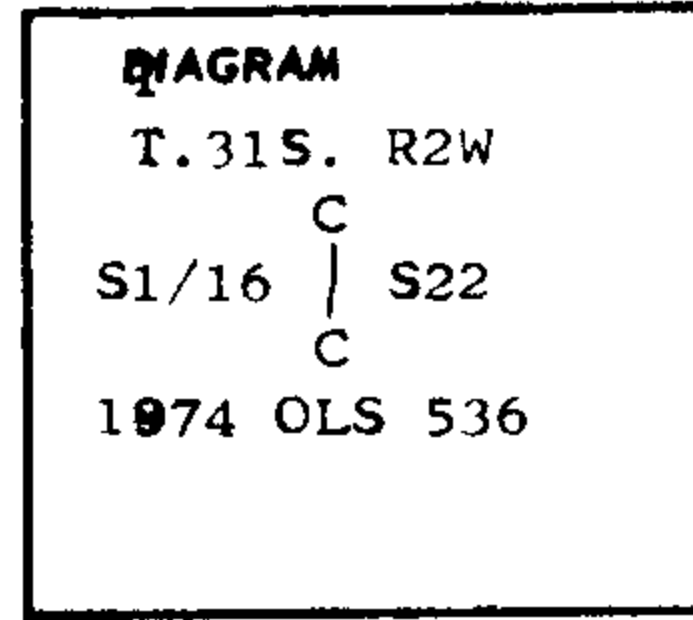

Description of corner evidence found:

NONE



Description of monument and accessories I established to perpetuate the original location of this corner

I set a 30 inch long, 2 1/2 inch diameter galvanized iron pipe 26 inches in the ground, in a mound of stones, with a 3 inch brass cap marked:

Bearing Trees:

A Cedar, 8" inches diameter bears S.43°W. 17.3 feet scribed CSI/16 S22 (BT) with a brass washer stamped LS 536 nailed at BT. Blaze

T31S R2W
 S1/16 C S22
 1974 OLS 536

A Cedar, 8 inches diameter bears S 81°E. 6.2 feet scribed CSI/16 S22 (BT) with a brass washer stamped LS 536 nailed at B.T. Blaze

NOTE: Both trees have a 6 inch red band painted around tree.

Corner lies approximately 17 feet South of East-West fence line.

From Book #2, page 26, Tiller Land Survey #14- Contract #004610N.

Office of *Surveyor* County of *Douglas*
 State of *Oregon*, I hereby certify that the within instrument was filed in this office for record on the *12* day of *February*
Francis P. Ferguson by *Virginia A. Yates*
 (COUNTY OFFICIAL) (DEPUTY)

CERTIFIED RECORD OF LAND CORNER MONUMENTATION

History of original corner establishment:

NONE

DIAGRAM
T31S R2W

SE1/16 S22
1974 OLS 536

Description of corner evidence found:

NONE

REGISTERED
PROFESSIONAL
LAND SURVEYOR

Glenn S. Baughman

OREGON
JULY 14 1961
GLENN S. BAUGHMAN
536

Description of monument and accessories I established to perpetuate the original location of this corner

I set a 30-inch long, 2 1/2 inch diameter galvanized iron pipe 26 inches in the ground, in a mound of stones, with a 3-inch brass cap marked:

Bearing trees: T31S R2W
SE1/16 S22
1974 OLS 536
A Cedar, 10 inches diameter bears
N 50° W 20.7 feet scribed SE1/16 S22 (BT)
with a brass washer stamped LS 536 nailed at BT. Blaze

A Fir, 11 inches diameter bears S 33° W
44.6 feet scribed SE1/16 S22 (BT) with a
brass washer stamped LS 536 nailed at BT. Blaze

NOTE: Both trees have a 6-inch red band painted around tree.

Corner lies approximately 5 feet East from North-South-East-West fence corner and approximately 150 feet West from North-South draw.

From Book #2, page 27, Tiller Land Survey #14 - Contract #004610N.

Office of *Surveyor* County of *Douglas*
State of *Oregon* I hereby certify that the within instrument was filed in this office
for record on the *12* day of *February* 19*74*., at *11:30* o'clock *A.m.*, (signed)
Franklin J. Suggs by *Virginia A. Zatta*
(COUNTY OFFICIAL) (DEPUTY)