

COUNTY SURVEYORS FILE DATA
DO NOT REMOVE FROM OFFICE

MAP FILE M55-63

FILED
RECORDED 7/7

MINOR LAND PARTITIONING
SECTIONS 14 & 23, T26S R4W, W.M.
Surveyed by Don E. Garrett
July, 1973
o Set 5/8" I. Rod
o Fd. 5/8" I. Rod
Scale 1" = 100'

PARTITIONER John D. Connine
Glide, Oregon
496-3245

LEGAL OWNERS OF RECORD
John D. & Helen M. Connine
Husband & Wife
Glide, Oregon

TOTAL NO. OF LOTS 1

WATER SUPPLY

SEWAGE DISPOSAL

MAP PREPARED BY DON E. GARRETT
450 W. Cochrane Lane
Roseburg, Oregon 97470
Tel. 672-1487

Legal Description

A parcel of land lying in Sections 14 & 23, Township 26 South, Range 4 West, Willamette Meridian, said parcel being more particularly described as follows:

Beginning at a 5/8" iron rod set in the South Line of the North Umpqua Highway, from which point the Northeast Corner of the above said Section 23 bears South 627.14 feet and East 915.00 feet; thence along the above said South Line S 61° 29' 34" E 34.35 feet to a 5/8" iron rod; thence along a fenceline S 0° 38' 40" E 610.50 feet to a 5/8" iron rod set in the North Line of the above said Section 23; thence along said North Line S 89° 58' 56" E 52.94 feet to the Exterior "L" Corner of DLC 43; thence along the East Line of DLC 40 South 587.40 feet to the Southeast Corner thereof; thence along the South Line of said DLC 40 S 89° 52' 24" W 361.96 feet to a 5/8" iron rod; thence N 0° 12' 20" W 1187.59 feet to a 5/8" iron rod; thence N 89° 06' 19" E 276.52 feet to a 5/8" iron rod; thence S 61° 29' 34" E 22.98 feet to a 5/8" iron rod; thence N 0° 38' 40" W 34.35 feet to the place of beginning and containing 9.18 acres of land more or less.

The above described parcel of land is subject to a road easement described as follows:

Beginning at a 5/8" iron rod set in the South Line of the North Umpqua Highway, from which point the Northeast Corner of the above said Section 23 bears South 627.14 feet and East 915.00 feet; thence along the above said South Line S 61° 29' 34" E 34.35 feet to a 5/8" iron rod; thence along a fenceline S 0° 38' 40" E 34.35 feet; thence N 61° 29' 34" W 34.35 feet to a 5/8" iron rod; thence N 0° 38' 40" W 34.35 feet to the place of beginning.

REGISTERED
PROFESSIONAL
LAND SURVEYOR
Don E. Garrett
OREGON
JULY 14, 1981
DON E. GARRETT
544

5
9.18 Ac. ±

EXT. 'L' DLC 43
Fd. Brass Cap
12" W. Oak Bears N14°30'E 55.2'

587.40
South

Fd. Brass Cap SE DLC 40
9" Madrone Bears South 1.7'
10" B. Oak (Clump) Bears N66°15'W

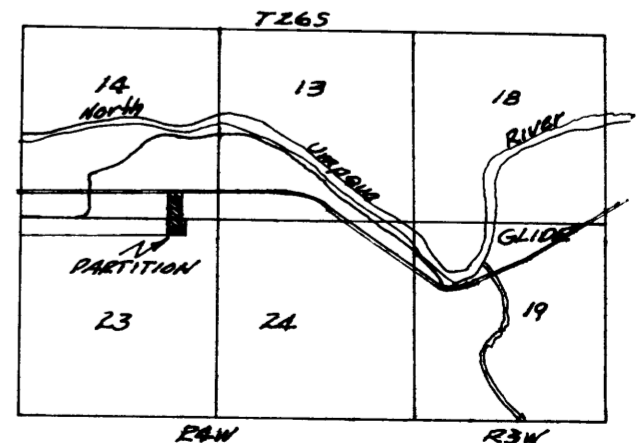

SOLD TO ADJACENT PROPERTY - NOT A M.L.P.

MAP FILE M55-63