

300
74-14091
STATE OF OREGON
COUNTY OF DOUGLAS
I, G. D. Myllenbeck, County Clerk and ex-officio
Recorder of Conveyances, in and for said County,
do hereby certify that the within instrument is
dated OCT 16 1974 3:01 P.
Recorded in Volume 557
Page 87 of Minor Land
Records of Douglas County, Oregon.
G. D. Myllenbeck
County Clerk
Mary J. Beal

PARTITIONER:

Veo Eugene Latham
P.O. Box 734
Winston, OR 97496
673-3653

FILED
RECEIVED
OCT 16 1974

COUNTY SURVEYOR
DOUGLAS COUNTY, ORE.

LEGAL OWNER OF
RECORD: same

TOTAL NUMBER OF LOTS: 2

SEWAGE DISPOSAL: septic tanks

WATER SUPPLY: wells

MAP PREPARED BY:

Harold Ball, C.E.
Route 3, Box 4000
Roseburg, OR 97470
673-6937

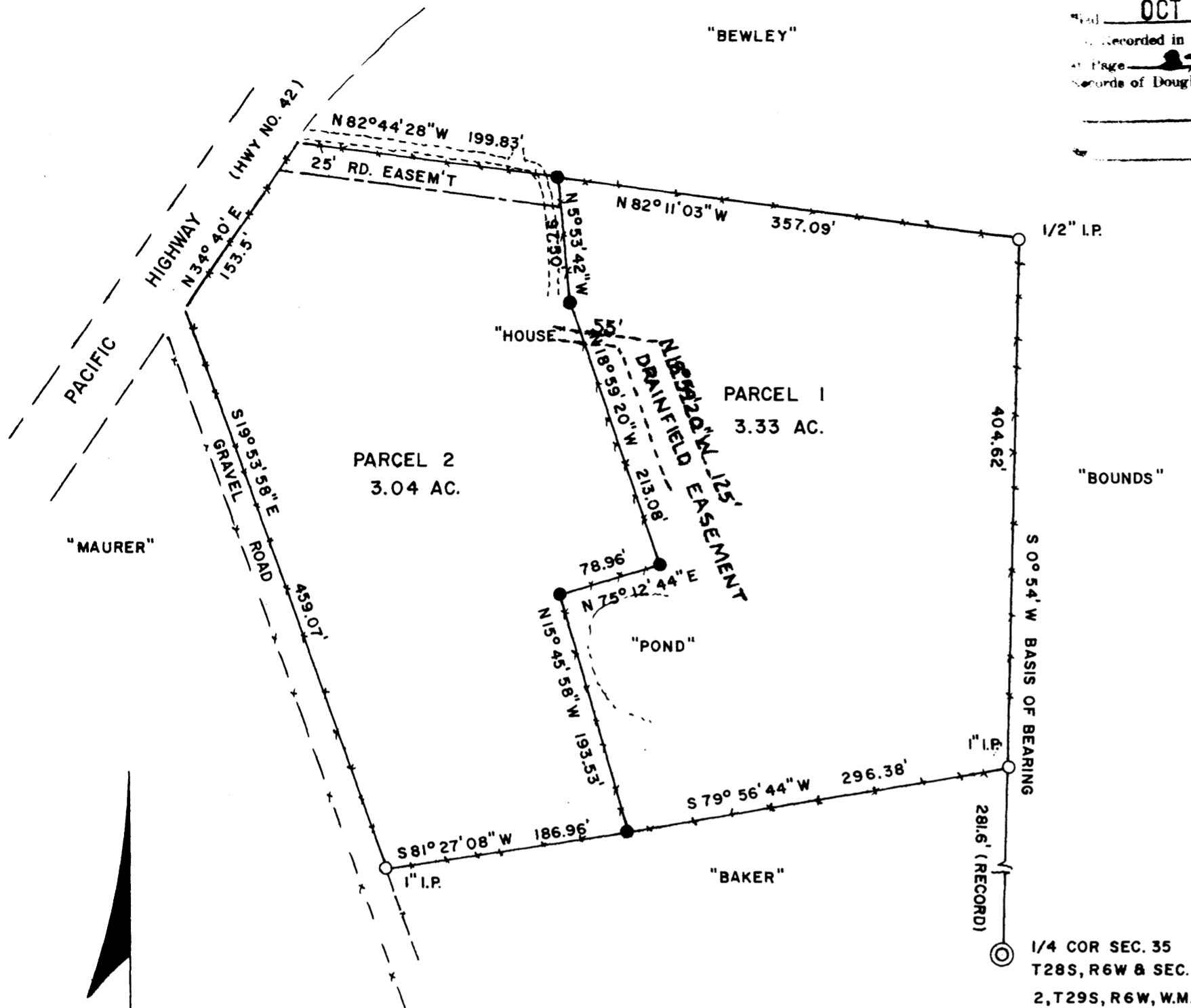

"BOUNDS"

LEGAL DESCRIPTION

Parcel No. 1 - Beginning at a 1-inch iron pipe on the East line of Lot 11, Coon's Dillard Subdivision, Douglas County, Oregon, from which the 1/4 corner of Section 35, Township 28 South, Range 6 West, and Section 2, Township 29 South, Range 6 West, Willamette Meridian bears South 0°54' West 281.6 feet; thence North 0°54' East 404.62 feet along the East line of said Lot 11 to a 1/2-inch iron pipe at the Northeast corner of that certain parcel of land conveyed to Eldon Shetler et ux as shown in Book 517 at Page 550, Douglas County Records; thence North 82°11'03" West 357.09 feet along the Northerly line of said Shetler parcel to a 5/8-inch iron rod; thence South 5°53'42" East 97.50 feet to a 5/8-inch iron rod; thence South 18°59'20" East 213.08 feet to a 5/8-inch iron rod; thence South 75°12'44" West 78.96 feet to a 5/8-inch iron rod; thence South 15°45'58" East 193.53 feet to a 5/8-inch iron rod in the Southerly line of said Shetler parcel; thence North 79°56'44" East 296.38 feet along said Southerly line to the point of beginning.

Parcel No. 2 - Commencing at a 1-inch iron pipe on the East line of Lot 11, Coon's Dillard Subdivision, Douglas County, Oregon, from which the 1/4 corner of Section 35, Township 28 South, Range 6 West, and Section 2, Township 29 South, Range 6 West, Willamette Meridian bears South 0°54' West 281.6 feet; thence North 0°54' East 404.62 feet along the East line of said Lot 11 to a 1/2-inch iron pipe at the Northeast corner of that certain parcel of land conveyed to Eldon Shetler et ux as shown in Book 517 at Page 550, Douglas County Records; thence North 82°11'03" West 357.09 feet along the Northerly line of said Shetler parcel to a 5/8-inch iron rod and the true point of beginning; thence South 5°53'42" East 97.50 feet to a 5/8-inch iron rod; thence South 18°59'20" East 213.08 feet to a 5/8-inch iron rod; thence South 75°12'44" West 78.96 feet to a 5/8-inch iron rod; thence South 15°45'58" East 193.53 feet to a 5/8-inch iron rod in the Southerly line of said Shetler parcel; thence South 81°27'08" West 186.96 feet along said Southerly line to a 1-inch iron pipe in the Westerly line of said Shetler parcel; thence North 19°53'58" West 459.07 feet more or less along said Westerly line to the Southerly line of State Highway No. 42; thence North 34°40' East 153.5 feet along said Southerly line of State Highway No. 42 to a point in the Northerly line of said Shetler parcel; thence South 82°44'28" East 199.83 feet along said Northerly line to the point of beginning.

Reserving therefrom a 25-foot wide road easement adjacent to and Southerly of the Northerly line of Parcel No. 2.

○ FD. I. PIPE SHOWN

● SET 5/8" I. ROD

NOTE - FOR RECORD DISTANCES SEE
C.S. FILE 41-104 & BOOK 517, PAGE 550
DOUGLAS COUNTY RECORDS

APPROVALS
Richard D. ... 16 October 1974
PLANNING COMMISSION DATE
Francis L. ... 16 Oct 74
COUNTY SURVEYOR DATE

1" = 100'
AUG 1974

MAP FILE M-57-44