

MINOR LAND PARTITION IN SECTION 24, T.30S. R.6W.W.M. CITY OF RIDDLE, OREGON

APRIL 1974 SCALE: 1"=30'

COUNTY SURVEYORS FILE DATA
DO NOT REMOVE FROM OFFICE

FILED *✓*
RECEIVED *2/4*

MAY 24 1974

COUNTY SURVEYOR
DOUGLAS COUNTY, ORE.
mL

Based on CS 55/344

APPROVALS:

Robert R. Robertson
Planning Commission Chairman *5/17/74*
Date

Robert Schkawl
City Engineer *5/22/74*
Date

PARTITIONER AND LEGAL OWNER:

Heinrich and Dorothy A. Schmidt
P.O. Box 23,
Riddle, Oregon 97469

NUMBER OF LOTS: 2

WATER SUPPLY: City of Riddle

SEWAGE: City of Riddle

MAP PREPARED BY: Harrison Munger, Consulting Engineer
321 Pacific Building
Roseburg, Oregon 97470
672-7377



LEGEND

- — Set 1/2" iron rod
- — Found 1/2" iron rod
- ⊙ — Found 3/4" iron pipe per CS 55/344
- ⊗ — Found 2" iron pipe

DESCRIPTIONS: PARCEL #1

Beginning at a point which is the northeast corner of the intersection of 4th and "E" Streets in Riddle, Douglas County, Oregon, marked by a 2" iron pipe, from which point the southeast corner of Donation Land Claim No. 47, Township 30 South, Range 6 West W.M. bears S 56°08'54" E 2541.02 feet; thence along the easterly R/W line of "E" Street N 33°30' W 31.00 feet to a 1/2" iron rod; thence N 56°30' E 100.00 feet to a 1/2" iron rod; thence S 33°30' E 31.00 feet to a 1/2" iron rod; thence along the northerly R/W line of 4th Avenue S 56°30' W 100.00 feet to the point of beginning, situated in Section 24, Township 30 South, Range 6 West W.M., Douglas County, Oregon, containing 3100 square feet, more or less.

PARCEL #2

Beginning at a point on the easterly R/W line of "E" Street, Riddle, Douglas County, Oregon, marked by a 1/2" iron rod, from which point the southeast corner of Donation Land Claim No. 47, Township 30 South, Range 6 West W.M. bears S 33°30' E 31.0 ft. S 56°08'54" E 2541.02 feet; thence running along the easterly R/W line of "E" Street N 33°30' W 56.00 feet to a 1/2" iron rod; thence N 56°30' E 132.80 feet, said point being referenced S 56°30' W 6.40 feet by a 3/4" iron pipe; thence S 33°30' E 87.00 feet to a point in the northerly R/W line of 4th Avenue, said point being referenced S 56°30' W 6.40 feet by a 3/4" iron pipe; thence along the northerly R/W line of 4th Avenue S 56°30' W 32.80 feet to a 1/2" iron rod; thence N 33°30' W 31.00 feet to a 1/2" iron rod; thence S 56°30' W 100.00 feet to the point of beginning, situated in Section 24, Township 30 South, Range 6 West W.M., Douglas County, Oregon, containing 8454 square feet, more or less.

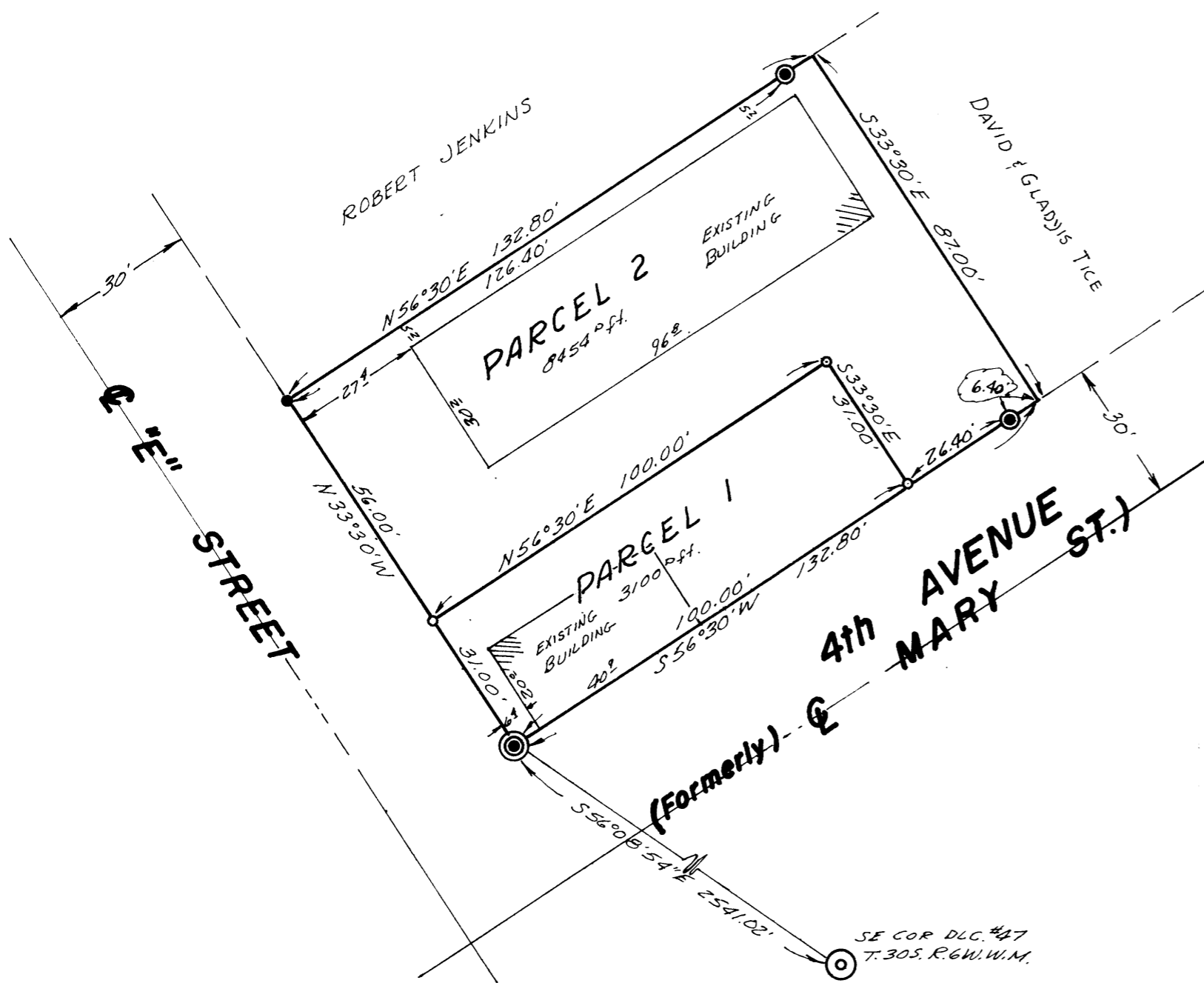

74-7081
STATE OF OREGON
COUNTY OF DOUGLAS
JUN 11 1974
2:51 P
Munger
C. D. Mollenbeck
Munger Seal

MAP FILE M53-33

MAP FILE M53-33