

COUNTY SURVEYORS FILE DATA
DO NOT REMOVE FROM OFFICE

FILED
RECEIVED
APR 18 1974 mcl
COUNTY SURVEYOR
DOUGLAS COUNTY, ORE
mcl

MAP FILE 1149-63...

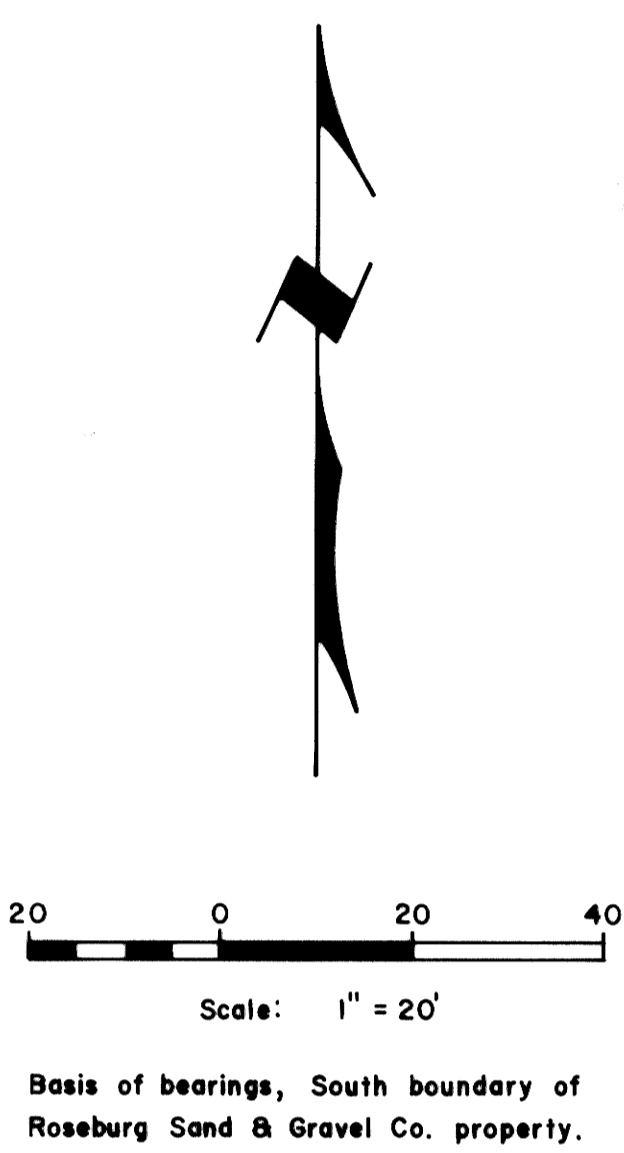

South Umpqua River

High water bank

30" oak BT
Stump, rotted
Point of beginning
36" oak BT
Stump, badly rotted
Basis of bearings

Scance, Orville & Violet M.
Inst. No. 71-1750

Roseburg Sand & Gravel Co.
Inst. No. 22677

Southern Pacific Railroad

William C. Wagner
DLC No. 55

Exterior
angle corner

N81°29'E, 1774.10
(Tie by legal record only)

LEGEND

- Corner found (3/4" iron pipe) ○
- Corner set (5/8" iron rod with aluminum cap) ●
- Corner not found ◌

PROPERTY LINE SURVEY
IN SW 1/4 SEC. 36, T.27 S., R.6 W., W. M.
For: Roseburg Sand & Gravel Co.
By: Shaner Engineering
April 15, 1974



COUNTY SURVEYORS FILE DATA
DO NOT REMOVE FROM OFFICE

MAP FILE 1149-63...