

SURVEY TO ESTABLISH PHOTOGRAMMETRIC CONTROL IN TOWNSHIP 28 SOUTH, RANGE 6 WEST, WILLAMETTE MERIDIAN, DOUGLAS COUNTY, OREGON

Surveyed for Delta Engineering Inc. by Don Garrett & Don Bentz
February 1972

Scale 1" = 1,000'

All bearings, distances, and coordinates are based on the Oregon State Plane Coordinate System, South Zone. Bench Mark and Section Corner locations are approximate. Descriptions and locations of monuments are on file in the Douglas County Surveyors Office. Distances were measured with a Hewlett-Packard 3800-A Distance Meter.

This survey is based on Stations Garrett & Rice which were measured & coordinated by The Douglas County Surveyors Office.

▲ - Denotes Brass Cap Monument

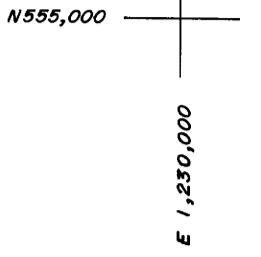

REGISTERED
PROFESSIONAL
LAND SURVEYOR
Don E. Garrett
OREGON
JULY 14, 1951
DON E. GARRETT
544

REGISTERED
PROFESSIONAL
LAND SURVEYOR
Donald A. Bentz
OREGON
JULY 12, 1968
DONALD A. BENTZ
839

GRID
NORTH

