

FILED  
RECEIVED

MAY 24 1971

COUNTY SURVEYOR  
DOUGLAS COUNTY, ORE.

55-201  
M 41-77

# SURVEY FOR UNITED STATES OF AMERICA

T 20S, R 10 & 11W, W.M.  
DOUGLAS COUNTY, OREGON

SCALE 1" = 1000'

MAY 15, 1971

PROJECT NAME - SULPHUR CADASTRAL SURVEY NO. 1-71  
CONTRACT NO. - 0031409  
FIELD BOOK REF. - 0031409 - BOOKS 1, 2, 3

All bronze caps set are 2 1/2" welded on 2" x 36" galvanized pipe set 24" in ground. Marked 1971 - 4185 and corner identification.

All corners set except corner no. 13 were set by proportional measure based on original G.L.O. surveys or retracements. Because of the large variance in remeasurement I consulted with the Portland office of the Bureau of Land Management regarding the proportioning.

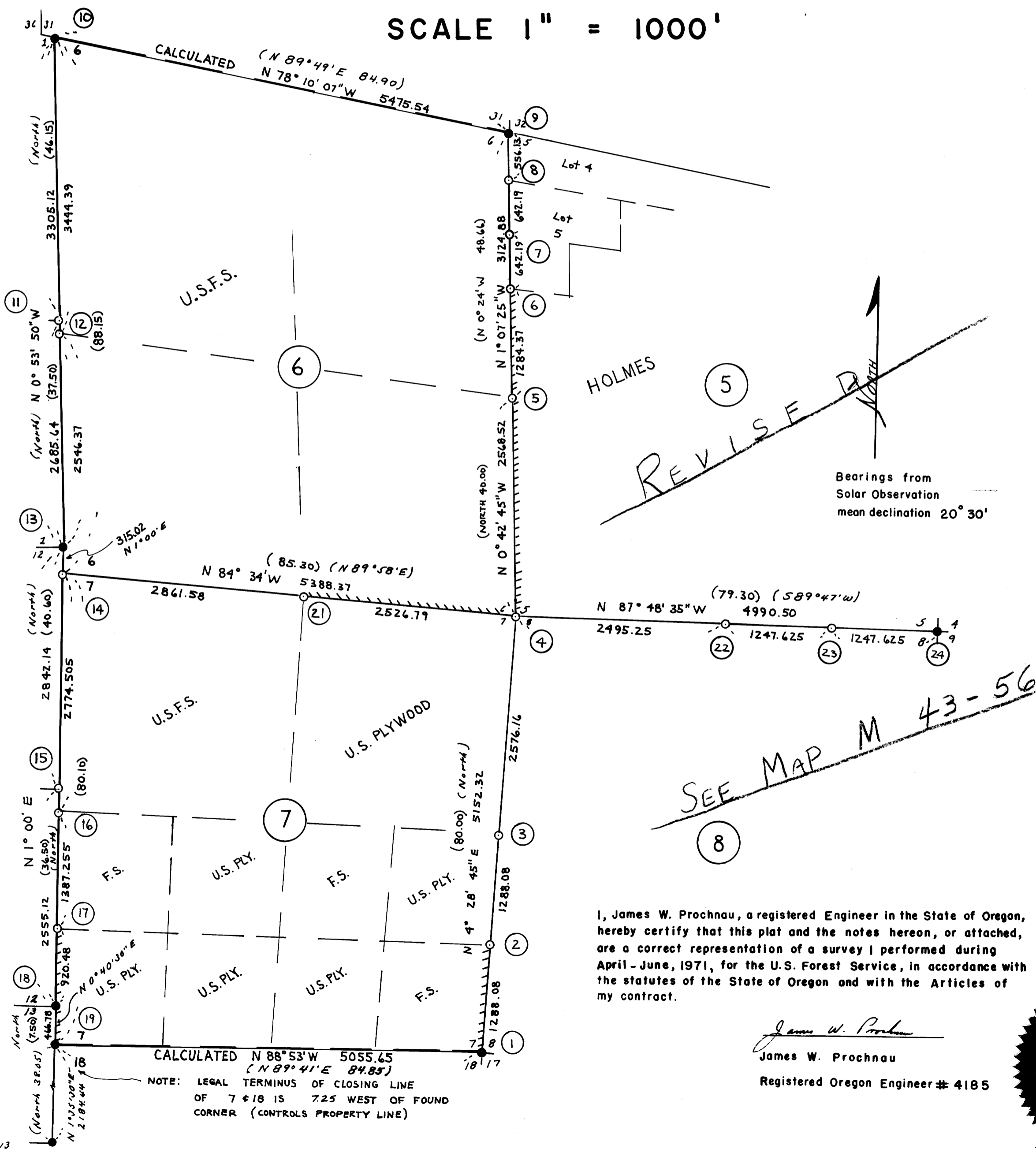

Corner Monument

- 1 Fd bronze cap
- 2 Set bronze cap
- 3 " "
- 4 " "
- 5 " "
- 6 " "
- 7 " "
- 8 " "
- 9 Found bronze cap
- 10 Found bronze cap
- 11 Set bronze cap 6" below road surface
- 12 Set bronze cap
- 13 " "
- 14 Set bronze cap
- 15 " "
- 16 " "
- 17 " "
- 18 Found bronze cap w.c. Set by Douglas Co.
- 19 " "
- 20 None
- 21 Set bronze cap
- 22 " "
- 23 " "
- 24 Fd. bronze cap

Accessories - (All bearing trees)

- New B.T. 20" maple bears S 79 1/2° W 10.0 ft; original 5" fir, now stub S 40° W 50.2 ft.
- Set - 10" yew bears S 89° W 84.80 ft; 10" maple bears S 83° E 37.80 ft.
- Set - 48" fir stump bears N 71° E 29.48 ft; 38" fir stump N 56° W 53.65 ft.
- Set - 18" maple bears S 46° W 47.55 ft; 26" maple bears S 26° E 43.06 ft.
- 4" alder bears N 17° E 27.56 ft; 32" hemlock bears N 19° W 59.10 ft.
- Set - 36" maple bears N 14° W 89.30 ft; 10" maple bears N 3° E 88.40 ft.
- Set - 12" alder bears N 6° W 9.90 ft; 24" fir bears East 36.20 ft.
- Set - 28" fir bears S 10° W 17.87 ft; 18" fir bears S 80° E 6.33 ft.
- Set - 28" fir bears N 17° E 23.30 ft; 28" fir bears N 12° W 28.60 ft.
- Corner & B.T.s set by W. Haines, survey recorded 1965
- Set - 16" fir bears N 82° W 31.0 ft; 18" fir bears N 57° W 42.18 ft.
- Set - 28" fir bears N 40° E 24.1 ft; 20" fir bears N 24° E 34.6 ft.
- Fd. original maple B.T. and fir (now windfall)
- Set - 24" fir bears N 30° W 75.29 ft; 18" fir bears S 3° W 23.93 ft.
- Set - 16" fir bears N 60° E 72.25 ft; 18" fir S 49° E 47.59 ft.
- Set - 32" fir bears S 66° W 33.9 ft; 20" fir bears N 73° W 29.10 ft.
- Set - 22" fir bears N 29° E 49.4 ft; 14" fir bears N 78° E 75.54 ft.
- Set - 62" fir bears S 23° E 36.55 ft; 54" fir N 5° E 13.50 ft.
- Cap is 10.00 West of original corner tree - new B.T. - 40"
- Cedar bears N 26° W 18.5 ft.
- New B.T. 8" hemlock bears N 45° E 39.2 ft.
- Fd. original Bearing Tree tagged by U.S.F.S. - now windfall
- Set - 28" fir stump bears N 85° E 8.45 ft; 26" fir stump S 31° W 12.3 ft.
- Set - 6" fir bears N 77° W 198.17 ft; 12" fir S 76° W 229.15 ft.
- Set cap for witness corner on section line N 87° 48' 35" W 20.00 ft. from true corner. Set 34" maple bears N 25° W 550.90 ft; 32" alder bears S 10° E 192.40 ft.
- Set in 1952 - 4 B.T.s

I, James W. Prochnau, a registered Engineer in the State of Oregon, hereby certify that this plat and the notes hereon, or attached, are a correct representation of a survey I performed during April - June, 1971, for the U.S. Forest Service, in accordance with the statutes of the State of Oregon and with the Articles of my contract.

*James W. Prochnau*  
James W. Prochnau  
Registered Oregon Engineer # 4185



LEGEND

- Corners found
- Corners set
- //// Property line marked with 6' iron posts & U.S.F.S. signs

M 41-77

3/4 Sec 13

CERTIFIED RECORD OF LAND CORNER MONUMENTATION



History of original corner establishment:

Never set

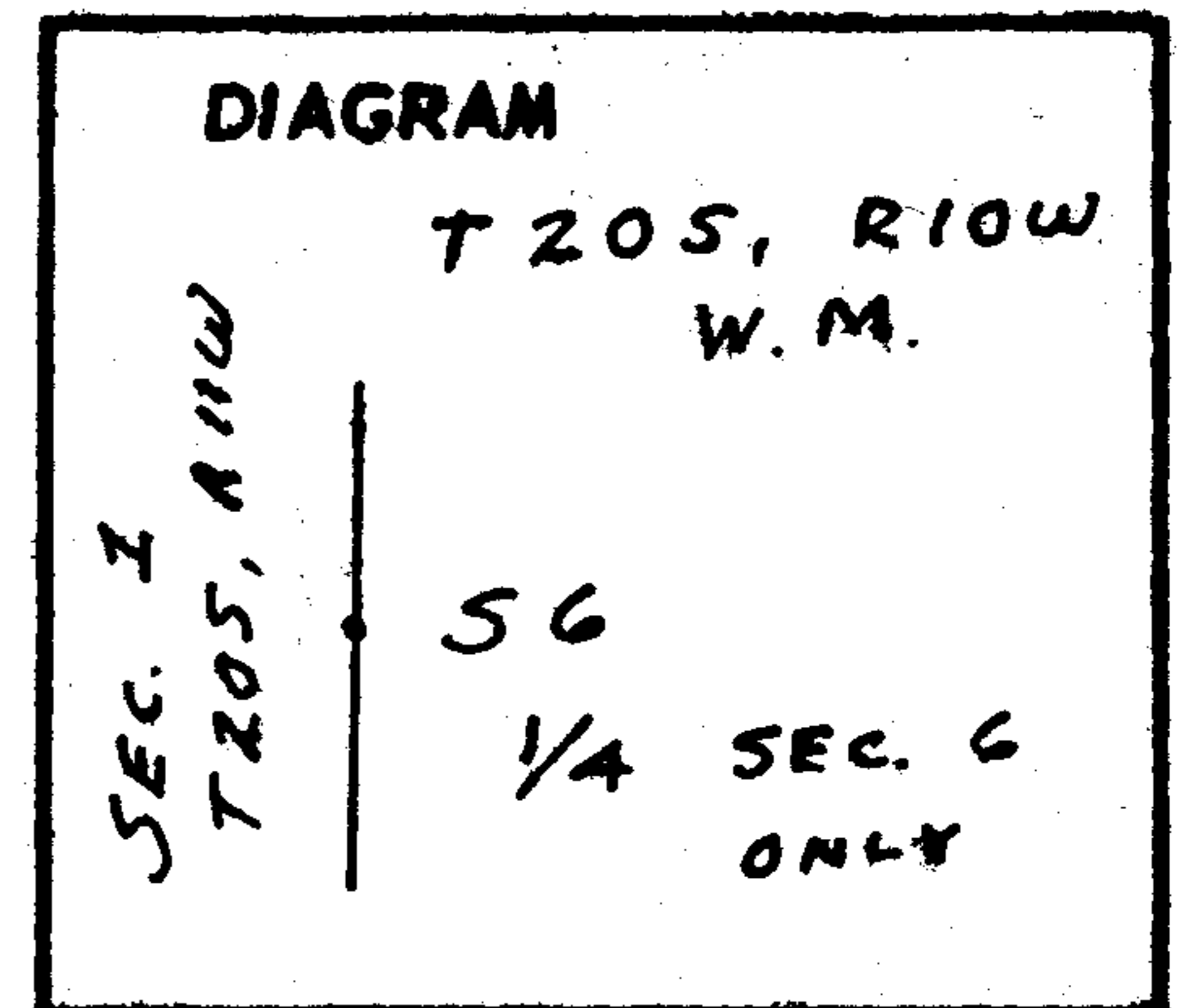

Description of corner evidence found:

None

Description of monument and accessories I established to perpetuate the original location of this corner

At the properly proportioned position I placed a 2" x 36" galvanized iron pipe, flanged at the bottom and capped with a bronze disk welded on top. The monument projects 6" above ground. I filled in around the pipe monument with stone and packed earth.

I stamped the disk

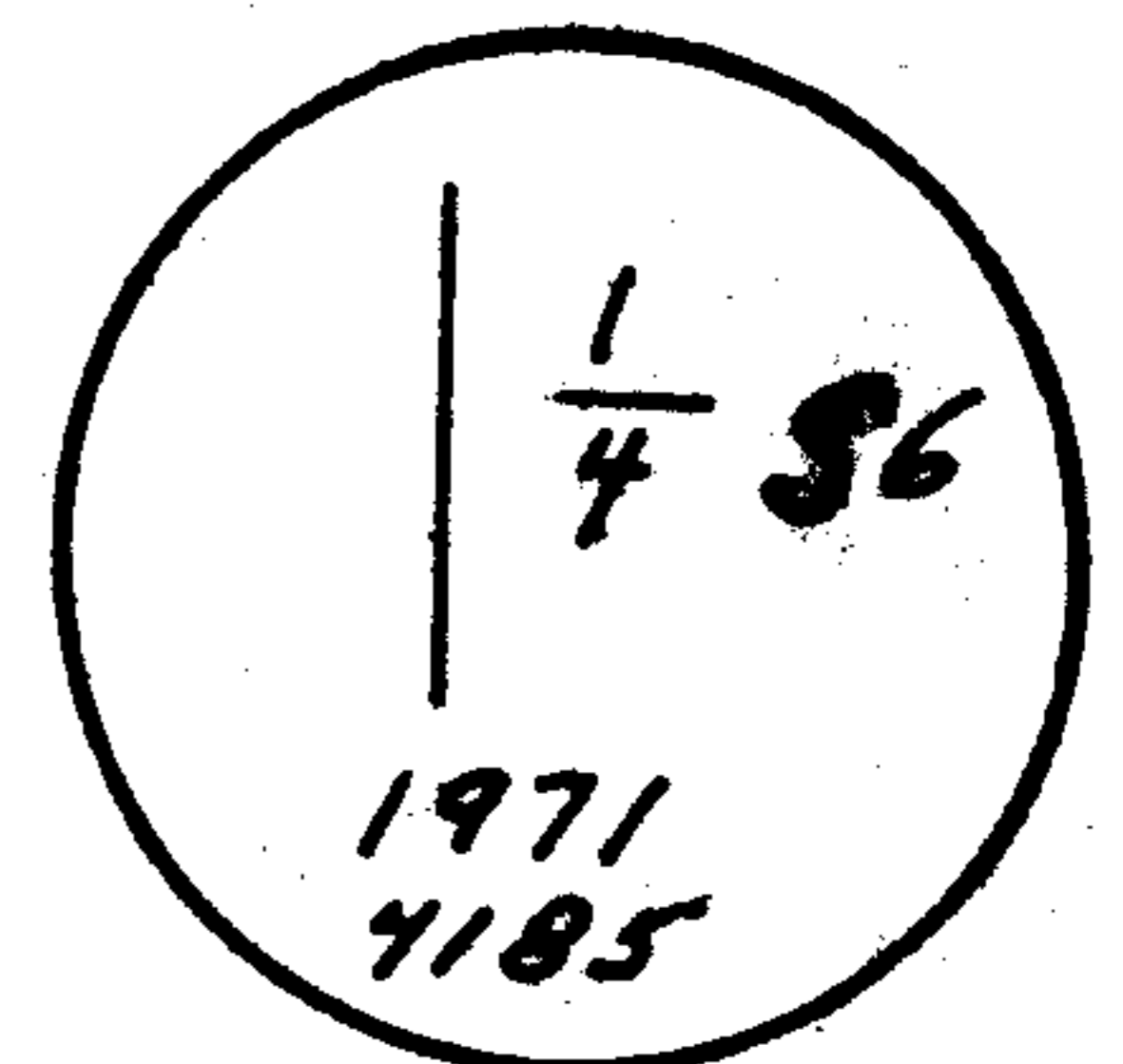

I established new bearing trees as follows. Each bearing tree has a scribed face and a U.S.F.S. bearing tree sign breast high and facing the monument.

Bearing trees set:

- a 28" fir bears N 40° E 24.1 feet
- a 20" fir bears N 24° E 34.6 feet

*James W. [Signature]*

Office of ..... County Surveyor ..... County of ..... Douglas .....  
State of ..... Oregon ..... , I hereby certify that the within instrument was filed in this office  
for record on the 24 day of ..... June ..... ; 1971, at 11 o'clock A.m., (signed)

*James W. [Signature]* ..... by .....  
(COUNTY OFFICIAL) (DEPUTY)

#46 T20-10W ✓  
#99 T20-11W ✓  
Form R6-7100-57 (9/66)

CORNER #12 ON MAP

C.S File 55 / 201-4

Map File M 41-77

**CERTIFIED RECORD OF LAND CORNER MONUMENTATION**

**History of original corner establishment:**

Corner established in 1894 by General Land Office  
Contract Survey

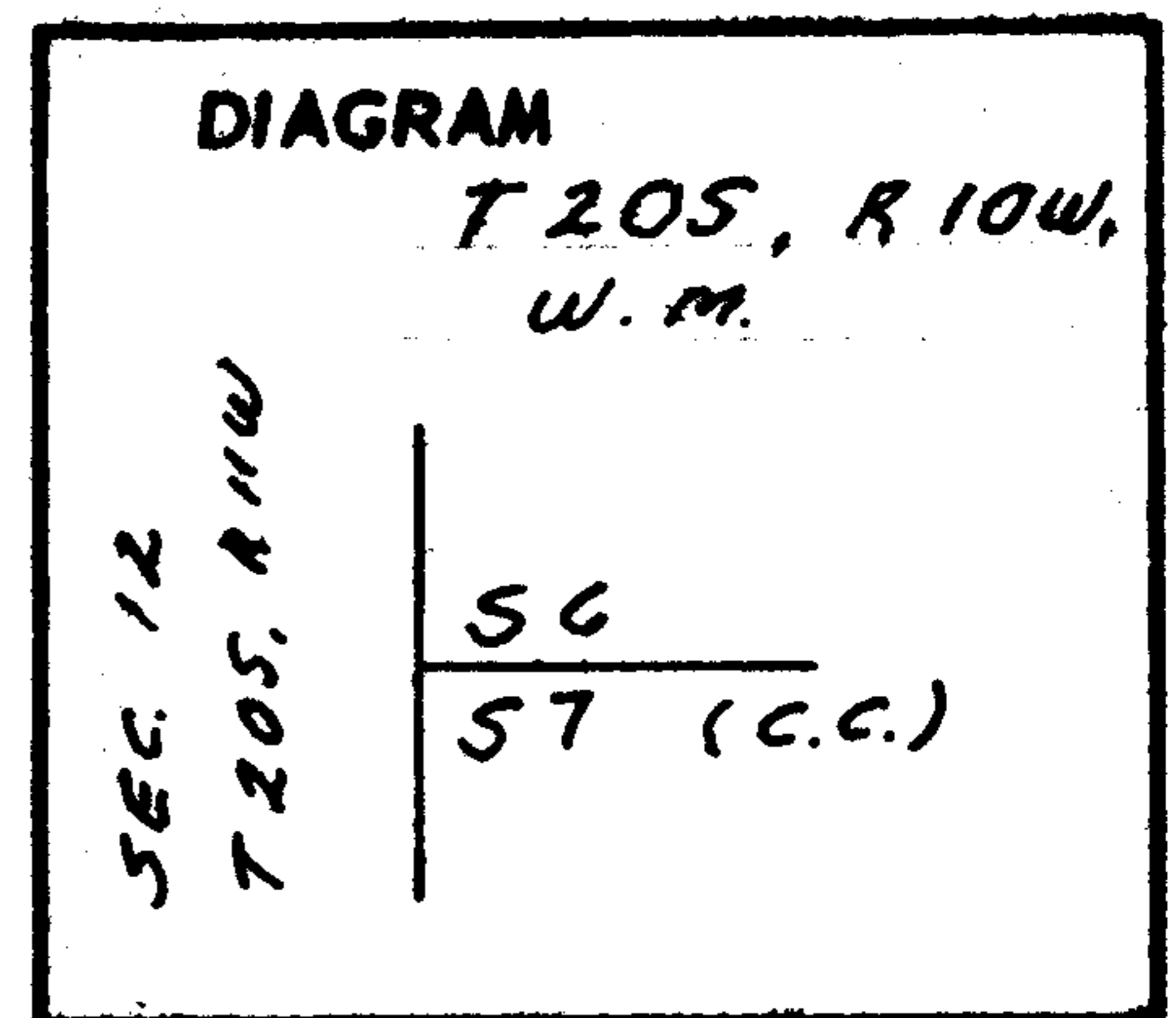

Original Survey record states: I set a stone 10x8x8 7/8 ins. in ground for closing corner to Sections 6 and 7 marked with CC and 5 notches on S and 1 notch on N faces and raised mound of stone 30 ins. high and 24 in base alongside. Pits impractical.

( No B.T.'s Set )

**Description of corner evidence found:**

None

**Description of monument and accessories I established to perpetuate the original location of this corner**

At the properly proportioned position I placed a 2" x 36" galvanized iron pipe, flanged at the bottom and capped with a bronze disk welded on top. The monument projects 6" above ground. I filled in around the pipe monument with stone and packed earth.

I stamped the disk

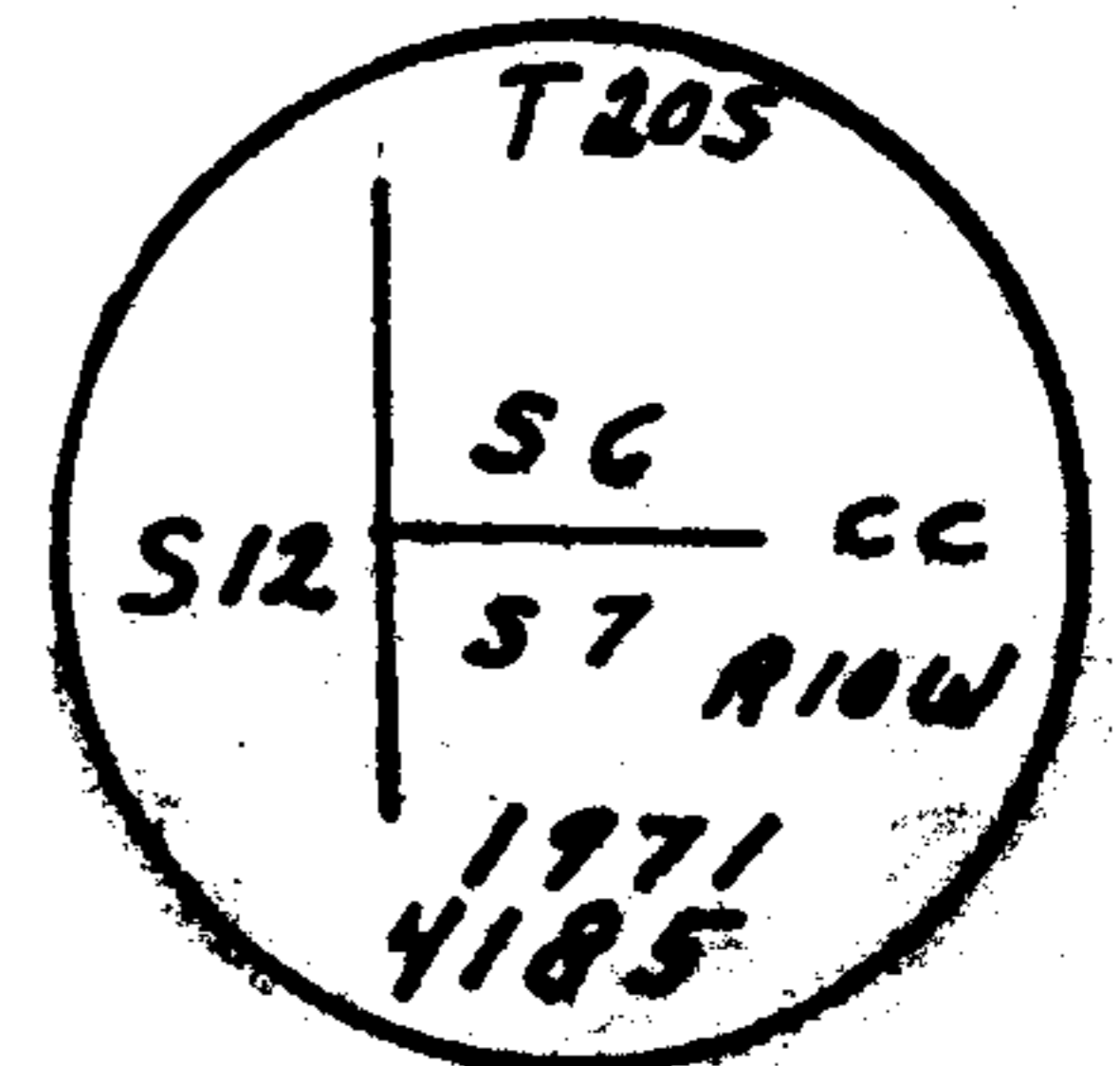

I established new bearing trees as follows. Each bearing tree has a scribed face and a U.S.F.S. bearing tree sign breast high and facing the monument.

**Bearing trees set:**

- a 16" fir bears N 60° E 72.25 feet
- an 18" fir bears S 49° E 47.59 feet

*James W. Ryerson*

Office of.....County Surveyor..... County of.....Douglas.....  
State of.....Oregon....., I hereby certify that the within instrument was filed in this office  
for record on the 24 day of .....June....., 1971, at 11 o'clock A.m., (signed)  
*James W. Ryerson* by ..... (DEPUTY)  
(COUNTY OFFICIAL)

#48 - T20-10 ✓  
#101 T20-11W ✓

Form R6-7100-57 (9/66)

**CORNER #14 ON MAP**

U.S. File 55 / 201-8

Map File M 44-71

CERTIFIED RECORD OF LAND CORNER MONUMENTATION



History of original corner establishment:

Never set

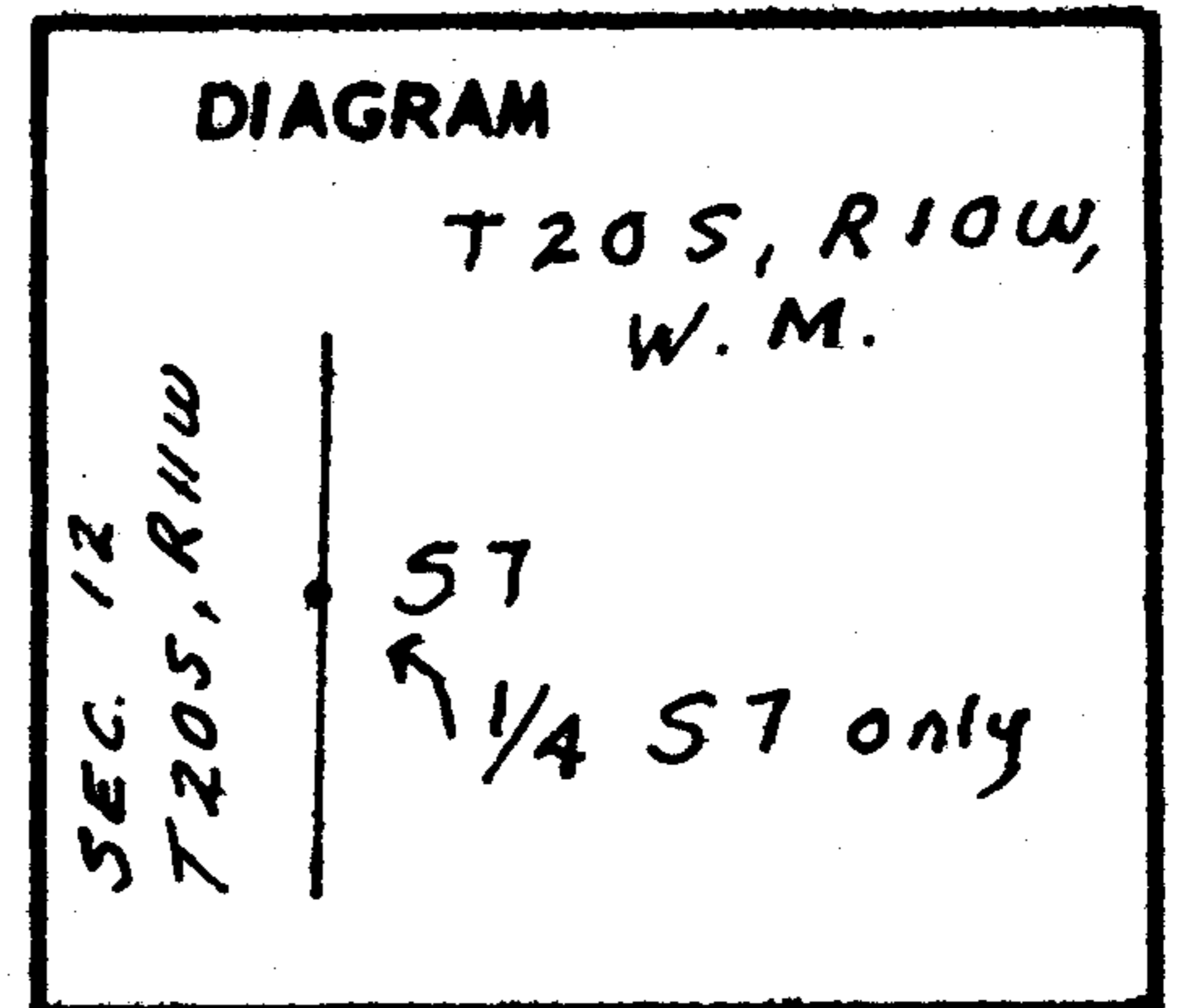

Description of corner evidence found:

None

Description of monument and accessories I established to perpetuate the original location of this corner

At the properly proportioned position I placed a 2" x 36" galvanized iron pipe, flanged at the bottom and capped with a bronze disk welded on top. The monument projects 6" above ground. I filled in around the pipe monument with stone and packed earth.

I stamped the disk

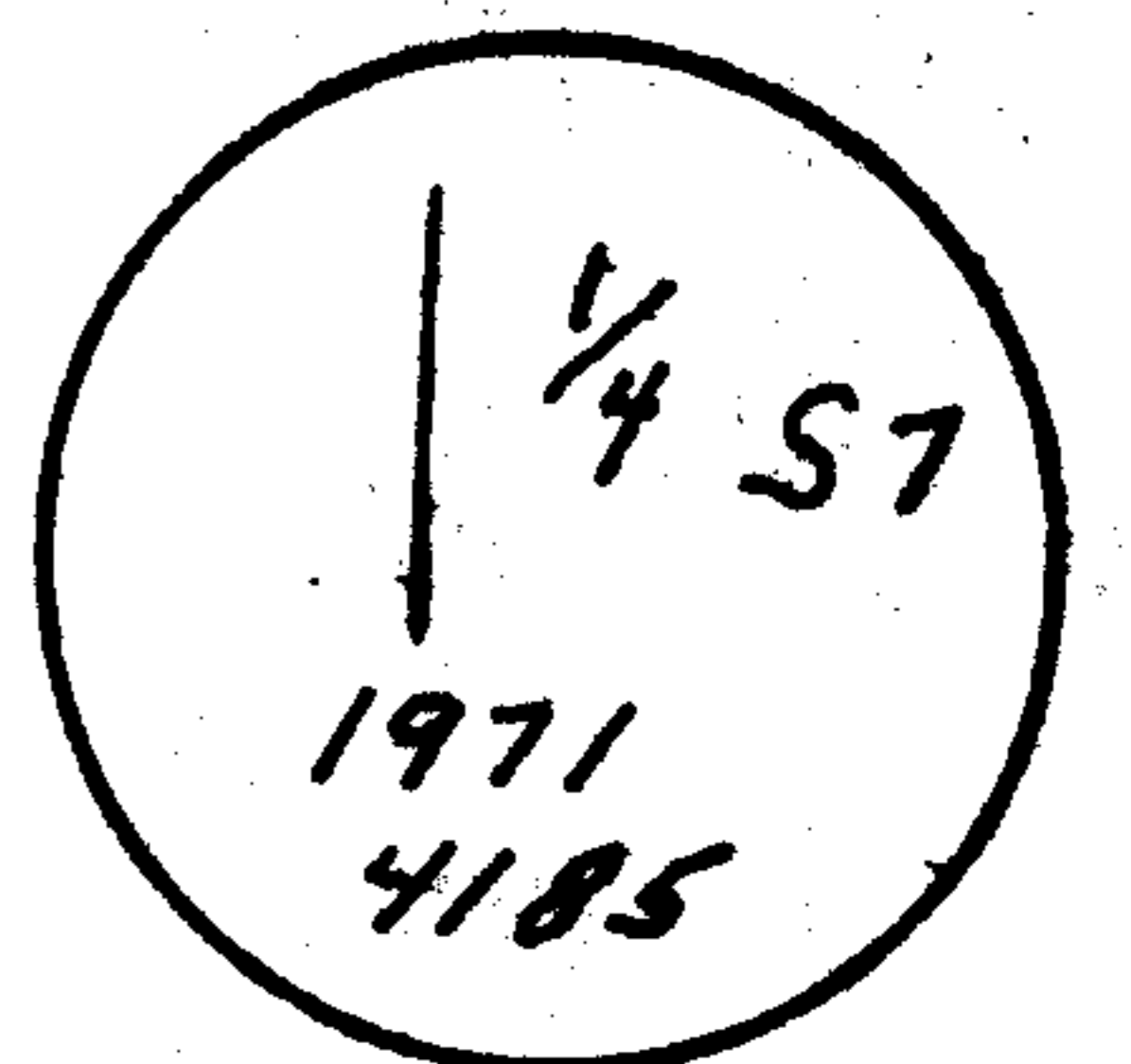

I established new bearing trees as follows. Each bearing tree has a scribed face and a U.S.F.S. bearing tree sign breast high and facing the monument.

Bearing trees set:

- a 22" fir bears N 29° E 49.4 feet
- a 14" fir bears N 78° E 75.54 feet

*James W. Ryron*

Office of ..... County Surveyor ..... County of ..... Douglas  
 State of ..... Oregon ..... , I hereby certify that the within instrument was filed in this office  
 for record on the 24 day of ..... June ..... , 1971 , at ..... 11 o'clock A.M., (signed)  
*James W. Ryron* by ..... (COUNTY OFFICIAL) ..... (DEPUTY)

#50 T20-10W ✓  
 #103 T20-11W ✓

Form R6-7100-57 (9/66)

CORNER #11 ON MAP

C.S. File 55/201-11

Map File M 44-77

CERTIFIED RECORD OF LAND CORNER MONUMENTATION

History of original corner establishment:

Never set

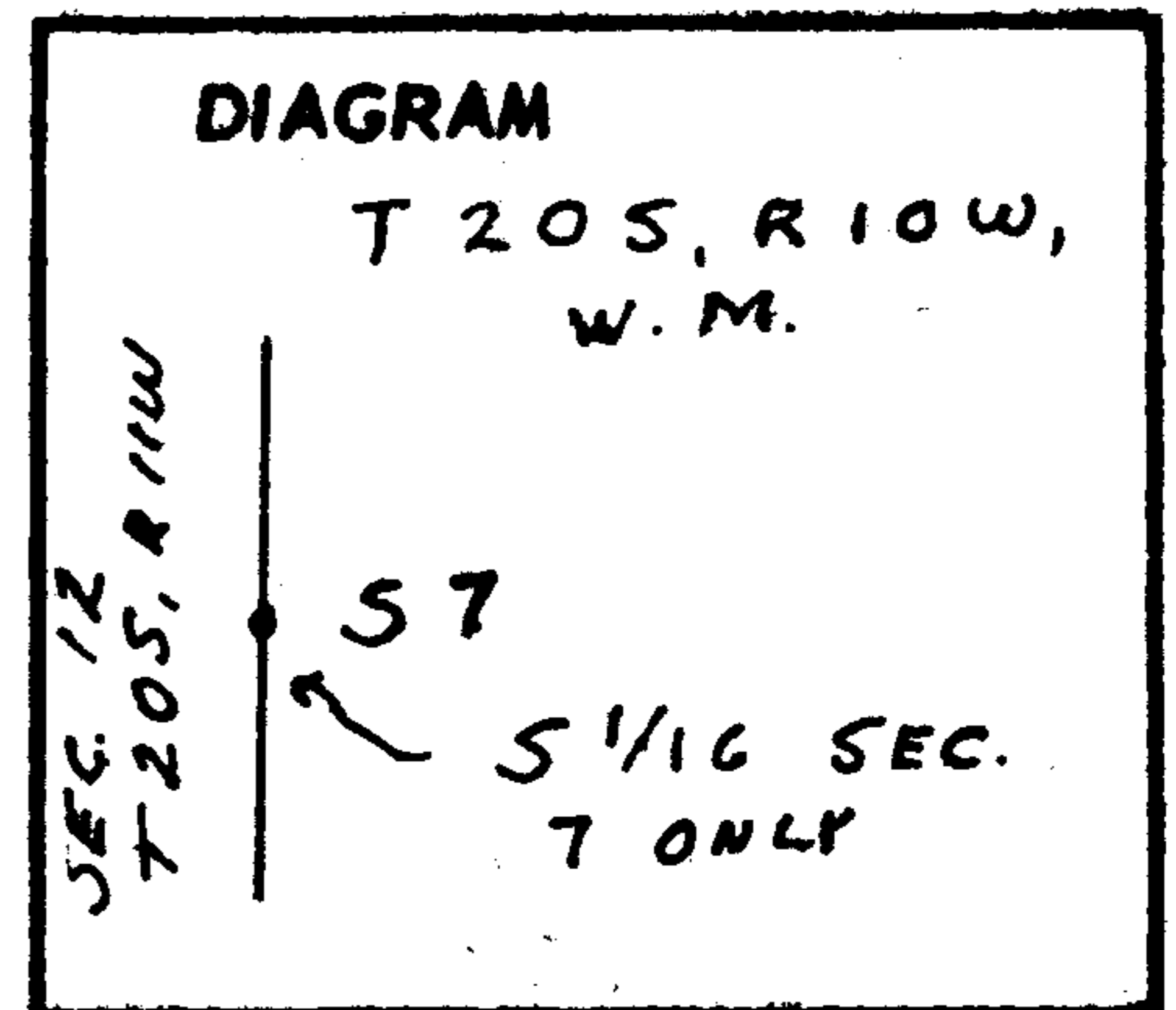

Description of corner evidence found:

None

Description of monument and accessories I established to perpetuate the original location of this corner

At the properly proportioned position I placed a 2" x 36" galvanized iron pipe, flanged at the bottom and capped with a bronze disk welded on top. The monument projects 6" above ground. I filled in around the pipe monument with stone and packed earth.

I stamped the disk

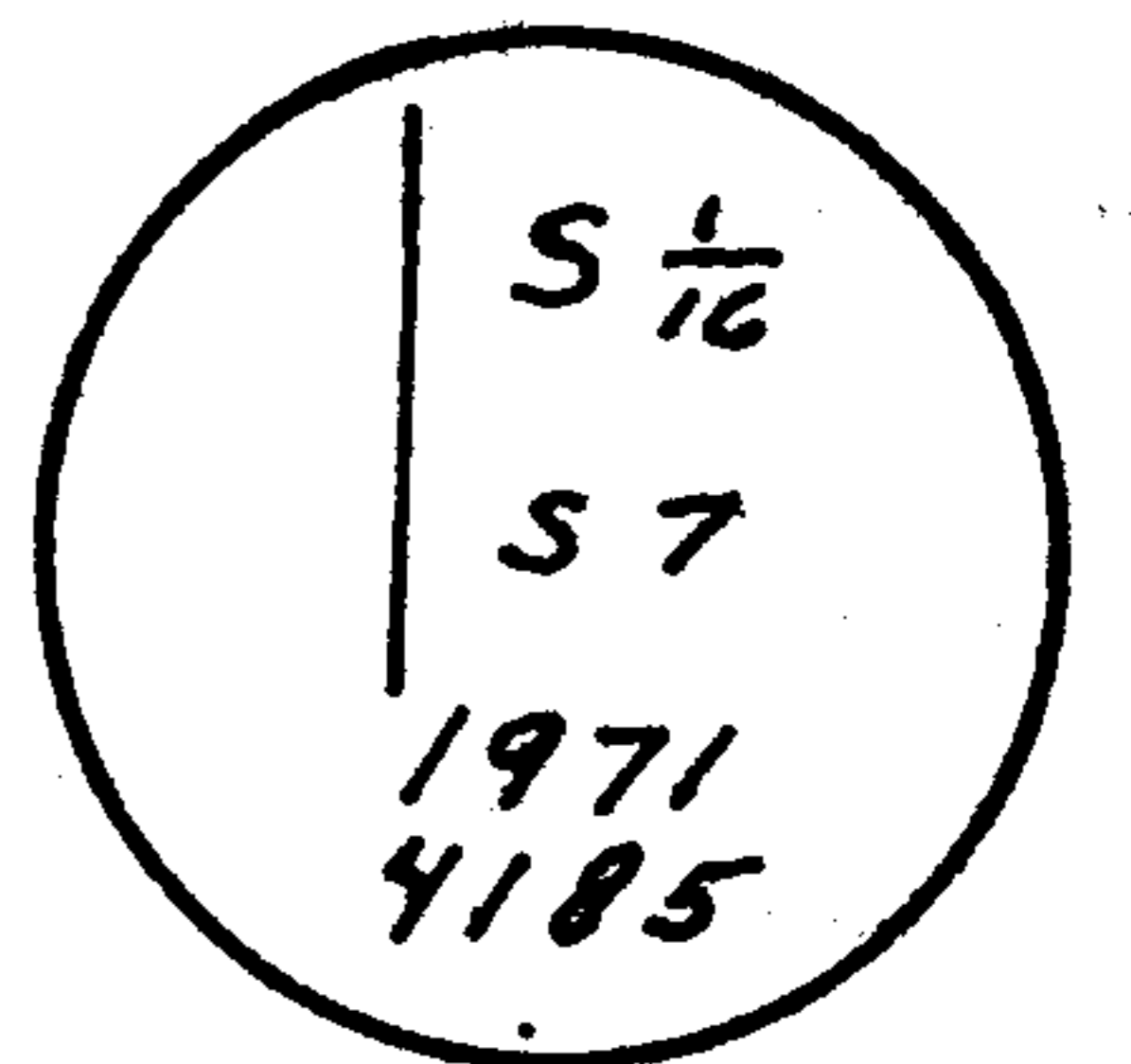

I established new bearing trees as follows. Each bearing tree has a scribed face and a U.S.F.S. bearing tree sign breast high and facing the monument.

Bearing trees set:

- a 62" fir bears S 23° E 36.55 feet
- a 54" fir bears N 5° E 13.50 feet

Office of ..... County Surveyor ..... County of ..... Douglas .....  
 State of ..... Oregon ..... , I hereby certify that the within instrument was filed in this office  
 for record on the 24 day of ..... June ..... , 1971, at ..... o'clock A.m., (signed)  
*James W. Ryan* by ..... (DEPUTY)  
 (COUNTY OFFICIAL)

*James W. Ryan*

CORNER #17 ON MAP

C.S. File 55 / 201-12

Map File M 41-77

CERTIFIED RECORD OF LAND CORNER MONUMENTATION

History of original corner establishment:

Corner established in 1892 by General Land Office  
Contract Survey

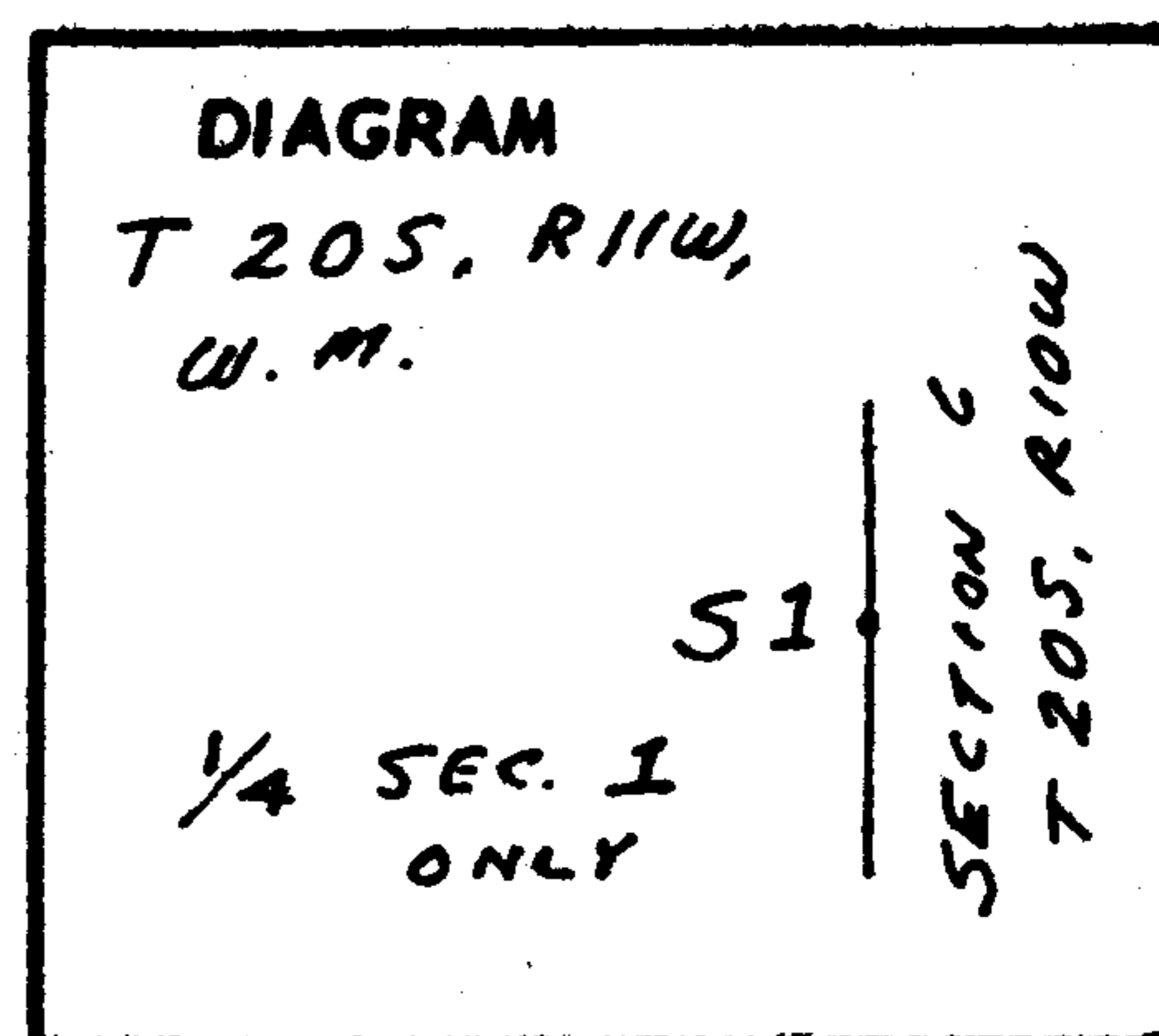

Original survey record states: Set a sandstone 12X8X7 8 ins. in the ground for 1/4 sec. cor. marked 1/4 on W. face, from which:  
a fir 6 ins. in dia. bears S 11° E 90 lks. dist., marked 1/4 S B.T.  
a fir 5 ins. in dia. bears N 87° W 75 lks. dist., marked 1/4 S B.T.

1894 survey makes corner common to Section 1 only

Description of corner evidence found:

None

Description of monument and accessories I established to perpetuate the original location of this corner

At the properly proportioned position I placed a 2" x 36" galvanized iron pipe, flanged at the bottom and capped with a bronze disk welded on top. The monument projects 6" above ground. I filled in around the pipe monument with stone and packed earth.

I stamped the disk

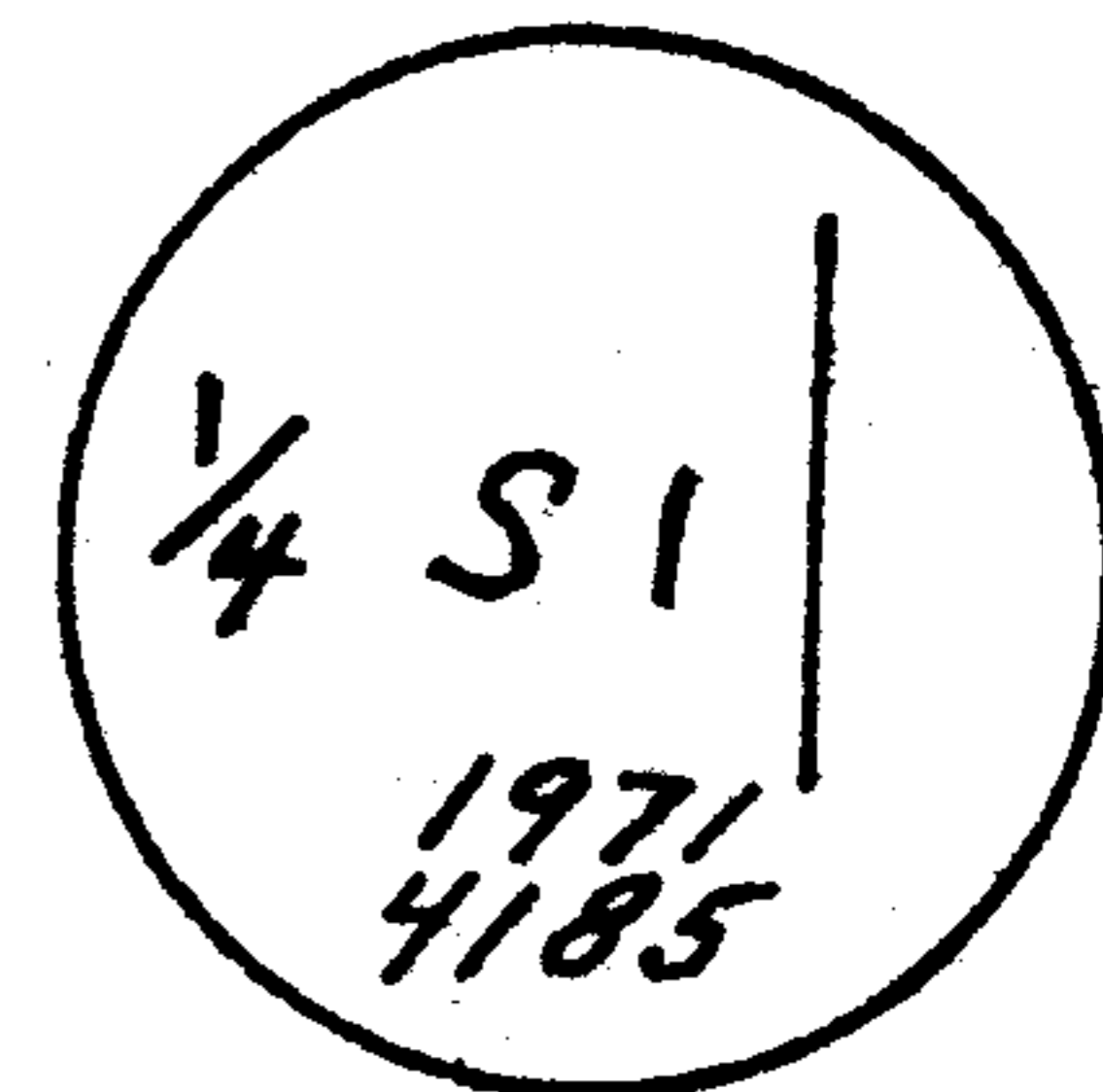

I established new bearing trees as follows. Each bearing tree has a scribed face and a U.S.F.S. bearing tree sign breast high and facing the monument.

Bearing trees set:

- a 16" fir bears N 82° W 31.00 feet
- an 18" fir bears N 57° W 42.18 feet

*James W. Ferguson*

Office of ..... County Surveyor ..... County of ..... Douglas .....  
 State of ..... Oregon ..... , I hereby certify that the within instrument was filed in this office  
 for record on the 24 day of ..... June ..... , 1971, at ..... 11 o'clock A.m., (signed)  
*James W. Ferguson* by .....  
 (COUNTY OFFICIAL) (DEPUTY)

CORNER #11 ON MAP

C.S. File 55 / 201-15

Map File M 41 - 77

#45 - T20-10 ✓  
 #98 - T20-11 ✓

CERTIFIED RECORD OF LAND CORNER MONUMENTATION

History of original corner establishment:

Corner established in 1892 by General Land Office

Contract Survey

Original Survey record states: Set a post 4½ ft. long 24 ins. in the ground from which:

- a maple 8" dia. bears N 45° E 30 lks. dist.
- a maple 24" dia. bears S 89° E 30 lks. dist.
- an alder 4" dia. bears S 64° W 117 lks. dist.
- a fir 4" diam. bears N 21° W 47 lks. dist.

Note: In 1894 all markings relating to R10W were destroyed making corner common to Section s 1 & 12 only

Description of corner evidence found:

Found original maple B.T. in NE quadrant ( Good face but scribing was destroyed in 1894 ) Found fir B.T. now 30" windfall with faint face on bottom. Corner agrees very well with " canon " call 0.25 chains North.

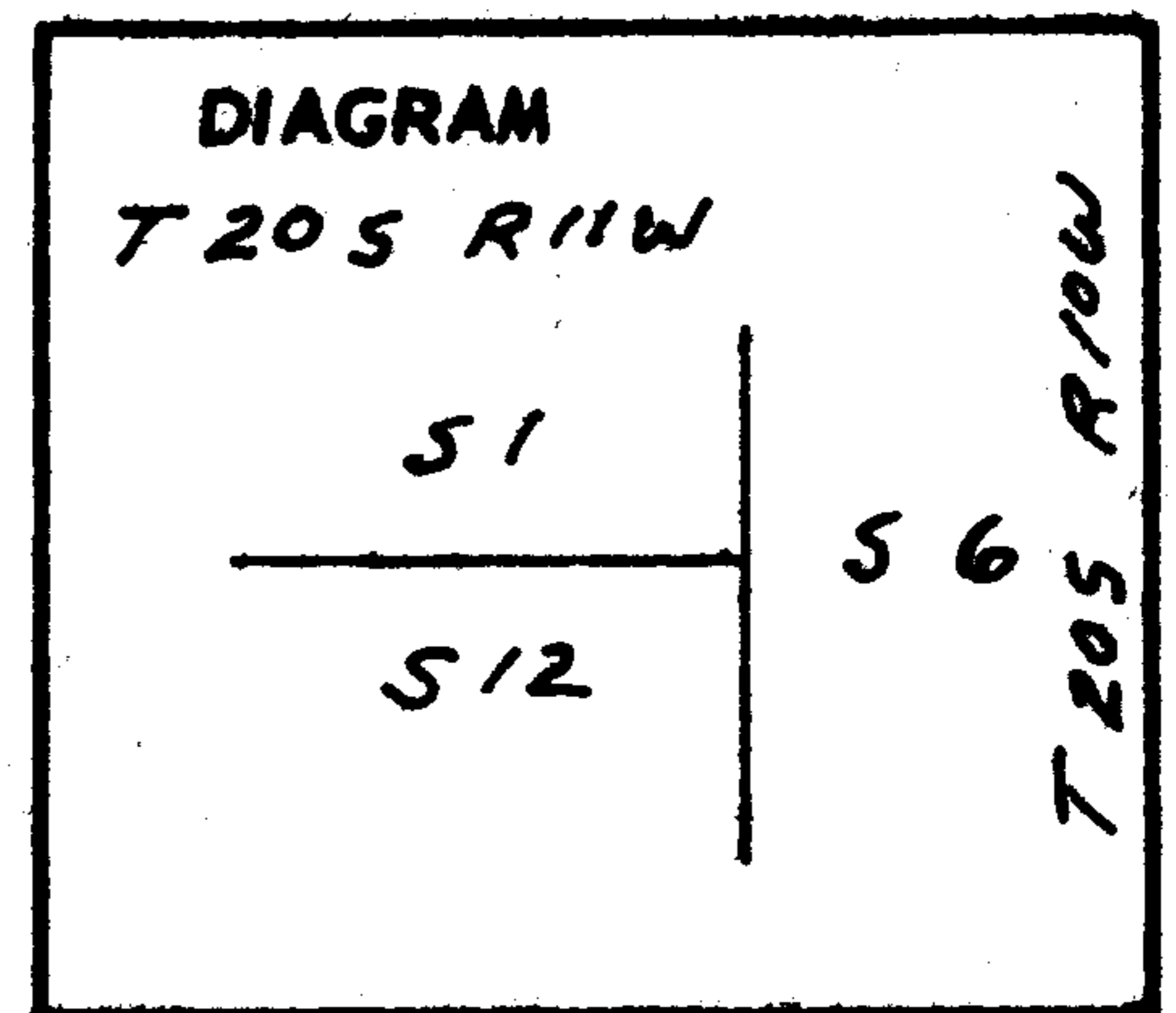

Description of monument and accessories I established to perpetuate the original location of this corner

From the original maple B.T. in NE quadrant I placed a 2" X 36" galvanized iron pipe, flanged at bottom and capped with a bronze disk welded on top. The monument projects 6" above ground. I filled in around the pipe monument with stone and packed earth.

Bearing Trees Set:

- a 24" fir bears N 30° W 75.29 feet
- an 18" fir bears S 3° W 23.93 feet

I stamped the disk →

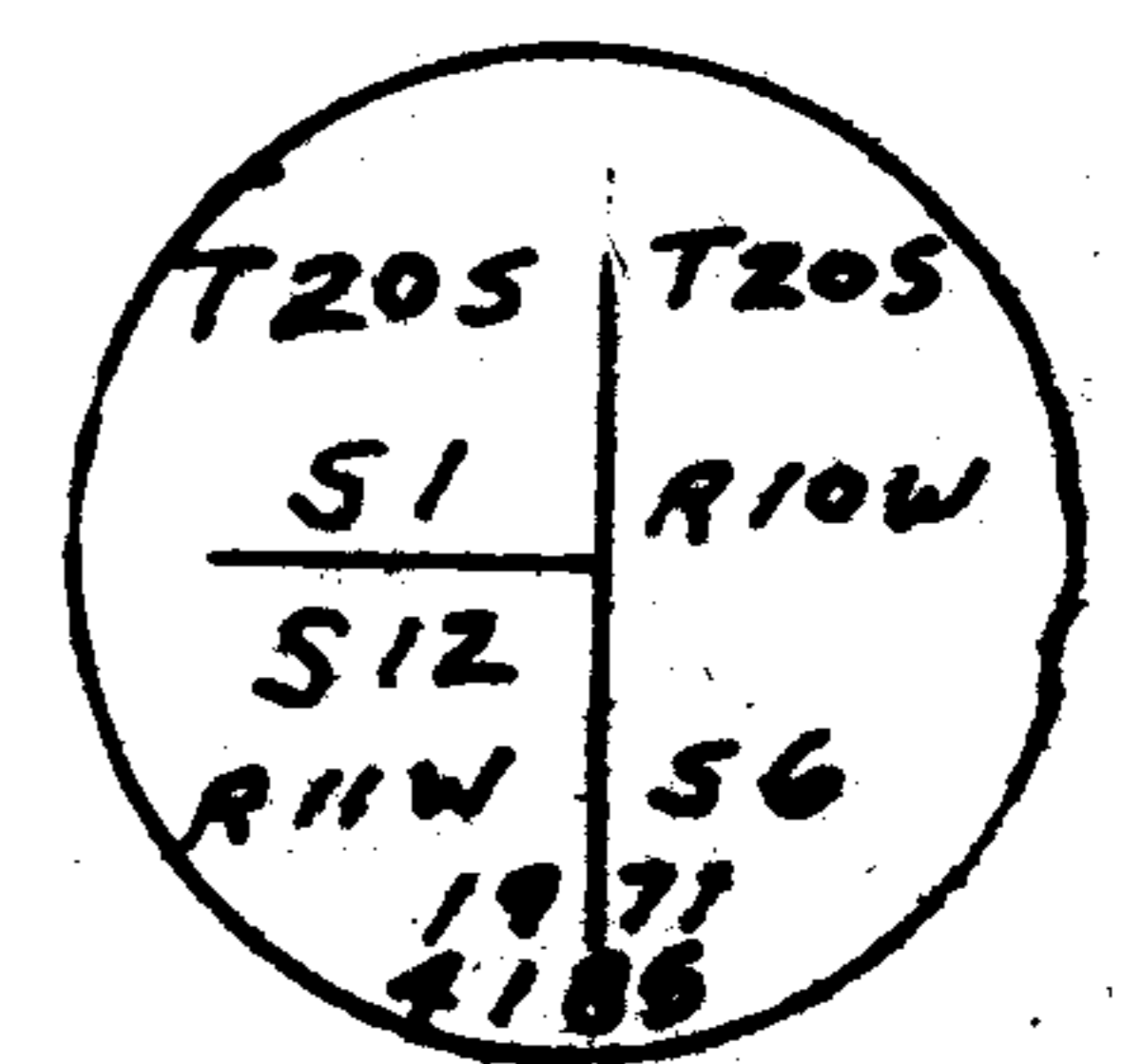

*James W. Parkman*

Office of COUNTY SURVEYOR County of DOUGLAS  
 State of OREGON, I hereby certify that the within instrument was filed in this office  
 for record on the 29 day of JUNE, 1977, at 11 o'clock A.m., (signed)  
James W. Parkman by \_\_\_\_\_ (DEPUTY)  
 (COUNTY OFFICIAL)

#47- T20-10 ✓  
 #100 T20-11W ✓

Form R6-7100-57 (9/66)

**CORNER #13 ON MAP**

C.S File 55 / 201-16

Map File M 41 - 77

CERTIFIED RECORD OF LAND CORNER MONUMENTATION

History of original corner establishment:

Corner established in 1892 by General Land Office

Contract Survey

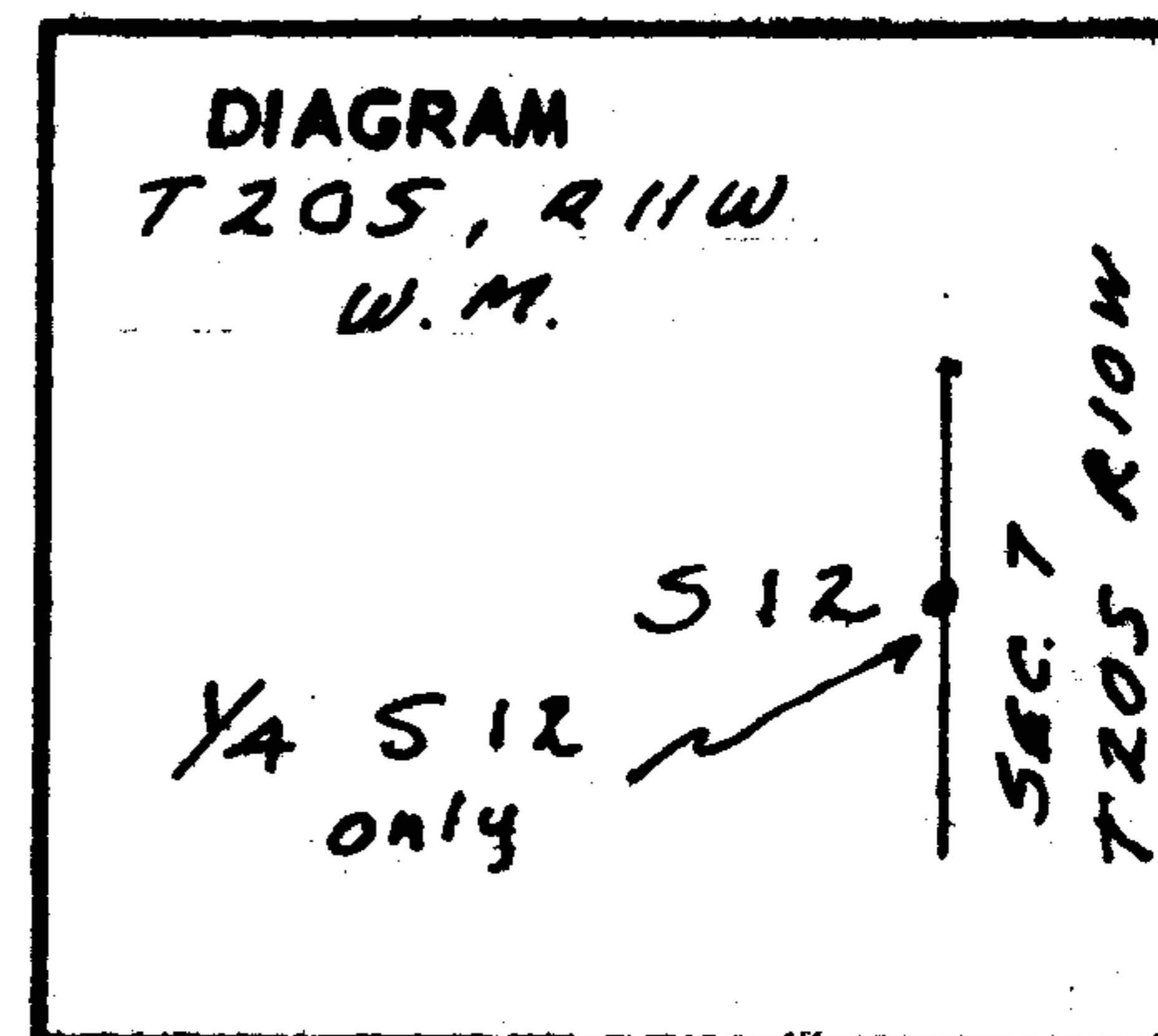

Original Survey record states: A willow 3 ins. dia. which I marked  $\frac{1}{4}$  s on W. side for  $\frac{1}{4}$  section corner, from Which:

- a willow 3 ins. dia. bears N 3° E 4 lks. dist., marked  $\frac{1}{4}$  S B.T.
- a willow 3 ins. dia. bears S 5° W 10 lks. dist., marked  $\frac{1}{4}$  S B.T.

1894 survey makes this corner common to Section 12 only

Description of corner evidence found:

None

Description of monument and accessories I established to perpetuate the original location of this corner

At the properly proportioned position I placed a 2" x 36" galvanized iron pipe, flanged at the bottom and capped with a bronze disk welded on top. The monument projects 6" above ground. I filled in around the pipe monument with stone and packed earth.

I stamped the disk

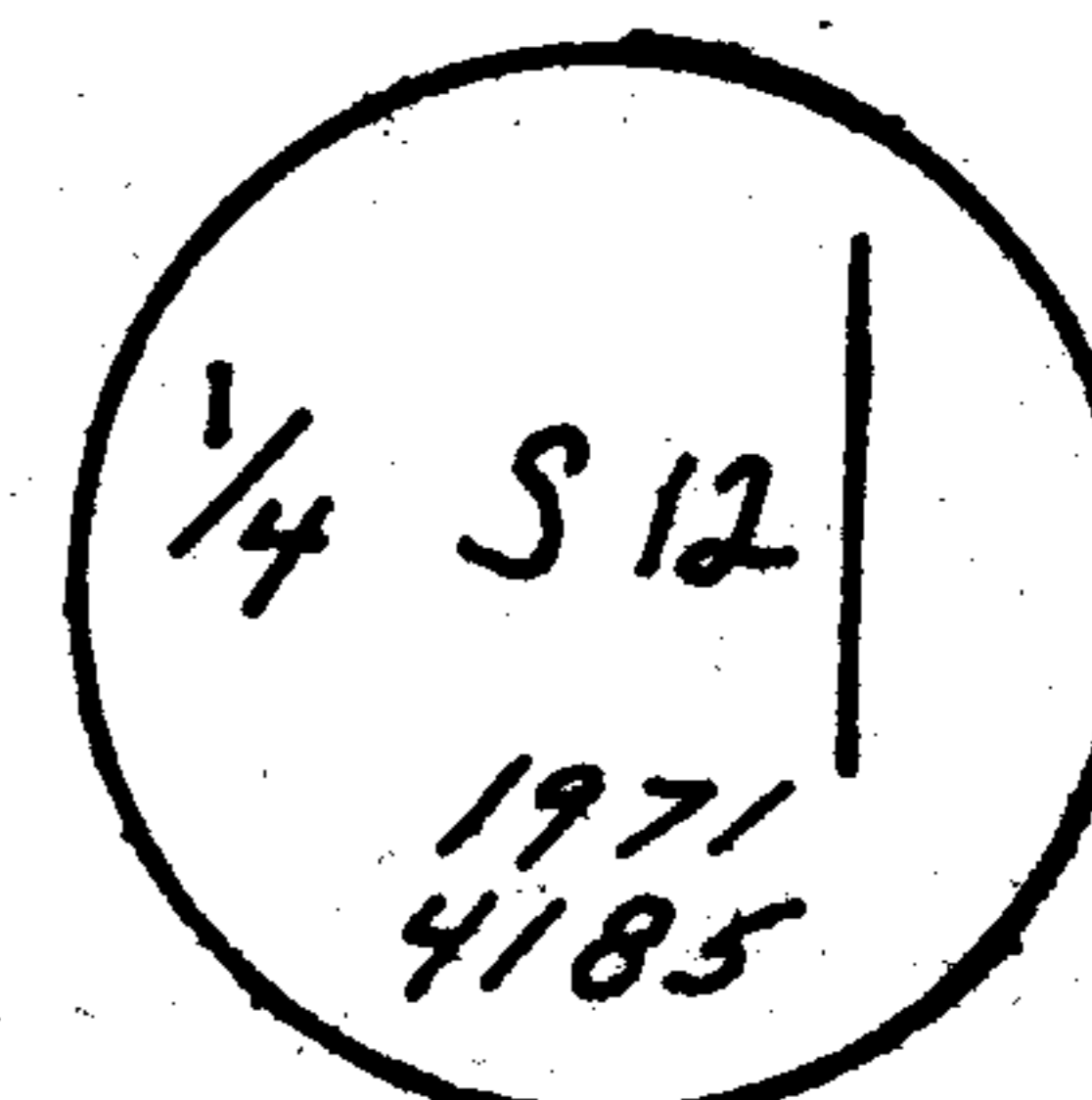

I established new bearing trees as follows. Each bearing tree has a scribed face and a U.S.F.S. bearing tree sign breast high and facing the monument.

Bearing trees set:

- a 32" fir bears S 66° W 33.90 feet
- a 20" fir bears N 73° W 29.10 feet

Office of ..... County Surveyor ..... County of ..... Douglas .....  
 State of ..... Oregon ..... , I hereby certify that the within instrument was filed in this office  
 for record on the 24 day of June ..... 1971, at 11 o'clock A.m., (signed)  
*James W. Parkman* by .....  
 (COUNTY OFFICIAL) (DEPUTY)

#49 - T20-10W ✓  
 #102 T20-11W ✓  
 Form R6-7100-57 (9/66)

CORNER #15 ON MAP

C.S. File 55 / 201-57

Map File M 41 T 77