

COUNTY SURVEYORS FILE DATA
DO NOT REMOVE FROM OFFICE

Survey for lot Corner Restoration, Bogard
Addition to the City of Roseburg.
Survey by Glenn S. Baughman
for Wm. Lassiter
Date: April 1965 Scale: 1" = 40'
o 3/8 Iron Rod Set.

REGISTERED
OREGON
LAND SURVEYOR
Glenn S. Baughman
JULY 14, 1951
GLENN S. BAUGHMAN
536

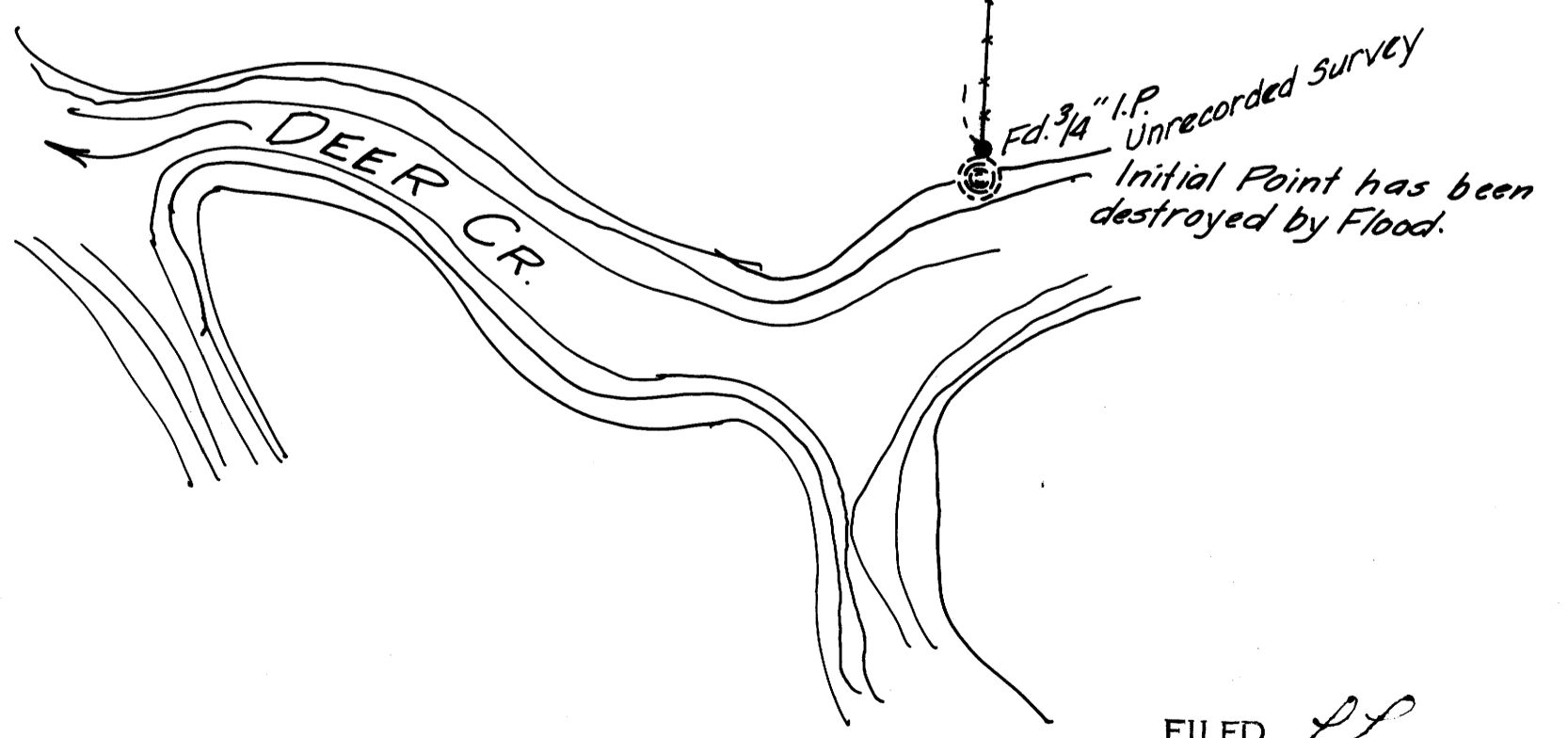

FILED RECEIVED
MAY 4 1965
COUNTY SURVEYOR
DOUGLAS COUNTY, ORE.