

Township 27 South
Range 6 West

Township 27 South
Range 5 West

Section 1
Section 12

Section 6
Section 7

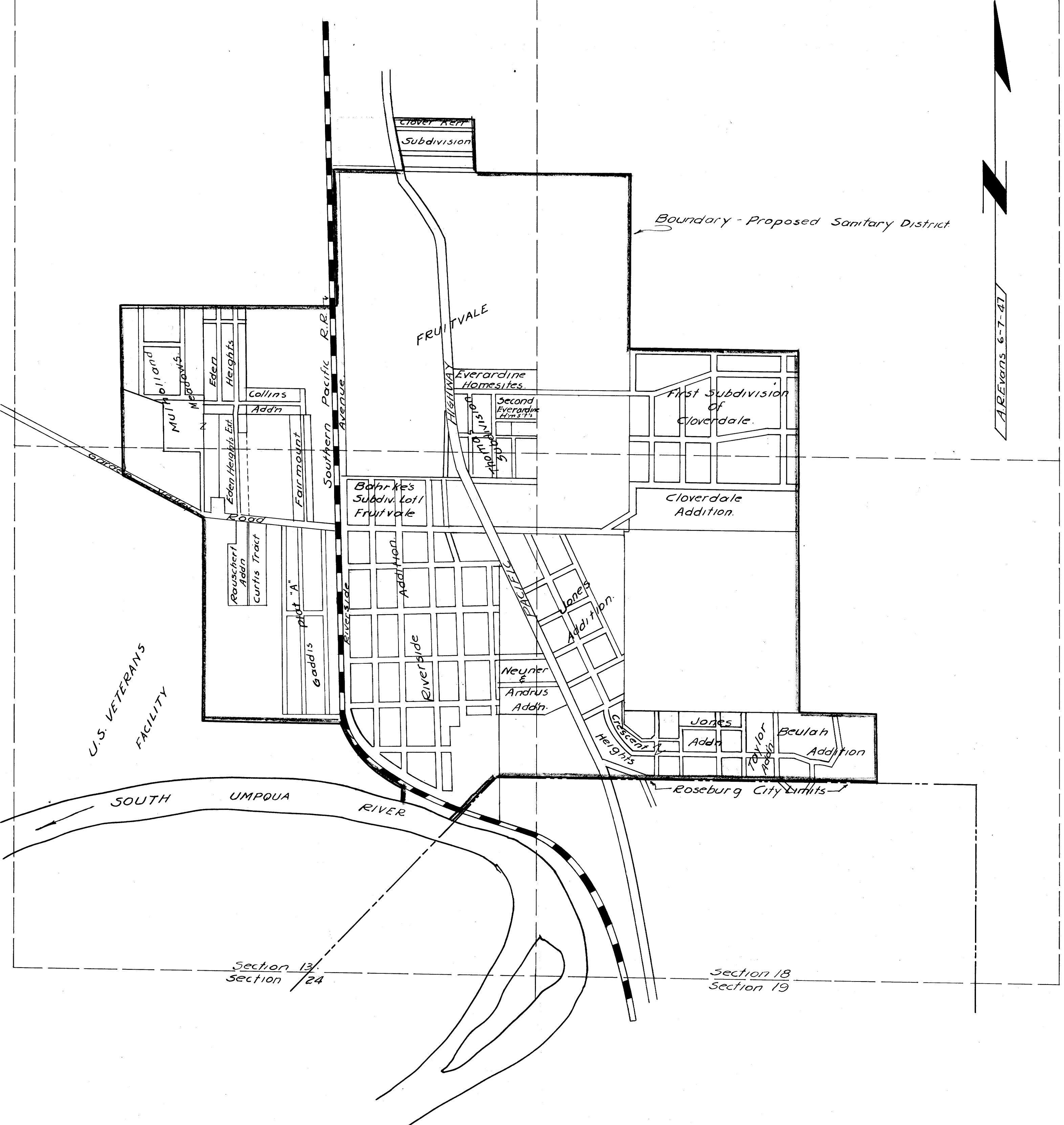

**PROPOSED SANITARY IMPROVEMENT DISTRICT
ADJACENT TO NORTH CITY LIMITS, ROSEBURG, ORE.**

BEN B. IRVING REGISTERED CIVIL ENGINEER

ROSEBURG OREGON

SCALE 8" = 1 MILE

COUNTY SURVEYORS FILE DATA
DO NOT REMOVE FROM OFFICE