

# SURVEY TO ESTABLISH PROPERTY CORNERS IN LOTS 1 & 2, BLOCK 14, MILLER'S ADDITION TO ROSEBURG, DOUGLAS COUNTY, OREGON

SURVEYED FOR: MRS. HELEN BITNER  
SURVEYED BY: G. R. LECKLIDER - ENG'R.

DECEMBER, 1959  
SCALE: 1" = 100'

- Denotes survey monuments found
- Denotes steel tube with survey cap set
- λ Denotes wooden stake set

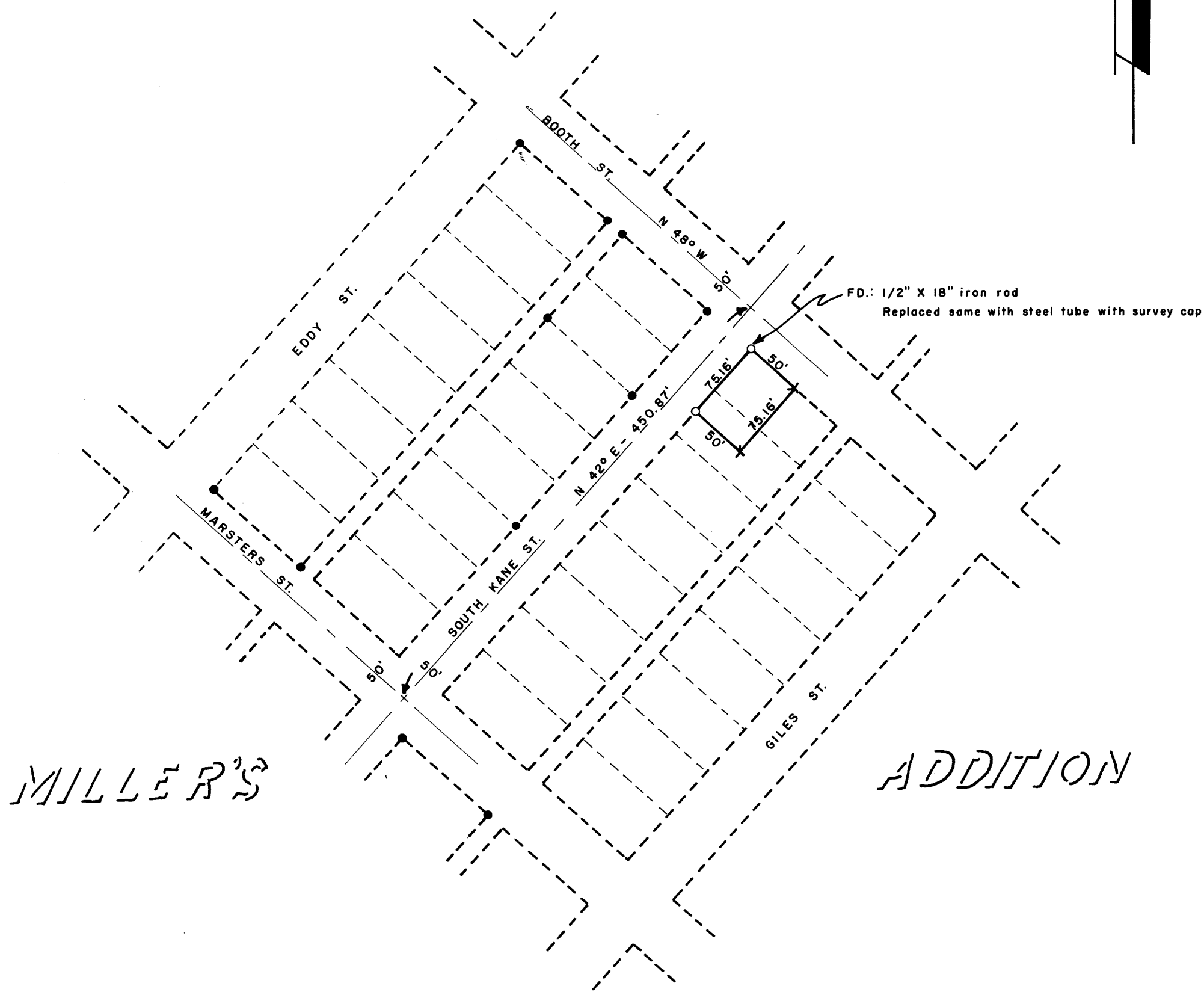

NOTE: BEARINGS SHOWN ARE BASED ON THE BEARINGS SHOWN ON THE PLAT OF MILLER'S ADDITION TO ROSEBURG AS FILED IN THE COUNTY CLERK'S OFFICE OF DOUGLAS COUNTY, OREGON

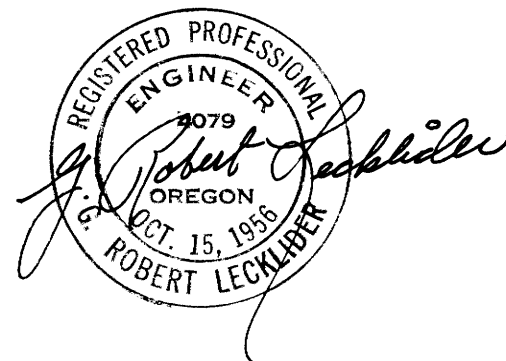

FILED  
RECEIVED

DEC 29 1959

COUNTY SURVEYOR  
DOUGLAS COUNTY, ORE.