

COUNTY SURVEYOR'S OFFICE
DOUGLAS COUNTY OREGON
SURVEY TO ESTABLISH CORNERS AND BOUNDARIES, NE¹/₄NW¹/₄, SE¹/₄NW¹/₄ & LOTS 3 & 4,
SECTION 30, T305, R3W, WM.

BEN B. IRVING COUNTY SURVEYOR
SURVEYED, NOV.-DEC. 1948, BY
A.R. EVANS, DEP. COUNTY SURVEYOR
SCALE 1" = 200'



COUNTY SURVEYORS FILE
NOT REMOVE FROM OFFICE

J. D. Wright

3 to 7305-RBld -

Nov. Dec. 1948

A. R. Evans - T

M. E. Godfrey H.C.

Frank Smith - R.C.

N. E. Richardson

Sta Dist Dep't & C.C. H.C. Slope (2)

512.9

✓

2

214L

H6-18

512.5 ✓

N3-30E ✓

N3 1/4 E

300.0

= 2043

93151
16°37L

1

634 ✓

N20-0730E ✓

N19°E

36°23'
18°11R

Spade
COR

24425

1305-

24.41

N1°56'E

N1°E

Inter.
D.L.C.
£

Sec Line

③ 11-5-48.

Clouety -

A R Evans T

Milo Godfrey HC

Frank Smith - Flag -

99396 ✓

99888 ✓

299.66

~~212.81~~

~~512.47~~

Auto Axle Found, Identified
From B.T.'s.

Mound of Rocks Intersected
By ~~Clinton~~ J. Amster - D.L.C. 39

C. S. File No. 73/6

Sfa Dist Deflt C.C. M.C. Slope ④

5
12011'

2500 ✓

2-02-30
N2-32-30E ✓

2708
+22-39 ✓

N13/4E

4

29° 25'
1443 R

1215 ✓

12-40
N12-40 W ✓

1222
+8-35 ✓

N123/4W

3

35° 18'
17039 L

3145 ✓

4-59
N5-29E ✓

N43/4E

2

2058
1020 R

5115

checked in field.

N3-30-E

5

✓
9/23/10

✓
9/23/10

C. S. File No. 73/6

Sta Dist Def't c.c. Mc Slope

1682'

8

2457'

~~4-25-30~~
N 45-30 E

2490'
-9-23'

7

13050'
6°55' L

N 4 E

789'

~~11-30-30~~
N 11-50-30 E

790'
+2-24'

N 1 1/4 E

6

17-36'
80°48' R

951'

~~2-32-30~~
N 9-05-30 E

9875'
+14-16'

N 2 1/4 E

5

1060'
0°30' R

~~2-02-30~~
N 2-92-30 E

1401'

98662 ✓

Logging road 27' ahead

99912 ✓

Top of ridge

96916 ✓

C. S. File No.

43/6

Sta Dist Defd C.C. M.C. Slope

1000'

Sec
Cor.

29/30

25°

2-24-30
N 1-54-30 W

N 2 1/2 W

29°
-22-47'

8676

10

9048'
4054'L

2-29-30
N 2-59-30 E

N 1 3/4 E

40'
-11-31'

7866

9

0°34'
0°20'L

2-49
N 3-49 E

N 1 E

967
+7°21'

8166

952
~~464~~

3-10'
1037'L

4-25-30
N 4-55-30 E

8

1680'

Sec. Cor Identified from

4 old Laurel B.T.'s

20" Laurel	N 40° E	33/ks	} ^{mine}
30" Laurel	S 45° E	40/ks	
18" "	N 55° W	19/ks	
14" Laurel	S 47° W	36/ks (Dead)	

Reset corner

Set 1 1/2" x 30" Iron Pipe

~~Blazed~~ Blazed and scribed

10" Chinquapiin N 31 1/2° W, 16 7'

Mkd. T 305-R 44 - 5-24 C.S.B.T.

12" Fir S 72 1/2° W - 50 2'

Mkd T 305-R 44 - 5-24 C.S.B.T.

Witnesses:

Set by A.R. Evans
D.C.S.

M.E. Godfrey

Frank Smith

Sta Dist Def. & C.C. %C Slope (10)

13

166.3 ✓

~~87-47~~
N86-58 E ✓

169.0 ✓
+10-14

N87 1/2 E

12

10.17'
0°39'L

275.2 ✓

~~88-25-30~~
N87-16-30 E ✓

284.4 ✓
+14-30

N88° E

11.

1039'
0°49'R

83.2 ✓

~~87-36~~
N88-26 E ✓

894 ✓
+17-55

N87 1/4 E

Section

18°01'
90°01'R

2-24-30
N 175 1/4 - 30 W ✓

101
1/3

11-8-48

Fair

Same crew

✓ 60484

51896

65156

C. S. File No. 23

Sta Dist Def's CC MC Slope (12)

16

296⁰ ✓

87.51-30

~~N 87° 51' E~~

N 88° 4' E

241.8

+11-56

15

264⁸ ✓

5053'
2056'L

5 89-12-[✓]E
~~89-39'E~~

589¹/₄E

268.5

+9-33

14

6°00'
3°00' R

295⁰ ✓

87-48

N 88-39 E

N 88 E

248.1

+8-20

13

0°02'
0°01' R

N 87-47 E

97839 ✓

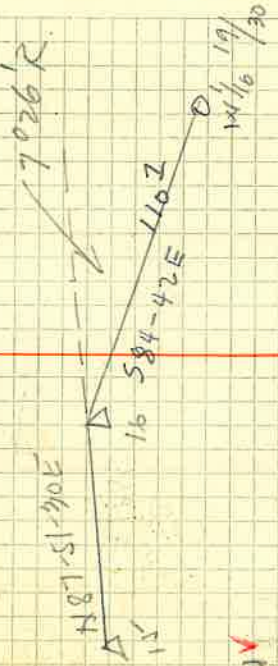

98611 ✓

Set $2\frac{1}{4}$ " X 36 " Iron Pipe
 for $W\frac{1}{16}$ Cor $19\frac{1}{30}$ -

Blazed and scribed B.T.

✓ 14" X Laurel South, 184
 Mk'd $W\frac{1}{16}$ S 30 - CS.B.T.
 22" Laurel N $18\frac{1}{2}$ W, 167
 Mk'd $W\frac{1}{16}$ S-19 - CS.B.T.

Sta Dist Dep't CC Alc Slope (19)

19

✓

118.2
+6-28

117.2

~~N 87-46 E~~
88-24-30

18

0°54'
0°27'L

N 89 E

213.5

+20-31'

200.2

~~N 87-43 E~~
88-51-30

N 89-13 E

17

0°21'
0°10'L

233.0

+18-14'

221.3

~~N 87-53 E~~
89-02

N 89 1/2 E

16

20°21'
10°10'R

N 87-51-30 E

15

99364 ✓

93657 ✓

94979 ✓

C. S. File No. 73/6

Sta Dist Def'd CC MC Slope

22

92⁴

88-40-30 ✓

S89⁴ E

14° 58'

95⁶ ✓

S88^{3/4} E

21

10° 46'
5° 23' R

88-4-30 ✓

N84⁴ E

175⁵ ✓
-6° 06'

174⁵ ✓

N86-15 E

20

30° 18'
10° 39' L

87-35-30 ✓

N86-27 E

79⁴
+2-38

79³ ✓

N88^{1/2} E

19

10° 38'
0° 49' L

N 88-24-30 E

11-9-48

(17)

Fair

Sane crew

✓
96608

Begin steep descent

✓
99449

Top of ridge -

✓
99898

C. S. File No.

43/6

Sta Dist Defs C.C. M.C. Slope

(18)

25

109.5

~~84-40-30~~
80-20
S 84-41 E

129.2 ✓
-32.02 ✓

24

130 L

7002'
3031'R

~~58-11-30~~
58-11 E

584 1/2 E

137.4 ✓
-18-49 ✓

23

10029'
514'R

86-34 ✓
~~NR-26~~ E

58 1/2 E

306.0 ✓

301 L

9031'
4045'L

NR 7 E

43.4 ✓
-27-15 ✓

22

S 88-40-30 E

✓
94697

✓
94656

✓
87673

✓
88902

263	02
38	58
<hr/>	
301	60

Sta Dist Dept CC. H.C. Slope

✓

1/4 Cor
19/90

230

20

5357+30E

-29°30'

25

4966E

5364E

584+0-30E

21

Location identified from O.B.T.'s
Corner destroyed -
Reset corner - by driving
2 1/2" x 36" boiler tube -
O.B.T.'s O.K. -

A.R. Evans -

Dep. Co. Surgeon
Witnesses!

A.E. Richardson D.C.S.

Milo Godfrey

Frank Smith.

C. S. File No. 13/6

Sta Dist Dep. # C.C. M.C. Slope

28

55 $\frac{3}{2}$

50-16-30N
~~50-0-0E~~

551 ✓
-9018'

South

27

0037
0°18'R

244 $\frac{3}{2}$

5-0-02E
~~5-0-0E~~

2559 ✓
-19221'

50°15'E

26

3017
1°38'R

3000 ✓

390 $\frac{4}{3}$
~~382~~

140-30
~~52-49E~~

-13°40' ✓
460-2 ✓
537 ✓
52 $\frac{1}{4}$ E -9°45' ✓

25

166°00'
83000'R

8440-30
~~505-49E~~

24

99189 ✓

95450 ✓

97169 ✓

$$\begin{array}{r} 29151 \\ 4692 \\ \hline 52 \end{array}$$

98556 ✓

$$\begin{array}{r} 390 \\ \hline 43 \end{array}$$

Sta DIST Def. & C.C. H.C. Slope 24

28

✓

2945' ✓
-14051'

284' 2

~~2-12~~
~~5005' W~~
E

53 1/4' E

30

6024'
3014' L

2176' ✓

-12059'

212' 2

~~1-02-30 W~~
~~5005' W~~

5015' W

29

3058'
1059' R

1084' ✓

-12809'

106' 00

~~0-56-30~~
~~5005' E~~

5045' E

28

2026'
1013' L

~~50-10-30 W~~
~~5005' E~~

✓
96660

✓
97844

✓
97760

25
C. S. File No. 43/6

Sta Dist Def F Cc Mic Slope

D.

1258

130°
+1927

C

P.O.T.

258°

2782
N 53 45 W
x 2281 v

A

90° 03'
45° 01'

5'

N 79 57 W

B

57 1/2 B

96764

Approx 1/6 car

2 RT4 from N rock car 5 each

2, RT4 from S Rock prop car

5.0010

Sta Dist Dept C. H.C. Slope

32

✓

156 $\frac{3}{4}$

156 $\frac{3}{4}$
+ 10 $\frac{3}{4}$

2-22

51-52 E

52 $\frac{1}{4}$ E

A

98° 28'
49° 14' R

298 $\frac{1}{2}$
- 220 $\frac{1}{2}$

258 $\frac{2}{3}$

551-86 E

C

480 24'
240 12' L

107 $\frac{1}{2}$
- 1° 51'

527-24 E

527 $\frac{1}{4}$ E

31

50° 24'
25° 12' L

52-42 E

99969 ✓

CN

1 1/16

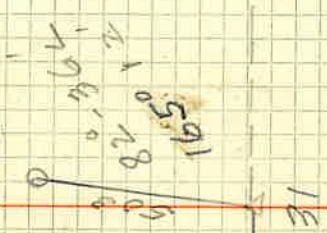

92587 ✓

Set 2 1/2" x 42" Iron Pipe,
for CN 1/16 Cor.

Blazed and scribed B.T.s.

99948 ✓

50" Fir N 16° W, 31.5'

48" Fir S 69° E, 20.5'

Both marked CN 1/16 S 30

C.S. B.T.

ARE

M.E.G.

F.D.S.

Reset from
prop corners
shown on Pg. 27

Sta Dist Dept c.c. H/c Slope

35

300' ✓

460' S
~~10-06-30~~
20-4-30 W ✓

-30' ✓

161' ✓

1-55' ✓

519' ✓

34

12018'
6009' L

300' ✓

-600' ✓

146' ✓

-10-5' ✓

~~26-15-30~~
26-45-30 W ✓

525' W

33

44° 40'
20° 50' R

102' ✓

-6-33' ✓

101' ✓

~~5-25-30~~
55-30 W ✓

54-45 W

32

5095'
9048' R

~~2-22~~
57-52 E

91

$$\begin{array}{r}
 299 \overline{) 57} \\
 \underline{161} \\
 460
 \end{array}$$

99855 ✓

99944 ✓

$$\begin{array}{r}
 298 \overline{) 35} \\
 \underline{146} \\
 444
 \end{array}$$

99449 ✓

99944 ✓



99341 ✓

C.S. File No. 43/6

Sto Dist Dept cc. Hc Slope (M)

Rock

Pass.

c/y

39²

S-31-06-3022E

38⁴
- 11⁰ 10'
18107

35

51⁰ 13'L

34

20-06-30
~~5-20-30-30W.~~

Found Rock Corner.
Identified from B.T.'s as
Center $\frac{1}{4}$ Corner, Sec. 30
Set by Deputy Co. Surveyor.

Sta Dist Def. E cc. Hc Slope (30)

38

72-57-30
~~N 72-27-30 W~~

73°
+7° 0'

72.5

N 73 1/2° W

37

4450'
2455' R

82-07-30
S 82-37-30 W

300°
+9° 57'

352.2

S 82 W

36

43° 51'
41° 58' R

300°
+8° 11'

670.6

S 60° 29 W

35

80° 05'
40° 02' R

300°
+11° 10'

S 70° 06 - 30 W

18° L

99255

98496

$$\begin{array}{r}
 295.5 \\
 56.7 \\
 \hline
 1.12 \\
 35
 \end{array}$$

98982

$$\begin{array}{r}
 294.32 \\
 79.37 \\
 \hline
 296.91
 \end{array}$$

98630

$$\begin{array}{r}
 296.91 \\
 \hline
 670.6
 \end{array}$$

98101

Sta Dist D.M.R. & C.C. M.C. (30) slope

41

1085

41-03
N40-33-W

109'
-5446'

40

5011'
2037L

~~38-16~~
N37-8-W

99'
+6011

92₂

5051'
2058R

N38 1/2 W

300'
+16024'

334-3

63° 06'
91033R

~~41-20-30~~
N40-54-30W

N41 1/2 W
+13° 23'

98

72-57-30
~~N72-27-30W~~

Top of ridge

99444 ✓

99418 ✓

95931 ✓

97284 ✓

46.5
287.8
—
34.3
3

Sta Dist Dell's CC P.C. (NS) Slope

44

108 4

76-33
577-24m.

109 2
-606.

43

187 4

13024'
6042'L
83-15
583-45m.

190 5
+10°16'

42

303.14

26009'
13055'L
83-40-30
N85-40-30m

113 2
-29°57'

N84 W

2072
-28°22'
219 L

41

2513'
42037'L
41-08
N40-33-126

99434

98399

Errek 40' back

80646 ✓

97.91.

88267 ✓

183.33

~~21.90~~

303.14

Sta Dist Dept CC. Pl.C. Slope (80)

1/4 Cor

1st Side

5-33

1243 ✓

+300'

1240

61-37 ✓
~~N 57-07-W~~ W.C.

N 62-W

46

43° 05' ✓
21° 33' R

300° ✓

-2000'

4060

83-09-30 ✓
N 82-39-30 W.

1064 L. ✓

N 83 1/2 W

45

51° 52' ✓
25° 56' R

3000 ✓

-15016'

3433

70-54-30 ✓
~~57-24-30 W.~~

539 ✓

S 70 3/4 W

44

10 11' ✓
5° 38' L

76-33 ✓
~~57-09-W.~~

90786 ✓

Location of Corner identified

from D.B.T.'s -

30" Fir 580E - 80 lks

alive & standing -
scribe marks plain -

22" Fir Stump - N65E 63 lks -

scribe MK "B.T. visible.

90899 ✓

Set $2\frac{1}{2} \times 36$ " Iron Pipe
for corner.

Blazed & scribed B.T.

12" Fir, N70E 380

Mkd $\frac{1}{4}$ 530 - C.S.B.T.

90471 ✓

Sta Dist Bqix C.C. H.C. Slope. (52)

49 /

695
4-25
~~N 3-55 W~~

498
+ 5028

N 4-15 W

48
10032'
5016'R

121 =
9-41
~~N 4-4 W~~

1280
+ 19049'

N 9 1/2 W

47
9031'
1016 L

7163
8-25-30
~~N 7-55-30 W~~

2415
+ 206035'

N 8 1/4 W

1/410
N 4 1/2 E
596

106023'
53011'R

61-37
~~N 6-37 W~~

43

✓
असुस

✓
असुस

✓
असुस

C. S. File no. 43/6

Sta Dist Dpt. L. cc. Pl. C. Slope

1

Sec

1811R

Cor

241/5

1237

N1-51E

1005'
 1005'
 1005'
 1005'

Roof

41° 37'
 20° 48' L

1005'
 1005'
 1005'
 1005'

2113'

652'
 652'
 652'
 652'

7105

22-39-30
 N22-09-30 E

+ 4° 56'

N23° 15' E

119

54° 09'
 29° 04' R

4-25
 N ~~25~~ W.

18

99630

C. S. File No. 73/6

Sta Dist \checkmark C.C. N.C. Shape ⁴⁰

51

105' \checkmark
+16-36
300' \perp

390' \checkmark

+15-02

N89-59-30E

50

0'0" \perp
0'01" \perp

E

250'

500' \perp

S89-59-30E

+5'51'

255' \perp

Approx

83-25
41-42L

S89 $\frac{3}{4}$ E

+8-56

$\frac{1}{16}$ lot

W side

S48-17E

1933

2

S80-26
128-13R

S48 $\frac{3}{4}$ E

N3-30E

1

12-9-48

Rain -
some gravel

41

N $\frac{1}{16}$ S30
on Rq line



125° 2'
251° 44'

Set 2 1/2" x 36" Iron pipe

For N $\frac{1}{16}$ Cor Sec 30 on Rq line

Blazed and scribed BT's

14" B. Oak S 35° E 154

30" Fir N 20° E 384

Both mtd

ARE

MEG

F.D.S.

N $\frac{1}{16}$ W S30 CS BT

C. S. File No. 43/6

98582

98596

62466

98788

Sta Dist ± C.C. N.C. Slope

54

✓

2732

268' ✓

N89-23E

+ 10-24

53

3060

N89E

1513

1036L

+ 13-36

147' ✓

S89-07E

589E

52

1646

0055E

2685

2625' ✓

N89-58.30E

E

+ 12-16

51

0062'
0061'
0061'L

N89-59-30E

90358 ✓

91116 ✓

91346 ✓

C. S. File No. 43/4

C. S. File No. 13/6

66.0
21.15
2.5

96507
70
11
16

81912

94880

Sta 2276.1
Dist 4
CC ✓
M.C
Shape 59

60
1482 ✓
N88-36E
188E
183 ±
-35-45

59
18°33'
9916R
N79-14-30E
N79E
99 ±
-26.57

58
868 ✓
9055'
30581
N83-17E
N79E
59 ±

57
8023'
4011L
N83 ± E
N83 ± E
700 ±

N 87-28-30E

(5)

67

67

81/57/8

89/40

99/57

C. S. File No. 43/b

Sta Dist δ CC ✓ H.C. Slope $\frac{52}{2}$

C

527-24E

31

104th
82° 16' R

60°
-29-16'

523 ✓ N 70-26E N 78° E

62

37° 42'
18° 51' L

308
-37-48

3018 ✓

N 89-17E

N 88 1/2 E

742
-29-54

61

60° 35'
39° 18' R

2553

-38-00

2012 ✓

N 85-59-35 E

50° 13'

N 84 1/4 E

60

20° 37' L

N 88-36 E

$$\begin{array}{r} 6736 \\ - 38 \\ \hline 6698 \end{array}$$

12-10-68

Rain
(and how!)

Same trend.

 \checkmark
87235

 \checkmark
79016
~~78537~~

86640

6476 \checkmark ~~32611~~

20127

237.05

64.79

$$\begin{array}{r} 20127 \\ + 64.79 \\ \hline 20181 \end{array}$$
78801 \checkmark

Sta	Dist	±	cc	M.C.	Slope
93					253'
	246 [±]	S 1° 01' + 26 W			-13-27
		D ⁰ 58'		S	
92		D ⁰ 29 R			162' L
	304 [±]	S 0° 32' + 30 W			
		S 14 W			300 [±]
		S-49'			-100'
71		2° 55' L			
	259 [±]	S-3-27 W			460 [±]
		D ⁰ 03'		S 3 W	
		D ⁰ 02' L			-4-47
70					
	122 [±]	S-3-28-30 W			132' L
		209° 06'		S 3 W	-22-15
		104° 33' L			
NW 1/4	147 [±]		N 71-58 W		
54					

53

Set 1" x 72" Iron Drive Shaft
for NW 1/4 Cor Section 30.
Blazed and scribed 13 T's.

18" Fir N66°W, 169'
14" Fir N72°E 394'

Both MKd NW 1/4 Cor, S. 30.
C.S.B.T.

ARE.
MEG.
F.D.S.

28828
163
30458

92574

NW 1/4 Cor
4-37E

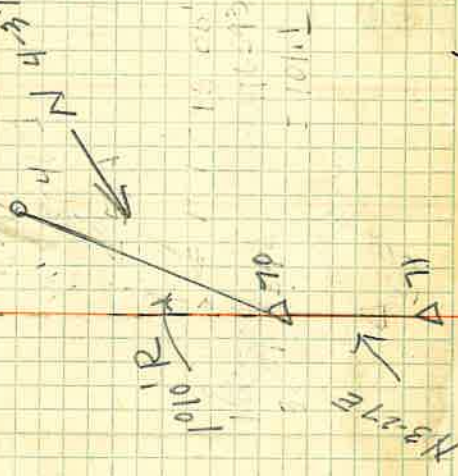

1000
1013
1011

C. S. File No. 73/6

916974

916974

92574

Sta DIST \pm C.C. H.C. Slope (5)

40 548-14-30E

19 40

CH 1/10 59°50R

75 3. 511-35-30W

79 2. 4
-17°30

511W

23028

110 44R

122 2
-3008

122 0 50-08-30E

51E

5 53

20 50 L

94 0

+12-47

234 4 52-48W

51 1/2 W

147 0

-13-49

30 33

10 40 R

51-01-30W

73

59-50
S-10-370A

57

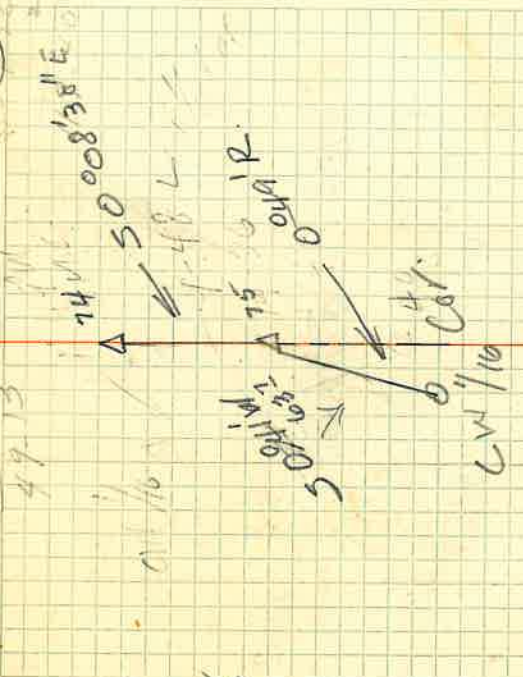

Set $2\frac{1}{2}'' \times 36''$ Iron Pipe
for CW $\frac{1}{16}$ Cor.

Blazed and scribed B.T.S

15" Fir South 100'

18" " N 80° W 312'

Both med CW $\frac{1}{16}$ 530. C.S.B.T.

ARE
MEG.

147.75
91.44
234.42

C.S. File No. 43/6 F.D.S.

Sta Dist \pm CC MC Slope m^2

98

1980

N 87-54-30 W

-23-24'

2160

97

181° 18'

N 89 W

90° 30' R

622

-28-22'

552

S 1-16-30 W

S 1 W

96

30° 09'

1035 L

1255

1152

S 3-01 W

-23-13'

CN 1/16

170° 09'

8035 L

S 3 W

95

S 11-35-30 W

91660

57' ahead to fence cor. Approx.
NE cor D.C.C.

87993

1" x 3/8" iron pipe
set cor at intersection of
for 1/16" line & Int. D.C.C. line

51-26-30 in

91902

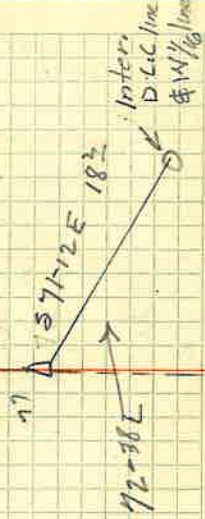

C. S. File No. 43/6

Sta Dist \neq CC A.C. Slope $\text{\textcircled{R}}$

Int Cor

DLC

1398'

1394' 582-8-30W

582 1/2 W

-4' 06"

35-48'

12-54L

80

2448'

2424' N 84-07-30W

-8-02'

6003'

N 85W

79

301'R

1923'

1876' N 87-09 W 1/2

-12+45'

1031'

N 88W

78

0' 45" R

N 87-54-30 W

68
Fd Rock wifer X

16" Fir N 30 W 261ks-

12" Fir N 60 E 261ks-

99744

99019

91534

C. S. File No. 73/6

Sta Dist \pm CC. H.C. Slope

92

N 16-29 W

1792

586-48 E

587 E

91

16025'

80 1/2 R

585-1830 W

928 L

3727

N 85-00 E

306 E

90

9009'

4005 L

N 85 E

410 1/2 W

2459

S 89-53 W

N 89-34 E

4006'

2003 L

N 87 1/2 E

Int. 5

Line

Dec.

2948

N 88-04 W

588-23 E

E. Int.

Dec

588 1/2 E

Cor 15

POT

588-23 E

N 88-04 W

Cor 14

6

0.8
0.8
0.8

~~0.0478~~
0.0478

Set $1\frac{1}{4}$ " I.P. at intersection of
S. Projection E. line D.L.C. &
S. line D.L.C. 46.85

C. S. File No. 43/6

Sta	Dist	F	CC	P.C	Scope
Q4	681.5 ✓	181°00'	N1-31°E	N1 1/4°E	1448 +11-55'
		90°30'L			300° +1°00'
					240°
					+2006'
SE Coy		181°00'			
D&C Bq		90°30'L			
	879	N87-33 W			
		587-51°E			
		71-4°S			
Q4		87-51°L		588°E	
			S		
			W		
	4685	71°18-30°E			
		South			
		73°35		S	
Q4		86-48°R			
		+186-29°E			
		586-48°E			

✓
97845

27
239.84 ✓
244.96 ✓
141.68 ✓

68.18 ✓

✓
99965

✓
99933

Fd. Gear with flange - buried

16" underground

1-B.T. drive & standing -

1 1/2" Oak - W.S.E. case

Sta Dist \pm CC. P.C. 9 slope

76

Dist

\pm

CC.

P.C.

9 slope

51-26.3011
N1-08.80E

77

15090'
75025R

573-5830E

112'

Dist

N74-16.30N

-11-24'

76

15151'
75035L

N75W

57611

Dist

51-57W

215'

+289'

95

POT.

N11/2E

Dist

51-57W

675'

+16-19'

94

POT.

N1E

215'

+12-48'

51-57W
N1-39E

67



88191

Set 2 1/2 X 42" Iron Pipe
 Mkd BT's
 30" Fir N 10° W - 807 +27-30'
 12" Fir N 85° W - 985' L
 98101

89636

168.17
 60.50
 108.67
 Both Mkd Ext "L"
 D.L.C. 39
 C.S.B.T.

91115

