

COUNTY SURVEYORS FILE
DO NOT REMOVE FROM OFFICE

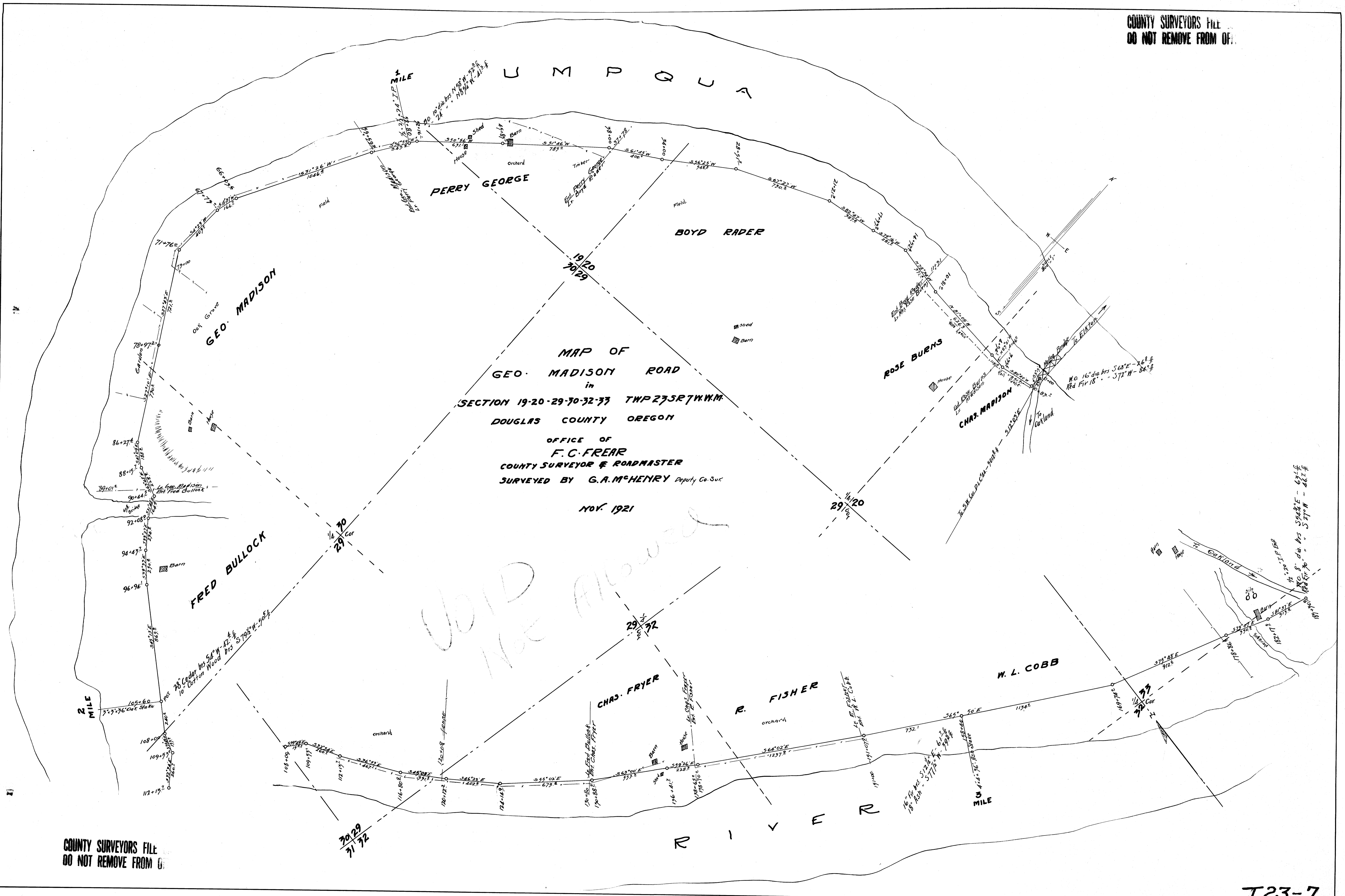

MAP OF
 GEO. MADISON ROAD
 in
 SECTION 19-20-29-30-32-33 TWP 23 S R 7 W M. 11
 DOUGLAS COUNTY OREGON
 OFFICE OF
 F. C. FREAR
 COUNTY SURVEYOR & ROADMASTER
 SURVEYED BY G. A. McHENRY Deputy Co. Sur.

NOV. 1921

VOID NOT ALLOWED

COUNTY SURVEYORS FILE
DO NOT REMOVE FROM OFFICE