

Abandoned Reservoir Location as plotted from descriptions pages 108 & 110 of Abstract. This is plotted from the assumption that the South line of the roadway is the division line between H.W. Gamble and Young & Co. This assumption is supported by statement of adjoining property owner and conditions existing on the ground.

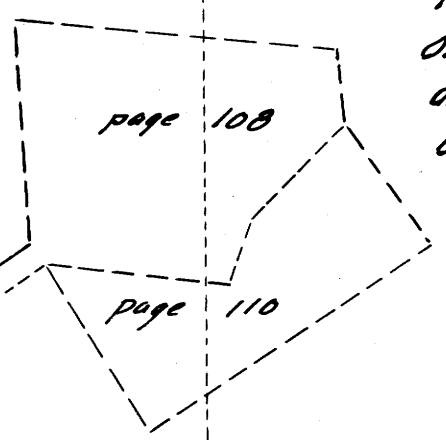

SE corner of old Masonic cemetery. This was only used for a short time if at all. Now abandoned as a cemetery.

DEED DESCRIPTION:- Beginning at a point from which the 1/4 section corner between Secs. 33 & 4 T24 & 25S R5W, W.M. bears N23°39'W 21.57 Chains Thence S34°3'E 3.17 Chs., Thence N155°57'E 3.16 Chs. Thence N34°3'W 3.17 Chs. Thence S55°57'W 3.16 Chs. to the place of beginning containing 1.00 Acres more or less.

Also a roadway 15ft wide beginning point of which is identical with the beginning point of the above described 1.00 Acre tract; Thence S55°57'W 90 ft. to the east line of the county road, Thence in a southerly direction along the east line of the said county road 15ft, Thence N55°57'E 91 ft to the above described 1.00 Acre tract; Thence N34°3'W 15ft to the place of beginning containing 0.31 acres more or less. All of the above described lands are located in Sec. 4 T 25S R5W W.M. Douglas Co. Oregon.

OAKLAND WATER SYSTEM.
RESERVOIR DESCRIPTION & TIE
Surveyed and Platted by
BEN. B. IRVING ROSEBURG, OREGON.
Registered Civil Engineer-Deputy County Surveyor.
October 30-31, 1929
SCALE 1" = 2 CHAINS.

COUNTY SURVEYORS FILE DATA
DO NOT REMOVE FROM OFFICE

Drawer 55-

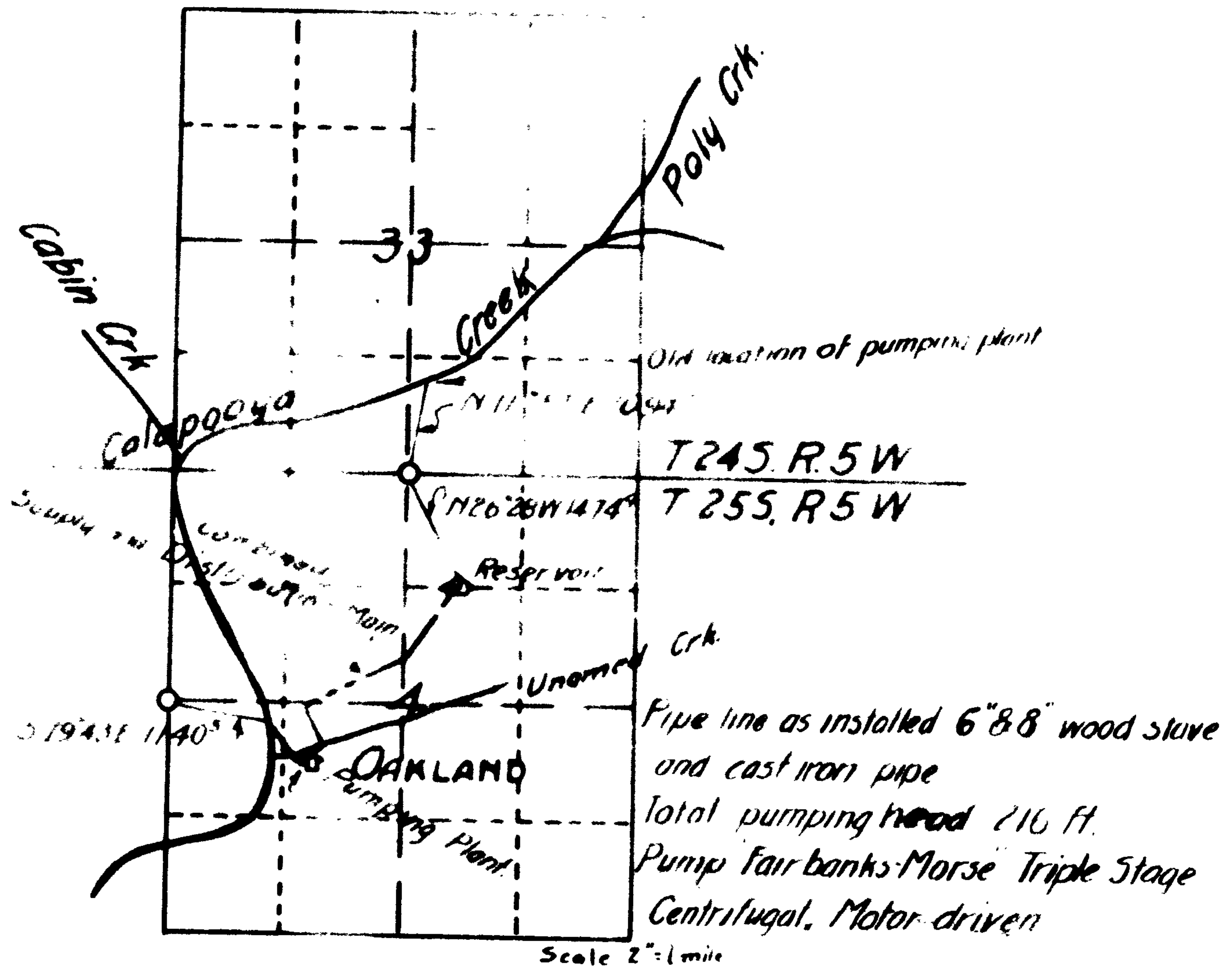

MAP OF
MUNICIPAL WATER SUPPLY OF
OAKLAND OREGON
 IN
SECTION 4 TWP. 25S., RANGE 5W., WM.
DOUGLAS COUNTY OREGON

OFFICE OF
BEN. B. IRVING
 CIVIL ENGINEER & SURVEYOR

CERTIFICATE OF SURVEYOR

I, Ben. B. Irving of Roseburg, Oregon, do hereby certify that this map was made from notes taken during an actual survey made by me on the third day of May 1928, and that it correctly represents the works described in the accompanying application together with the location of streams and other ditches in the immediate vicinity.

OREGON N° 240

Date of Registration Nov. 8. 1919

Ben B Irving

Registered Professional Engineer