

COUNTY SURVEYORS FILE
DO NOT REMOVE FROM OFFICE

Survey For Deed Description
in
Section 17, T.22S., R.5W. W.M.
for
WILLIAM Griswold
Scale 1" = 60' Aug 28, 1956

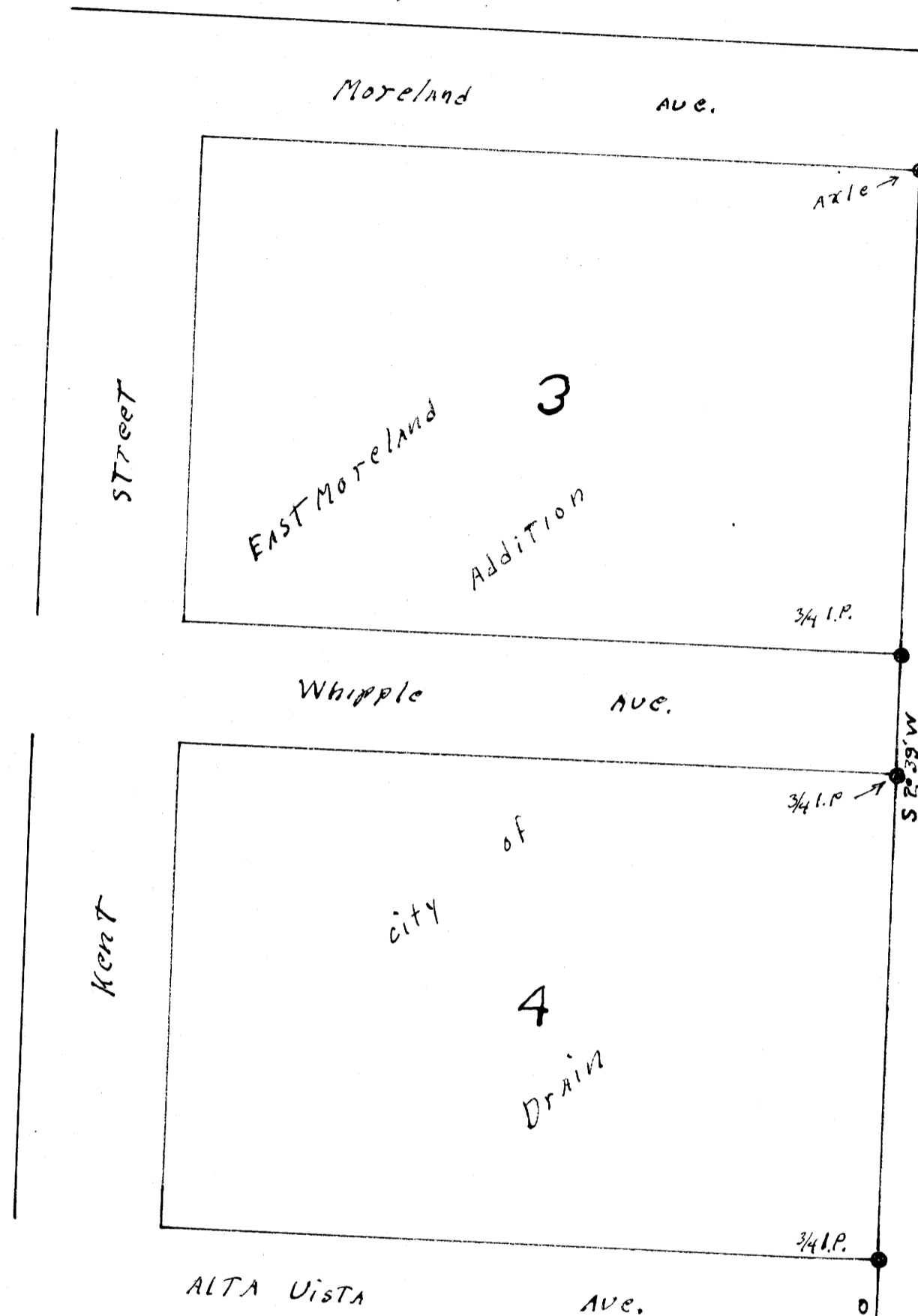

- Existing Monument found
- Set 24" angle irons with
C.N.P.s inscribed - Survey
Point - Wilford N. HAINES
239.

REGISTERED
OREGON
LAND SURVEYOR

Wilford N. Haines

MAY 7, 1948
WILFORD N. HAINES
239

FILED
RECEIVED

AUG 31 1956

COUNTY SURVEYOR
DOUGLAS COUNTY, ORE.

MAP FILE M3, 2