

LEGEND:

- ▣ SET 5/8" x 30" IRON ROD w/CAP MARKED "I.E. ENGINEERING" UNLESS OTHERWISE NOTED
- FOUND 5/8" IRON ROD UNLESS OTHERWISE NOTED
- FOUND ALUMINUM CAP
- △ CALCULATED POSITION
- () R1 RECORD AS PER VOL. 21, PG. 58

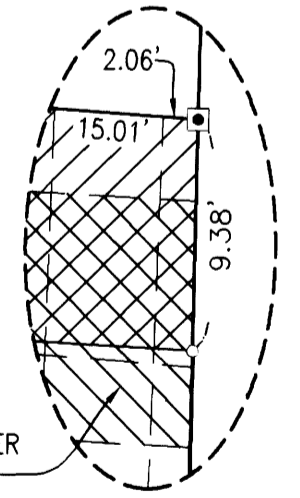

EXISTING 15' WIDE POWER EASEMENT PER VOL. 294, PG. 513

DETAIL
SCALE: NTS

CURVE TABLE					
CURVE	CHORD BEARING	CHORD LENGTH	RADIUS	CURVE LENGTH	DELTA
C1	S83°59'04"W	158.47'	470.00'	159.23'	19°24'40"
C2	N83°13'19"E	165.28'	530.00'	165.95'	17°56'26"
C3	N76°15'50"E	37.22'	530.00'	37.23'	4°01'28"
C4	N81°39'29"E	62.53'	530.00'	62.57'	6°45'51"
C5	N88°36'58"E	66.11'	530.00'	66.16'	7°09'07"

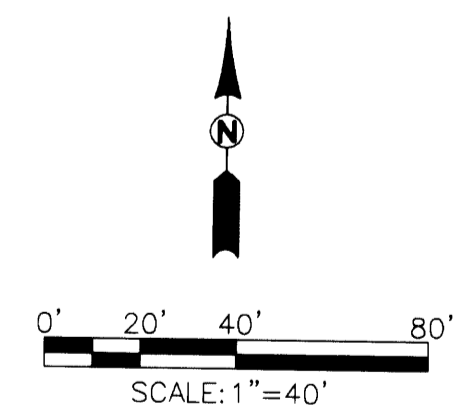

<p>REGISTERED PROFESSIONAL LAND SURVEYOR</p> <p><i>Ronald A. Quimby</i></p> <p>OREGON JULY 14, 1978 RONALD A. QUIMBY 1654</p> <p>EXPIRES: 12/31/2006</p>	<p>REPLAT OF LOTS 8 THROUGH 12 OF CLEARWATER 2 SUBDIVISION</p> <p>LYING IN THE WEST 1/2 SECTION 20, TOWNSHIP 27 SOUTH, RANGE 5 WEST, WILLAMETTE MERIDIAN, DOUGLAS COUNTY, OREGON</p>	
	<p>SURVEYED FOR: JERRY TABOR 615 DAIRY LOOP RD. ROSEBURG, OR 97470</p>	<p>SURVEYED BY: i.e. ENGINEERING 505 SE Main Street Roseburg, Oregon 97470 PHONE (541) 673-0166 FAX (541) 440-9392 iemail@ieengineering.com</p>
<p>SCALE: AS SHOWN</p>	<p>JOB NO: 859-12 DATE: NOV., 2006</p>	<p>DWG. BY: JAC PM: BHK</p>