

LEGEND:

- SET 5/8" x 30" IRON ROD w/CAP MARKED "I.E. ENGINEERING" UNLESS OTHERWISE NOTED
 - FOUND 5/8" IRON ROD UNLESS OTHERWISE NOTED
 - FOUND ALUMINUM CAP
 - △ CALCULATED POSITION
- () R1 RECORD AS PER VOL. 21, PG. 58

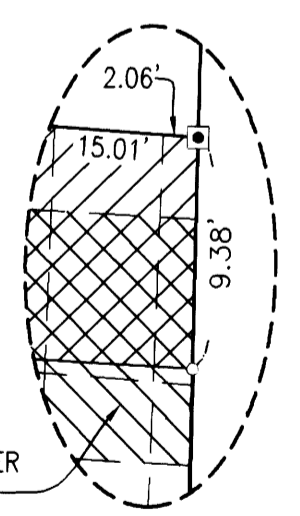

EXISTING 15' WIDE POWER EASEMENT PER VOL. 294, PG. 513

DETAIL
SCALE: NTS

CURVE TABLE					
CURVE	CHORD BEARING	CHORD LENGTH	RADIUS	CURVE LENGTH	DELTA
C1	S83°59'04"W	158.47'	470.00'	159.23'	19°24'40"
C2	N83°13'19"E	165.28'	530.00'	165.95'	17°56'26"
C3	N76°15'50"E	37.22'	530.00'	37.23'	4°01'28"
C4	N81°39'29"E	62.53'	530.00'	62.57'	6°45'51"
C5	N88°36'58"E	66.11'	530.00'	66.16'	7°09'07"

REGISTERED PROFESSIONAL LAND SURVEYOR

Ronald A. Quimby

OREGON
JULY 14, 1978
RONALD A. QUIMBY
1654

EXPIRES: 12/31/2006

REPLAT OF LOTS 8 THROUGH 12 OF CLEARWATER 2 SUBDIVISION

LYING IN THE WEST 1/2 SECTION 20, TOWNSHIP 27 SOUTH, RANGE 5 WEST, WILLAMETTE MERIDIAN, DOUGLAS COUNTY, OREGON

SURVEYED FOR:
JERRY TABOR
615 DAIRY LOOP RD.
ROSEBURG, OR 97470

SURVEYED BY:
i.e.
ENGINEERING
505 SE Main Street
Roseburg, Oregon 97470
PHONE (541) 673-0166
FAX (541) 440-9392
iemail@ieengineering.com

SCALE: AS SHOWN

DATE: NOV., 2006

JOB NO: 859-12
DWG. BY: JAC
PM: BHK

PAGE: 1 OF 2

DECLARATION:

KNOW ALL PEOPLE BY THESE PRESENTS THAT JERRY L. TABOR BUILDING, INC., IS THE OWNER OF THE LAND REPRESENTED HEREON AND MORE PARTICULARLY DESCRIBED HEREIN AND HAS CAUSED THE SAME TO BE PLATTED BY THE NAME OF "REPLAT OF LOTS 8 THROUGH 12 OF CLEARWATER 2 SUBDIVISION" TOGETHER WITH EASEMENTS AS SHOWN.

Jerry Tabor 10/14/07
 JERRY L. TABOR DATE
 (PRESIDENT, JERRY L. TABOR BUILDING INC.)

SURVEYOR'S CERTIFICATE:

I, RONALD A. QUIMBY, OREGON PROFESSIONAL LAND SURVEYOR NO. 1654, HEREBY CERTIFY THAT I HAVE CORRECTLY SURVEYED AND MARKED WITH PROPER MONUMENTS THE LAND SHOWN ON THE ANNEXED PLAT OF WHICH THE FOLLOWING IS A TRUE AND CORRECT DESCRIPTION:

A PARCEL OF LAND CONSISTING OF LOTS 8, 9, 10, 11 AND 12 OF "CLEARWATER 2 SUBDIVISION" (VOLUME 21, PAGE 58, INSTRUMENT NUMBER 2005-021360) RECORDED IN THE DOUGLAS COUNTY PLAT RECORDS, LOCATED IN THE WEST HALF OF SECTION 20, TOWNSHIP 27 SOUTH, RANGE 5 WEST, WILLAMETTE MERIDIAN, DOUGLAS COUNTY, OREGON TOGETHER WITH THAT PORTION OF VACATED WALDON AVENUE RECORDED AS INSTRUMENT NUMBER ~~2006-023595~~, DOUGLAS COUNTY PLAT RECORDS

ACKNOWLEDGMENT:

STATE OF Oregon
 COUNTY OF Douglas } ss.

KNOW ALL PEOPLE BY THESE PRESENTS, ON THIS 14th DAY OF November, 2007, BEFORE ME A NOTARY PUBLIC IN AND FOR SAID STATE AND COUNTY, PERSONALLY APPEARED JERRY L. TABOR WHO DID SAY THAT HE IS THE IDENTICAL PERSONS NAMED IN THE FOREGOING INSTRUMENT AND THAT HE EXECUTED SAID INSTRUMENT FREELY AND VOLUNTARILY.

Elaine Berg
 NOTARY SIGNATURE

Elaine Berg
 NOTARY NAME

NOTARY PUBLIC - Oregon
 COMMISSION NO.: 405611
 MY COMMISSION EXPIRES: June 23, 2010

NARRATIVE:

THE PURPOSE OF THIS SURVEY WAS TO REPLAT THE ABOVE DESCRIBED PARCEL INTO THE LOT AS SHOWN. THE PROCEDURE WAS AS FOLLOWS: EXISTING MONUMENTS OF RECORD WERE TIED AND HELD AS SHOWN. THE BOUNDARIES WERE DETERMINED FROM THE PREVIOUS SURVEY "CLEARWATER 2 SUBDIVISION" (VOLUME 21, PAGE 58) RECORDED IN THE DOUGLAS COUNTY PLAT RECORDS. THE SOUTHERLY RIGHT-OF-WAY BOUNDARY OF WALDON AVENUE WAS ESTABLISHED BY HOLDING MONUMENTS FOUND ON THE CENTERLINE OF OF WALDON AVENUE AND RIGHT-OF-WAY VACATION INSTRUMENT NUMBER 2006-023595. MONUMENTS WERE SET TO DELINEATE LOT LINES AND RIGHT-OF-WAY AS SHOWN.

P.U.E. NOTE:

PUBLIC UTILITY EASEMENTS SHOWN ON THIS MAP ARE SUBJECT TO RESTRICTIONS RECORDED IN INSTRUMENT NUMBER 2007-000867 OF DEED RECORDS OF DOUGLAS COUNTY.

FIELD CREW: MIKE FROMDAHL AND JOSH MAXWELL
EQUIPMENT: NIKON STATION AND TDS RECON DATA COLLECTOR
OFFICE: BRENT KNAPP
DRAFTING: JOE COOK

TAX COLLECTOR STATEMENT:

I HEREBY CERTIFY THAT TAXES AND SPECIAL ASSESSMENTS OR OTHER CHARGES REQUIRED BY LAW HAVE BEEN PAID.

Sandra S. Cornee 1/12/07
 DOUGLAS COUNTY TAX COLLECTOR DATE

COMMUNITY DEVELOPMENT DEPARTMENT FILE NO. SRE-06-1

APPROVALS:

S. Sweet 11/20/06
 PLANNING COMMISSION CHAIRMAN DATE
Frederick H. Alley 11/20/06
 COMMUNITY DEVELOPMENT DIRECTOR DATE
[Signature] 11/20/06
 PUBLIC WORKS DIRECTOR DATE
Randy Wan 11-28-06
 DOUGLAS COUNTY SURVEYOR DATE
RON NORTHCRACK 1-12-07
 DOUGLAS COUNTY TAX ASSESSOR DATE
[Signature] 1-12-07
 DOUGLAS COUNTY COMMISSIONER DATE
[Signature] 1-12-07
 DOUGLAS COUNTY COMMISSIONER DATE
 FILED THIS 12th DAY OF JANUARY 2007, 3:08 O'CLOCK PM
 2007-000868
BARBARA E. NIELSEN
 DOUGLAS COUNTY CLERK
Elaine G. Burnett 1-12-07
 BY: DEPUTY DATE

ZONE: MR-14
 COMP. PLAN: LDR
 WATER: CITY OF ROSEBURG
 SEWER: ROSEBURG URBAN SANITARY AUTHORITY

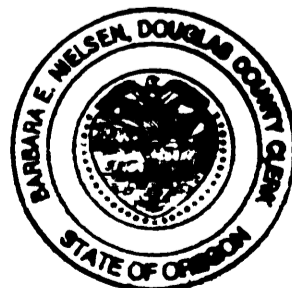

REGISTERED PROFESSIONAL LAND SURVEYOR
Ronald A. Quimby
 OREGON
 JULY 14, 1978
 RONALD A. QUIMBY
 1654
 EXPIRES: 12/31/2006

REPLAT OF LOTS 8 THROUGH 12 OF CLEARWATER 2 SUBDIVISION	
LYING IN THE WEST 1/2 SECTION 20, TOWNSHIP 27 SOUTH, RANGE 5 WEST, WILLAMETTE MERIDIAN, DOUGLAS COUNTY, OREGON	
SURVEYED FOR: JERRY TABOR 615 DAIRY LOOP RD. ROSEBURG, OR 97470	SURVEYED BY: i.e. ENGINEERING 505 SE Main Street Roseburg, Oregon 97470 PHONE (541) 673-0166 FAX (541) 440-9392 iemail@ieengineering.com
SCALE: NO SCALE	JOB NO: 859-12 DATE: NOV., 2006 DWG. BY: JAC PM: BHK
PAGE: 2 OF 2	

VOL. 22 PAGE 33 B

VOL. 22 PAGE 33 B