

DOUGLAS COUNTY OFFICIAL RECORDS
 BARBARA E. NIELSEN, COUNTY CLERK
 2006-016086
 NO FEE
 06/27/2006 01:04:30 PM
 PLAT-SUB Cnt=1 Stn=1 RECEIPTCOUNTER
 This is a no fee document

REPLAT OF LOTS 1-5, NORTH PORTION OF 6, 9-12 & 17-20
KRUSE TERRACE TRACTS, VOL. 9, PG. 6
 IN THE NORTHEAST 1/4, SEC. 19, T. 25 S., R. 5 W., W.M.
 CITY OF SUTHERLIN, DOUGLAS COUNTY, OREGON - MAY 2006
 FILE REP-2005-12-16

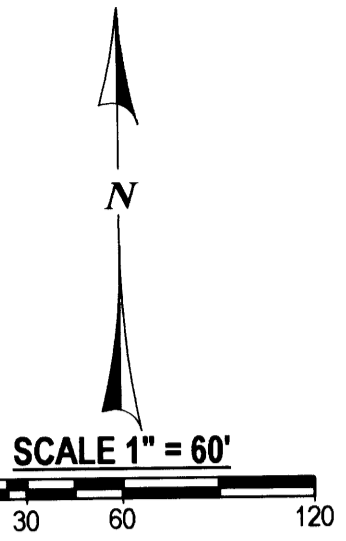

DECLARATION:

KNOW ALL PEOPLE BY THESE PRESENTS THAT GENE WHITAKER, OF GENE WHITAKER INC. DOES HEREBY DECLARE THAT HE IS THE OWNER OF THE LAND AND THAT HE DOES CAUSE THE PROPERTY TO BE REPLATTED IN ACCORDANCE WITH THE PROVISIONS OF CHAPTER 92, OREGON REVISED STATUTES AND IN ACCORDANCE WITH CITY OF SUTHERLIN PLANNING COMMISSION APPROVAL FILE REP-2005-12-16 AND HE DOES DEDICATE TO THE CITY OF SUTHERLIN FOR PUBLIC USE THAT PORTION SHOWN AND DESCRIBED HEREON FOR THE EXTENSION OF MYRTLE STREET AND HE DOES CREATE FOR THE BENEFIT OF THE CITY OF SUTHERLIN AN ADDITIONAL UTILITY EASEMENT AS SHOWN IN THE DETAIL.

Gene Whitaker
 GENE WHITAKER FOR GENE WHITAKER INC.

SURVEYORS CERTIFICATE:

I, CARL A. SWEEDEN, A REGISTERED PROFESSIONAL LAND SURVEYOR DO HEREBY CERTIFY THAT I HAVE CORRECTLY SURVEYED AND MARKED THE LAND SHOWN HEREON IN ACCORDANCE WITH OREGON REVISED STATUTES, CHAPTER 92.

Carl A. Sweeden
 CARL A. SWEEDEN

REGISTERED PROFESSIONAL LAND SURVEYOR
Carl A. Sweeden
 OREGON
 CARL A. SWEEDEN
 2752
 JANUARY 16, 1996
 EXPIRES 6-30-08

R/W CURVE INFORMATION:

CURVE	DELTA	RAD	ARC	TAN	CHORD	CHORD BRG
1	52°43'59"	151.57	139.50	75.13	134.63	N 20°17'00"W
2	2°36'03"	196.39	8.91	4.46	8.91	N 45°20'58"W
3	46°10'04"	136.39	109.90	58.13	106.95	S 23°33'57"E

EASEMENTS OF RECORD:

EASEMENTS AS RECORDED IN INST. #06-006513
 OVERHANG EASEMENT TO OREGON / CALIFORNIA POWER CO., INST. #95898

AREA OF DEDICATION TO THE CITY OF SUTHERLIN FOR PUBLIC PURPOSE

APPROVALS:

Samuel Peterson 6-27-06
 DOUGLAS COUNTY COMMISSIONER DATE
Carl A. Sweeden 6-26-06
 DOUGLAS COUNTY COMMISSIONER DATE
Ron Neumann 6-26-06
 DOUGLAS COUNTY ASSESSOR DATE
Randy Smith 6-23-06
 DOUGLAS COUNTY SURVEYOR DATE
Barbara E. Nielsen 6-27-06
 COUNTY CLERK DATE
 CITY OF SUTHERLIN PLANNING COMMISSION.

I HEREBY CERTIFY THAT ALL TAXES AND SPECIAL ASSESSMENTS OR OTHER CHARGES REQUIRED BY LAW HAVE BEEN PAID.

Sandra K. Conese 6/27/06
 DOUGLAS COUNTY TAX COLLECTOR DATE

FILED THIS 27 DAY OF June 2006
 at 1:04pm
 BARBARA E. NIELSEN
 COUNTY CLERK
 By *Carl Engen* Deputy

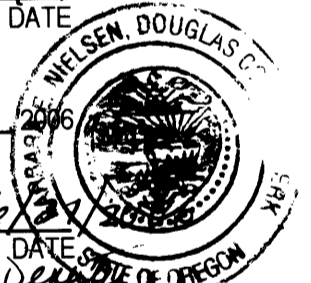

ACKNOWLEDGEMENTS:

STATE OF OREGON)
 COUNTY OF DOUGLAS)

THERE PERSONALLY APPEARED BEFORE ME GENE WHITAKER OF GENE WHITAKER INC. WHO IS KNOWN TO ME TO BE THE IDENTICAL INDIVIDUAL WHO EXECUTED THE FORGOING INSTRUMENT AND WHO DOES HEREBY ACKNOWLEDGE SAID INSTRUMENT TO BE HIS VOLUNTARY ACT AND DEED.

THIS INSTRUMENT WAS ACKNOWLEDGED BEFORE ME ON THIS:

19th DAY OF June, 2006.

Serri M Ayres *Jenni M Ayres*
 NOTARY PUBLIC - OREGON (PRINTED NAME) (SIGNATURE)

A397107 11-9-2009
 COMMISSION NO. MY COMMISSION EXPIRES

LEGAL DESCRIPTION:

PART A, INST. #95-00061 AND LOTS 1-4, 9-12 AND LOTS 17-20, KRUSE TERRACE TRACTS AS PER PARCEL 1, INST. #91-11757, ALL OF DOUGLAS COUNTY, OREGON DEEDS AND RECORDS AND ALSO: THAT PORTION OF VACATED WESTWOOD STREET DESCRIBED IN INST. #04-008946 AND ALL OF THAT PORTION OF WESTWOOD STREET ADJOINING THE PREVIOUSLY DESCRIBED LANDS PER ORS 271.140.

DEDICATION DESCRIPTION:

BEGINNING AT A POINT ON THE WEST LINE OF MYRTLE STREET AS PLATTED IN KRUSE TERRACE TRACTS AND BEING N 6°05'00" E 204.97 FEET FROM THE SOUTHEAST CORNER OF LOT 20; THENCE 139.50 FEET ALONG THE ARC OF A CURVE TO THE LEFT HAVING A RADIUS OF 151.57 FEET AND CENTRAL ANGLE OF 52°43'59"; THENCE N 46°38'59" W 60.00 FEET; THENCE 8.92 FEET ALONG THE ARC OF A CURVE TO THE RIGHT HAVING A RADIUS OF 197.99 FEET AND CENTRAL ANGLE OF 2°34'49"; THENCE N 89°50'28" E 5.42 FEET ALONG THE NORTH LINE OF KRUSE TERRACE TRACTS; THENCE LEAVING SAID NORTH LINE AND ALONG THE WEST LINE OF THAT LAND DESCRIBED AS PARCEL 2 PER M 78-22, N 0°28'55" W 136.54 FEET; THENCE SOUTHEASTERLY 111.19 FEET ALONG THE ARC OF A CURVE TO THE LEFT HAVING A RADIUS OF 137.99 FEET AND CENTRAL ANGLE OF 46°10'04"; THENCE S 46°38'59" E 54.08 FEET; THENCE N 89°50'28" E 28.34 FEET; THENCE, S 6°05'00" W 175.04 FEET TO THE POINT OF BEGINNING CONTAINING 0.23 AC M/L.

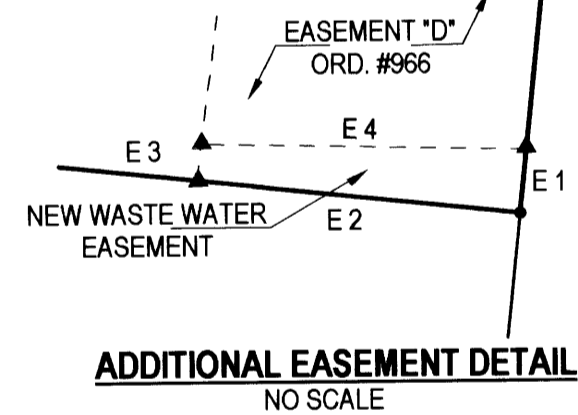

LINE INTERSECTION DETAIL NO SCALE

(LOT 1, VOL. 21, PAGE 27)

EASEMENT LINE TABLE

LINE	BEARING	DISTANCE
E 1	S 6°07'33"W	2.48'
E 2	N 83°55'00"W	12.89'
E 3	N 7°27'38"E	1.40'
E 4	S 88°44'00"E	12.90'

LINE	BEARING	DISTANCE
1	N 6°11'27"E (N 6°04'42"E)R2	30.05' (30.0')R2
2	S 83°55'00"E (S 88°44'00"E)	29.70' (30.0')
3	N 83°49'28" W (S 88°44'00"E)	29.91' (30.0')
4	N 53°48'40" W (N 53°44'40" W)R2	60.13' (60.12')R2
5	N 6°03'13"E (N 6°04'42"E)R2	63.95' (64.0')R2
6	S 88°40'36"E	26.90'

NARRATIVE:

THIS SURVEY WAS COMPLETED AT THE REQUEST OF THE OWNER SHOWN TO ESTABLISH THE BOUNDARY OF LOTS 1 - 6, 9 - 12 AND 17 - 20, KRUSE TERRACE TRACTS FOR THE PURPOSE OF A REPLAT, SAID LANDS DESCRIBED IN INSTR. #91-11757 AND #95-00061, DOUGLAS COUNTY, OREGON, DEEDS AND RECORDS. THE BASIS OF BEARING WAS HELD TO THE NORTH LINE OF LOT 1, VOL. 21, PAGE 27, DOUGLAS COUNTY, OREGON, PLAT RECORDS AND THE BOUNDARY WAS DETERMINED AS FOLLOWS: FIRST I HOLD POINT "A" & "B" AND DO DIST./DIST. INTERSECTION TO COMPUTE "C". THEN I COMPLETE A BEARING / BEARING INTERSECTION USING LINE "C" - "B" AND "D" - "E" TO DETERMINE "F". THIS FITS VERY WELL WITH THE POSITION OF "H" WHICH WAS COMPUTED BY HOLDING "G" AND INTERSECTING THE WEST LINE OF MYRTLE STREET PER PLAT BEARING WITH THE LINE "D" - "E". I THEN DETERMINE "K" PERPENDICULAR TO LINE "A" - "J" BEING ON THE CENTER OF VACATED WESTWOOD STREET PER CITY OF SUTHERLIN ORDINANCE #966 AS RECORDED IN INSTR. #2006-006513 OF SAID COUNTY RECORDS. THIS ESTABLISHED THE SOUTHERLY SOUTHEAST CORNER OF THE REPLAT LOT 1. POINT "L" WAS THEN ESTABLISHED ON THE EAST LINE OF VACATED WESTWOOD STREET PER DEED #04-008946 OF SAID COUNTY RECORDS BY PROPORTIONING AND POINT "N" THEN ESTABLISHED ON THE CENTER OF VACATED WESTWOOD STREET PERPENDICULAR TO THE WEST LINE OF LOT 1, VOL. 21, PAGE 27 BY INTERSECTION HOLDING THE CENTERLINE ESTABLISHED BY HOLDING "K" - "M". THE AREA OF DEDICATION FOR MYRTLE STREET WAS THEN ESTABLISHED AS APPROVED PER THE CITY OF SUTHERLIN, PLANNING COMMISSION AND AS DIRECTED BY THE OWNER.

FIELD CREW: J. SNOW, M. SCHMIDT, T. RUSHING
 EQUIPMENT USED: NIKON DTM-521 W/ SUPPORT
 MAPPING & CALC'S: C. SWEEDEN

LEGEND:

- o FOUND 5/8" I. ROD PER VOL. 9, PG. 6 (REC. 1/2") UNLESS NOTED OTHERWISE
- SET 5/8" X 30" IRON ROD W/ RED PLASTIC CAP "SWEEDEN LS 2752"
- ▲ COMPUTED POINT, NOTHING FOUND OR SET
- () RECORD PER KRUSE TERRACE, VOL. 9, PG. 6
- ()R1 RECORD PER M78-22
- ()R2 RECORD PER P.P. #2006-0044
- ()R3 RECORD PER RM 2-1

VOL. 21, PG. 27 EQUAL MEASURED UNLESS NOTED

WATER: CITY OF SUTHERLIN
 SEWER: CITY OF SUTHERLIN
 ZONING: C3
 COMP. PLAN: COMMUNITY COMMERCIAL

EGR & ASSOCIATES, INC.
 ENGINEERS AND SURVEYORS
 602 S. E. Parrott
 Roseburg, Oregon 97470 (541) 672-8344
 Fax (541) 672-1782