

**NOTE:**  
 SEE DETAIL A ON SHEET 2  
 FOR DETAIL OF THIS AREA.

- LEGEND**
- SET 5/8" x 30" IR w/CAP MARKED "I.E. ENGINEERING" UNLESS OTHERWISE NOTED
  - FOUND 5/8" IRON ROD UNLESS OTHERWISE NOTED
  - FOUND 1" IRON PIPE
  - △ CALCULATED POSITION
  - ( ) RECORD AS PER M137-34
  - [ ] RECORD AS PER INST. NO. 2002-0251

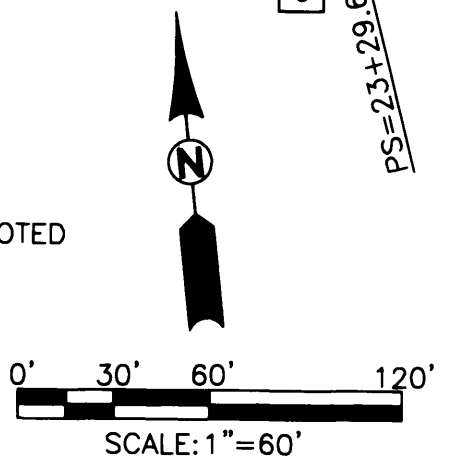

<p><b>REGISTERED PROFESSIONAL LAND SURVEYOR</b></p> <p><i>Jerry Lee Estabrook</i></p> <p><b>OREGON</b>        JUNE 30, 1995  <b>JERRY LEE ESTABROOK</b>        2703</p> <p>EXPIRES: 12/31/2003</p>	<p><b>GOLDEN EAGLE PARK SUBDIVISION</b>        LYING IN THE SE 1/4 OF SEC. 18 AND NE 1/4 OF SEC. 19,        T27S, R5W, W.M., DOUGLAS COUNTY, OREGON</p>	
	<p>SURVEYED FOR:        CITY OF ROSEBURG        900 SE DOUGLAS AVE.        ROSEBURG, OR 97470</p>	<p>SURVEYED BY:  <b>i.e.</b>        ENGINEERING        741 SE Jackson Street        Roseburg, Oregon 97470        PHONE (541) 673-0166        FAX (541) 440-9392        iemail@ieengineering.com</p>
<p>SCALE: AS SHOWN DATE: MARCH, 2003</p>		<p>DWG. BY: MLJ        JOB NO: 149-131        PAGE: 1 OF 3</p>