

SHADY OAK SUBDIVISION

LOCATED IN THE S.W 1/4 OF SECTION 17, T.26S., R.3W., W.M.

SURVEYOR'S CERTIFICATE:

I, KRISTIAN O. DEGROOT, BEING FIRST DULY SWORN, DEPOSE AND SAY THAT I HAVE CORRECTLY SURVEYED AND MARKED WITH PROPER MONUMENTS THE LANDS SHOWN ON THE ANNEXED PLAT OF WHICH THE FOLLOWING IS A TRUE AND CORRECT DESCRIPTION:
 BEGINNING AT A 5/8" IRON ROD FROM WHICH THE 1/4 CORNER COMMON TO SECTION 17 AND 20 OF TOWNSHIP 26 SOUTH, RANGE 3 WEST, WILLAMETTE MERIDIAN BEARS S 57°54'47" E, 1130.82 FEET; THENCE N 33°43'35" W, 75.00 FEET TO A 5/8" IRON ROD; THENCE S 56°16'25" W, 64.15 FEET TO A 5/8" IRON ROD; THENCE N 33°43'35" W, 349.66 FEET TO A 5/8" IRON ROD; THENCE N 1°39'00" W, 44.35 FEET TO A 5/8" IRON ROD; THENCE 18.25 FEET ALONG THE ARC OF A 25 FOOT RADIUS CURVE TO THE LEFT (THE LONG CHORD BEARS N 22°36'41" W, 17.84 FEET); THENCE N 43°31'11" W, 155.05 FEET TO A 5/8" IRON ROD; THENCE 53.75 FEET ALONG THE ARC OF A 256.48 FOOT RADIUS CURVE TO THE LEFT (THE LONG CHORD BEARS N 49°31'35" W, 53.65 FEET); THENCE N 55°40'34" W, 29.20 FEET TO A 5/8" IRON ROD, ON THE SOUTHERLY RIGHT-OF-WAY LINE OF STATE HIGHWAY NO. 138; THENCE N 55°18'50" E, ALONG SAID SOUTHERLY RIGHT-OF-WAY LINE, 127.40 FEET TO A 5/8" IRON ROD; THENCE S 48°58'37" E, 62.19 FEET TO A 5/8" IRON ROD; THENCE S 68°13'12" E, 86.47 FEET TO A 5/8" IRON ROD; THENCE S 79°51'25" E, 164.17 FEET TO A 5/8" IRON ROD; THENCE S 75°17'43" E, 114.73 FEET TO A 5/8" IRON ROD; THENCE N 75°33'57" E, 92.17 FEET TO A 5/8" IRON ROD; THENCE N 55°58'29" E, 170.41 FEET TO A 5/8" IRON ROD; THENCE S 31°46'34" E, 8.50 FEET TO A 1/2" IRON ROD; THENCE S 42°19'33" W, 78.23 FEET TO A 1/2" IRON ROD; THENCE S 16°29'48" W, 40.02 FEET TO A 5/8" IRON ROD; THENCE S 23°25'24" E, 137.63 FEET TO A 1/2" IRON ROD; THENCE S 11°32'58" E, 165.33 FEET TO A 5/8" IRON ROD; THENCE S 35°28'22" E, 146.26 FEET TO A 5/8" IRON ROD; THENCE S 76°28'56" W, 390.00 FEET TO THE POINT OF BEGINNING, ALL BEING LOCATED IN THE SW 1/4 OF SECTION 17, T26S., R3W., W.M., DOUGLAS COUNTY, OREGON, AND CONTAINING 6.24 ACRES MORE OR LESS.

DEDICATION:

KNOW ALL MEN BY THESE PRESENT THAT ESTON AND EVELYN DUMONT, DARRELL AND ROSELLA DOTY AND DOREE BAUGHMAN ARE THE OWNERS OF THE LAND REPRESENTED ON THE ANNEXED PLAT AND MORE PARTICULARLY DESCRIBED IN THE ACCOMPANYING SURVEYOR'S CERTIFICATE AND HAVE CAUSED THE SAME TO BE SURVEYED AND PLATTED IN THE NAME OF 'SHADY OAK SUBDIVISION' AND DO HEREBY DEDICATE THE STREET AND THE ROADWAY AND UTILITY EASEMENTS SHOWN THEREON TO THE USE OF THE PUBLIC FOREVER.

Eston Dumont
ESTON DUMONT

Evelyn Dumont
EVELYN DUMONT

Darrell Doty
DARRELL DOTY

Rosella Doty
ROSELLA DOTY

Doree Baughman
DOREE BAUGHMAN

Notary Seal
NOTARY PUBLIC
STATE OF OREGON
COMMISSION NO. 93251
EXPIRES 12-31-95

APPROVALS:

Keith J. Cubic 2/11/94
PLANNING DIRECTOR DATE
Jerry E. Womack 2-16-94
COUNTY SURVEYOR DEPUTY DATE
Mario J. Reddekopp 3-01-94
COUNTY ASSESSOR DATE

TAX COLLECTOR CERTIFICATE:
I HEREBY CERTIFY THAT ALL TAXES AND SPECIAL ASSESSMENTS OR OTHER CHARGES REQUIRED BY LAW HAVE BEEN PAID.

Anne E. Schroeder 3-1-94
DOUGLAS COUNTY TAX COLLECTOR DATE



FILED THIS 2nd DAY OF March 1994
IN VOLUME 18 PAGE 11
GAY FIELDS, County Clerk
by Carol Engle, Deputy
COUNTY CLERK

BY THE ORDER OF THE BOARD OF COMMISSIONERS:
Doug Robinson 3-2-94
CHAIRPERSON DATE
John Morgan 3-2-94
COMMISSIONER DATE
Gene Wadsworth 3-2-94
COMMISSIONER DATE

Kristian O. DeGroot
KRISTIAN O. DEGROOT
REGISTERED LAND SURVEYOR, 1941

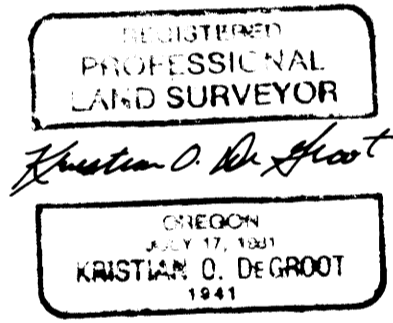

EXPIRES: 12-31-95

SUBSCRIBED AND SWORN TO BEFORE ME THIS 12th DAY OF February, 1994.

NOTARY PUBLIC, STATE OF OREGON

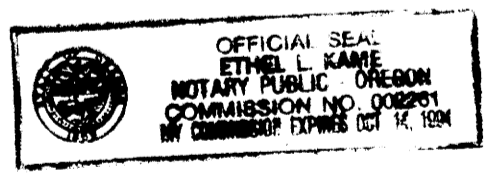

NARRATIVE:

THE PURPOSE OF THIS SURVEY WAS TO CREATE A 9 LOT RESIDENTIAL SUBDIVISION OF THAT PROPERTY AS DESCRIBED IN INST. NO. 90-17133, INST. NO. 93-24694 AND ON A PORTION OF INST. NO. 86-00139. MONUMENTS FOUND PER M50-78 AND M51-3 CONTROLLED THE WESTERLY AND SOUTHERLY BOUNDARY. THE EASTERLY BOUNDARY AND THE BOUNDARY OF LOT 9 WERE CONTROLLED BY FOUND MONUMENTS PER M50-78 AND M77-25. THE NORTHERLY BOUNDARY WAS CONTROLLED BY MONUMENTS FOUND PER M114-31. THE SOUTHERLY RIGHT-OF-WAY LINE OF OR 138 WAS CONTROLLED BY A FOUND RIGHT-OF-WAY MONUMENT (910+00, 60' RIGHT) AND A MONUMENT PER M99-73. THIS SURVEY WAS PERFORMED BY KRIS DEGROOT, LES FANNING, MATT DISON AND STEVE BRAZIL USING A SOKKIA SET 3C, SET 4A AND SET 5 TOTAL STATION, WITH COMPUTATIONS BY GLENN BAUGHMAN, KRIS DEGROOT AND BILL WARREN AND DRAFTING BY BILL WARREN.

ACKNOWLEDGEMENT:

STATE OF OREGON)
COUNTY OF DOUGLAS) ss
KNOW ALL PEOPLE BY THESE PRESENTS, ON THIS 22nd DAY OF February 1994, BEFORE ME, A NOTARY PUBLIC IN AND FOR SAID STATE AND COUNTY, PERSONALLY APPEARED ESTON DUMONT, EVELYN DUMONT, DARRELL DOTY, ROSELLA DOTY AND DOREE BAUGHMAN, TO ME KNOWN TO BE THE PERSONS DESCRIBED IN AND WHO EXECUTED THE FOREGOING DEDICATION, WHO BEING DULY SWORN, DID SAY THAT THEY EXECUTED THE SAME FOR THE PURPOSES SET FORTH THEREIN.
IN TESTIMONY WHEREOF, I HAVE HEREUNTO SET MY HAND AND AFFIXED MY OFFICIAL SEAL THIS DAY AND YEAR FIRST ABOVE WRITTEN.

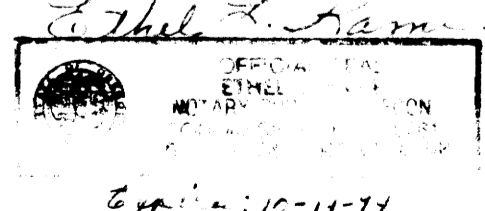

NOTE:
THERE ARE NO APPURTENANT WATER RIGHTS OF RECORD ON THIS PARCEL

94-05370

COUNTY SURVEYORS FILE DATA
DO NOT REMOVE FROM OFFICE

VOL. 18 PAGE 11A

VOL. 18 PAGE 11A