

Duncan's First Addition to Yoncalla

in Lot 2, Block 2, "DeVore's Addition to Yoncalla,"
 lying in NE 1/4, Section 4, T23S, R5W, W.M.
 and in George A. Burts D.L.C. No. 40
 and in Government Lot 3

CERTIFICATE OF SURVEYOR

I, Donald A Bentz, being first duly sworn, depose and say that I have correctly surveyed and marked with proper monuments the land shown on the annexed plat of which the following is a true and correct description:

A parcel of land lying in Section 4 Township 23 South, Range 5 West, Willamette Meridian and being a portion of Lot 2, Block 2, "DEVORE'S ADDITION TO YONCALLA" as recorded in Volume 3, Page 38 in the Plat Records of Douglas County, Oregon said parcel also being a portion of that property described in Instrument No. 80-07786 in the Deed Records of Douglas County, Oregon, said parcel being more particularly described as follows:

Beginning at a 2 1/2" x 30" galvanized iron pipe in the Westerly right-of-way line of Williams Road, said point being the Northeast Corner of the above said Lot 2, Block 2; thence along said Westerly Line S17°49'02"E 297.13 feet to a 5/8" iron rod, said point being the Southeast Corner of said Lot 2, Block 2; thence leaving said Westerly Line and running along the North Lines of those properties described in Instrument Nos. 70-10537 and 76-11194 as recorded in the Deed Records of Douglas County, Oregon, respectively, N89°07'51"W 714.30 feet to a 5/8" iron rod; thence leaving said North Line and running N0°52'09"E 166.98 feet to a 5/8" iron rod; thence N89°07'51"W 20.99 feet to a 5/8" iron rod; thence N0°54'55"E 115.00 feet to a 5/8" iron rod in the South Line of that property described in Instrument No. 75-14484 as recorded in the Deed Records of Douglas County, Oregon; thence along said South Line S89°05'05"E 640.00 feet to the point of beginning and containing 4.37 acres of land, more or less.

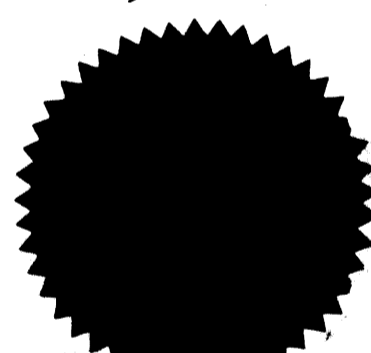
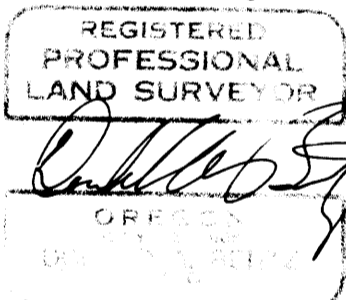

Donald A. Bentz
 Donald A. Bentz
 Registered Land Surveyor
 839

subscribed and sworn before me this 2nd day of July, 1980
 my commission expires on the 12th day of July, 1981

Virginia A. Lungen
 Notary Public, State of Oregon

DEDICATION

& Andrew F. & Emil I. Gurtright,

Know all men by these present that DUNCAN FAMILY CORPORATION, the owner of the lands shown on the annexed plat have caused the same to be surveyed and platted by the name of "DUNCAN'S 1ST ADDITION TO YONCALLA" and do hereby dedicate to the public use forever, the streets shown hereon.

Margaret Duncan
 Margaret Duncan,
 Chairman of the Board

Aileen Pettit
 Aileen Pettit,
 Secretary - Treasurer

Andrew F. Gurtright
 Andrew F. Gurtright

Emil I. Gurtright
 Emil I. Gurtright

CORPORATE ACKNOWLEDGEMENT

State of Oregon }
 County of Douglas } ss

Andrew F. & Emil I. Gurtright,

On this 11 day of August, 1980 before me appeared Margaret Duncan, Aileen Pettit, Chairman of the Board and Secretary - Treasurer respectively of Duncan Family Corporation, all to me personally known, who being duly sworn, do say that they hold the aforesaid offices in the Corporation hereunto mentioned and that the instrument was signed and sealed in behalf of said Corporation, by the authority of the Board of Directors and further acknowledge said instrument to be the free act and deed of said Corporation.

Subscribed and sworn to before me this 11 day of August, 1980
Notary Public, State of Oregon
 3-2-82

APPROVALS

By order of Douglas County Commissioners:

- | | | | |
|-----------------------|---------------------------|-------|------|
| Chairman | <i>Bill Vian</i> | 9-24- | 1980 |
| Commissioner | <i>Paul J. Makinen</i> | 9-24- | 1980 |
| Commissioner | <i>Wray</i> | | 1980 |
| County Health Officer | <i>Elizabeth B. Young</i> | 9-24- | 1980 |
| County Surveyor | <i>Francis L. Lungen</i> | 9-5- | 1980 |
| County Assessor | <i>George Marsh</i> | 9-23 | 1980 |
| City of Yoncalla: | | | |
| Planning Commission | | | 1980 |

BHW Engineering & Surveying
 1205 S.E. Court
 Roseburg, Oregon 97470
 673-0165

Filed Oct 8, 1980
Loris L. Wadsworth
 County Clerk

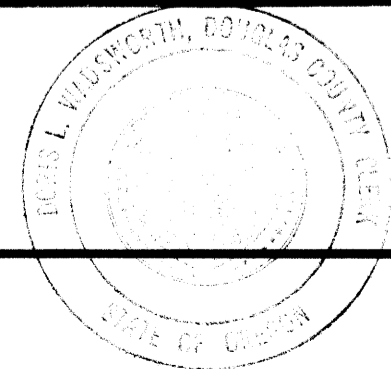

VOL. 16 PG. 51 A

VOL. 16 PG. 51 A