

WEST BRAE

A subdivision in Sec. 1, T. 27S., R. 6W., W.M.

Certificate of Surveyor

I, Romanso E. Ware, being first duly sworn, depose and say that I have correctly surveyed and marked with proper monuments the lands shown on the annexed plat of which the following is a true and correct description:

Beginning at the Initial Point, a 2" x 36" galvanized iron pipe set 6" below the surface of the ground from which the W 1/4 Cor. Sec. 1, T27S, R6W, W.M. bears S62°38'02"W 1218.02 feet; thence running NO°25'53"E 968.02 feet; thence N89°51'44"E 650.26 feet to the westerly right-of-way line of Interstate 5 Freeway; thence along the said westerly right-of-way line N89°51'44"E 75.00 feet, along a spiral curve to the left (the long chord of which bears S2°06'W 68.26 feet) 68.26 feet to a point opposite and 125 feet from engineers centerline station 2402+1815 P.T., S2°04'15"W 1077.66 feet; thence leaving the westerly right-of-way line of Interstate 5 Freeway N89°56'18"W 288.35 feet; thence N89°54'50"W 30.00 feet; thence NO°00'45"E 174.94 feet; thence N89°58'37"W 372.85 feet to the point of beginning and containing 17.11 acres of land, more or less.

Romanso E. Ware
Romanso E. Ware

Subscribed and sworn before me this 3 day of January, 1980
My commission expires on the 12th day of July, 1981

Virginia A. Ferguson
Notary Public, State of Oregon

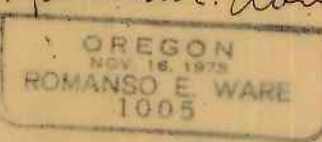
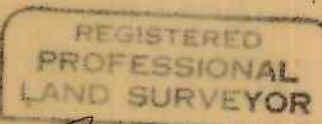

Dedication

Know all men by these presents that we, Frank E. Guido, Nina N. Guido, Jeffrey G. Guido, Deryle J. Towner, Gayle L. Towner, Stephen D. Guido, Susan J. Gomes, Kelly J. Guido and Patrick F. Guido, are the owners of the lands shown on the annexed plat; that we have caused the same to be surveyed and platted by the name of "WEST BRAE" and that we do hereby dedicate to the use of the public forever the streets and easements shown thereon.

<u>Frank E. Guido</u> Frank E. Guido	<u>Nina N. Guido</u> Nina N. Guido	<u>Jeffrey G. Guido</u> Jeffrey G. Guido
<u>Deryle J. Towner</u> Deryle J. Towner	<u>Gayle L. Towner</u> Gayle L. Towner	<u>Stephen D. Guido</u> Stephen D. Guido
<u>Susan J. Gomes</u> Susan J. Gomes	<u>Kelly J. Guido</u> Kelly J. Guido	<u>Patrick F. Guido</u> Patrick F. Guido

Acknowledgement

State of Oregon }
County of Douglas } ss
On the 21st day of November, 1979 before me appeared Frank E. Guido, Nina N. Guido, Jeffrey G. Guido, Deryle J. Towner, Gayle L. Towner, Stephen D. Guido, Susan J. Gomes, Kelly J. Guido and Patrick F. Guido, to me personally known, and being duly sworn, did say that they are the lawful owners of the tract of land shown on the annexed plat and they do hereby acknowledge that they signed the accompanying dedication as their free and voluntary act and deed.

In testimony whereof I have hereunto set my hand and affixed my official seal the day and year above written.

Helen P. Scott
Notary Public, State of Oregon
My commission expires October 4, 1981

Approvals

By order of Douglas County Commissioners:

<u>Bill Vian</u> Chairman	<u>1-7</u> , 19 <u>80</u>
<u>John</u> Commissioner	<u>Jan 7</u> , 19 <u>80</u>
<u>Paul Matheson</u> Commissioner	<u>Jan 7</u> , 19 <u>80</u>
<u>Elinor B. Young</u> County Health Officer	<u>Jan. 8</u> , 19 <u>80</u>
<u>Francis L. Ingram</u> County Surveyor	<u>JAN 4</u> , 19 <u>80</u>
<u>Long Maud</u> County Assessor	<u>Jan 4</u> , 19 <u>80</u>

County Planning Commission:

<u>Jayne Morgan</u> President	<u>12-20</u> , 19 <u>79</u>
<u>B. Thomason</u> Secretary	<u>12-20</u> , 19 <u>79</u>

STATE OF OREGON)
COUNTY OF DOUGLAS) ss

I, Romanso E. Ware, being first duly sworn, depose and say that I am the surveyor who surveyed and prepared the final plat of "WEST BRAE", and that the foregoing tracing is an exact copy of the plat of the said "WEST BRAE".

Romanso E. Ware
Romanso E. Ware
Registered Oregon Land Surveyor

Subscribed and sworn before me this 3 day of January, 1980.
My commission expires on the 12th day of July, 1981.

Virginia A. Ferguson
Notary Public, State of Oregon

STATE OF OREGON)
COUNTY OF DOUGLAS) ss

I, Doris L. Wadsworth, County Clerk of Douglas County, Oregon do hereby certify that the within copy of plat has been by me compared with the original thereof and that it is an exact copy of the whole thereof as the same appears on file in my office and custody.

Witness my hand and official seal this 8th day of Jan, 1980

Doris L. Wadsworth
County Clerk by Mary L. Seal, Deputy

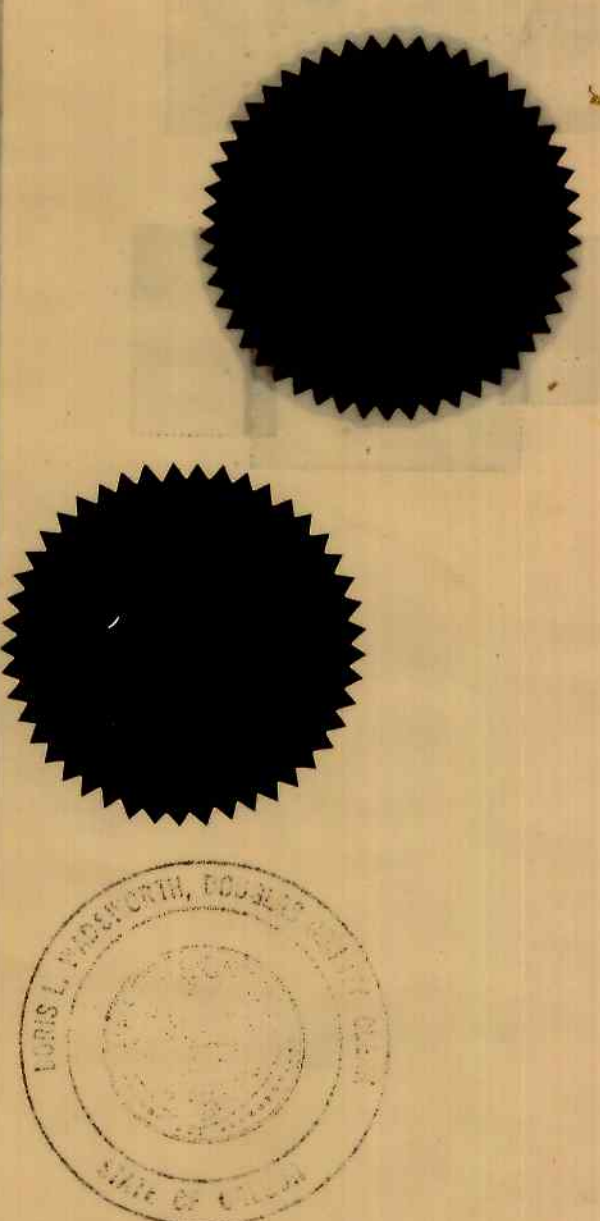

BHW Engineering & Surveying
1205 S.E. Court
Roseburg, Oregon 97470
673-0165

Filed Jan 8, 1980
Doris L. Wadsworth
County Clerk by Mary L. Seal, Deputy

VOL. 16 PG. 42B

VOL. 16 PG. 42B