

APPROVALS
BY ORDER OF THE COUNTY COURT
APPROVED Aug 29 1955
Cl Hill
COUNTY JUDGE
E. R. Metzger
COMMISSIONER

BY ORDER OF COUNTY PLANNING COMMISSION
APPROVED Aug 25 1955
O. J. Flett
PRESIDENT
R. H. Franks
SECRETARY

APPROVED Aug 27 1955 APPROVED August 22 1955
Norman C. Bowker COUNTY ASSESSOR Robert P. Shumy COUNTY SURVEYOR

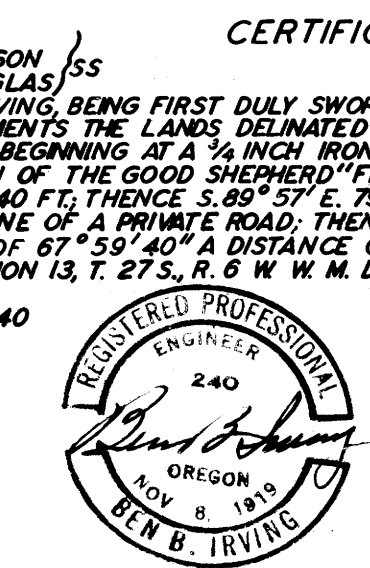

CERTIFICATE OF SURVEYOR

STATE OF OREGON }
COUNTY OF DOUGLAS }
I, BEN B. IRVING, BEING FIRST DULY SWORN, DEPOSE AND SAY THAT I HAVE CORRECTLY SURVEYED AND MARKED WITH PROPER MONUMENTS THE LANDS DELINEATED ON THE ANNEXED PLAT OF WHICH THE FOLLOWING IS A TRUE AND CORRECT DESCRIPTION: BEGINNING AT A 3/4 INCH IRON ROD SET FOR THE NORTH WEST CORNER OF THE INFANT AND YOUTH SECTION OF THE "GARDEN OF THE GOOD SHEPHERD" FROM WHICH THE NORTH WEST CORNER OF THE J. HUNTLEY D.L.C. NO. 56 BEARS N 6° 30' 40" W 1712.40 FT; THENCE S. 89° 57' E. 79.26 FT. TO A ONE INCH IRON PIPE; THENCE S. 00° 01' W 155.74 FT. TO A 3/4 INCH IRON ROD IN THE NORTH LINE OF A PRIVATE ROAD; THENCE ALONG THE ARC OF A CURVE TO THE RIGHT WITH A RADIUS OF 155.93 FT. THROUGH AN ANGLE OF 67° 59' 40" A DISTANCE OF 185.05 FT. TO A 3/4 INCH IRON ROD; THENCE N. 6° 59' E 0.5 FT. TO THE POINT OF BEGINNING. IN SECTION 13, T. 27 S., R. 6 W. W. M. DOUGLAS COUNTY, OREGON.

OREGON No 240
NOV. 8, 1919

Ben B. Irving
BEN B. IRVING
REG. PROF. ENGINEER

SUBSCRIBED AND SWORN TO BEFORE ME THIS 27 DAY OF August 1955

NOTE:- THIS AMENDED PLAT IS FILED TO CORRECT THE DIRECTION OF THE GRAVES IN THE INFANT SECTION OF THE ORIGINAL PLAT, AND SUPERCEDES THE ORIGINAL PLAT AS FILED IN VOL. 11, PAGE 14 OF PLAT RECORDS OF DOUGLAS COUNTY, OREGON.

Chas Doerner
COUNTY CLERK

KNOW ALL MEN BY THESE PRESENTS THAT THE ROSEBURG MEMORIAL GARDENS INCORPORATED AN OREGON CORPORATION OWNERS OF THE LANDS REPRESENTED AND DESCRIBED ON THE ANNEXED PLAT HAVE CAUSED THE SAME TO BE SURVEYED AND PLATTED BY THE NAME OF "AMENDED PLAT OF INFANT AND YOUTH SECTION OF THE GARDEN OF THE GOOD SHEPHERD" AND HEREBY DEDICATE, AS ON THE ORIGINAL PLAT OF SAID INFANT AND YOUTH SECTION OF THE GARDEN OF THE GOOD SHEPHERD, ALL STREETS, WALKS AND MEMORIALS TO THE LOT OWNERS FOREVER.
IN TESTIMONY WHEREOF THE ROSEBURG MEMORIAL GARDENS INCORPORATED HAS CAUSED THESE PRESENTS TO BE SIGNED BY ITS PRESIDENT THIS 22 DAY OF AUGUST 1955.

Robert A. Dudley
ROBERT A. DUDLEY, PRESIDENT
ROSEBURG MEMORIAL GARDENS, INCORPORATED

STATE OF OREGON }
COUNTY OF DOUGLAS }
ON THIS 22 DAY OF August 1955, BEFORE ME APPEARED ROBERT A. DUDLEY, PRESIDENT OF THE ROSEBURG MEMORIAL GARDENS INCORPORATED, TO ME PERSONALLY KNOWN WHO BEING DULY SWORN DID SAY THAT SAID CORPORATION IS THE LAWFUL OWNER OF THE TRACT OF LAND DELINEATED ON THE ANNEXED PLAT, AND THAT HE SIGNED THE ACCOMPANYING DEDICATION AS HIS FREE AND VOLUNTARY ACT AND DEED FOR THE SAID CORPORATION.
IN TESTIMONY WHEREOF I HAVE HEREUNTO SET MY HAND AND AFFIXED MY OFFICIAL SEAL THIS DAY AND YEAR FIRST ABOVE WRITTEN.

Opal Callahan
NOTARY PUBLIC FOR OREGON
Comm. expires - Nov. 7, 1958

AMENDED PLAT OF
INFANT AND YOUTH SECTION
OF THE
GARDEN OF THE
GOOD SHEPHERD

BEN B. IRVING, REG. PROF. ENGINEER

ROSEBURG OREGON SCALE - 1" = 10'

FILED September 16 1955

Chas Doerner
COUNTY CLERK

STATE OF OREGON }
COUNTY OF DOUGLAS }
I, CHAS DOERNER COUNTY CLERK OF DOUGLAS COUNTY OREGON DO HEREBY CERTIFY THAT THE WITHIN COPY OF PLAT HAS BEEN BY ME COMPARED WITH THE ORIGINAL THEREOF AND THAT IT IS AN EXACT COPY OF THE WHOLE THEREOF AS THE SAME APPEARS ON FILE IN MY OFFICE AND CUSTODY.
WITNESS MY HAND AND OFFICIAL SEAL THIS 16 DAY OF September 1955

Chas Doerner
COUNTY CLERK

STATE OF OREGON }
COUNTY OF DOUGLAS }
I, BEN B. IRVING, BEING FIRST SWORN, DEPOSE AND SAY UPON OATH, THAT I AM THE SURVEYOR WHO MADE THE SURVEY AND PREPARED THE FINAL MAP OF "AMENDED PLAT OF INFANT AND YOUTH SECTION OF THE GARDEN OF THE GOOD SHEPHERD" AND THAT THE FOREGOING TRACING IS AN EXACT COPY OF THE MAP OF SAID "AMENDED PLAT OF INFANT AND YOUTH SECTION OF THE GARDEN OF THE GOOD SHEPHERD."

Ben B. Irving

SUBSCRIBED AND SWORN TO BEFORE ME THIS 27 DAY OF August 1955

Chas Doerner
COUNTY CLERK

BEARINGS ARE BASED ON THE LONG CHORD S 62° 43' 20" W AS SHOWN ON THE SOUTH LINE OF "GARDEN OF MEDITATION"