

# HALL AND HAMLIN TRACT MYRTLE CREEK

JOHN HALL  
AND  
JOHN L. HAMLIN } PROPRIETORS

D. W. RANSAM, SURVEYOR

SIZE OF LOTS  
50 X 100 FT.  
SIZE OF BLKS  
200 X 200 FT

FOR ORIGINAL PLAT SEE VOL. 4, PAGE 502 DEED RECORDS RECORDED MAY 17, 1869 (SGD) M. M. MELVIN, CO. CLERK

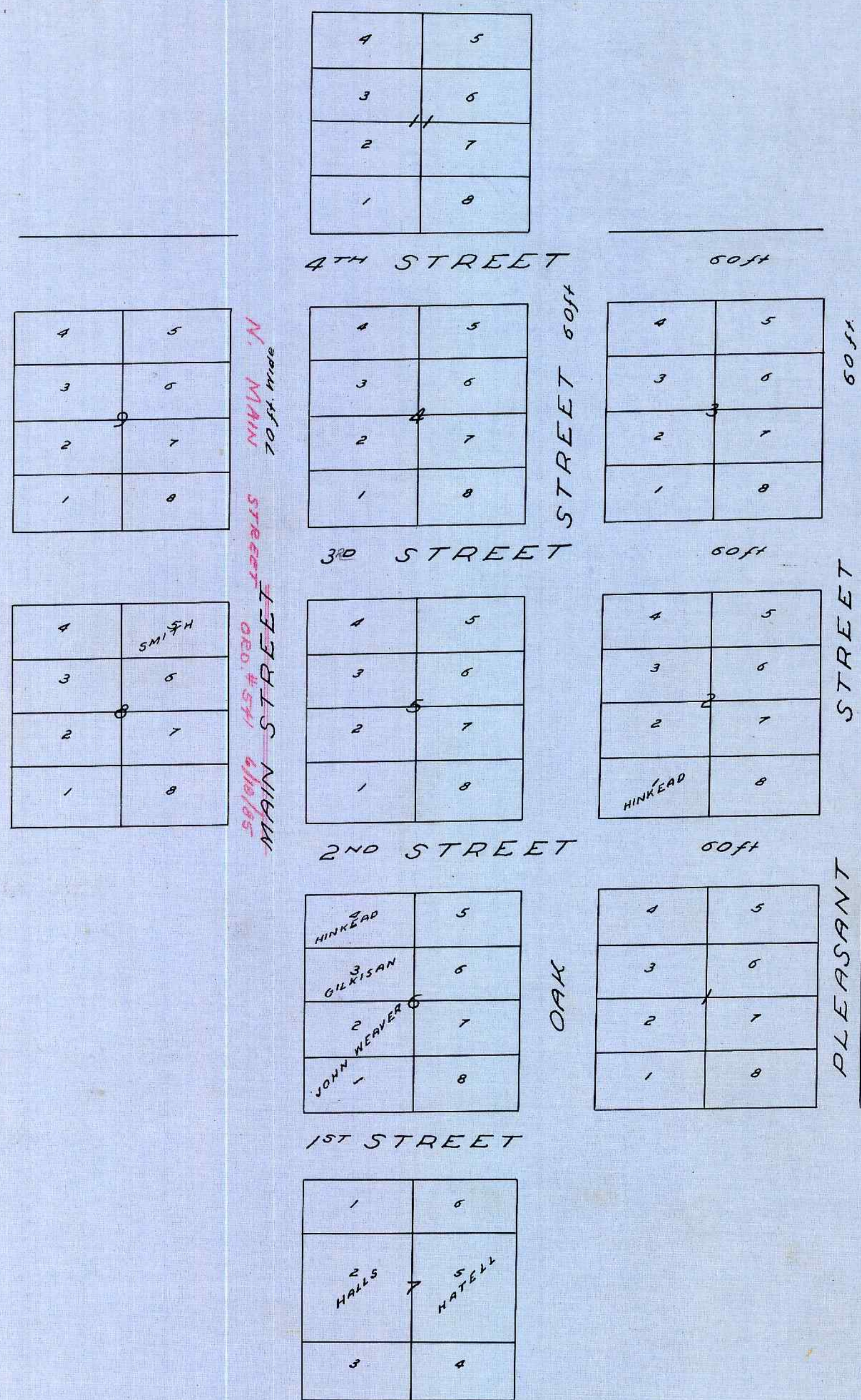
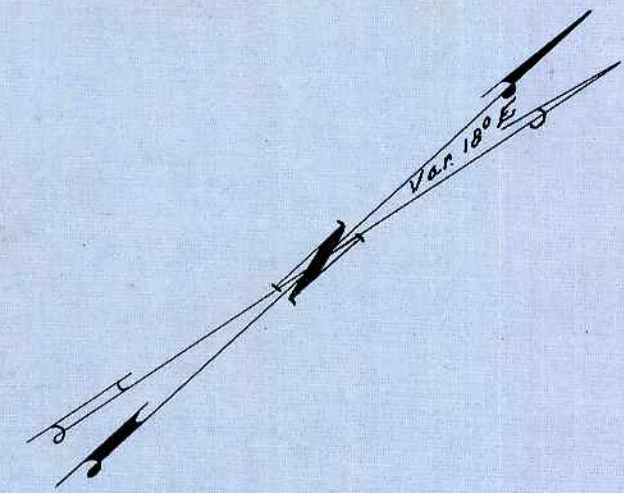

STATE OF OREGON }  
COUNTY OF DOUGLAS } ss  
I, BEN B. IRVING, COUNTY SURVEYOR OF DOUGLAS COUNTY OREGON DO HEREBY CERTIFY THAT THIS COPY OF "HALL AND HAMLIN TRACT" IS A TRUE AND CORRECT COPY OF THE ORIGINAL PLAT AS FILED IN THE OFFICE OF THE COUNTY CLERK AND IS MADE IN COMPLIANCE WITH CHAPTER 92 OREGON LAWS 1953 SEC. 92-130.

*Ben B. Irving*  
COUNTY SURVEYOR

SUBSCRIBED AND SWORN TO BEFORE ME THIS 15<sup>th</sup> DAY OF December 1955.

*Chas Doerner*  
COUNTY CLERK

STATE OF OREGON }  
COUNTY OF DOUGLAS } ss  
I, CHAS DOERNER, COUNTY CLERK OF DOUGLAS OREGON DO HEREBY CERTIFY THAT THE FOREGOING COPY OF PLAT HAS BEEN BY ME COMPARED WITH THE ORIGINAL THEREOF THAT IT IS A TRUE AND CORRECT COPY THEREFROM AND OF THE WHOLE THEREOF AS THE SAME APPEARS ON FILE IN MY OFFICE AND CUSTODY.  
WITNESS MY HAND AND OFFICIAL SEAL THIS 15<sup>th</sup> DAY OF December 1955.

*Chas Doerner*  
COUNTY CLERK