

CEMETERY GROUNDS OF PHILETARIAN LODGE N° 8  
I. O. O. F. ROSEBURG DOUGLAS COUNTY OREGON  
SURVEYED DEC. 1878 BY S. S. WILLIAMS SURVEYOR

STATE OF OREGON }  
COUNTY OF DOUGLAS } ss  
I, BEN B. IRVING, COUNTY SURVEYOR OF DOUGLAS COUNTY OREGON  
DO HEREBY CERTIFY THAT THIS COPY OF "PHILETARIAN LODGE NO. 8 I.  
O. O. F. CEMETERY," IS A TRUE AND CORRECT COPY OF THE ORIGINAL  
PLAT AS FILED IN THE OFFICE OF THE COUNTY CLERK AND IS MADE  
IN COMPLIANCE WITH CHAPTER 92 OREGON LAWS 1953, SEC. 92-130.

*Ben B. Irving*  
COUNTY SURVEYOR

SUBSCRIBED AND SWORN TO BEFORE ME THIS 2nd DAY OF  
December 1954.

*Chas Doerner*  
COUNTY CLERK

FILED & RECORDED OCT. 16, 1895  
(S.G.D.) F. W. BENSON, CO. CLERK

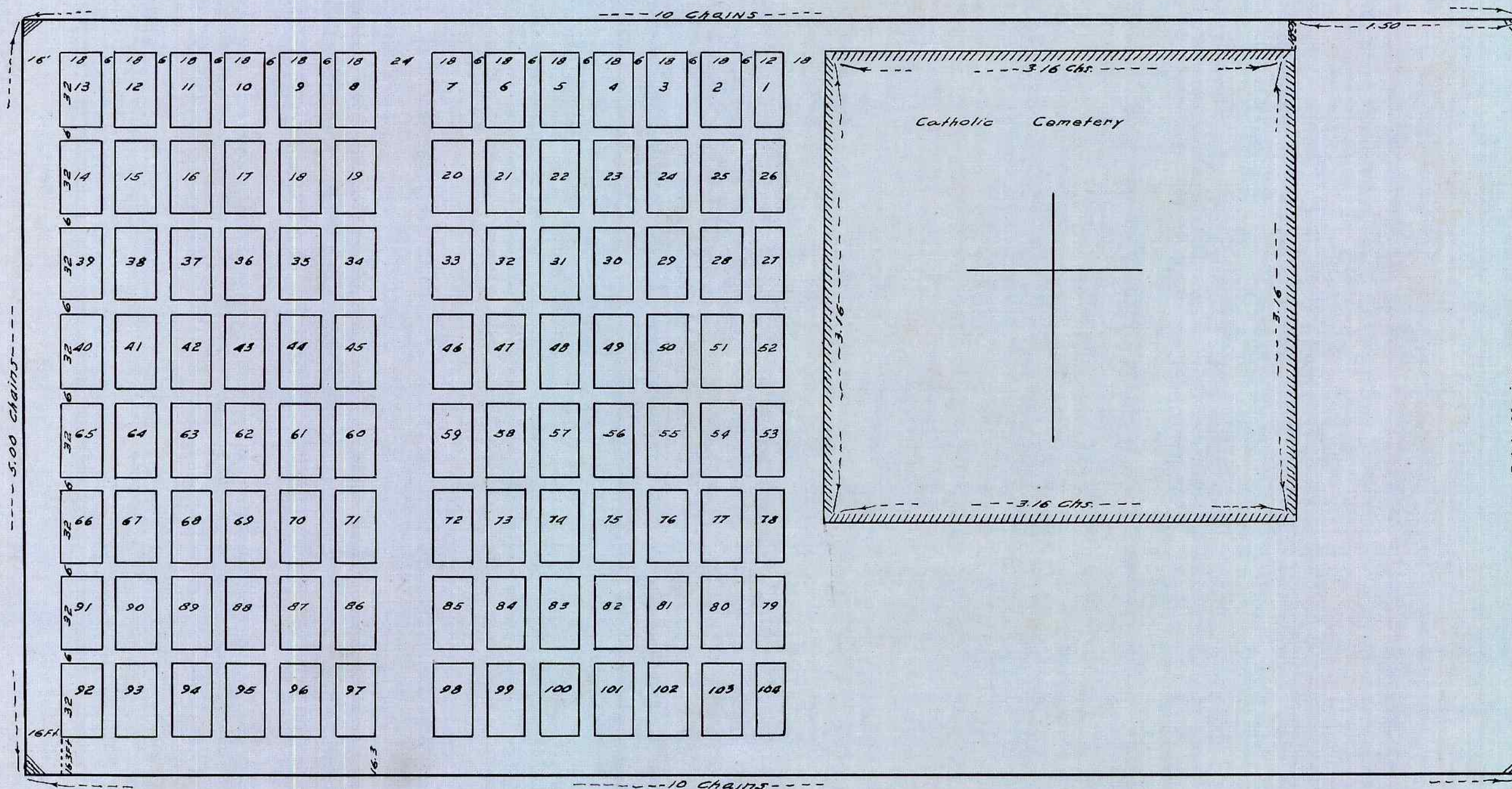

STATE OF OREGON }  
COUNTY OF DOUGLAS } ss  
I, CHAS. DOERNER, COUNTY CLERK OF DOUGLAS COUNTY  
OREGON DO HEREBY CERTIFY THAT THE FOREGOING COPY OF PLAT HAS  
BEEN BY ME COMPARED WITH THE ORIGINAL THEREOF THAT IT IS A  
TRUE AND CORRECT COPY THEREFROM AND OF THE WHOLE THEREOF  
AS THE SAME APPEARS ON FILE IN MY OFFICE AND CUSTODY.  
WITNESS MY HAND AND OFFICIAL SEAL THIS 2nd  
DAY OF December 1954.

*Chas Doerner*  
COUNTY CLERK

Donation Claim of Thomas Stephens T. 27 S. R. 5 W. Oregon