

UMPQUA LODGE NO. 37 I. O. O. F. CEMETERY OAKLAND OREGON

THE ODD FELLOWS CEMETERY OF OAKLAND OR. IS LOCATED ON THE NORTH BOUNDARY OF THE REASON REED DONATION LAND CLAIM AND IS DESCRIBED AS FOLLOWS, BEGINNING AT A POINT ON THE NORTH BOUNDARY OF SAID DONATION LAND CLAIM 8.56 CHS SOUTH AND 7.38 CHS. WEST OF THE QUARTER SECTION CORNER BETWEEN SECTIONS 4 AND 5 AND FROM WHICH A WHITE OAK 5 INCHES IN DIAMETER AND MARKED B. T. BEARS N. 84° E. THREE LINKS DISTANT AND A WHITE OAK 7 INCHES IN DIAMETER AND MARKED B. T. BEARS S. 65° W. THIRTEEN LINKS DISTANT. RUNNING THENCE AT RIGHT ANGLES TO SAID NORTH BOUNDARY NAMED N. 12° WEST 6.32 CHS.; THENCE PARALLEL TO SAID NORTH BOUNDARY S. 78° W. 9.48 CHS.; THENCE AT RIGHT ANGLES S. 12° E. 6.32 CHS. THENCE ALONG SAID WEST BOUNDARY N. 78° E. 9.48 CHS. TO THE PLACE OF BEGINNING. ALL BEING IN SECTION 5 T. 25. SOUTH OF RANGE 5 WEST, WILLAMETTE MERIDIAN IN DOUGLAS COUNTY OREGON, AND CONTAINING SIX ACRES. THE CEMETERY IS DIVIDED BY AVENUES AND STREETS INTO BLOCKS WHICH ARE NUMBERED CONSECUTIVELY FROM 1 UPWARDS. THE BLOCKS ARE SUBDIVIDED BY ALLEYS INTO LOTS, HALF LOTS AND QUARTER LOTS WHICH ALSO ARE NUMBERED CONSECUTIVELY FROM 1 UPWARDS. THE LOTS ARE TWENTY FEET SQUARE, THE HALF LOTS ARE TEN BY TWENTY FEET AND THE QUARTER LOTS ARE FIVE BY TWENTY FEET. THE AVENUES NAMED "CENTRAL", "EASTERN" AND "WESTERN" ARE EACH THIRTY FEET WIDE, THE STREETS NAMED FIRST AND SECOND ARE EACH TWENTY FEET WIDE AND THE STREETS NAMED "A", "B" AND "C" ARE EACH FIFTEEN FEET WIDE. "A" STREET RUNS AROUND AND ADJOINING THE FENCE INCLOSING THE CEMETERY. ALL ALLEYS ARE FIVE FEET WIDE. ALL OF THE LAND INCLUDED BETWEEN FIRST AND SECOND STS. ARE RUNNING THROUGH THE LOT FROM SOUTH TO NORTH IS RESERVED FOR THE USE AND BENEFIT OF THE MEMBERS OF UMPQUA LODGE NO. 37 I. O. O. F. AND OTHER ODD FELLOWS. THE REMAINDER TO BE DISPOSED OF AT PRIVATE SALE.

RECORDED MARCH 1, 1894. _____ CO. CLERK.

STATE OF OREGON }
COUNTY OF DOUGLAS } ss
I, BEN B. IRVING, COUNTY SURVEYOR OF DOUGLAS COUNTY OREGON DO HEREBY CERTIFY THAT THIS COPY OF UMPQUA LODGE NO. 37 I. O. O. F. CEMETERY, IS A TRUE AND CORRECT COPY OF THE ORIGINAL PLAT AS FILED IN THE OFFICE OF THE COUNTY CLERK, AND IS MADE IN COMPLIANCE WITH CHAPTER 92, OREGON LAWS, 1953. SEC. 92-130.

Ben B. Irving
COUNTY SURVEYOR

SUBSCRIBED AND SWORN TO BEFORE ME THIS 13th DAY OF December, 1954.

Chas Doerner
COUNTY CLERK

STATE OF OREGON }
COUNTY OF DOUGLAS } ss
I, CHAS. DOERNER, COUNTY CLERK OF DOUGLAS COUNTY OREGON DO HEREBY CERTIFY THAT THE FOREGOING COPY OF PLAT HAS BEEN BY ME COMPARED WITH THE ORIGINAL THEREOF THAT IT IS A TRUE AND CORRECT COPY THEREFROM AND OF THE WHOLE THEREOF AS THE SAME APPEARS ON FILE IN MY OFFICE AND CUSTODY.
WITNESS MY HAND AND OFFICIAL SEAL THIS 13th DAY OF December, 1954.

Chas Doerner
COUNTY CLERK

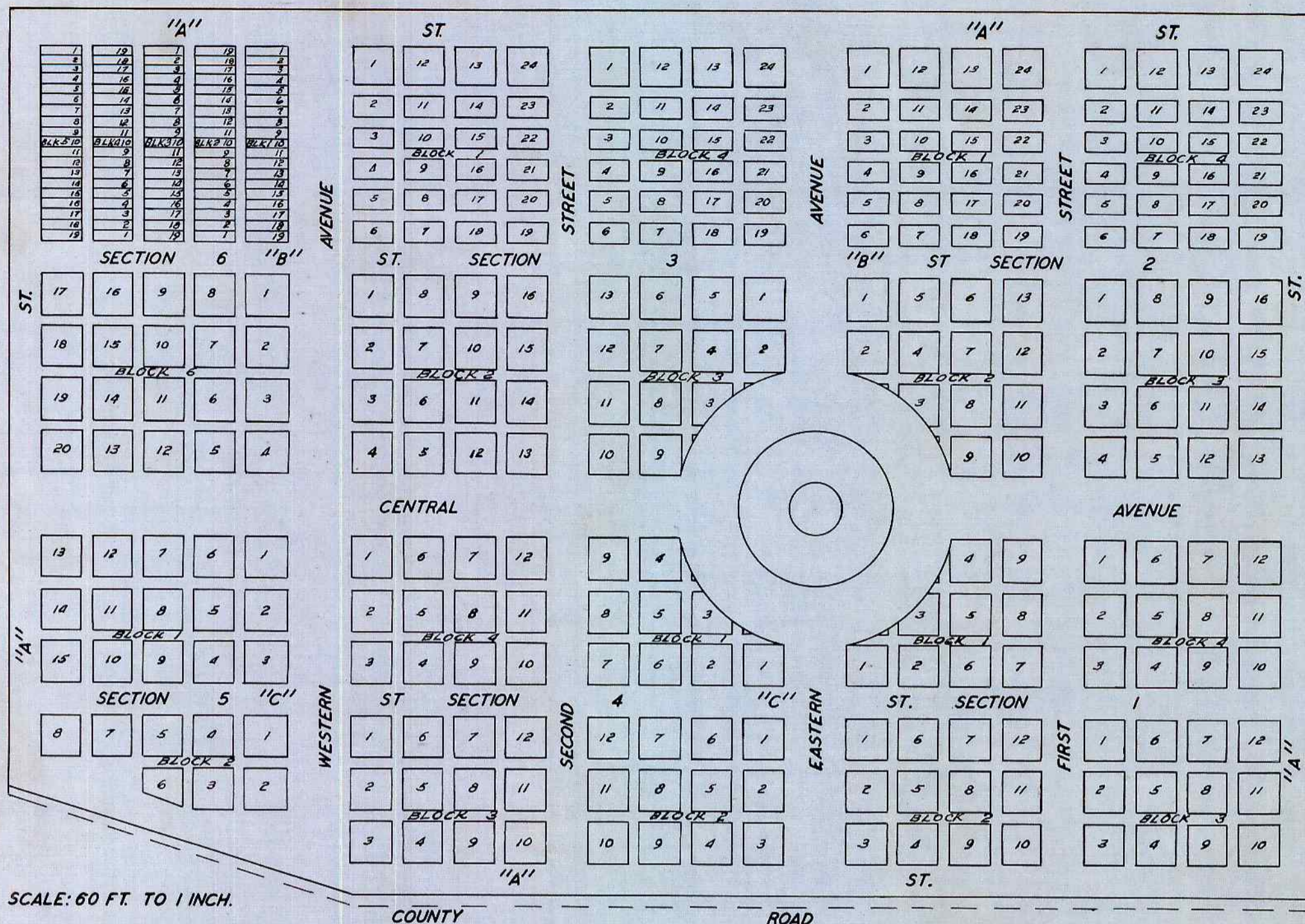

SCALE: 60 FT. TO 1 INCH.