

MAP SHOWING SUBDIVISION OF LOT 5 BLOCK 17 OF BUSHEY'S ADDITION TO ROSEBURG OREGON

NOTE:- A BLUE PRINT FROM THIS TRACING IS THOUGHT TO BE ON FILE THROUGH A MISTAKE, THE TRACING WAS NOT PLACED ON FILE.

SIGNED J. C. KELLEY

FILED FEB. 14, 1900 (SGD) J. F. GAZLEY, COUNTY CLERK

STATE OF OREGON }
COUNTY OF DOUGLAS } SS

I HEREBY CERTIFY THAT THE WITHIN WAS RECORDED BY ME IN DOUGLAS COUNTY RECORDS, BOOK OF DEEDS VOL. 39 PAGE 525 ON THE 25 DAY OF JUNE 1900. (SGD) J. F. GAZLEY, COUNTY CLERK.

60 ft Wide

NORTH 50° 50' EAST

SOUTH 84° 10' EAST

FULLERTON AVENUE

60 ft Wide

HOWARD STREET

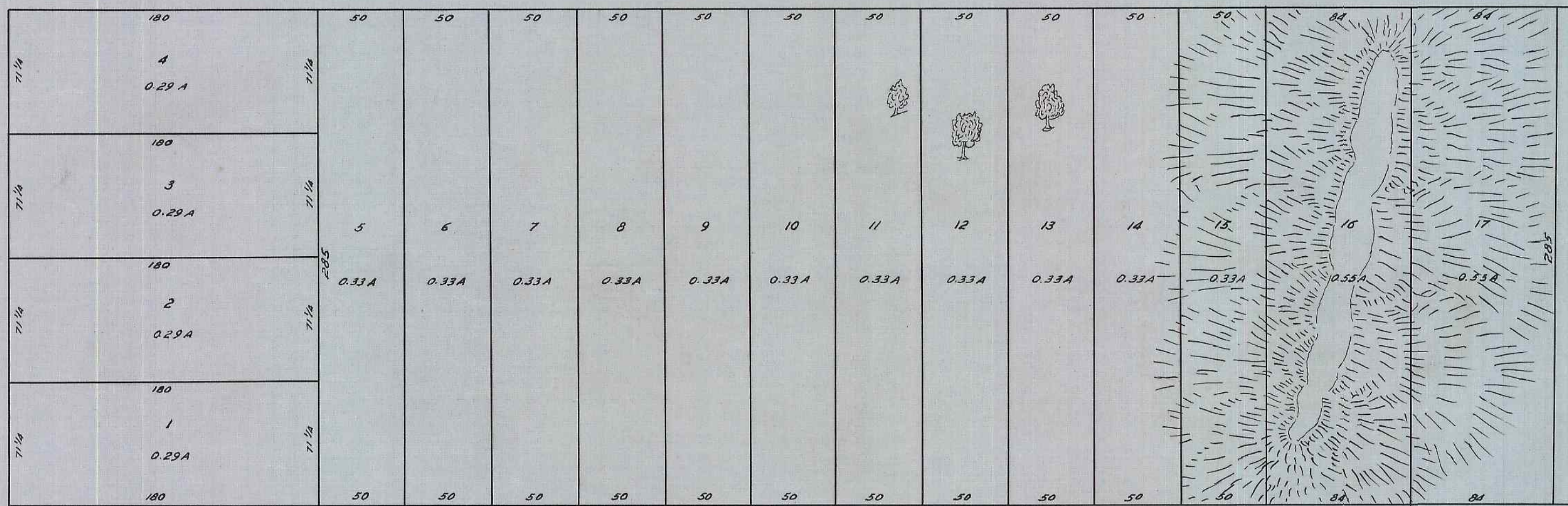

SCALE 60 FT TO 1 INCH
J. C. KELLEY C. E.
APRIL 1894



STATE OF OREGON }
COUNTY OF DOUGLAS } SS

I, CHAS. DOERNER COUNTY CLERK OF DOUGLAS COUNTY OREGON DO HEREBY CERTIFY THAT THE FOREGOING COPY OF PLAT HAS BEEN BY ME COMPARED WITH THE ORIGINAL THEREOF THAT IT IS A TRUE AND CORRECT COPY THEREFROM AND OF THE WHOLE THEREOF AS THE SAME APPEARS ON FILE IN MY OFFICE AND CUSTODY.

WITNESS MY HAND AND OFFICIAL SEAL THIS 26 DAY OF January 1955.

Chas Doerner
COUNTY CLERK

STATE OF OREGON }
COUNTY OF DOUGLAS } SS

I, BEN B. IRVING COUNTY SURVEYOR OF DOUGLAS COUNTY OREGON DO HEREBY CERTIFY THAT THIS COPY OF "SUBDIVISION OF LOT 5 BLOCK 17 OF BUSHEY'S ADDITION" IS A TRUE AND CORRECT COPY OF THE ORIGINAL PLAT AS FILED IN THE OFFICE OF THE COUNTY CLERK AND IS MADE IN COMPLIANCE WITH CHAPTER 92 OREGON LAWS 1953, SEC. 92 - 130.

Ben B. Irving
COUNTY SURVEYOR

SUBSCRIBED AND SWORN TO BEFORE ME THIS 26 DAY OF January 1955

Chas Doerner
COUNTY CLERK