

PLAT OF
CEMETERY GROUNDS PROPERTY, OF MIRROR LODGE NO. 47 I. O. O. F.
LOOKING GLASS DOUGLAS COUNTY OREGON

FILED MARCH 10TH 1898
(SGD) JOHN H. SHUPE
COUNTY CLERK

RECORDED MARCH 10TH 1898
(SGD) JOHN H. SHUPE
COUNTY CLERK

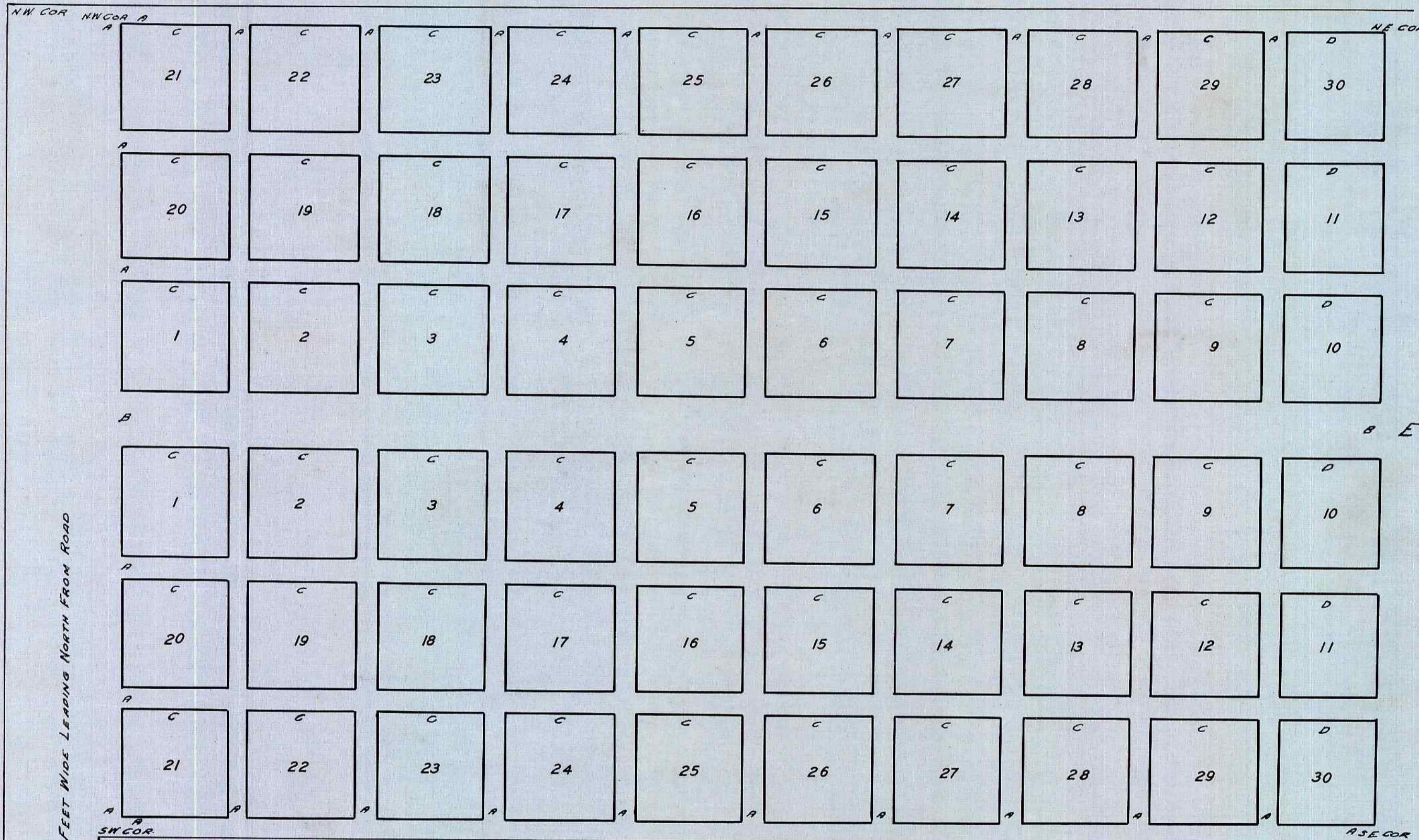

STATE OF OREGON }
COUNTY OF DOUGLAS } SS
I, BEN B. IRVING, COUNTY SURVEYOR OF DOUGLAS COUNTY OREGON DO HEREBY CERTIFY THAT THIS COPY OF "PLAT OF CEMETERY GROUNDS PROPERTY OF MIRROR LODGE NO. 47 I. O. O. F. LOOKING GLASS DOUGLAS COUNTY OREGON" IS A TRUE AND CORRECT COPY OF THE ORIGINAL PLAT AS FILED IN THE OFFICE OF THE COUNTY CLERK AND IS MADE IN COMPLIANCE WITH CHAPTER 92 OREGON LAWS 1953, SEC. 92-130

Ben B. Irving
COUNTY SURVEYOR

SUBSCRIBED AND SWORN TO BEFORE ME THIS 2nd DAY OF December 1954.

Chas Doerner
COUNTY CLERK

STATE OF OREGON }
COUNTY OF DOUGLAS } SS
I, CHAS DOERNER, COUNTY CLERK, OF DOUGLAS COUNTY OREGON DO HEREBY CERTIFY THAT THE FOREGOING COPY OF PLAT HAS BEEN BY ME COMPARED WITH THE ORIGINAL THEREOF THAT IT IS A TRUE AND CORRECT COPY THEREFROM AND OF THE WHOLE THEREOF AS THE SAME APPEARS ON FILE IN MY OFFICE AND CUSTODY.
WITNESS MY HAND AND OFFICIAL SEAL THIS 2nd DAY OF December 1954.

Chas Doerner
COUNTY CLERK

A: ALLEYS 4 FEET WIDE, B GREAT THOROUGHFARE 11 FEET WIDE, C LOTS 22 FEET SQUARE, D LOTS 22 FEET NORTH & SOUTH 15 FEET 8 IN EAST & WEST.