

PLAT OF PART OF THE TOWN OF WINCHESTER

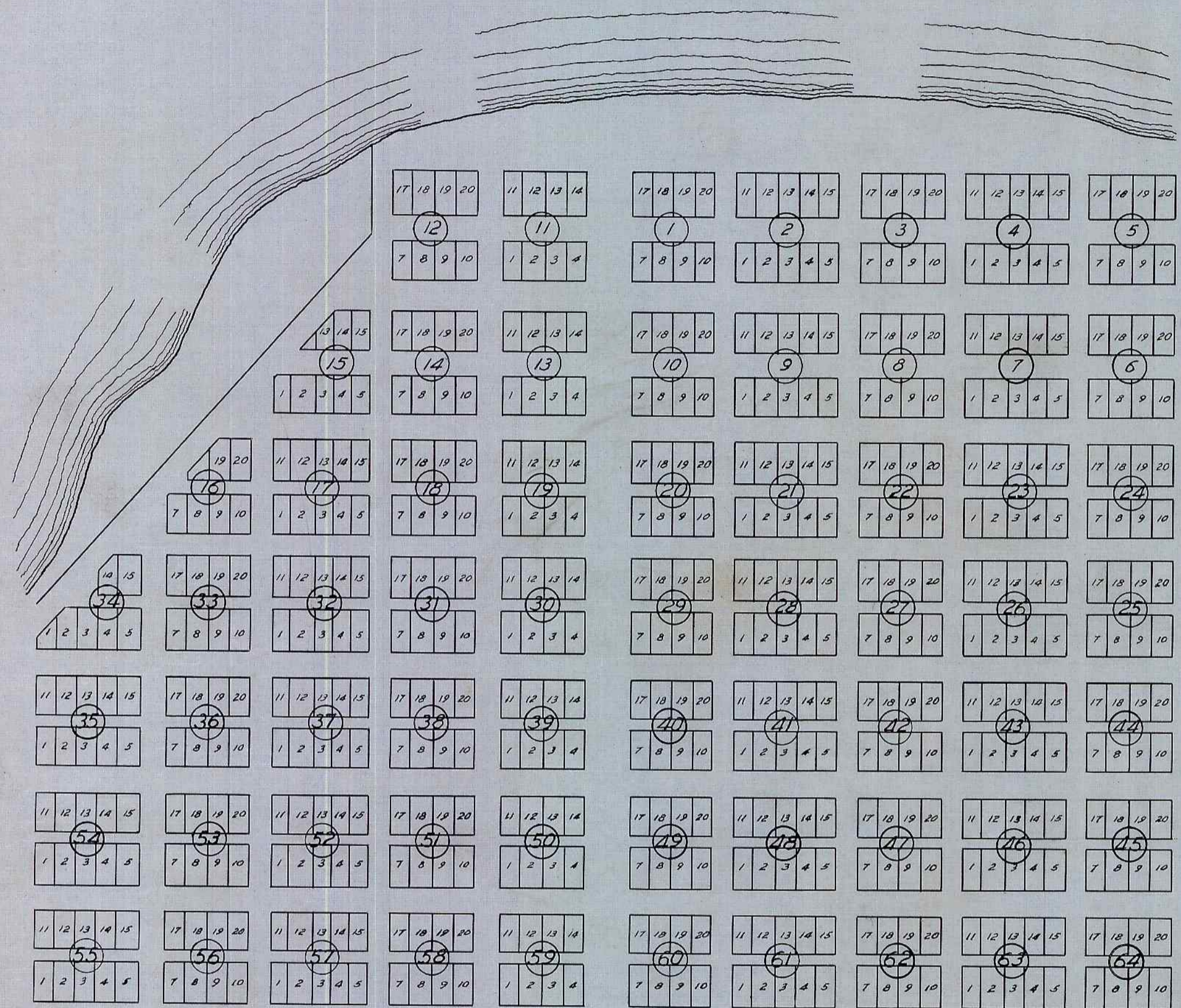

STATE OF OREGON }
 COUNTY OF DOUGLAS } ss
 I, BEN B. IRVING, COUNTY SURVEYOR OF DOUGLAS COUNTY OREGON, DO HEREBY CERTIFY THAT THIS COPY OF "PLAT OF PART OF THE TOWN OF WINCHESTER" IS A TRUE AND CORRECT COPY OF THE ORIGINAL PLAT AS FILED IN THE OFFICE OF THE COUNTY CLERK AND IS MADE IN COMPLIANCE WITH CHAPTER 92 OREGON LAWS 1953 SEC 92-130

Ben B. Irving
 COUNTY SURVEYOR

SUBSCRIBED AND SWORN TO BEFORE ME THIS 26 DAY OF January 1955.

Chas Doerner
 COUNTY CLERK

STATE OF OREGON }
 COUNTY OF DOUGLAS } ss
 I, CHAS. DOERNER, COUNTY CLERK OF DOUGLAS COUNTY OREGON DO HEREBY CERTIFY THAT THE FOREGOING COPY OF PLAT HAS BEEN BY ME COMPARED WITH THE ORIGINAL THEREOF THAT IT IS A TRUE AND CORRECT COPY THEREFROM AND OF THE WHOLE THEREOF AS THE SAME APPEARS ON FILE IN MY OFFICE AND CUSTODY.
 WITNESS MY HAND AND OFFICIAL SEAL THIS 26 DAY OF January 1955

Chas Doerner
 COUNTY CLERK

RECORDED JUNE 17TH 1857 (SGD) JAMES M. PYLE, RECORDER.

RECORDED IN DEED RECORDS VOL. I, P. 97

FOR PARTIAL VACATION SEE VACATING ORDER V. 7 P. 232 JULY 5th TERM 1899 OF COUNTY COURT ALSO VOL. 7 PAGE 488 MAY 8th TERM 1902 OF COUNTY COURT. ALSO VOL. 7 P. 379 ALSO VOL. 6 P. 548.