

CAMELOT SUBDIVISION

GENERAL NOTES

- THE 2002 EDITION OF THE STANDARD SPECIFICATIONS FOR CONSTRUCTION PREPARED BY THE OREGON DEPARTMENT OF TRANSPORTATION AND THE AMERICAN PUBLIC WORKS ASSOCIATION OREGON CHAPTER WILL BE CONSIDERED THE STANDARD SPECIFICATIONS.
- TRENCH BACK FILL SHALL BE CLASS B (3/4"-0" CRUSHED ROCK) UNDER ALL STREETS AND PARKING LOTS, AND CLASS A (SUITABLE EXCAVATED MATERIAL) ELSEWHERE, UNLESS SHOWN DIFFERENT ON TRENCH DETAIL OR IN SPECIFICATIONS. ALL TRENCHES WILL BE COMPACTED WITH HAND-OPERATED PNEUMATIC COMPACTOR.
- THE CONTRACTOR SHALL REPLACE ANY AND ALL SURVEY MONUMENTS WHICH ARE AFFECTED BY THE CONSTRUCTION. ALL MONUMENTS WILL BE RESET BY A LICENSED LAND SURVEYOR.
- LOCATIONS SHOWN ON ENGINEERING DRAWINGS ARE APPROXIMATE. THE EXACT LOCATION WILL BE STAKED IN THE FIELD BY THE ENGINEER. CONTRACTOR TO GIVE SEVEN (7) DAYS NOTICE TO ENGINEER FOR STAKES.
- CONTRACTOR SHALL MAINTAIN A MINIMUM HORIZONTAL SEPARATION OF TEN (10) FEET BETWEEN WATER MAINS AND SEWER MAINS MEASURED EDGE TO EDGE.
- INSULATED COPPER TONING WIRE APPROVED FOR DIRECT BURY SHALL BE PLACED IN ALL TRENCHES WHERE PIPE HAS BEEN LAID. ALL TONE WIRE SHALL BE TESTED PRIOR TO ACCEPTANCE.
- THE CONTRACTOR SHALL NOTIFY ALL AFFECTED UTILITY COMPANIES FOR LOCATIONS OF MAINLINE AND SERVICE LINE LOCATIONS PRIOR TO DIGGING. CONTRACTOR TO CONTACT ONE-CALL AT LEAST 48 HOURS PRIOR TO CONSTRUCTION AT 1-800-332-2344.
 ATTENTION:
 OREGON LAW REQUIRES YOU TO FOLLOW RULES ADOPTED BY THE OREGON UTILITY NOTIFICATION CENTER. THOSE RULES ARE SET FORTH IN THE OAR 952-001-0010 THROUGH OAR 952-001-0090, AND OREGON LAWS 1995, CHAPTER 691, SECTION 7. YOU MAY OBTAIN COPIES OF THE RULES BY CALLING THE CENTER.
- ENGINEER AND COUNTY TO BE NOTIFIED FOR INSPECTION AS SHOWN ON SCHEDULE OR AS SPECIFIED IN "GENERAL NOTES" FOR THAT SPECIFIC CONSTRUCTION ITEM.
- CONTRACTOR TO FIELD VERIFY TYPE, LOCATION, AND ELEVATIONS OF EXISTING UNDERGROUND UTILITIES PRIOR TO INSTALLATION OF NEW PIPING.
- CONTRACTOR RESPONSIBLE FOR OBTAINING ALL REQUIRED PERMITS FOR WORKING IN PUBLIC RIGHT OF WAYS. (i.e. ODOT, CITY, COUNTY).
- COMPACTION TESTS SHALL BE REQUIRED ON ALL MAINLINE TRENCHES AND ON SUB GRADE MATERIAL. ALL TESTING SHALL BE AT THE APPLICANT/DEVELOPER'S COST.

GENERAL SANITARY SEWER AND WATER NOTES

- ALL SANITARY SEWER WORK SHALL BE IN CONFORMANCE WITH TRI CITY JOINT SANITARY SEWER & WATER WORKS AUTHORITY'S SPECIFICATIONS AND ORDINANCE (FEBRUARY 6, 2007). IN CASES OF CONFLICT TRI CITY SANITARY SEWER & WATER WORKS AUTHORITY'S SPECIFICATIONS SHALL TAKE PRECEDENCE OVER THE STANDARD SPECIFICATIONS.

GENERAL STREET IMPROVEMENT NOTES

- ALL STREET IMPROVEMENT WORK SHALL BE IN CONFORMANCE WITH THE LATEST VERSION OF CITY OF ROSEBURG DOUGLAS COUNTY DRAINAGE MANAGEMENT PLAN DESIGN STANDARDS AND ADDENDUM DATED MAY 1990 AND DOUGLAS COUNTY PUBLIC WORKS DEPARTMENT DESIGN STANDARDS AND STANDARD DRAWINGS. IN CASES OF CONFLICT THE DOUGLAS COUNTY STANDARDS SHALL TAKE PRECEDENCE OVER THE STANDARD SPECIFICATIONS.
- ALL TRENCHES IN DOUGLAS COUNTY ROADWAYS SHALL BE BACK FILL WITH SAND SLURRY.
- ALL ASPHALT PAVEMENT SHALL BE "C" MIX MEETING OREGON STATE HIGHWAY DEPARTMENT STANDARDS.
- TWO CURB WEEP HOLES PER LOT SHALL BE PROVIDED AT EITHER END OF FRONTAGE OR AS DESIGNATED BY THE ENGINEER.
- ENGINEER AND CITY TO BE NOTIFIED FOR INSPECTION AS SHOWN ON SCHEDULE OR AS SPECIFIED IN "GENERAL NOTES" FOR THAT SPECIFIC CONSTRUCTION ITEM.

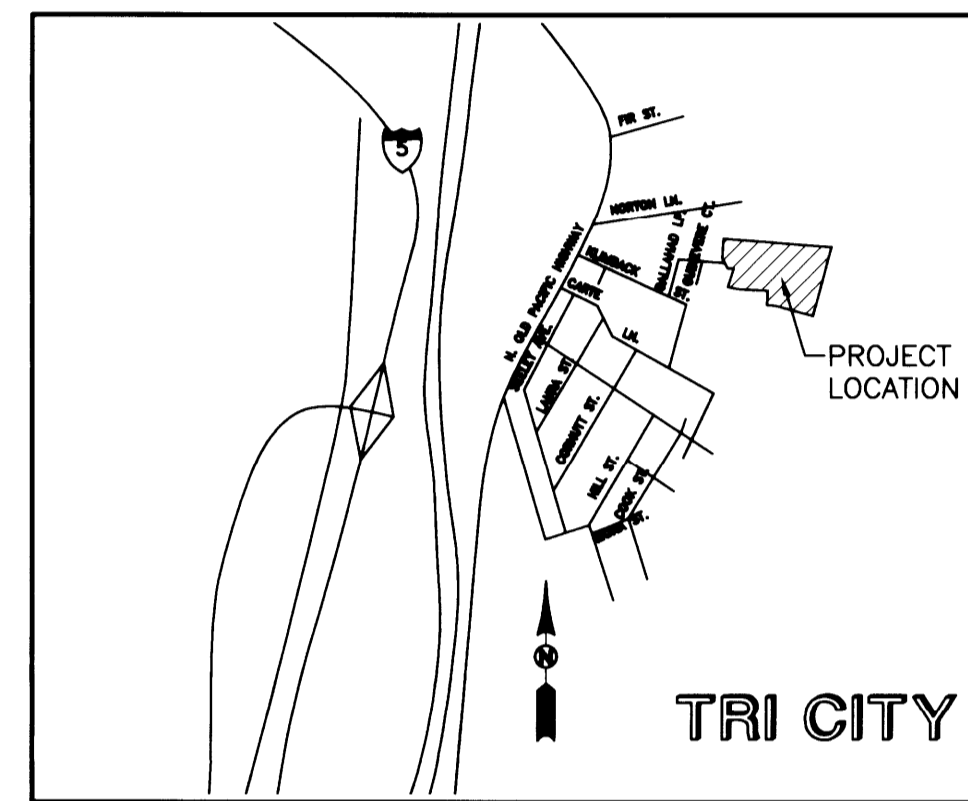

VICINITY MAP
NTS

DOUGLAS COUNTY INSPECTION SCHEDULE

DOUGLAS COUNTY SHALL BE NOTIFIED FOR INSPECTION AT LEAST 24 HOURS PRIOR TO THE ACCOMPLISHMENT OF THE FOLLOWING STAGES OF CONSTRUCTION. PHONE: 440-4481

- ANY STORM SEWER CONSTRUCTION (INCLUDING STRUCTURES)
- FINISH SUB-GRADE. (PRIOR TO FABRIC INSTALLATION)
- SOIL STABILIZATION FABRIC INSTALLATION
- FINISHED SUBBASE MATERIAL (PRIOR TO PLACING BASE COURSE)
- ANY CONCRETE WORK
- FINISH AGGREGATE BASE COURSE
- PAVING

NONE OF THE ABOVE ITEMS OF WORK IN COUNTY SHALL BE COVERED UNTIL INSPECTED BY DOUGLAS COUNTY.

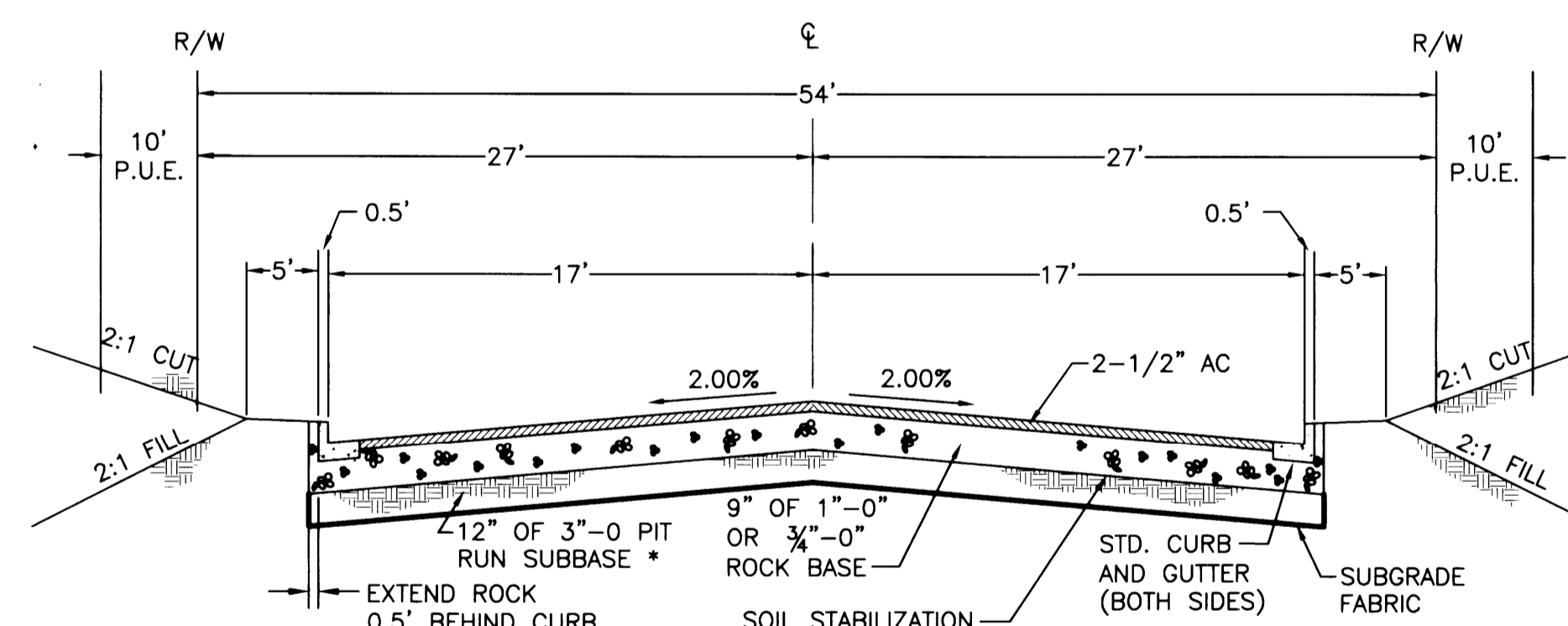

TYPICAL STREET SECTION
NTS

* REMOVE AND REPLACE ANY CONTAMINATED 3"-0 PIT RUN SUBBASE MATERIAL PRIOR TO PLACING AGGREGATE BASE.

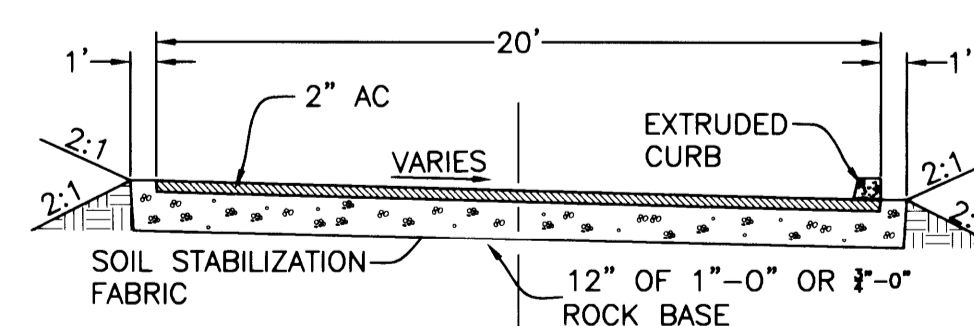

TYPICAL DRIVEWAY SECTION
N.T.S.

LEGEND

(ELEV.) ELEV.	EXISTING ELEV.	□	EXISTING CURB INLET (CI)
---	NEW ELEV.	■	NEW CURB INLET (CI)
---	SAW CUT	□	EXISTING CATCH BASIN (CB)
---	EXISTING CABLE TV	■	NEW CATCH BASIN (CB)
---	EXISTING EDGE OF AC OR GRAVEL	□	CLEANOUT
---	EXISTING POWER (OVERHEAD)	○	GUY WIRE
---	EXISTING POWER (UNDERGROUND)	○	GAS METER
---	NEW UNDERGROUND (TV, POWER, PHONE)	○	EXISTING FIRE HYDRANT
---	EXISTING GAS	○	NEW FIRE HYDRANT
---	EXISTING RIGHT-OF-WAY	○	LANDSCAPING
---	NEW RIGHT-OF-WAY	○	EXISTING VALVE
---	EXISTING FENCE	○	NEW VALVE
---	NEW FENCE	○	EXISTING MANHOLE (MH)
---	EXISTING WATER	○	NEW MANHOLE (MH)
---	EXISTING WATERMAIN	○	POWER POLE
---	NEW WATER	○	PHONE PED
---	EXISTING STORM SEWER (STS)	○	EXISTING LIGHT POLE
---	NEW STORM SEWER (STS)	○	NEW LIGHT POLE
---	EXISTING SANITARY SEWER (SS)	○	MAIL BOX
---	NEW SANITARY SEWER (SS)	○	EXISTING WATER SERVICE
---	EXISTING PRESSURE SEWER (PS)	○	NEW WATER SERVICE
---	NEW PRESSURE SEWER (PS)	○	BLOW OFF
---	EXISTING FORCEMAIN (FM)	○	CABLE TV PED (TV)
---	NEW FORCEMAIN (FM)	○	
---	SILT FENCE (S-F)	○	
---	NEW ELECTRICAL CONDUIT	○	
---	TOP OF CURB	○	
---	ASPHALT	○	
---	BACK OF WALK	○	
---	FINISH GRADE	○	
---	FINISH FLOOR	○	
---	ORIGINAL GROUND	○	
---	TOP OF WALK	○	

SHEET INDEX

- COVER SHEET / GENERAL NOTES
- OVERALL / EXISTING SITE CONDITIONS
- OVERALL GRADING & EROSION CONTROL
- GALLAHAD PLAN & PROFILE
- SEWER PLAN & PROFILE / DETAILS
- CONSTRUCTION DETAILS
- CONSTRUCTION DETAILS
- CONSTRUCTION DETAILS
- EROSION CONTROL DETAILS
- WETLAND MITIGATION

CALL BEFORE YOU DIG 1
ONE CALL (800) 332-2344
 OAR 952-001-0010 THROUGH
 OAR 952-001-0090

i.e. ENGINEERING
 809 SE Pine Street
 Roseburg, Oregon 97470
 PHONE (541) 673-0166
 FAX (541) 440-9392
 iemail@ieengineering.com

Project Name: CAMELOT	
Title: CAMELOT	
DES JPM	PROJECT NO. 973-21
DWG BWC	DATE: MARCH 27, 2007
CHK SNL	SCALE: AS SHOWN
APP SNL	SHEET: 1 OF 10

REGISTERED PROFESSIONAL
 ENGINEER
 14828
 David T. Buhl
 OREGON
 MAY 25, 1988
 EXPIRES: 12/31/2009

Rev.	Date	Dwg	Description
1	4/20/07	BWC	AGENCIES REVIEW
2	11/1/08	ANV	SECTION CHANGE-OKed BY PW
3	3/16/09	ANV	AS-BUILTS