

CURVE DATA	
① Δ = 89°53'09" R = 20' L = 31.38'	⑥ Δ = 78°42'40" R = 37' L = 50.83'
② Δ = 90°06'51" R = 20' L = 31.46'	⑦ Δ = 78°42'40" R = 20' L = 27.48'
③ Δ = 41°22'13" R = 22' L = 15.86'	⑧ Δ = 103°20'07" R = 23' L = 41.48'
④ Δ = 161°27'06" R = 22' L = 61.99'	⑨ Δ = 206°40'13" R = 42' L = 151.50'

- GENERAL NOTES - STREET AND STORM DRAINAGE IMPROVEMENTS**
- ALL STREET AND STORM DRAINAGE IMPROVEMENTS SHALL BE CONSTRUCTED IN ACCORDANCE WITH DOUGLAS COUNTY STANDARDS AND SPECIFICATIONS.
 - THE ENTIRE STREET RIGHT-OF-WAY SHALL BE STRIPPED OF ORGANIC MATERIAL. THE MATERIAL MAY BE PLACED ON THE REAR 20 FEET OF THE ADJOINING LOTS AND AS DIRECTED AT THE TIME OF CONSTRUCTION.
 - THE CONTRACTOR SHALL PLACE ALL EXCESS EXCAVATED MATERIAL ON THE ADJOINING LOTS IN A UNIFORM MANNER. AT THE COMPLETION OF THE PROJECT, THE CONTRACTOR SHALL BLADE AND DISTRIBUTE THE MATERIAL PLACED ON THE LOTS SUCH THAT THE LOTS DRAIN WITHOUT WATER POCKETS AND THE AREA APPEARS PLEASANT TO THE EYE.
 - FILL MATERIAL WITHIN THE STREET RIGHT-OF-WAY LIMITS SHALL BE PLACED TO 95 PERCENT OF MAXIMUM DENSITY AND AT OPTIMUM MOISTURE AS DETERMINED BY AASHTO DESIGNATION T-99.
 - THE CONTRACTOR SHALL SUBMIT A SAMPLE OF THE PROPOSED MATERIAL TO BE USED FOR BASE ROCK FOR THE APPROVAL OF BOTH THE ENGINEER AND DOUGLAS COUNTY. APPROVAL OF THE SUBGRADE MUST BE RECEIVED BY THE CONTRACTOR PRIOR TO PLACEMENT OF ANY BASE MATERIAL. PROCEEDING WITHOUT APPROVAL SHALL BE GROUNDS FOR REMOVAL OF MATERIAL PLACED AND AT THE CONTRACTOR'S EXPENSE.
 - THE CONTRACTOR SHALL APPLY AN ADEQUATE TACK COAT TO THE CURB BELOW THE PAVING LINE AND TO ALL EXISTING ASPHALT SURFACES WHICH HAVE BEEN THOROUGHLY AND ADEQUATELY CLEANED OF ALL MONOMETHACRYLIC CONCRETE MATERIALS. APPROVAL MUST BE GIVEN FOR BASE ROCK PRIOR TO PLACEMENT OF ASPHALT CONCRETE IN ANY MOUNT.
 - A 3-INCH WEEP HOLE SHALL BE INSTALLED IN THE CURB 5 FEET EACH SIDE OF EACH LOT LINE.
 - AFTER THE CURB IS FINISHED (PRIOR TO FINAL SET), A "W" AND/OR AN "S" SHALL BE STAMPED IN THE TOP OF CURB OVER EACH WATER AND SEWER HOUSE SERVICE LOCATION.
 - THE 12-INCH-DIAMETER STORM SEWER SHALL BE EXTRA-STRENGTH, C-14, CONCRETE CULVERT PIPE.
 - THE BACKFILL ABOVE THE PIPE ZONE FOR STORM SEWERS SHALL BE WITH GRANULAR MATERIAL UNLESS OTHERWISE NOTED.

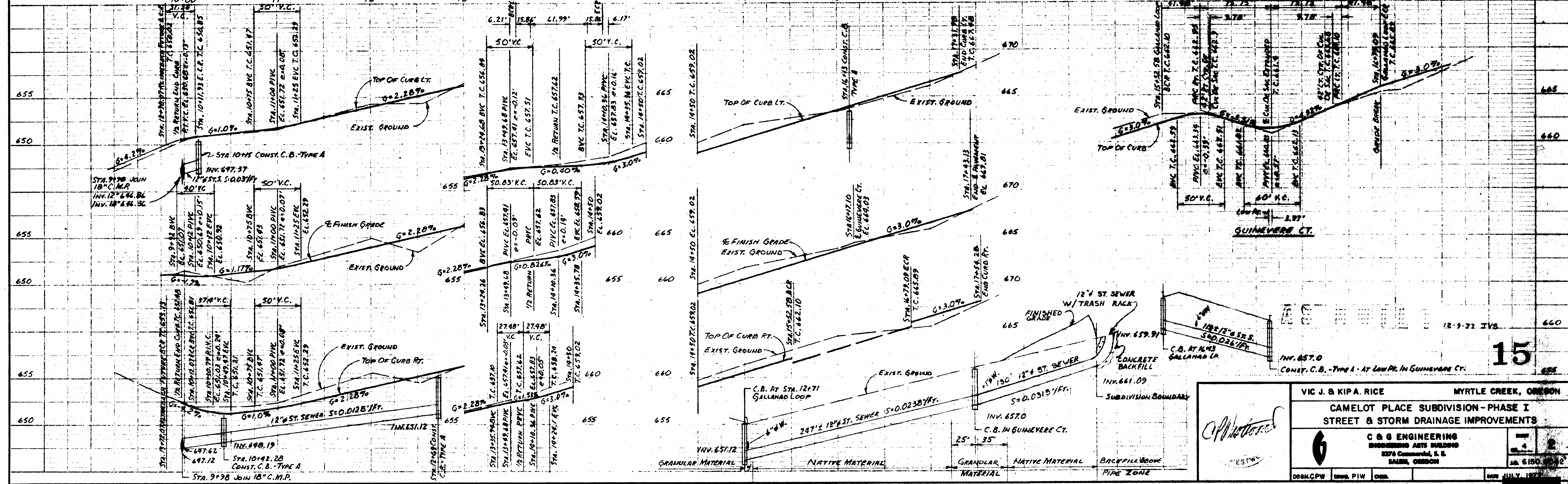

15

VIC J. B. KIPA, RICE MYRTLE CREEK, OREGON

CAMELOT PLACE SUBDIVISION - PHASE I
STREET & STORM DRAINAGE IMPROVEMENTS

C & G ENGINEERING
ENGINEERING ARTS BUILDING
2276 Commercial, S.E.
SALEM, OREGON

DATE: JULY 1987

DS&L:CPW amp. PIW CMB. and