

1R-5-273

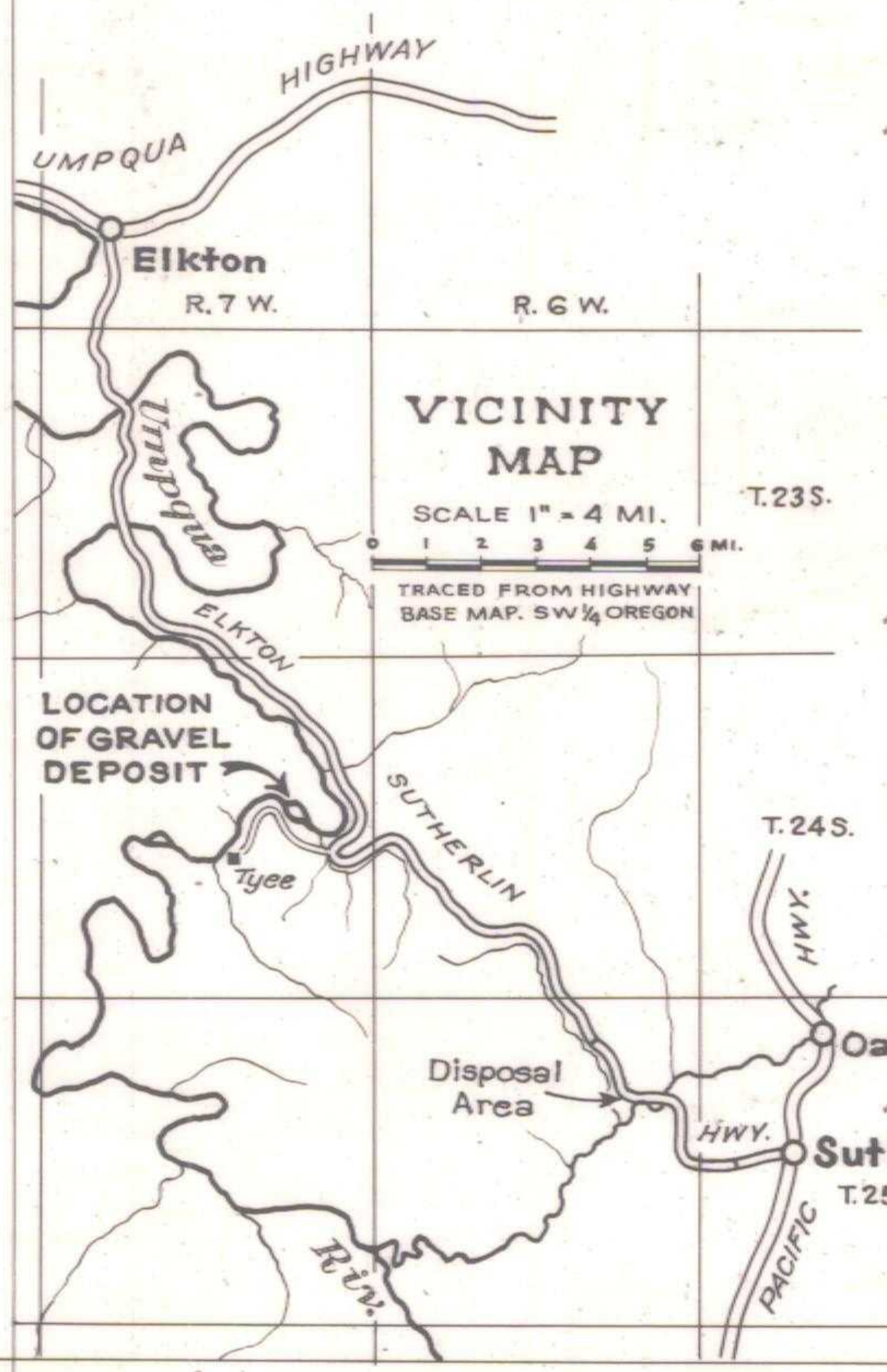
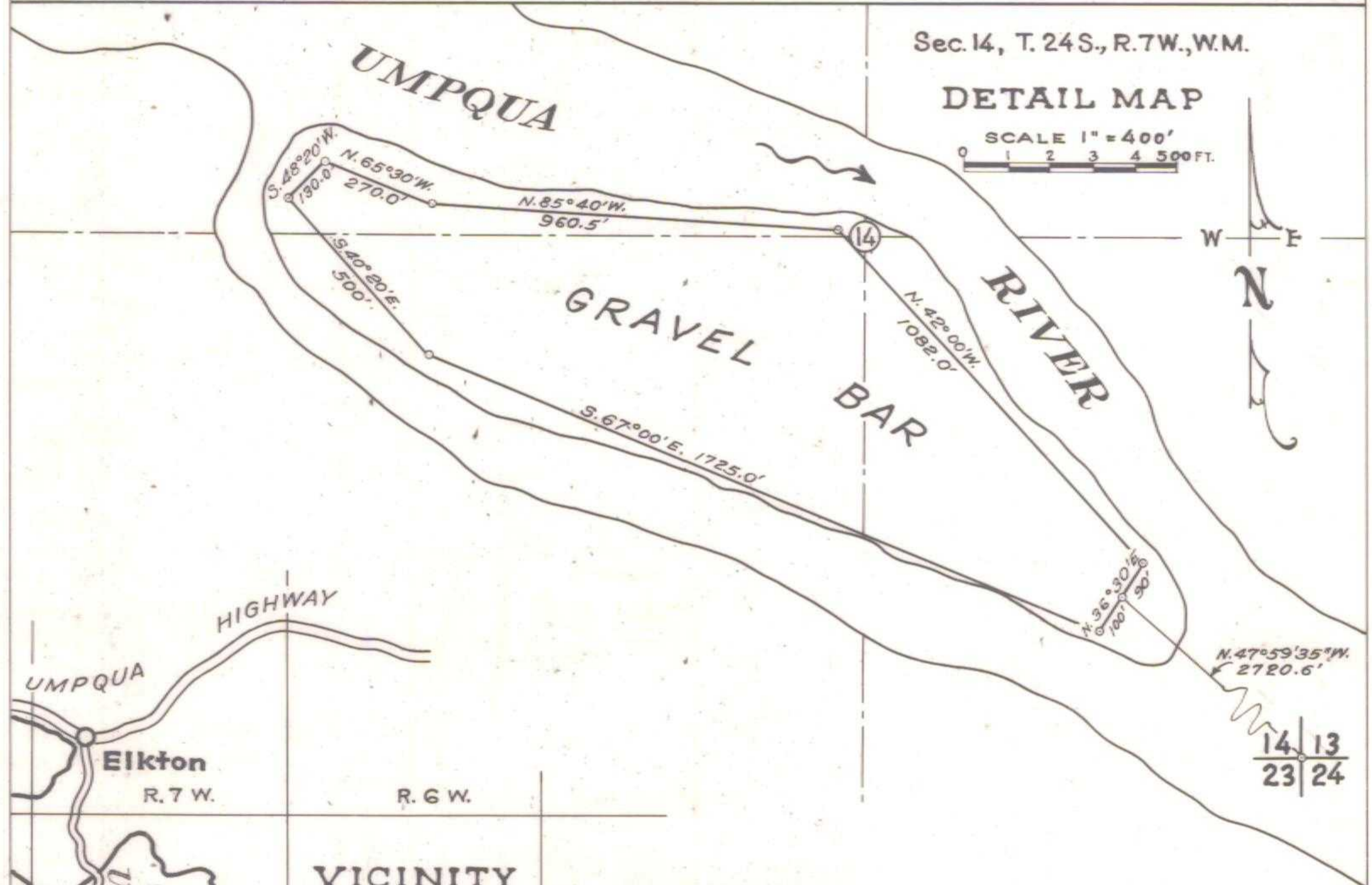

Approximately 100,000 Cu.Yds. of gravel to be dredged.

Normal High Water Elev. 216'
 " Low " " 202'
 No Excavation Below " 199'

PROPOSED DREDGING
 in
UMPQUA RIVER
 near
 Tye Junction
DOUGLAS COUNTY

APPLICATION BY OREGON STATE HIGHWAY COMM.
 May 1952