

T30S R5W WWM
SECTION 18
MP 225.3

18925
① F.L. KUMMER
Vol. 159 PAGE 138, 157
See 1R-5-238 for ②
6.07 ACRES

Deed Q-1370
B.221-P.165

1" Iron Pipe
Found

~~18924~~
G.A. FITZPATRICK
Vol. 100 PAGE 192
12.52 ACRES

2" Iron Pipe
Found

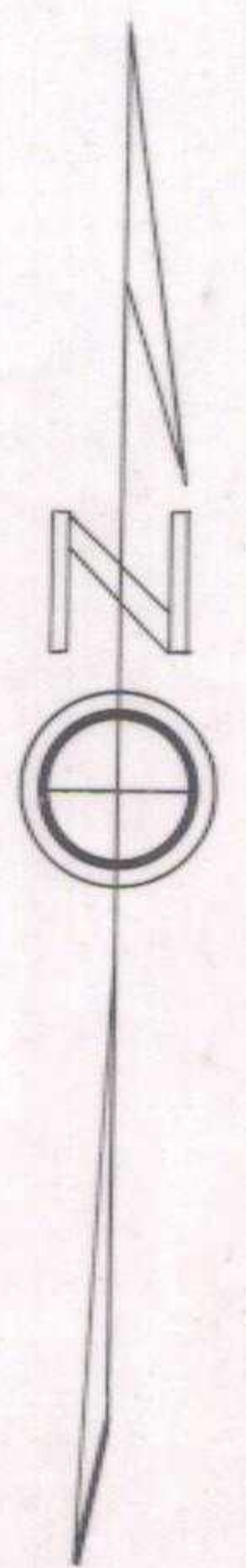
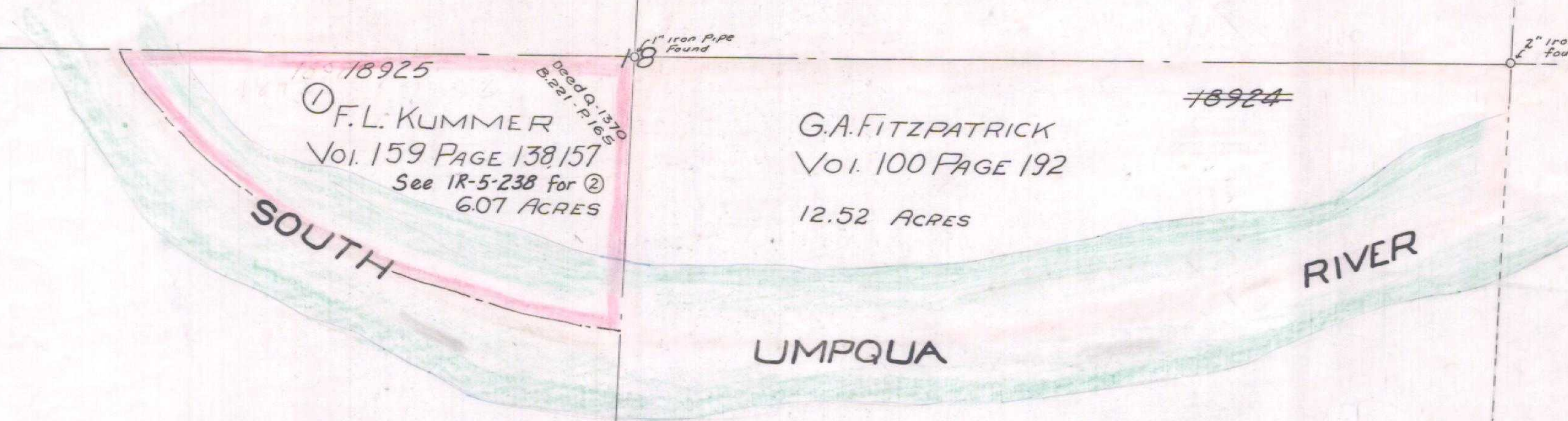

OREGON STATE HIGHWAY DEPARTMENT	
ACQUIRE FROM	KUMMER & FITZPATRICK
For	GRAVEL BAR
Highway	PACIFIC
County	DOUGLAS
Scale 1" = 200'	Date FEB. 21, 1952